

SECTION A-A

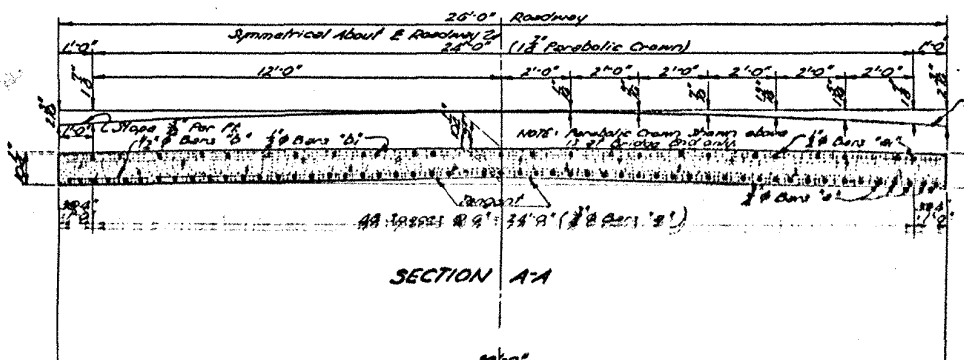

SECTION A-A

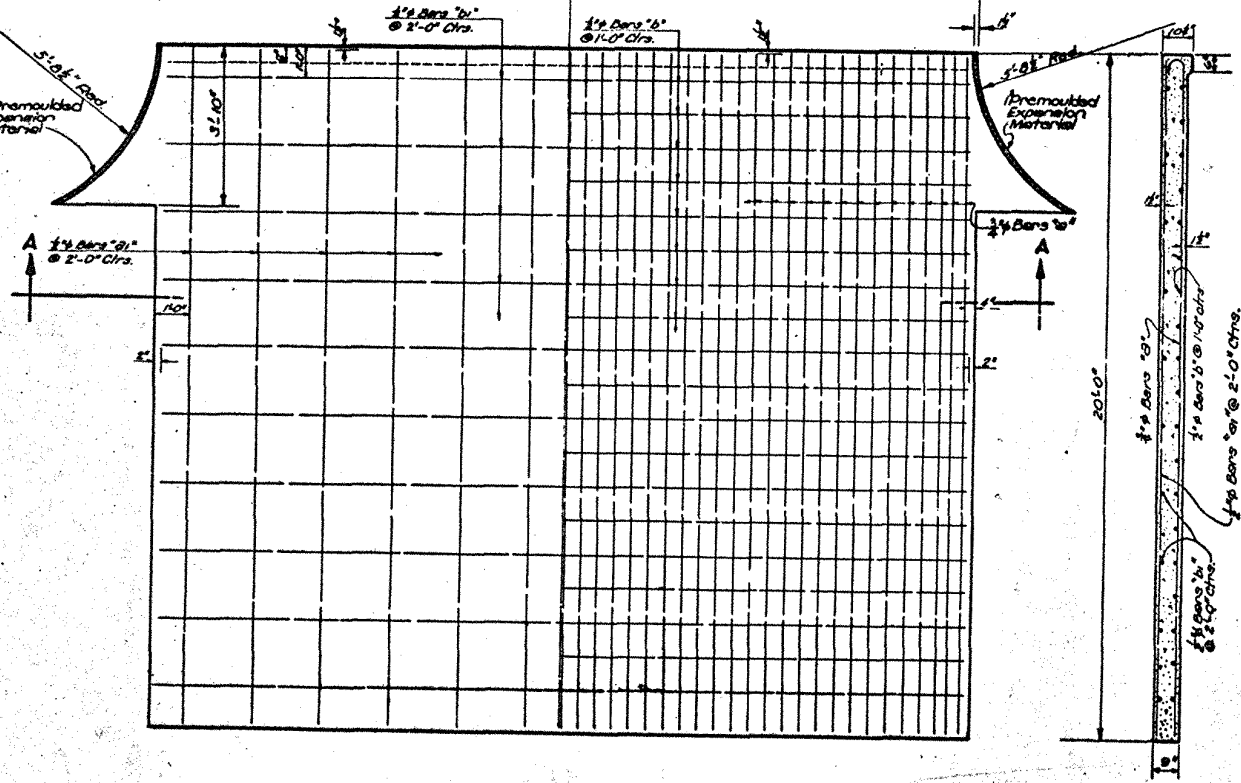

HALF PLAN  
Showing Reinf. Steel in Top of Slab.

HALF PLAN  
Showing Reinf. Steel in Bottom of Slab.

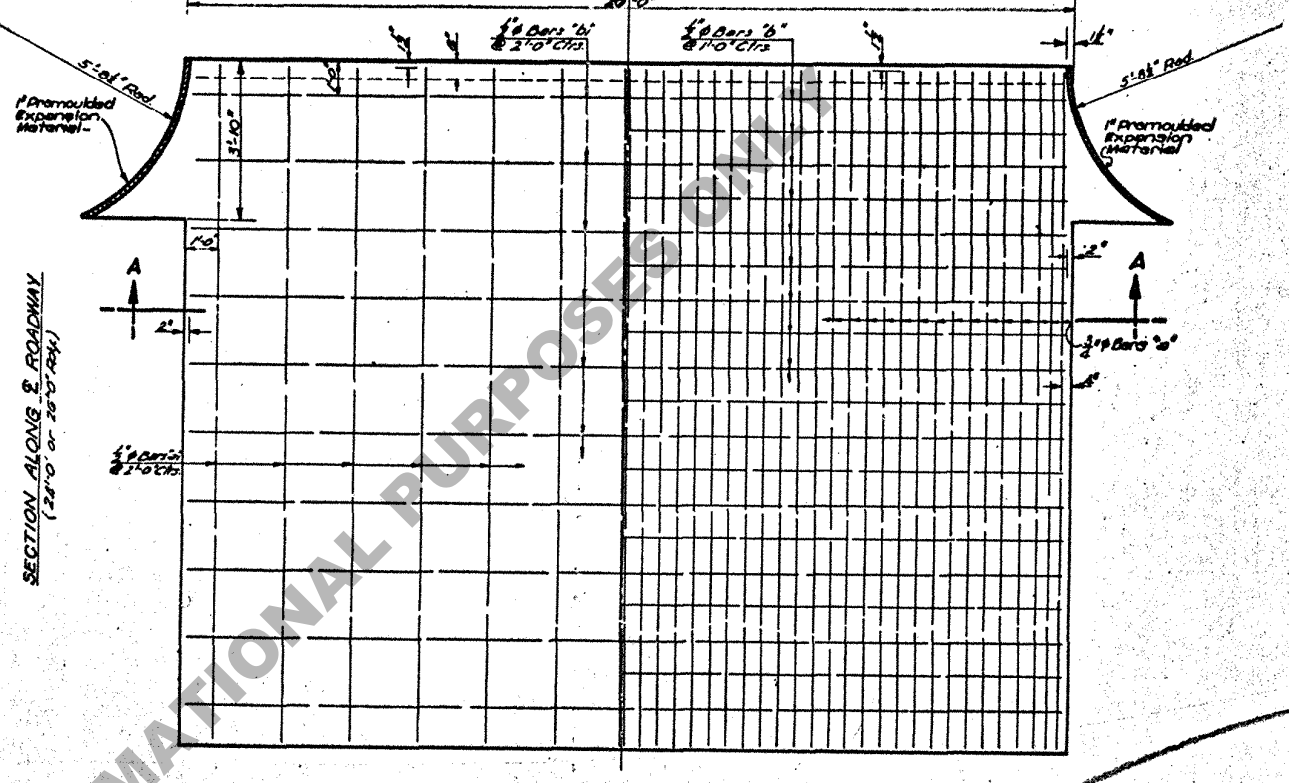

HALF PLAN  
Showing Reinf. Steel in Top of Slab

HALF PLAN  
Showing Reinf. Steel in Bottom of Slab

24'-0" ROADWAY

BILL OF MATERIALS (ONE SLAB)				
BAR SIZE	NO	UNIT	LGTH	TOTAL LGTH
#4	12	20'-5"	1082'-1"	Bottom of Slab
#4	12	20'-5"	1082'-1"	Bottom of Slab
TOTAL #4 BARS = 1000'-5" = 1500 LBS.				
TOTAL REINFORCING STEEL = 2119 LBS.				
CONCRETE APPR. SLAB = 64083.166				

26'-0" ROADWAY

BILL OF MATERIALS (ONE SLAB)				
BAR SIZE	NO	UNIT	LGTH	TOTAL LGTH
#4	12	20'-5"	1082'-1"	Bottom of Slab
#4	12	20'-5"	1082'-1"	Bottom of Slab
#4	12	20'-5"	1082'-1"	Bottom of Slab
#4	12	20'-5"	1082'-1"	Bottom of Slab
TOTAL #4 BARS = 1082'-1" = 1623 LBS.				
TOTAL REINF. STEEL = 2205 LBS.				
CONCRETE APPR. SLAB = 5852.30122				

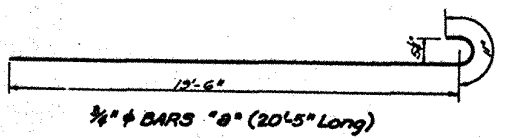

GENERAL NOTES:  
 Construction Specifications: Latest Approved LA. DEPT. OF HIGHWAYS STD. SPECS.  
 Design Specifications: A.A.S.H.O. 1943.  
 Dimensions relating to Reinforcing Steel are to Bar Centers.  
 Reinforcing Steel to be STRUCTURAL or INTERMEDIATE Grade.  
 All Concrete to be Class "A" or mix used in adjoining work.  
 1" Pre-moulded Expansion Material to be included in price bid for Concrete.

NOTE:  
 This Standard to be used with Gravel or Bituminous Approaches.

STANDARD PLAN  
 20'-0" REINF. CONC. APPROACH SLAB  
 24'-0" & 26'-0" ROADWAY  
 TO BE USED WITH STD. PLANS AS NOTED  
 24'-0" RWY: C-60-5, 6-15, 5-C, 5-15, 5-15, 5-C, 6-15  
 26'-0" RWY: C-60-5, 6-15, 5-C, 5-15, 5-15, 5-C, 6-15  
 DATED MAY 17, 1950

NOTE:  
 This Standard Plan is a Revision of Standard Plan C-M-113.

DATE	DESCRIPTION	BY

STATE OF LOUISIANA  
 DEPARTMENT OF HIGHWAYS  
 BRIDGE DESIGN SECTION

FOR INFORMATIONAL PURPOSES ONLY