

PLAN
Showing Reinforcing in Bottom of Slab

END ELEVATION

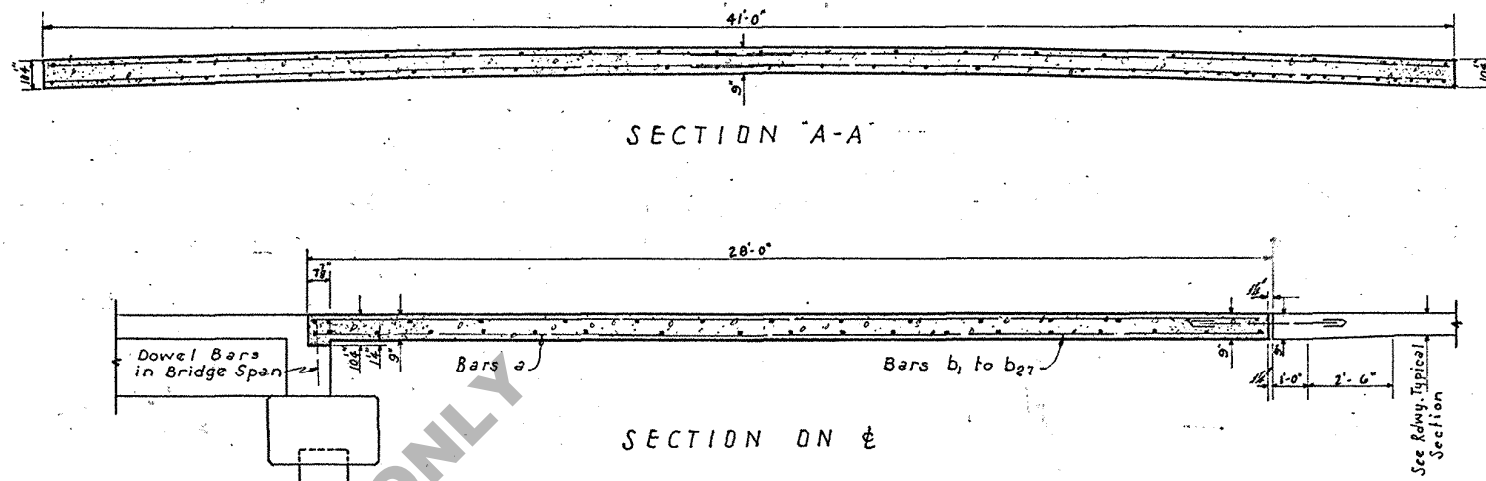

SECTION A-A

SECTION ON E

GENERAL NOTES:-
 1. La Highway Commission Specifications shall govern.
 2. Concrete shall be Class "A-A".
 3. All Reinforcing Steel shall be deformed Bars except the 3/4" x 4'-0" Dowels, which shall be round and smooth.
 4. The Sub-Grade shall be prepared as described in Pamphlet G, Paragraph 36.31.
 5. The Slab shall be finished as described in Pamphlet G, Paragraph 36.33, except that no finishing machine shall be required.
 6. The Slab shall be protected and cured as described in Pamphlet G, Paragraph 36.34, 36.35 & 36.36.
 7. The entire length of the 3/4" dowel Bars shall be dipped in heavy oil or painted with grease prior to placing.
 8. No direct payment will be made for the 40 Expansion Tubes; cost of same shall be included in unit bid price for deformed steel.

BILL OF REINFORCING STEEL FOR ONE APPROACH SLAB							
MARK	SIZE	SPACING	NO	VARI- ATION	LENGTH		LOCATION
					UNIT	TOTAL	
Dowels	3/4"	2'-0"	20	-	4'-0"	80'-0"	Dowels to Rdwy. Slab
TOTAL 3/4" BARS =						80'-0"	= 120 Lbs.
a	5/8"	6"	80	-	10'-8"	853'-4"	Longit. bottom of Slab at Br. End
a1	-	6"	2	-	3'-6"	13'-0"	Ditto at edges
b, to b27	-	1'-6"	leach	1'-3"	4'-0" - 36'-6"	546'-9"	Longit. Bottom of Slab
TOTAL 5/8" BARS =						1413'-1"	= 1480 Lbs.
c	1/2"	1'-6"	10	-	26'-6"	265'-0"	Diag. Transv. Bottom of Slab
c1	-	6"	4	-	25'-9"	103'-0"	Ditto at Bridge End
d	-	6" & 1'-6"	36	-	4'-0"	144'-0"	Dowels Top & Bottom of Slab
e	-	1'-6"	15	-	20'-3"	303'-9"	Transv. Bottom of Slab
e1 to e3	-	1'-6"	leach	1'-9"	5'-0" - 19'-0"	108'-0"	Ditto short side of Slab
e4 to e13	-	1'-6"	leach	1'-9"	4'-0" - 19'-9"	118'-9"	- Long
f	-	2'-0"	6	-	26'-6"	159'-0"	Diag. Transv. Top of Slab
f1	-	6"	4	-	25'-9"	103'-0"	Ditto at Bridge End
g	-	2'-0"	14	-	20'-3"	283'-6"	Transv. Top of Slab
g1 to g7	-	2'-0"	leach	2'-4"	4'-6" - 18'-6"	80'-6"	Ditto Short Side of Slab
g8 to g14	-	2'-0"	leach	2'-4"	6'-0" - 20'-0"	91'-0"	- Long
h	-	-	1	-	3'-6"	3'-6"	Longit. Top of Slab Short Side
h1 to h10	-	2'-0"	leach	1'-8"	12'-0" - 27'-0"	195'-0"	-
k	-	-	1	-	43'-8"	43'-8"	- Long
k1 to k10	-	2'-0"	leach	1'-8"	28'-0" - 43'-0"	355'-0"	-
TOTAL 1/2" BARS =						2362'-8"	= 2008 Lbs.

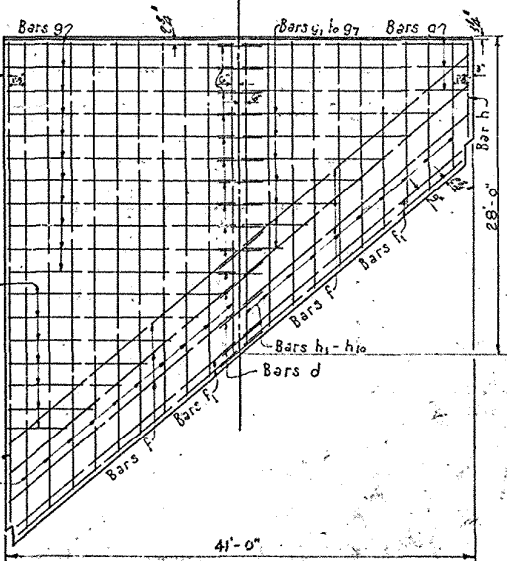

PLAN SHOWING REINFORCING IN TOP OF SLAB

QUANTITIES FOR ONE APPROACH SLAB
 CLASS "A-A" CONCRETE = 33.98 CU. YDS.
 TOTAL REINFORCING STEEL = 3608 POUNDS

Valid
 12-21-45

STANDARD PLAN
 R.C. APPROACH SLAB 50° SKEW
 FOR
 40' BRIDGE AND 4' ROADWAY SLABS
 LOUISIANA HIGHWAY COMMISSION
 BATON ROUGE, LA. August 1944

11-1-44	EXP. JONES	J.H.V.	Checked	By	Checked
REVISIONS					

C-M-19-3-50