

ROOSEVELT BLVD: W NAPOLEON - W METAIRIE (CE&I)

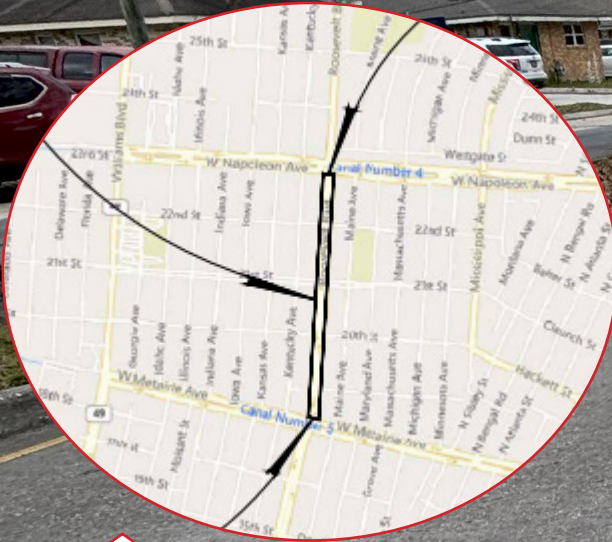

Contract No. 4400031036 | State Project No. H.015120.6

February 4, 2025



Proposed Project Location

DOTD FORM: 24-102

PROPOSAL TO PROVIDE CONSULTANT SERVICES

(Revised December 12, 2024)

Prime consultant shall complete the DOTD Form 24-102 without altering the Form's text; however, the instruction and/or guidance for Sections 12 through 23 can be removed but do not remove Section title and number.

ANY CONSULTANT FAILING TO SUBMIT ANY OF THE INFORMATION REQUIRED ON THE DOTD FORM 24-102, OR PROVIDING INACCURATE INFORMATION ON THE DOTD FORM 24-102, MAY BE CONSIDERED NON-RESPONSIVE.

1. Contract Name as shown in the advertisement	ROOSEVELT BLVD: W NAPOLEON - W METAIRIE (CE&I)
2. Contract Number(s) as shown in the advertisement	4400031036
3. State Project Number(s), if shown in the advertisement	H.015120.6
4. Prime consultant name (name must match <u>exactly</u> as registered with the Louisiana Secretary of State (SOS) where such registration is required by law; including punctuation; <u>include screenshot from SOS at the end of Section 20</u>)	 Design Engineering, Inc.
5. Prime consultant license number (as registered with the Louisiana Professional Engineering and Land Surveying Board (LAPELS) if registration is required under Louisiana law)	EF.0001135
6. Prime consultant mailing address	3330 W. Esplanade Avenue, Suite 205, Metairie, Louisiana 70002
7. Prime consultant physical address (existing or to be established, if location is used as an evaluation criteria)	(Same as above mailing address)
8. Name, title, phone number, and email address of prime consultant's contract point of contact	Jim Martin, Ph.D., P.E., President (504) 836-2155 jmartin@dei-engr.com
9. Name, title, phone number, and email address of the official with signing authority for this proposal	Jim Martin, Ph.D., P.E., President (504) 836-2155 jmartin@dei-engr.com

Prime consultant should enter the firm name in the footer at the bottom of this page. (It will carry over to subsequent pages.)

10. This is to certify that all information contained herein is accurate and true, and that the team presently has sufficient staff to perform these services within the designated time frame. By submitting this proposal, proposer certifies that it is not engaged in a boycott of Israel and it will, for the duration of its contract obligations, refrain from a boycott of Israel. Proposer also certifies and agrees that the following information is correct: In preparing its response, the proposer has considered all proposals submitted from qualified, potential subcontractors and suppliers, and has not, in the solicitation, selection, or commercial treatment of any subcontractor or supplier, refused to transact or terminated business activities, or taken other actions intended to limit commercial relations, with a person or entity that is engaging in commercial transactions in Israel or Israeli-controlled territories, with the specific intent to accomplish a boycott or divestment of Israel. The proposer also has not retaliated against any person or other entity for reporting such refusal, termination, or commercially limiting actions. DOTD reserves the right to reject the response of the bidder or proposer if this certification is subsequently determined to be false, and to terminate any contract awarded based on such a false response.

Pursuant to Act No. 581 of the 2024 Louisiana Legislature Regular Session, proposer further certifies that it does not have a practice, policy, guidance, or directive that discriminates against a firearm entity or firearm trade association based solely on the entity's or association's status as a firearm entity or firearm trade association. In addition, proposer certifies it will not discriminate against a firearm entity or firearm trade association during the term of the contract based solely on the entity's or association's status as a firearm entity or firearm trade association.

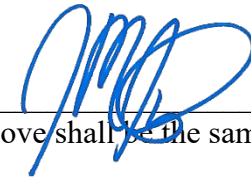

Signature above shall be the same person listed in Section 9:

February 4, 2025

Date:



11. If a Disadvantaged Business Enterprise (DBE) goal has been set for this advertisement, indicate which firm(s) will be used to meet the DBE goal and each firm(s)' percentage.

Firm(s):



The advertisement states "NO DBE GOAL"

Firm(s)' %:

12. Discipline Table:

Discipline(s)	% of Overall Contract	 Design Engineering, Inc. (Prime)	 Eustis Engineering L.L.C.	Each Discipline must total to 100%
CE&I/OV	100%	96%	4%	100%
Identify the percentage of work for the overall contract to be performed by the prime consultant and each sub-consultant.				
Percent of Contract	100%	96%	4%	100%

13. Firm Size:

Firm name	DOTD Job Classification	Number of personnel <u>committed to this contract</u>	Total number of personnel available in this DOTD Job Classification (if needed)
 Design Engineering, Inc.	Principal	0	3
	Supervisor - Eng	0	3
	Engineer	2	6
	Engineer Intern	0	4
	Project Office Manager	1	1
	Inspector - Certified	1	3
	Inspector	0	10
 Eustis Engineering L.L.C.	Principal	2	3
	Supervisor - Eng	2	8
	Engineer	1	4
	Engineer Intern	1	5
	Engineering-Aide	2	8
	CADD Technician	1	1
	Clerical	3	13
	Driller	1	7
	Geologist	1	2
	Inspector	6	15
	Inspector - Certified	1	1
	Supervisor - Other	2	8
	Technician	6	10



14. Organizational Chart:

Certifications	
■	DOTD Certified Inspector
*	Work Zone training (TCS, TCT, & Flagger)

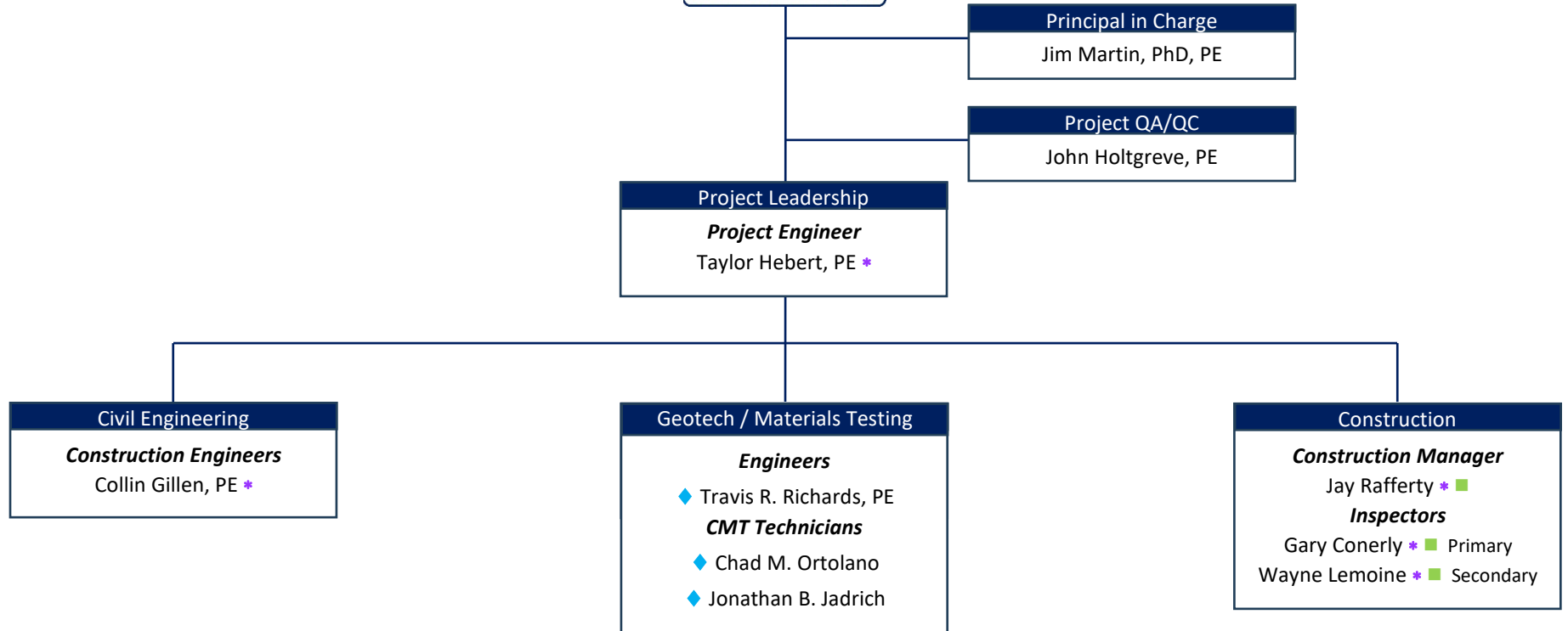
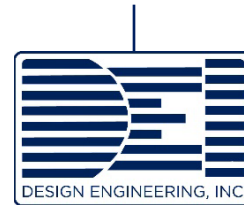

Sub-Consultants	
◆	Eustis Engineering L.L.C.
(No symbol signifies DEI Staff)	



15. Minimum Personnel Requirements:

MPR No. Do not insert wording from ad	Personnel being used to meet the MPR (Individual(s) may not satisfy more than one MPR unless specifically allowed by Attachment B of the advertisement)	Firm employed by	Type of license and discipline meeting MPR/ certification & number (Ex: PE # - Civil)	State of license	License / certification expiration date
1	Jim Martin, Ph.D., P.E.		P.E. No. 31281 - Civil	LA	09/30/2026
2	Collin Gillen, P.E.		P.E. No. 49017 - Civil	LA	09/30/2026
3	Taylor Hebert, P.E.		P.E. No. 44720 - Civil	LA	09/30/2026

16. Staff Experience:

Firm employed by		Design Engineering, Inc.			
Name	James Martin, Ph.D., P.E.		Years of relevant experience with this employer		11
Title	President/Principal-In-Charge		Years of relevant experience with other employer(s)		12
Degree(s) / Years / Specialization		 <p>Tulane University: Doctor of Philosophy 2003 Tulane University: MS, Environmental Engineering 2000 University of Alabama: BS, Civil Engineering 1998 Old Dominion University: Coastal Engineering Certificate 2010</p>			
Active registration number / state / expiration date		31281 /LA/ 09/30/2026			
Year registered	2004	Discipline	Civil Engineer		
Contract role(s) / brief description of responsibilities		Dr. Martin will serve as Principal-In-Charge for this project. Dr. Martin has had extensive design experience with the construction of civil engineering projects including concrete roads and drainage as featured in this project. He will make certain that appropriate resources are assigned to the project and that schedules and budgets are adhered to. He will be directly accessible to the client for any concerns that need to be elevated to the level of Principal.			
Experience dates (mm/yy–mm/yy)	Experience and qualifications relevant to the proposed contract; <i>i.e.</i> , “designed drainage”, “designed girders”, “designed intersection”, etc. Experience dates should cover the years of experience specified in the applicable MPR(s).				
12/23 – Ongoing	DOTD SP NO. H.014681.6: NINE MILE POINT RD: US 90 - LA 18 : (Role: President/Principal-In-Charge) Dr. Martin oversaw and managed all personnel and contracts involved in the construction engineering inspection services for the reconstruction of approximately 1.542 miles located on Nine Mile Point Road from its junction with Route US 90 to its junction with Seven Oaks Boulevard. The project scope included grading, milling asphalt concrete, pavement patching, Class II base course, fiber-reinforced asphalt concrete, and related work for the road improvement project of Nine Mile Point Rd: US 90 – LA 18 in Jefferson Parish. Pavement striping, signs, legends, and symbols were also included. DEI was responsible for the construction, engineering, and inspection, ensuring that all construction field records were maintained. DEI ensured daily entries in the project diary, documenting the utilization of contractor's personnel and equipment, acceptance of work, assessment of traffic control, and recording of contract time through the SiteManager.				
04/21 – Ongoing	DOTD SP NO. H.011797: AMES BLVD. (WESTBANK EXPRESSWAY - HAPPY ST.): (Role: President/Principal-In-Charge) Dr. Martin was responsible for overseeing and managing all personnel and contracts for the construction of 0.39 miles of roadway which included asphalt paving inspection, estimate generation, material sampling, submittal review, and project close-out of Ames Boulevard from the Westbank Expressway to Happy Street.				
09/23 - Ongoing	DOTD SP NO. H.011779: POWER BLVD. MEDIAN IMPROVEMENTS (WEST ESPLANADE AVE. – VINTAGE DR.): (Role: President/Principal-In-Charge) Dr. Martin was responsible for overseeing and managing all personnel and contracts for the creation of a bike/pedestrian path along the median area of Power Blvd. between West Esplanade Ave. and Vintage Drive. The project includes concrete paving, excavation, drainage, bridge construction, lighting, landscaping, striping, and the installation of amenities such as drinking water fountains.				
04/19 – Ongoing	DOTD SP NO. H.011795: WESTWOOD DRIVE (WB EXPRESSWAY. TO LAPALCO) (CE&I): (Role: President/Principal-In-Charge) Dr. Martin oversaw and managed all personnel and contracts involved in the construction of 0.648 miles of roadway. The scope of the project included 20,516 SY of Portland Cement Concrete Pavement with barrier curb, mountable curb, and gutter, including Class II base course, drainage pipes and structures, sanitary sewer, and related work. The project also involved tie-ins to the existing Westbank Expressway on the north end and Lapalco Blvd. on the south end. Pavement striping, and installation of signs, legends, and symbols were included in the scope. DEI was responsible for all construction field records and ensured daily entries were made in the project diary to document the contractor's personnel and equipment utilization, acceptance of work, adequacy of traffic control, and tracking of contract time through SiteManager.				

05/19 – Ongoing	DOTD SP NO. H011798.6: AIRLINE PARK BOULEVARD (CAMPHOR TO WEST NAPOLEON) (CE&I): (Role: President/Principal-In-Charge) Dr. Martin oversaw and managed all personnel and contracts for the construction of 0.390 miles of roadway. The scope of the project included grading, drainage structures, asphalt pavement milling, pavement patching, Class II base course, scarification and compaction of the roadbed, asphalt concrete pavement, Portland Concrete Pavement, cofferdams, stormwater pumping station, and related work. Additionally, tasks such as pavement striping, and installation of signs, legends, and symbols were incorporated. DEI was responsible for the construction, engineering, and inspection of this project, including the maintenance of all construction field records. DEI ensured daily entries were made in the project diary to document the utilization of the contractor's personnel and equipment, the acceptance of work, the assessment of traffic control effectiveness, and the tracking of contract time through the SiteManager.
10/18 – Ongoing	DOTD SP NO. H007271.6: CANAL BOULEVARD (ROBERT E. LEE – AMETHYST) (CE&I): (Role: President/Principal-In-Charge) Dr. Martin oversaw and managed all personnel and contracts involved in the reconstruction of an existing four-lane divided boulevard. The project scope included grading, drainage structures, asphalt pavement milling, pavement patching, Class II base course, scarification and compaction of the roadbed, asphalt concrete pavement, Portland Cement Concrete Pavement, cofferdams, stormwater pumping station, pavement striping, signs, legends, and symbols. DEI was responsible for the construction, engineering, and inspection aspects of this project. Additionally, DEI maintained all construction field records and ensured daily entries were made in the project diary to document the contractor's personnel and equipment utilization, acceptance of work, adequacy of traffic control, and tracking of contract time through the SiteManager.
09/16 – 02/17	DOTD SP NO. H.007277: LAKE FOREST BOULEVARD (CE&I): (Role: President/Principal-In-Charge) Dr. Martin oversaw and managed all personnel and contracts involved in the construction of approximately 638 LF of Portland Cement Concrete Pavement with barrier curb, barrier rails, and a retaining wall. The project included the installation of drainage pipes and structures and tie-in to the existing Westbound concrete pavement at Lake Forest Boulevard. Additionally, approximately 624 LF of the existing Eastbound asphaltic concrete pavement on Lake Forest Boulevard was removed through milling and overlaid with a 2" asphaltic concrete wearing course, achieving a 2.5% cross slope. Pavement striping, and installation of signs, legends, and symbols were part of the project scope. DEI was responsible for the construction, engineering, and inspection, ensuring that all construction field records were maintained. DEI ensured daily entries in the project diary, documenting the utilization of contractor's personnel and equipment, acceptance of work, assessment of traffic control, and recording of contract time through the SiteManager.
01/24 - Ongoing	DOTD SP NO. H.014642.5 : PR 929: US 61 - LA 42 (CE&I): (Role: President/Principal-In-Charge) Dr. Martin oversaw and managed all personnel and contracts involved in the construction of approximately 2.7 miles on PR 929, extending from its intersection with Route US 61 to Parker Rd. in Ascension Parish. His duties included construction management, overseeing daily construction operations, and ensuring compliance with project specifications. The project scope included milling asphalt concrete, pavement patching, and asphalt overlay. Mr. Gillen ensured the accuracy of construction field records, coordinated utility adjustments, and handled the inspection of contractor activities. He also contributed to preparing final estimates, processing change orders, and managing the project's closeout documentation.
07/24 - Ongoing	DOTD SP NO. H.013267.6: SCOTLANDVILLE PKWY TO DOWNTOWN BR TRAIL-PHASE 1: (Role: President/Principal-In-Charge) Dr. Martin oversaw and managed all personnel and contracts involved in the construction for Phase 1 of the Scotlandville Parkway to Downtown Baton Rouge Trail project, which spans approximately 2.8 miles along US 61 and US 61-X in East Baton Rouge Parish. His responsibilities included daily inspections of the contractor's operations to ensure compliance with project specifications. He also managed construction field records, including daily entries for contractor personnel, equipment, work acceptance, and traffic control. Mr. Gillen coordinated with the Jefferson Parish Engineer/Representative for utility and drainage structure adjustments, prepared final estimate packages, and handled change orders. Additionally, he processed contractor invoices and worked on project closeout documentation in alignment with LADOTD requirements.
07/14 – 01/18	DOTD SP. H.006568: WASHINGTON AVE. PEDESTRIAN CROSSING XAVIER UNIVERSITY: Dr. Martin was responsible for overseeing and managing all personnel and contracts for constructing an elevated pedestrian crossing over Washington Avenue, Washington Avenue Canal, and Drexel Drive. Also included was the construction of an enclosed stairway and elevator towers located at the corner of Fern Street and Washington Avenue and Drexel Dr. near the north campus of Xavier University. The entire construction contract administration and construction engineering and inspection for this project was managed through LaDOTD SiteManager Program.

Firm employed by		Design Engineering, Inc.		
Name	John Holtgreve, P.E.	Years of relevant experience with this employer	38	
Title	Project Manager	Years of relevant experience with other employer(s)	12	
Degree(s) / Years / Specialization		Tulane University: MCE, Civil Engineering 1975 Tulane University: BS, Civil Engineering 1970		
Active registration number / state / expiration date		16383 /LA/ 03/31/2025		
Year registered	1976	Discipline	Civil Engineer	
Contract role(s) / brief description of responsibilities		Mr. Holtgreve will serve as the Project QA/QC for this contract. Mr. Holtgreve has performed CE&I on projects in Kenner for over 30 years. On this project he will be available for guidance and direction when any out of the order issues arise. He will also review submittals and RFI responses for quality control.		
Experience dates (mm/yy–mm/yy)	Experience and qualifications relevant to the proposed contract; <i>i.e.</i> , “designed drainage”, “designed girders”, “designed intersection”, etc. Experience dates should cover the years of experience specified in the applicable MPR(s).			
01/24 - Ongoing	DOTD SP NO. H.014642.5 : PR 929: US 61 - LA 42 (CE&I): (Role: Project Manager) Mr. Holtgreve was responsible for overseeing the construction administration for the reconstruction of approximately 2.7 miles on PR 929, extending from its intersection with Route US 61 to Parker Rd. in Ascension Parish. His duties included construction management, overseeing daily construction operations, and ensuring compliance with project specifications. The project scope included milling asphalt concrete, pavement patching, and asphalt overlay. Mr. Gillen ensured the accuracy of construction field records, coordinated utility adjustments, and handled the inspection of contractor activities. He also contributed to preparing final estimates, processing change orders, and managing the project's closeout documentation.			
07/24 - Ongoing	DOTD SP NO. H.013267.6: SCOTLANDVILLE PKWY TO DOWNTOWN BR TRAIL-PHASE 1: (Role: Project Manager) Mr. Holtgreve was responsible for overseeing the construction administration for Phase 1 of the Scotlandville Parkway to Downtown Baton Rouge Trail project, which spans approximately 2.8 miles along US 61 and US 61-X in East Baton Rouge Parish. His responsibilities included daily inspections of the contractor's operations to ensure compliance with project specifications. He also managed construction field records, including daily entries for contractor personnel, equipment, work acceptance, and traffic control. Mr. Gillen coordinated with the Jefferson Parish Engineer/Representative for utility and drainage structure adjustments, prepared final estimate packages, and handled change orders. Additionally, he processed contractor invoices and worked on project closeout documentation in alignment with LADOTD requirements.			
12/23 - Ongoing	DOTD SP NO. H.014681.6: NINE MILE POINT RD: US 90 - LA 18: (Role: Project Manager) Mr. Holtgreve was responsible for overseeing the reconstruction of approximately 1.542 miles of Nine Mile Point Road in Jefferson Parish. The project involved tasks such as grading, milling asphalt pavement, patching, installing Class II base course, and constructing fiber-reinforced asphalt concrete. Additional work included roadbed scarification and compaction, setting up drainage structures, ensuring proper pavement striping, and installing signs, legends, and symbols. DEI provided construction engineering and inspection services, including maintaining construction field records. Daily project diary entries tracked contractor personnel, equipment usage, work acceptance, traffic control evaluation, and contract time management through SiteManager.			
09/23 - Ongoing	DOTD SP NO. H.011779: POWER BLVD. MEDIAN IMPROVEMENTS (WEST ESPLANADE AVE. – VINTAGE DR.): (Role: Project Manager) Mr. Holtgreve was responsible for overseeing the construction administration for the creation of a bike/pedestrian path along the median area of Power Blvd. between West Esplanade Ave. and Vintage Drive in the City of Kenner. The project includes concrete paving, excavation, drainage, bridge construction, lighting, landscaping, striping, and the installation of amenities such as drinking water fountains.			

04/19 – Ongoing	DOTD SP NO. H.011795: WESTWOOD DRIVE (WB EXPRESSWAY. TO LAPALCO) (CE&I): (Role: Project Manager) Mr. Holtgreve was responsible for overseeing the construction of 0.648 miles of roadway, which included 20,516 SY of Portland Cement Concrete Pavement with barrier curb, mountable curb, and gutter, including Class II base course, drainage pipes and structures, sanitary sewer and related work, and tie-in to the existing Westbank Expressway on the north end and Lapalco Blvd. on the south end. Pavement striping, signs, legends, and symbols were also included. DEI was responsible for the construction, engineering, and inspection of this project, including maintaining all construction field records. DEI made daily entries in the project diary to indicate the contractor's personnel and equipment being utilized on the project, the acceptance of work, the evaluation of traffic control, and the tracking of contract time through the Site Manager.
10/18 – Ongoing	DOTD SP NO. H007271.6: CANAL BOULEVARD (ROBERT E. LEE – AMETHYST) (CE&I): (Role: Project Manager) Mr. Holtgreve was responsible for overseeing the reconstruction of an existing four (4) lane-divided boulevard. The project entailed various tasks such as grading, managing drainage structures, milling asphalt pavement, patching pavement, implementing Class II base course, scarifying and compacting the roadbed, constructing asphalt concrete pavement and Portland Cement Concrete Pavement, setting up cofferdams, establishing a stormwater pumping station, ensuring proper pavement striping, and installing signs, legends, and symbols. DEI was responsible for the construction, engineering, and inspection of this project, which included maintaining all construction field records. DEI made daily entries in the project diary to indicate the contractor's personnel and equipment being utilized on the project, the acceptance of work, the evaluation of traffic control, and the tracking of contract time through the Site Manager.
09/16 – 02/17	DOTD SP NO. H.007277: LAKE FOREST BOULEVARD (CE&I): (Role: Project Manager) Mr. Holtgreve was responsible for overseeing the construction of approximately 638 LF of Portland Cement Concrete Pavement with barrier curb, barrier rails, and a retaining wall, including drainage pipes and structures, and tie-in to the existing Westbound concrete pavement at Lake Forest Boulevard. Approximately 624 LF of the existing Eastbound asphaltic concrete pavement on Lake Forest Boulevard was removed by milling and overlaid with a 2" asphaltic concrete wearing course, developing a 2.5% cross slope. Pavement striping, signs, legends, and symbols were included.
05/08 – 12/16	SP NO. H.002550: MACARTHUR DRIVE INTERCHANGE COMPLETION (ON AND OFF RAMPS FOR PETERS ROAD) PHASE II: (Role: Project Manager) Mr. Holtgreve oversaw the demolition of one on-ramp, the construction of two ramps (one on-ramp and one off-ramp), and the relocation and widening of the service road to accommodate the new ramps. The existing Manhattan Boulevard off-ramp to Manhattan Boulevard was demolished and rebuilt several hundred feet west of the existing location to make room for the new Peters Road on-ramp. The ramps were constructed using prestressed concrete trapezoidal box girders supported on single pier bents with pile footings to match the aesthetics of the existing Westbank Expressway bridges.
11/09 – 02/11	DOTD SP NO. 742-36-0110: ROBERT E. LEE BOULEVARD, PARIS AVE. TO PRATT DRIVE: (Role: Project Manager) Mr. Holtgreve oversaw the design and construction administration of the reconstruction of 4,500 LF of the existing Robert E. Lee Blvd. This included major subsurface drainage improvements from 15" \varnothing to 60" \varnothing of reinforced concrete pipe and utility relocations. DEI provided full construction management services for the LADOTD and the City of New Orleans. The entire construction contract administration and construction engineering and inspection for this project were managed through the LADOTD Site Manager Program.
11/09 - 11/11	DOTD SP NO. 742-36-0117: FLEUR DE LIS DRIVE RECONSTRUCTION, VETERANS BLVD. TO N. OF 30TH STREET (CE&I): (Role: Project Manager) Mr. Holtgreve was responsible for overseeing the construction management with Critical Path Scheduling and Primavera P6 software, as well as construction inspection services for the construction of the roadway water line replacement, utility relocations, and sewer line replacement. The entire construction contract administration and construction engineering and inspection for this project were managed through the LADOTD Site Manager Program.

Firm employed by		Design Engineering, Inc.			
Name	Taylor Hebert, P.E.		Years of relevant experience with this employer		2
Title	Civil Engineer		Years of relevant experience with other employer(s)		8
Degree(s) / Years / Specialization		University of Georgia: BS, Civil Engineering 2016			
Active registration number / state / expiration date		44720 /LA/09/30/2026			
Year registered	2020	Discipline	Civil Engineer		
Contract role(s) / brief description of responsibilities		Mr. Hebert will serve as Project Engineer for this contract. Mr. Hebert will be directly responsible for the RFIs, Submittals, Schedule Reviews, Pay Application Approval, and all other office specific tasks required by the CE&I Company.			
Experience dates (mm/yy–mm/yy)	Experience and qualifications relevant to the proposed contract; <i>i.e.</i> , “designed drainage”, “designed girders”, “designed intersection”, etc. Experience dates should cover the years of experience specified in the applicable MPR(s).				
09/23 - Ongoing	DOTD SP NO. H.011779: POWER BLVD. MEDIAN IMPROVEMENTS (WEST ESPLANADE AVE. – VINTAGE DR.): (Role: Civil Engineer) Mr. Hebert assisted with the construction administration and inspection of approximately 4,800 LF of a bike/pedestrian path along the median area of Power Blvd. between West Esplanade Ave. and Vintage Drive located in the City of Kenner. The project includes clearing and grubbing, grading, drainage structures, pavement patching, class ii base course, precast concrete piles, lighting, concrete walks, landscaping, pedestrian bridge, and related work.				
09/23 - Ongoing	DOTD SP. NO. H.014317.6: CAREY STREET PAVEMENT REHABILITATION (CE&I): (Role: Civil Engineer) Mr. Hebert assisted in the construction administration of the reconstruction of 3,500 linear feet of residential concrete panel roadway on Carey St. from Old Spanish Trail to Front Street, located in the City of Slidell. Responsibilities include construction management, document control, and meeting coordination. The project involves grading, Class II base course installation, Portland Cement Concrete Pavement (PCCP), and associated work. The project included extensive roadway and utility improvements, such as drainage structures, pavement replacement, and utility upgrades.				
05/23 - Ongoing	DOTD SP NO. H.014315.6: GRAFTON DRIVE PAVEMENT REHABILITATION (CE&I): (Role: Civil Engineer) Mr. Hebert assisted in the construction administration of the reconstruction of the reconstruction of Grafton Drive from Cardinal Drive to E. Pinewood Drive, located in the City of Slidell. Responsibilities include construction management, document control, and meeting coordination. This project includes the removal of curbs, concrete pavement, grading, Class II base course, Portland cement concrete pavement, and related work. The scope of work also entails addressing issues related to traffic maintenance, joint sealing, and curb ramp improvements to enhance the overall safety and accessibility of Grafton Drive.				

12/23 - Ongoing	<p>DOTD SP NO. H.014681.6: NINE MILE POINT RD: US 90 - LA 18: (Role: Civil Engineer) Mr. Hebert assisted in the construction administration for the reconstruction of Nine Mile Point Road (US 90 – LA 18) in Jefferson Parish. His responsibilities included construction management, document control, and coordination of meetings. The project involved grading, milling asphalt pavement, patching, installing Class II base course, and constructing fiber-reinforced asphalt concrete. Mr. Hebert helped address traffic control issues, monitored the work for compliance with specifications, and supported efforts to ensure the project was completed efficiently and safely.</p>
01/24 – Ongoing	<p>DOTD SP NO. H.011775.6 : US 11 & US 190 BICYCLE AND PED CROSSINGS (CE&I): (Role: Civil Engineer) Mr. Hebert assisted in the construction administration for the improvement of 0.163 miles of roadway at the intersection of US 11 (Front St.) and US 190B (Fremaux Ave.) in Slidell, St. Tammany Parish. His responsibilities included construction management, document control, and coordination of meetings. The project involved clearing and grubbing, drainage structure installation, milling asphalt, pavement patching, and the application of Portland cement concrete and asphalt concrete overlays. Mr. Hebert monitored daily construction operations, ensured adherence to project specifications, and addressed any issues related to traffic control and utility adjustments, ensuring the project met quality standards and stayed on schedule.</p>
01/24 - Ongoing	<p>DOTD SP NO. H.014642.5 : PR 929: US 61 - LA 42 (CE&I):(Role: Civil Engineer) Mr. Hebert supported the construction administration for the reconstruction of approximately 2.7 miles on PR 929, extending from its intersection with Route US 61 to Parker Rd. in Ascension Parish. His duties included construction management, overseeing daily construction operations, and ensuring compliance with project specifications. The project scope included milling asphalt concrete, pavement patching, and asphalt overlay. Mr. Hebert ensured the accuracy of construction field records, coordinated utility adjustments, and handled the inspection of contractor activities. He also contributed to preparing final estimates, processing change orders, and managing the project's closeout documentation.</p>

Firm employed by		Design Engineering, Inc.			
Name	Collin Gillen, P.E.		Years of relevant experience with this employer		5
Title	Civil Engineer		Years of relevant experience with other employer(s)		0
Degree(s) / Years / Specialization		Louisiana State University: BS, Civil Engineering 2020			
Active registration number / state / expiration date		49017 /LA/ 09/30/2026			
Year registered	2024	Discipline	Civil Engineer		
Contract role(s) / brief description of responsibilities		Mr. Gillen will serve as Civil Engineer and deputy Project Engineer for this contract. He has performed CE&I on DOTD contracts in Kenner, including 2024 and 2025. The LPA has voiced outstanding reviews of his work.			
Experience dates (mm/yy–mm/yy)	Experience and qualifications relevant to the proposed contract; <i>i.e.</i> , “designed drainage”, “designed girders”, “designed intersection”, etc. Experience dates should cover the years of experience specified in the applicable MPR(s).				
09/23 - Ongoing	DOTD SP NO. H.011779: POWER BLVD. MEDIAN IMPROVEMENTS (WEST ESPLANADE AVE. – VINTAGE DR.): (Role: Civil Engineer) Mr. Gillen is performing inspection oversight, quality assurance, and construction administration for the creation of a bike/pedestrian path along the median area of Power Blvd. between West Esplanade Ave. and Vintage Drive located in the City of Kenner. The project includes concrete paving, excavation, drainage, bridge construction, lighting, landscaping, striping, and the installation of amenities such as drinking water fountains.				
09/23 - Ongoing	DOTD SP. NO. H.014317.6: CAREY STREET PAVEMENT REHABILITATION (CE&I): (Role: Civil Engineer) Mr. Gillen is currently assisting the project engineer in the construction administration of the reconstruction of approximately 3,500 linear feet of primarily residential concrete panel roadway on Carey St. from Old Spanish Trail to Front Street, located in the City of Slidell. Responsibilities include construction management, document control, and meeting coordination. The project involves grading, Class II base course installation, Portland Cement Concrete Pavement (PCCP), and associated work.				
05/23 - Ongoing	DOTD SP NO. H.014315.6: GRAFTON DRIVE PAVEMENT REHABILITATION (CE&I): (Role: Civil Engineer) Mr. Gillen is currently assisting the project engineer in the construction administration of the reconstruction of Grafton Drive from Cardinal Drive to E. Pinewood Drive, located in the City of Slidell. Responsibilities include construction management, document control, and meeting coordination. This project includes the removal of curbs, concrete pavement, grading, Class II base course, Portland cement concrete pavement, and related work. The scope of work also entails addressing issues related to traffic maintenance, joint sealing, and curb ramp improvements to enhance the overall safety and accessibility of Grafton Drive.				
03/21 – 07/22	DOTD SP NO. H.007276.6: MAGAZINE ST. (LEAKE AVE TO EAST DRIVE) (CE&I): (Role: Civil Engineer) Mr. Gillen is currently assisting the project engineer in the construction administration of the reconstruction of Magazine Street, between the intersections of Leake Avenue and East Drive, located in the Audubon Neighborhood area of New Orleans. Responsibilities include construction management, document control, and meeting coordination. This project also includes full reconstruction and will involve full block roadway pavement replacement, including resetting distinctive aggregate curbs, ADA accessible ramps, drainage system replacement, sidewalk, driveway, sewer line, and water main utility replacement. This project is also coordinated with Hard Rock Construction throughout the construction process.				

07/24 - Ongoing	DOTD SP NO. H.013267.6: SCOTLANDVILLE PKWY TO DOWNTOWN BR TRAIL-PHASE 1: (Role: Civil Engineer) Mr. Gillen assisted in the construction administration for Phase 1 of the Scotlandville Parkway to Downtown Baton Rouge Trail project, which spans approximately 2.8 miles along US 61 and US 61-X in East Baton Rouge Parish. His responsibilities included daily inspections of the contractor's operations to ensure compliance with project specifications. He also managed construction field records, including daily entries for contractor personnel, equipment, work acceptance, and traffic control. Mr. Gillen coordinated with the Jefferson Parish Engineer/Representative for utility and drainage structure adjustments, prepared final estimate packages, and handled change orders. Additionally, he processed contractor invoices and worked on project closeout documentation in alignment with LADOTD requirements.
05/20 – Ongoing	DOTD SP NO. H.011795: WESTWOOD DRIVE (WESTBANK EXPRESSWAY - LAPALCO): (Role: Civil Engineer) Mr. Gillen performed inspection oversight, quality assurance, and construction administration for the construction of 0.648 miles of roadway, which included 20,516 SY of Portland Cement Concrete Pavement with barrier curb, mountable curb and gutter. This project included Class II base course, drainage pipes and structures, sanitary sewer and related work, and tie-in to the existing Westbank Expressway on the north end and Lapalco Blvd. on the south end. Pavement striping, signs, and legends and symbols were also included.
01/24 – Ongoing	DOTD SP NO. H.011775.6 : US 11 & US 190 BICYCLE AND PED CROSSINGS (CE&I): (Role: Civil Engineer) Mr. Gillen assisted in the construction administration for the improvement of 0.163 miles of roadway at the intersection of US 11 (Front St.) and US 190B (Fremaux Ave.) in Slidell, St. Tammany Parish. His responsibilities included construction management, document control, and coordination of meetings. The project involved clearing and grubbing, drainage structure installation, milling asphalt, pavement patching, and the application of Portland cement concrete and asphalt concrete overlays. Mr. Gillen monitored daily construction operations, ensured adherence to project specifications, and addressed any issues related to traffic control and utility adjustments, ensuring the project met quality standards and stayed on schedule.
01/24 - Ongoing	DOTD SP NO. H.014642.5 : PR 929: US 61 - LA 42 (CE&I): (Role: Civil Engineer) Mr. Gillen supported the construction administration for the reconstruction of approximately 2.7 miles on PR 929, extending from its intersection with Route US 61 to Parker Rd. in Ascension Parish. His duties included construction management, overseeing daily construction operations, and ensuring compliance with project specifications. The project scope included milling asphalt concrete, pavement patching, and asphalt overlay. Mr. Gillen ensured the accuracy of construction field records, coordinated utility adjustments, and handled the inspection of contractor activities. He also contributed to preparing final estimates, processing change orders, and managing the project's closeout documentation.
12/23 - Ongoing	DOTD SP NO. H.014681.6: NINE MILE POINT RD: US 90 - LA 18: (Role: Civil Engineer) Mr. Gillen assisted in the construction administration for the reconstruction of Nine Mile Point Road (US 90 – LA 18) in Jefferson Parish. His responsibilities included construction management, document control, and coordination of meetings. The project involved grading, milling asphalt pavement, patching, installing Class II base course, and constructing fiber-reinforced asphalt concrete. Mr. Hebert helped address traffic control issues, monitored the work for compliance with specifications, and supported efforts to ensure the project was completed efficiently and safely.

Firm employed by Design Engineering, Inc.					
Name	Jay Rafferty		Years of relevant experience with this employer		5
Title	Construction Manager		Years of relevant experience with other employer(s)		27
Degree(s) / Years / Specialization		Southeastern Louisiana University: Industrial Technology 1997 Troxler Radiation Safety and Nuclear Testing Equipment Course 8/17/10, Army Corps of Engineers Construction Management Quality Course 11/2/12, Supervisor Compliance Training Department, Supervisor Course 6/6/14, Completed ATSSA Work Zone Traffic Control Technician, Supervisor, and Flagger			
Active registration number / state / expiration date		N/A			
Year registered	N/A	Discipline	N/A		
Contract role(s) / brief description of responsibilities		Jay Rafferty will serve as the Project Office Manager for this contract. Mr. Rafferty is a Certified DOTD inspector who will coordinate field operations on the Project. He will make sure that Headlight and SightManager are up to date and that on days when the primary inspector is unavailable that the project is appropriately staffed either by the secondary inspector or by himself.			
Experience dates (mm/yy–mm/yy)	Experience and qualifications relevant to the proposed contract; i.e., “designed drainage”, “designed girders”, “designed intersection”, etc. Experience dates should cover the years of experience specified in the applicable MPR(s).				
09/23 - Ongoing	DOTD SP NO. H.011779: POWER BLVD. MEDIAN IMPROVEMENTS (WEST ESPLANADE AVE. – VINTAGE DR.): (Role: Construction Manager) Mr. Rafferty provided resident inspection for the creation of a bike/pedestrian path along the median area of Power Blvd. between West Esplanade Ave. and Vintage Drive located in the City of Kenner. The project includes concrete paving, excavation, drainage, bridge construction, lighting, landscaping, striping, and the installation of amenities such as drinking water fountains. Mr. Rafferty’s responsibilities for this project were to ensure that the resident inspector prepared daily reports, inspected the progress of the work to ensure that the Contractor complied with the requirements of the plans and specifications, and attended all the progress meetings.				
05/23 - Ongoing	DOTD SP NO. H.014315.6: GRAFTON DRIVE PAVEMENT REHABILITATION (CE&I): (Role: Construction Manager) Mr. Rafferty provided resident inspection for the roadway reconstruction project consisting of the removal of curbs, concrete pavement, grading, Class II base course, Portland cement concrete pavement, and related work. The scope of work also entails addressing issues related to traffic maintenance, joint sealing, and curb ramp improvements to enhance the overall safety and accessibility of Grafton Drive. Mr. Rafferty’s responsibilities for this project is to ensure that the resident inspector is preparing daily reports, inspecting the progress of the work to ensure that the Contractor complies with the requirements of the plans and specifications, and attending all the progress meetings. He also oversees that the resident inspector is writing in his daily diary items of work performed for the day and the comparison of quantities installed with the Contractor. The entire construction contract administration and construction engineering and inspection for this project are managed through LaDOTD SiteManager.				
04/21 – Ongoing	DOTD SP NO. H.011797: AMES BLVD. (WESTBANK EXPRESSWAY - HAPPY ST.): (Role: Construction Manager) Mr. Rafferty provided resident inspection for 0.39 miles of roadway which included asphalt paving inspection, estimate generation, material sampling, submittal review, and project close-out of Ames Boulevard from the Westbank Expressway to Happy Street. Mr. Rafferty’s responsibilities for this project were to ensure that the resident inspector prepared daily reports, inspected the progress of the work to ensure that the Contractor complied with the requirements of the plans and specifications, and attended all the progress meetings.				

03/21 – 07/22	DOTD SP NO. H.007276.6: MAGAZINE ST. (LEAKE AVE TO EAST DRIVE) (CE&I): (Role: Construction Manager) Mr. Rafferty provided resident inspection for this roadway rehabilitation project consisting of the removal of existing pavement, excavation/embankment, base course, PCC paving, drainage structures, concrete curb, sidewalks & handicap ramps, water & sewer lines, pavement markings, and related work. Mr. Rafferty's responsibilities for this project were to ensure that the resident inspector is preparing daily reports, inspecting the progress of the work to ensure that the Contractor complies with the requirements of the plans and specifications, and attending all the progress meetings. He also oversaw that the resident inspector is writing in his daily diary items of work performed for the day and the comparison of quantities installed with the Contractor. The entire construction contract administration and construction engineering and inspection for this project are managed through LaDOTD SiteManager.
10/18 – Ongoing	DOTD SP NO. H007271.6: CANAL BOULEVARD (ROBERT E. LEE – AMETHYST) (CE&I): (Role: Construction Manager) Mr. Rafferty provided resident inspection for the reconstruction of an existing four-lane divided boulevard. The project scope included grading, drainage structures, asphalt pavement milling, pavement patching, Class II base course, scarification and compaction of the roadbed, asphalt concrete pavement, Portland Cement Concrete Pavement, cofferdams, stormwater pumping station, pavement striping, signs, legends, and symbols. Mr. Rafferty's responsibilities for this project were to ensure that the resident inspector is preparing daily reports, inspecting the progress of the work to ensure that the Contractor complies with the requirements of the plans and specifications, and attending all the progress meetings. He also oversaw that the resident inspector is writing in his daily diary items of work performed for the day and the comparison of quantities installed with the Contractor. The entire construction contract administration and construction engineering and inspection for this project are managed through LaDOTD SiteManager.
05/20 – Ongoing	DOTD SP NO. H.011795: WESTWOOD DRIVE (WB EXPRESSWAY TO LAPALCO): (Role: Construction Manager) Mr. Rafferty was responsible for preparing daily reports, inspecting the progress of the work to ensure that the contractor complied with the requirements of the plans and specifications, and attending all project meetings for the construction of 0.648 miles of roadway. This construction includes 20,516 square yards of Portland Cement Concrete Pavement with barrier curb, mountable curb, and gutter, including Class II base course, drainage pipes and structures, sanitary sewer and related work, and tie-in to the existing Westbank Expressway on the north end and Lapalco Blvd. on the south end. Pavement striping, signs, legends, and symbols are also included. DEI is responsible for the construction, engineering, and inspection of this project, which includes maintaining all construction field records, making daily entries in the project diary to indicate the contractor's personnel and equipment being utilized on the project, the work being accepted, the acceptability of traffic control, and the charging of contract time through Site Manager.
05/19 – Ongoing	DOTD SP NO. H011798.6: AIRLINE PARK BOULEVARD (CAMPHOR TO WEST NAPOLEON): (Role: Construction Manager) Mr. Rafferty provided resident inspection for the construction of 0.390 miles of roadway which includes grading, drainage structures, milling asphalt pavement, pavement patching, class ii base course, scarifying and compacting roadbed, asphalt concrete pavement, Portland Cement Concrete Pavement, cofferdams, storm water pumping station, and related work on Airline Park Boulevard from north of its intersection with Camphor St. to its junction with W. Napoleon Ave. Mr. Rafferty's responsibilities for this project were to ensure that the resident inspector is preparing daily reports, inspecting the progress of the work to ensure that the Contractor complies with the requirements of the plans and specifications, and attending all the progress meetings. He also oversaw that the resident inspector is writing in his daily diary items of work performed for the day and the comparison of quantities installed with the Contractor. The entire construction contract administration and construction engineering and inspection for this project are managed through LaDOTD SiteManager.

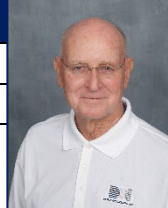
Firm employed by Design Engineering, Inc.					
Name	Wayne "Dickie" Lemoine		Years of relevant experience with this employer		5
Title	Certified Inspector		Years of relevant experience with other employer(s)		50
Degree(s) / Years / Specialization		Certifications: LaDOTD Structural Concrete Inspector, Basic Bridge Safety Inspector's Training, Bridge Inspection Update, Nondestructive Evaluation of Bridge Conditions, Bridge Inspector, Movable Bridge Inspection Training Course, ATSSA Flagger, ATSSA Traffic Control Supervisor, Prager Gear Seminar, Pump and Seal School, Stream Stability and Scour at Highway Bridges for Bridge Inspectors, Hazwoper, Industrial Hydraulics, Deleading of Industrial Structures, Inspection of Fracture Critical Bridge Members			
Active registration number / state / expiration date			N/A		
Year registered	N/A		Discipline	N/A	
Contract role(s) / brief description of responsibilities			Mr. Lemoine will serve as the Secondary Inspector for this project. Mr. Lemoine has over 33 years of experience with the Louisiana Department of Transportation and Development. He will be available to cover the project in the absence of the primary inspector as well as to assist on any questions that may benefit from his wealth of experience.		
Experience dates (mm/yy–mm/yy)	Experience and qualifications relevant to the proposed contract; i.e., “designed drainage”, “designed girders”, “designed intersection”, etc. Experience dates should cover the years of experience specified in the applicable MPR(s).				
12/18 – 7/21	GNOEC NO. 433: SOUTHBOUND CAUSEWAY SAFETY RAIL IMPROVEMENTS (CE&I): (Role: Resident Inspector) Mr. Lemoine performed inspections for the improvement of the existing bridge railing system to MASH Test Level 4, the repair of damaged concrete railing, replacement of impact attenuators, relocation of signs and supports, modification of call boxes, installation of pavement markings, and installation of access platforms. Construction administration included the organization of progress meetings, review of submittals (e.g., Construction Schedules, RFIs, Plan Changes, and Materials), and processing of partial pay estimates. Resident inspection included the observation of construction activities (e.g., 48 miles of bridge rail fabrication and installation, 138,000 epoxied anchor rods, and repair of damaged concrete rail), production of daily reports, review of TTC installation/removal, and review of on-site safety.				
9/13 – 6/16	LA 70 MISSISSIPPI RIVER BRIDGE, PHASE II CE&I, PAINTING INSPECTION, AND ENVIRONMENTAL MONITORING, ST. JAMES PARISH, LA: (Role: Resident Inspector) Mr. Lemoine performed structural steel inspection, traffic control inspection, structural concrete repair inspection, and contract administration for the LA 70 Bridge over the Mississippi River. He coordinated the painting and environmental operations with SiteManager Reports and Daily Work Reports. This project included strengthening steel members, repairing end dams and roadway joints, and painting the steel approaches.				

10/18-06/19	SUNSHINE BRIDGE, DONALDSONVILLE, LA: (Role: Resident Inspector) Mr. Lemoine performed inspections on repairs to the expansion joints on the Sunshine Bridge. Mr. Lemoine also inspected the placement of epoxy in the roadway repair. He was responsible for preparing the daily report and attending all project meetings. Mr. Lemoine also reviewed and processed Contractors' invoices.
06/16- Ongoing	SP NO. 706-99-0004, GNOEC#ER-0004: REPAIRS & REPLACEMENT OF THE 9-MILE TURNAROUND SPANS ON LAKE PONTCHARTRAIN CAUSEWAY, ST. TAMMANY AND JEFFERSON PARISHES, LA.: (Role: Resident Inspector) Mr. Lemoine served as the inspector for pile driving and structural concrete placement. He maintained all the SiteManager records and performed sampling and testing for concrete placements on the decks. The project cost \$2M.
06/17 - Ongoing	CAUSEWAY BRIDGE, METAIRIE, LA: (Role: Resident Inspector) Mr. Lemoine held the position of Senior Bridge Inspector and Coordinator with the Greater New Orleans Expressway Commission. He inspected the installation of the dynamic boards at the Causeway bridge. Additionally, he inspected the reconstruction of the electrical system of the North Toll Plaza Building and the reconstruction of the exit road and parking lot at the North Toll Plaza.
11/07 – 02/13	LOUISIANA TIMED PROGRAM (LTM), STATEWIDE, LA.: (Role: Resident Inspector) Mr. Lemoine was the lead inspector assigned to the Huey P. Long Bridge widening project. He managed and inspected the widening of the current bridge to include three 11-foot travel lanes in each direction, along with inside and outside shoulders. Instead of adding pier foundations for the main river bridge, the construction plans called for the widening of pier shafts above the existing caisson foundations and the addition of two new parallel trusses to accommodate the widened roadway along the main bridge. For the approaches, new parallel structures were built to accommodate the new roadways. The construction cost \$5.2B.
01/71-01/04	Mr. Lemoine was the Maintenance and Inspection Supervisor for the following: <ul style="list-style-type: none"> ➤ Bayou Sarah Swing Bridge ➤ Judge Perez Bridge ➤ Claiborne Avenue Bridge (Judge Seeber Bridge) ➤ Danziger Bridge ➤ US 11 North Draw ➤ Chef Menteur Pass ➤ Houma Navigation Bridge ➤ Bayou Dularge Bridge ➤ Raceland Vertical Lift Bridge ➤ Kerner Swing Bridge ➤ Kraemer Vertical Lift Bridge ➤ La 24 Company Canal Bridge ➤ LaRose Vertical Lift Bridge ➤ Lockport Swing Bridge ➤ Bayou Black Bridge ➤ LA-661 Bayou LaCarpe Bridge ➤ Bayou La Loutre Bridge

Firm employed by Design Engineering, Inc.			
Name	Gary Conerly		Years of relevant experience with this employer
Title	Certified Inspector		Years of relevant experience with other employer(s)
Degree(s) / Years / Specialization		Certifications: LaDOTD Structural Concrete Inspector, Troxler Nuclear Gauge Safety Certification, Toxler Hazmat Certification, ACI Concrete Strength Testing Technician, ACI Concrete Field-Testing Technician – Grade I, ATSSA National Flagger Certification.	
Active registration number / state / expiration date		N/A	
Year registered	N/A	Discipline	N/A
Contract role(s) / brief description of responsibilities		Mr. Conerly will serve as a Certified Inspector for this project. Mr. Conerly will be on site daily to monitor and record all relevant activities to confirm that the contractor is performing his duties in accordance with the Plans and Specifications.	
Experience dates (mm/yy–mm/yy)	Experience and qualifications relevant to the proposed contract; i.e., “designed drainage”, “designed girders”, “designed intersection”, etc. Experience dates should cover the years of experience specified in the applicable MPR(s).		
09/23 - Ongoing	DOTD SP NO. H.011779: POWER BLVD. MEDIAN IMPROVEMENTS (WEST ESPLANADE AVE. – VINTAGE DR.): (Role: Resident Inspector) Mr. Conerly is currently performing inspections for approximately 4,800 LF of the creation of a bike/pedestrian path along the median area of Power Blvd. between West Esplanade Ave. and Vintage Drive located in the City of Kenner. The project includes clearing and grubbing, grading, drainage structures, pavement patching, class ii base course, precast concrete piles, lighting, concrete walks, landscaping, pedestrian bridge, and related work. Mr. Conerly prepares daily reports, which are recorded through the LADOTD Site Manager system, inspects the progress of the work to ensure that the Contractor complies with the requirements of the plans and specifications, and attends all the progress meetings. Mr. Conerly writes in his daily diary items of work performed for the day and the comparison of quantities installed with the Contractor.		
12/23 - Ongoing	DOTD SP NO. H.014681.6: NINE MILE POINT RD: US 90 - LA 18: (Role: Resident Inspector) Mr. Conerly is currently performing inspections for the reconstruction of approximately 1.542 miles of Nine Mile Point Road, located in Jefferson Parish. The project includes grading, milling asphalt concrete, pavement patching, Class II base course, fiber-reinforced asphalt concrete, and related road improvements. Mr. Conerly ensures that the construction activities comply with the project plans and specifications by inspecting the contractor’s work daily. He also prepares daily reports recorded through the LADOTD Site Manager system, documenting the contractor’s personnel and equipment used, the work completed, and comparing installed quantities with the contractor’s reports. Additionally, Mr. Conerly attends progress meetings and monitors the contractor’s adherence to the schedule and traffic control measures.		
10/19 – 09/21	SEVERN AVENUE: VETERANS - W. ESPLANADE: (Role: Resident Inspector) Mr. Conerly provided resident inspection for the removal and replacement of roadway, sidewalks, ADA ramps, pedestrian crosswalks, and the installation of cross signals of Severn Ave. As part of the Statewide Transportation Improvement Program (STIP), the project aimed to enhance pedestrian safety in response to increased traffic. Mr. Conerly conducted concrete inspections, soils testing, compaction testing, and vibration monitoring. Mr. Conerly inspected the progress of the work to ensure that the Contractor complies with the requirements of the plans and specifications.		

11/12 – 12/16	SP NO. H.002550: MACARTHUR DRIVE INTERCHANGE COMPLETION: (Role: Resident Inspector) Mr. Conerly served as the Resident Inspector for the MacArthur Interchange project, overseeing critical aspects of construction. Mr. Conerly's role focused on concrete maturity, density, and strength inspections. His responsibilities included monitoring the demolition, pile installations, and coordination with geotechnical engineers. Mr. Conerly's expertise contributed significantly to ensuring the project's compliance with LaDOTD and FHWA requirements.
09/13 – 12/13	HUEY P. LONG BRIDGE: (Role: Resident Inspector) Mr. Conerly oversaw the inspection of the Huey P. Long Bridge widening project, executed in multiple phases. The project transformed the two-lane bridge into three 11-foot travel lanes in each direction, with inner and outer shoulders. The construction plans avoided additional pier foundations for the main bridge, opting for the widening of pier shafts above existing caisson foundations. Two new parallel trusses were added to support the expanded roadway on the main bridge, while new parallel structures were built for the approaches. Mr. Conerly prepared daily reports, recorded through the project management system, ensuring compliance with plans and specifications. His daily diary documented work progress, including a detailed comparison of installed quantities with contractual specifications.
07/24 - Ongoing	DOTD SP NO. H.013267.6: SCOTLANDVILLE PKWY TO DOWNTOWN BR TRAIL-PHASE 1: (Role: Resident Inspector) Mr. Conerly is performing inspections for Phase 1 of the Scotlandville Parkway to Downtown Baton Rouge Trail project, which spans approximately 2.8 miles along US 61 and US 61-X in East Baton Rouge Parish. The project involves significant roadway and infrastructure improvements to enhance connectivity and safety for pedestrians and cyclists. Mr. Conerly inspects daily construction operations, ensuring that the work complies with project specifications. He also maintains detailed daily reports, recorded through the LADOTD Site Manager system, documenting contractor personnel, equipment, and work progress. Mr. Conerly attends all progress meetings and tracks installed quantities against contractor reports. His role also includes reviewing and ensuring proper traffic control measures are in place during construction.
01/24 – Ongoing	DOTD SP NO. H.011775.6 : US 11 & US 190 BICYCLE AND PED CROSSINGS (CE&I): (Role: Resident Inspector) Mr. Conerly is currently performing inspections for the roadway improvements along US 11 (Front St.) and US 190B (Fremaux Ave.) in Slidell, St. Tammany Parish. The project includes clearing and grubbing, drainage structures, milling asphalt concrete, pavement patching, Class II base course, Portland cement concrete pavement, asphalt concrete overlay, and related work. Mr. Conerly prepares daily reports recorded through the LADOTD Site Manager system, inspects the progress of the work to ensure compliance with the project's specifications, and attends progress meetings. He maintains a daily diary to document the work performed, the quantities installed, and the comparison with the contractor's reports.
01/24 - Ongoing	DOTD SP NO. H.014642.5 : PR 929: US 61 - LA 42 (CE&I): (Role: Resident Inspector) Mr. Conerly is currently performing inspections for the reconstruction of approximately 2.7 miles of roadway along PR 929, from its intersection with US 61 to its intersection with Parker Rd. The project includes milling asphalt concrete, pavement patching, asphalt concrete overlay, and related work. Mr. Conerly prepares daily reports through the LADOTD Site Manager system, inspects the progress of the work to ensure compliance with the plans and specifications, and attends all progress meetings. He maintains a daily diary, documenting the work performed each day and comparing the quantities installed with the contractor's reports.

Firm employed by Eustis Engineering L.L.C.				
Name	Travis R. Richards, P.E.		Years of relevant experience with this employer	18
Title	Vice President of Testing and Senior Project Manager		Years of relevant experience with other employer(s)	7
Degree(s) / Years / Specialization		Graduate Certificate / 2018 / Coastal Engineering Master of Science / 2017 / Engineering Master of Science / 2015 / Engineering Management Bachelor of Science / 1998 / Civil Engineering		
Active registration number / state / expiration date		License No. 30992 / Louisiana / 3-31-2025		
Year registered	2004	Discipline	Civil Engineering	
Contract role(s) / brief description of responsibilities		Mr. Richards is responsible for the technical functions/performance of the soil mechanics' laboratory. As a Professional Engineer in Civil Engineering registered in Louisiana, with more than five years' experience and comparable experience in the testing and acceptance of construction materials on LaDOTD projects, with the exception of being employed by the Prime Consultant, he fulfills Item Nos. 1, and 2 of the Minimum Personnel Requirements in this Advertisement.		
Experience dates (mm/yy–mm/yy)	Experience and qualifications relevant to the proposed contract; <i>i.e.</i> , “designed drainage”, “designed girders”, “designed intersection”, etc. Experience dates should cover the years of experience specified in the applicable MPR(s).			
11/21 – 02/23	LADOTD, NEW MAGAZINE STREET IMPROVEMENTS BETWEEN LEAKE AVENUE TO AVENUE EAST DRIVE, NEW ORLEANS, LOUISIANA (24689): This project involved the reconstruction of Magazine Street in New Orleans, Louisiana. Our services included testing and inspection of earthwork and concrete. Mr. Richards reviewed the concrete mix design report.			
07/21 – 08/21	LADOTD, AMES BOULEVARD BETWEEN THE WEST BANK EXPRESSWAY AND HAPPY STREET, JEFFERSON PARISH, LOUISIANA (24631): Eustis Engineering completed concrete and asphalt testing and inspection services for this project. As the project manager, Mr. Richards reviewed the reports and provided quality control checks of our services.			
08/18 – 11/18	LADOTD, GIRDER SPAN BRIDGE REPAIRS, EARHART EXPRESSWAY AND CLEARVIEW PARKWAY INTERCHANGE, METAIRIE, LOUISIANA (23954): This project included quality control inspections and testing of concrete and grout, as well as a special inspector for high strength grout. Mr. Richards was Project Manager for this work.			

Firm employed by Eustis Engineering L.L.C.			
Name	Chad M. Ortolano		Years of relevant experience with this employer
Title	Senior CMT Technician		Years of relevant experience with other employer(s)
Degree(s) / Years / Specialization		High School Graduate / 2007	
Active registration number / state / expiration date		N/A	
Year Registered	N/A	Discipline	N/A
Contract role(s) / brief description of responsibilities		Mr. Ortolano will be able to provide a variety of CMT services for this project if needed. He is an ACI-certified concrete field-testing technician, has NICET CMT certifications in Soil, Asphalt, and Concrete (Level II for all), and holds a HAZMAT Certification for Nuclear Gauges. He was previously certified as a Traffic Control Supervisor by ATSSA and can be recertified, if needed.	
Experience dates (mm/yy–mm/yy)	Experience and qualifications relevant to the proposed contract; <i>i.e.</i> , “designed drainage”, “designed girders”, “designed intersection”, etc. Experience dates should cover the years of experience specified in the applicable MPR(s).		
11/21 – 02/23	LADOTD, NEW MAGAZINE STREET IMPROVEMENTS BETWEEN LEAKE AVENUE TO AVENUE EAST DRIVE, NEW ORLEANS, LOUISIANA (24689): This project involved the reconstruction of Magazine Street in New Orleans, Louisiana. Our services included testing and inspection of earthwork and concrete. Mr. Ortolano and the Eustis team performed in-place density tests throughout the project area.		
08/18 – 11/18	LADOTD - GIRDER SPAN BRIDGE REPAIRS, EARHART EXPRESSWAY AND CLEARVIEW PARKWAY INTERCHANGE, METAIRIE, LOUISIANA (23954): The scope of work for this project included soil mechanics laboratory tests, in-place nuclear density tests, concrete inspections, compressive strength testing of concrete cylinders, and asphalt pavement cores at 172 locations to the approximate 12-in. depth. Mr. Ortolano performed in-place density tests and concrete inspection services on this project on an as-needed basis.		

Firm employed by Eustis Engineering L.L.C.			
Name	Jonathan B. Jadrich		Years of relevant experience with this employer
Title	Senior CMT Technician		Years of relevant experience with other employer(s)
Degree(s) / Years / Specialization		Bachelor of Science / 1993 / Physics	
Active registration number / state / expiration date		N/A	
Year registered	N/A	Discipline	N/A
Contract role(s) / brief description of responsibilities		Mr. Jadrich will be able to provide a variety of CMT services for this project. His main area of expertise includes concrete inspection, in-place density tests, masonry inspection, rebar inspection and site inspection. Additionally, Mr. Jadrich assists our laboratory on an as-needed basis.	
Experience dates (mm/yy–mm/yy)	Experience and qualifications relevant to the proposed contract; <i>i.e.</i> , “designed drainage”, “designed girders”, “designed intersection”, etc. Experience dates should cover the years of experience specified in the applicable MPR(s).		
11/21 – 02/23	LADOTD, AMES BOULEVARD BETWEEN THE WEST BANK EXPRESSWAY AND HAPPY STREET, JEFFERSON PARISH, LOUISIANA (24689): This project involved the reconstruction of Magazine Street in New Orleans, Louisiana. Our services included testing and inspection of earthwork and concrete. Mr. Jadrich and the Eustis team performed in-place density tests throughout the project area. He dedicated nearly 60 hours to the project.		
07/21 – 08/21	LADOTD, AMES BOULEVARD BETWEEN THE WEST BANK EXPRESSWAY AND HAPPY STREET, JEFFERSON PARISH, LOUISIANA (24631): This project involved renovations and upgrades to a section of the roadway pavement along Ames Boulevard between the West Bank Expressway and Happy Street in Jefferson Parish. Eustis Engineering was brought in to provide construction materials testing and inspection services during the laying of asphalt and concrete. Mr. Jadrich assisted with asphalt and concrete inspections.		
08/18 – 11/18	LADOTD, GIRDER SPAN BRIDGE REPAIRS, EARHART EXPRESSWAY AND CLEARVIEW PARKWAY INTERCHANGE, METAIRIE, LOUISIANA (23954): This project included quality control inspections and testing of concrete and grout, as well as a special inspector for high strength grout. Mr. Jadrich took part in the fieldwork activities.		

17. Firm Experience:

Firm name	Design Engineering, Inc.		Past Performance Evaluation Discipline(s)*	Road, CE&I/OV
Project name	POWER BLVD. MEDIAN IMPROVEMENTS (WEST ESPLANADE AVE. - VINTAGE DR.)		Firm responsibility (prime or sub?)	Prime
Project number	H.011779	Owner's name	Kenner Department of Public Works	
Project location	City of Kenner		Owner's Project Manager	Jose Gonzalez
Owner's address, phone, email	1610 3rd St., Kenner, LA, 70062, (504) 468-7515, jgonzalez@kenner.la.us			
Services commenced by this firm (mm/yy)	09/23	Total consultant contract cost (\$1,000's)		\$500
Services completed by this firm (mm/yy)	11/24	Cost of consultant services provided by this firm (\$1,000's)		\$500

Design Engineering, Inc. (DEI) provided construction contract administration and construction engineering inspection (CE&I) services for the Power Blvd. Median Improvements project, which enhanced pedestrian and cyclist infrastructure along Power Boulevard between West Esplanade Avenue and Vintage Drive in the **City of Kenner**. The scope of work included:

- Scheduling and attending the preconstruction meeting.
- Maintaining all construction field records; making daily entries in the project diary to indicate the contractor's personnel and equipment being utilized on the project, the work being accepted, and the acceptability of traffic control; and the charging of contract time. **These activities were managed through LaDOTD's SiteManager Program.**
- Coordinating with Jefferson Parish Engineer/Representative for all relocations/adjustments of utility facilities and existing drainage structures for the construction of work site.
- Inspecting the Contractor's construction operations daily to ensure that all work is performed in accordance with the specified plans and specifications.
- **Preparing final estimate packages, including Form 2059 – "Summary of Test Results" in conformance with the DOTD's requirements.**
- Preparing plan changes and change orders.
- Reviewing and processing Contractor's invoices and generating partial estimates and weather and workday reports in **Site Manager**.
- **Working on the 175-project closeout and submitting all documents required by LaDOTD Baton Rouge, Construction Audit.**

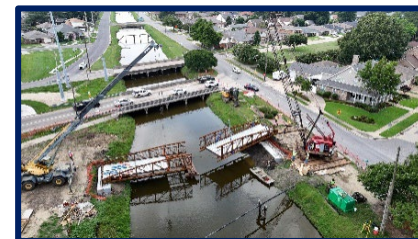

**Personnel Involved
& to be Used:**

Jim Martin
John Holtgreve
Taylor Hebert
Collin Gillen
Jay Rafferty
Gary Conerly

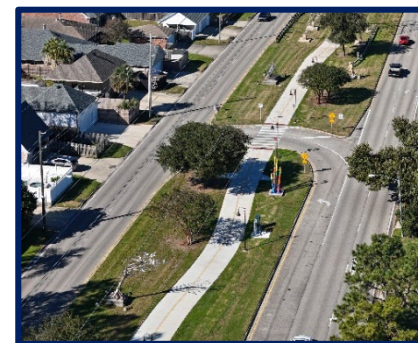

The project included the construction of a multi-use pathway with concrete paving, the relocation of an existing bridge, the installation of a pedestrian bridge near Vintage Drive, and the implementation of a new subsurface drainage system to address stormwater concerns. Additional features included ADA-compliant elements, modern lighting, landscaping, and drinking water fountains to enhance safety and accessibility.

Firm name	Design Engineering, Inc.		Past Performance Evaluation Discipline(s)*	Road, CE&I/OV
Project name	WESTWOOD DRIVE (WB EXPRESSWAY. TO LAPALCO)		Firm responsibility (prime or sub?)	Prime
Project number	H.011795	Owner's name	Jefferson Parish	
Project location	Jefferson Parish		Owner's Project Manager	Mark Drewes
Owner's address, phone, email	1221 Elmwood Park, Suite 802, Jefferson, LA, (504) 736-6505, mdrewes@jeffparish.net			
Services commenced by this firm (mm/yy)	04/19	Total consultant contract cost (\$1,000's)		\$602
Services completed by this firm (mm/yy)	06/20	Cost of consultant services provided by this firm (\$1,000's)		\$602

Design Engineering, Inc. (DEI) is responsible for providing the construction **contract administration and construction engineering inspection services for the construction of 0.648 miles of roadway** which includes **20,516 SY of Portland Cement Concrete Pavement** with barrier curb, mountable curb, and gutter, including Class II base course, **drainage pipes and structures**, sanitary sewer and related work, and tie-in to the existing Westbank Expressway on the north end and Lapalco Blvd. on the south end. Pavement striping, signs and legends, and symbols are also included. Construction Management performed by the office and site personnel includes:

- Schedule and attend the preconstruction meeting.
- Maintain all construction field records; make daily entries in the project diary to indicate the contractor's personnel and equipment being utilized on the project, the work being accepted, the acceptability of traffic control, and the charging of contract time. **All of these activities are managed through LADOTD's Site Manager Program.**
- Coordinate with Jefferson Parish Engineer/Representative for all relocations/adjustments of utility facilities and existing drainage structures for the construction of work site.
- Inspect the Contractor's construction operations (daily) to ensure that all work is performed in accordance with the specified plans and specifications.
- Prepare final estimate packages, including Form 2059 – "Summary of Test Results" in conformance with the DOTD's requirements.
- Prepare plan changes and change orders.
- Review and process Contractor's invoices and generate partial estimates and weather and workday reports in **Site Manager**.
- Work on the 175-project closeout and submit all documents required by LADOTD Baton Rouge, Construction Audit.

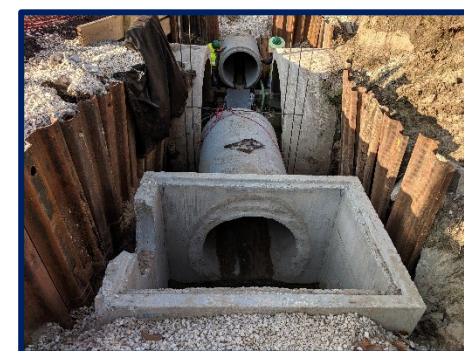

Personnel involved & will be utilized in this submittal:

Jim Martin
John Holtgreve
Collin Gillen
Jay Rafferty

Firm name	Design Engineering, Inc.		Past Performance Evaluation Discipline(s)*	Road, CE&I/OV
Project name	NINE MILE POINT RD: US 90 - LA 18		Firm responsibility (prime or sub?)	Prime
Project number	H.014681.6	Owner's name	Jefferson Parish	
Project location	Jefferson Parish, LA		Owner's Project Manager	Neil Schnieder
Owner's address, phone, email	1221 Elmwood Park, Jefferson, LA, (504) 736-6505, nschneider@jeffparish.net			
Services commenced by this firm (mm/yy)	12/23	Total consultant contract cost (\$1,000's)		\$198
Services completed by this firm (mm/yy)	Ongoing	Cost of consultant services provided by this firm (\$1,000's)		\$198

Design Engineering, Inc. (DEI) Design Engineering, Inc. (DEI) provided construction engineering inspection services for the reconstruction of approximately **1.542 miles of Nine Mile Point Road**, extending from its junction with Route US 90 to its junction with Seven Oaks Boulevard in Jefferson Parish. This project involved extensive roadwork, including grading, milling of asphalt concrete, pavement patching, Class II base course installation, and the application of fiber-reinforced asphalt concrete. Additionally, pavement striping, signs, legends, and symbols were included to enhance roadway safety and functionality. As part of the construction management services, DEI was responsible for the following:

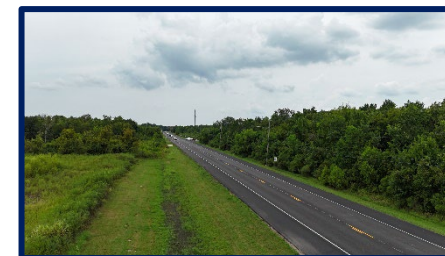

**Personnel Involved
& to be Used:**

Jim Martin
John Holtgreve
Taylor Hebert
Collin Gillen
Jay Rafferty
Gary Conerly

- **Preconstruction Coordination:** Scheduling and attending the preconstruction meeting to ensure alignment among all project stakeholders.
- **Field Records Management:** Maintaining accurate daily field records, including documenting the contractor's personnel and equipment, progress of work, traffic control measures, and contract time. These records were managed using LaDOTD's SiteManager Program.
- **Utility Relocations and Adjustments:** Coordinating with local utility companies for the relocation and adjustment of utility facilities and drainage structures to accommodate the construction activities.
- **Daily Construction Inspections:** Inspecting the contractor's construction operations on a daily basis to ensure compliance with the specified plans, ensuring quality control and adherence to safety standards.
- **Final Estimate Preparation:** Preparing the final estimate package, including Form 2059 – "Summary of Test Results," in accordance with LaDOTD's specifications.
- **Change Orders and Plan Updates:** Managing and processing plan changes and change orders as required throughout the course of the project.
- **Invoice and Payment Processing:** Reviewing and processing contractor invoices, generating partial estimates, and compiling weather and workday reports through the SiteManager system.
- **Project Closeout:** Assisting with the final project closeout, ensuring that all required documentation was submitted to LaDOTD Baton Rouge for the Construction Audit and completing all necessary compliance procedures.
- This project was a significant contribution to improving Nine Mile Point Road in **Jefferson Parish**, enhancing the road's capacity and safety for local commuters. DEI's meticulous construction engineering inspection services ensured that the project was completed to the highest standards, within the specified time frame, and in full compliance with LaDOTD requirements.

Firm name	Design Engineering, Inc.		Past Performance Evaluation Discipline(s)*		Road, CE&I/OV	
Project name	AMES BOULEVARD (WB EXPRESSWAY-HAPPY STREET)			Firm responsibility (prime or sub?)		Prime
Project number	H.011797	Owner's name	Jefferson Parish			
Project location	Jefferson Parish			Owner's Project Manager	Mark Drewes	
Owner's address, phone, email	1221 Elmwood Park Blvd., Jefferson, LA, (504) 736-6505, mdrewes@jeffparish.net					
Services commenced by this firm (mm/yy)		02/21	Total consultant contract cost (\$1,000's)			\$512
Services completed by this firm (mm/yy)		12/21	Cost of consultant services provided by this firm (\$1,000's)			\$838

Design Engineering, Inc. (DEI) was responsible for providing the construction **contract administration and construction engineering inspection services for the construction of 0.39 miles of roadway** which included asphalt paving inspection, estimate generation, material sampling, submittal review, and project closeout. Construction Management performed by the office and site personnel included:

- Scheduling and attending the preconstruction meeting.
- Maintaining all construction field records; making daily entries in the project diary to indicate the contractor's personnel and equipment being utilized on the project, the work being accepted, and the acceptability of traffic control; and the charging of contract time. **These activities were managed through LaDOTD's SiteManager Program.**
- Coordinating with Jefferson Parish Engineer/Representative for all relocations/adjustments of utility facilities and existing drainage structures for the construction of work site.
- Inspecting the Contractor's construction operations daily to ensure that all work is performed in accordance with the specified plans and specifications.
- **Preparing final estimate packages, including Form 2059 – "Summary of Test Results" in conformance with the DOTD's requirements.**
- Preparing plan changes and change orders.
- Reviewing and processing Contractor's invoices and generating partial estimates and weather and workday reports in **Site Manager**.
- **Working on the 175-project closeout and submitting all documents required by LaDOTD Baton Rouge, Construction Audit.**

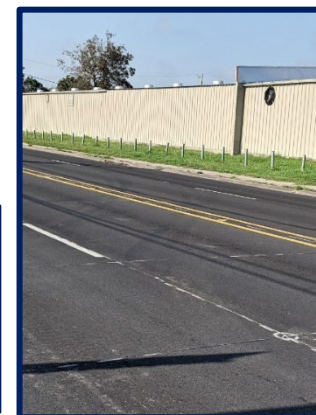

**Personnel Involved
& to be Used:**

Jim Martin
John Holtgreve
Jay Rafferty

Firm name	Design Engineering, Inc.		Past Performance Evaluation Discipline(s)*	Road, CE&I/OV
Project name	AIRLINE PARK BOULEVARD (CAMPHOR TO WEST NAPOLEON)		Firm responsibility (prime or sub?)	Prime
Project number	H.011798.6	Owner's name	Jefferson Parish	
Project location	Jefferson Parish		Owner's Project Manager	Mark Drewes
Owner's address, phone, email	1221 Elmwood Park, Suite 802, Jefferson, LA, (504) 736-6505, mdrewes@jeffparish.net			
Services commenced by this firm (mm/yy)	05/19	Total consultant contract cost (\$1,000's)		\$348
Services completed by this firm (mm/yy)	08/20	Cost of consultant services provided by this firm (\$1,000's)		\$348

Design Engineering, Inc. (DEI) is responsible for providing the construction **contract administration and construction engineering inspection services for the construction of 0.390 miles of roadway** which includes grading, drainage structures, milling asphalt pavement, pavement patching, class ii base course, scarifying and compacting roadbed, asphalt concrete pavement, Portland Cement Concrete Pavement, cofferdams, storm water pumping station, and related work on Airline Park Boulevard from north of its intersection with Camphor St. to its junction with W. Napoleon Ave. Pavement striping, sign and legends and symbols are also included. Construction Management performed by the office and site personnel includes:

- Schedule and attend the preconstruction meeting.
- Maintain all construction field records; make daily entries in the project diary to indicate the contractor's personnel and equipment being utilized on the project, the work being accepted, the acceptability of traffic control, and the charging of contract time. **All of these activities are managed through LADOTD's Site Manager Program.**
- Coordinate with Jefferson Parish Engineer/Representative for all relocations/adjustments of utility facilities and existing drainage structures for the construction of work site.
- Inspect the Contractor's construction operations (daily) to ensure that all work is performed in accordance with the specified plans and specifications.
- Prepare final estimate packages, including Form 2059 – "Summary of Test Results" in conformance with the DOTD's requirements.
- Prepare plan changes and change orders.
- Review and process Contractor's invoices and generate partial estimates and weather and workday reports in **Site Manager**.
- Work on the 175-project closeout and submit all documents required by LADOTD Baton Rouge, Construction Audit.



**Personnel Involved
& to be Used:**

Jim Martin
John Holtgreve

Firm Name	Eustis Engineering L.L.C.				Discipline(s)*	Geotech
Project Name	New Magazine Street Improvements, Between Leake Avenue to Avenue East Drive				Firm responsibility (prime or sub?)	Sub
Project Number	H.007273		Owner's Name	LaDOTD through Design Engineering, Inc.		
Project Location	New Orleans, LA			Owner's Project Manager	Brett Liuzza, P.E.	
Owner's address, phone, email		3330 West Esplanade Avenue, Suite 205, Metairie, Louisiana, 504-836-2155, bliuzza@dei-engr.com				
Services commenced by this firm (mm/yy)		11/21	Total consultant contract cost (\$1,000's)			Unknown
Services completed by this firm (mm/yy)		02/23	Cost of consultant services provided by this firm (\$1,000's)			\$28

The portion of Magazine Street between Leake Avenue and slightly east of East Drive in New Orleans, Louisiana was demolished and reconstructed. The new pavement comprised of Portland Cement Concrete. Utility features were also planned to be updated. Eustis Engineering provided construction materials testing services for the project to include sampling and field testing of earthwork, and field testing and sampling of concrete.

For the sampling and field testing of earthwork, Eustis Engineering provided a qualified technician to:

- observe proofrolling operations,
- obtain representative samples of materials intended for use on the project,
- perform in place density tests on these same materials throughout the day, and
- determine if the materials in the field have been properly compacted and are in compliance with the project plans and specifications.

During concrete, mortar, and grout testing services, Eustis Engineering's ACI certified technicians:

- recorded each mix design used while at the project site;
- recorded the amount of water or additives added to the concrete, mortar, and/or grout mix;
- observed the placement of the material while performing testing;
- performed slump tests (either visual or actual) for each truck load witnessed;
- sampled the material at intervals stated in the project plans and specifications

Personnel Involved & to be Used:

Travis R. Richards, P.E.
Chad M. Ortolano
Jonathan B. Jodrich

Firm Name	Eustis Engineering L.L.C.				Discipline(s)*	Geotech
Project Name	Ames Boulevard Between the West Bank Expressway and Happy Street				Firm responsibility (prime or sub?)	Sub
Project Number	H.011797	Owner’s Name	LaDOTD Through Design Engineering, Inc.			
Project Location	Jefferson Parish, Louisiana			Owner’s Project Manager	Brent French, P.E.	
Owner’s address, phone, email	5080 Florida Boulevard, Baton Rouge, Louisiana 70806, 225-929-9133, kristy.smith2@la.gov					
Services commenced by this firm (mm/yy)	07/21	Total consultant contract cost (\$1,000’s)				Unknown
Services completed by this firm (mm/yy)	08/21	Cost of consultant services provided by this firm (\$1,000’s)				\$3.5

This project involved renovations and upgrades to a section of the roadway pavement along Ames Boulevard between the West Bank Expressway and Happy Street in Jefferson Parish.

Eustis Engineering was brought in to provide construction materials testing and inspection services during the laying of asphalt and concrete for this project; specifically asphalt base course, asphalt binder course, asphalt wearing course, asphalt incidental mix, and Portland cement concrete types B and M.

Eustis Engineering's specific duties included molding concrete cylinders, testing asphalt courses, performing inspections, and generally providing quality control oversight to ensure materials and processes conformed to manufacturer's specifications, the Job Mix Formula (JMF), and the LaDOTD's criteria.

Our field inspectors logged over 50 hours on site for these services. Daily reports were reviewed for quality control by our engineering staff and issued through our online client portal in MetaField.

Personnel Involved & to be Used:

Travis R. Richards, P.E.
Jonathan B. Jodrich

Firm Name	Eustis Engineering L.L.C.				Discipline(s)*	Geotech
Project Name	Girder Span Bridge Repairs, Earhart Expressway and Clearview Parkway Interchange				Firm responsibility (prime or sub?)	Sub
Project Number	H.011158.6		Owner's Name	LaDOTD Through Boh Bros Construction Co., L.L.C.		
Project Location	Metairie, Louisiana			Owner's Project Manager	Gordon Abboud	
Owner's address, phone, email	730 Tonti Street, New Orleans, Louisiana, 225-756-3850, gabboud@bohbro.com					
Services commenced by this firm (mm/yy)	08/18	Total consultant contract cost (\$1,000's)				Unknown
Services completed by this firm (mm/yy)	11/18	Cost of consultant services provided by this firm (\$1,000's)				\$3

Our scope of work for this project included concrete and grout testing for the girder span bridge repairs located at the Earhart Expressway and Clearview Parkway Interchange in Metairie, Louisiana.

Eustis Engineering provided ACI certified technicians to perform quality control inspections and testing of both concrete and grout, as well as a special inspector for high strength grout. These services included:

- recording each mix design used while at the project site;
- recording the amount of water or additives added to the mixes;
- performing slump or flow cone tests for each batch of concrete or grout;
- determining the air content for each sample tested;
- sampling the concrete and grout at intervals stated in the plans and specifications; and
- performing compression testing on specimens collected during our testing services at intervals of 7 and 28 days.

Personnel Involved & to be Used:

Travis R. Richards, P.E.
Chad M. Ortolano
Jonathan B. Jodrich

Considering the small scope and close proximity to our office, we logged under 50 hours to complete these services.

18. Approach and Methodology:

ROOSEVELT BLVD: W NAPOLEON - W METAIRIE (CE&I)

Project Understanding:

Design Engineering, Inc. (DEI) will provide Construction Contract Administration, Construction Engineering, and Inspection (CE&I) services typically performed by the Louisiana Department of Transportation and Development (LADOTD) for the reconstruction of Roosevelt Boulevard from West Napoleon Avenue to West Metairie Avenue. This project spans 0.57 miles and includes the reconstruction of Portland Cement Concrete (PCC) pavement, Class II Base course, curbs, drainage systems, sidewalks, earthwork, and driveways. The roadway is classified as an urban collector with a design speed of 40 mph and a posted speed limit of 30 mph. Below is the proposed project location.

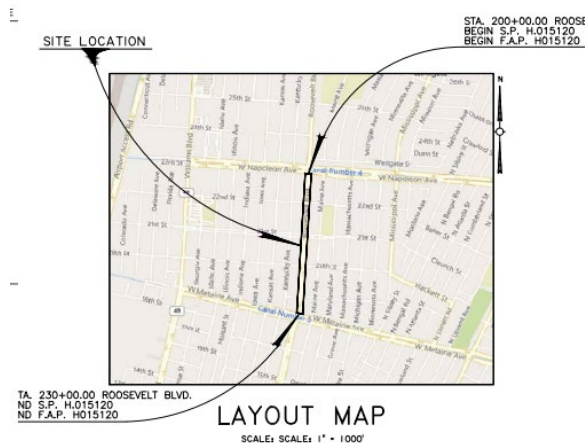

Figure 1: Proposed Project Location

We understand that this project includes several design exceptions approved by Jose Gonzalez, City of Kenner CAO. These exceptions include the installation of 4-foot-wide sidewalks instead of the 5-foot minimum required by LADOTD Minimum

Design Guidelines, the exclusion of bicycle accommodations per LADOTD's Complete Streets Policy, and the installation of barrier curbs along medians to match the existing curb type, which does not meet LADOTD's mountable curb requirements outlined in the Roadway Design Procedures and Details Manual. These exceptions are a result of the specific needs and existing conditions along Roosevelt Boulevard, ensuring that the improvements align with the community's requirements while maintaining safety and functionality.

One of the defining features of the project is the implementation of a single typical section for the entire length of the improvement. This approach ensures consistency throughout the corridor, simplifying design and construction processes while providing a uniform driver experience. This typical section will be applied across the entire stretch of the road to streamline the construction, reduce material variations, and enhance the aesthetics and functionality of the roadway. The scope also includes removal and replacement of several drainage features as well as new sidewalks.

The contractor will remove 17,832.5 square yards of pavement, followed by the placement of **16,280 square yards of PCC pavement at a thickness of 9 inches; this is the primary feature and purpose of the project.** This new pavement is designed to withstand high traffic loads while providing a smooth and durable surface. Additionally, 670.4 square yards of PCC pavement will be constructed for crossovers and turnouts, ensuring proper turning radii for vehicles and smooth transitions between lanes. The project includes the installation of 18,600.2 square yards of Class II Base course at a thickness of 12 inches to provide a stable foundation for the new pavement.

Storm drainage improvements are a critical component

of the project, addressing the area's drainage needs and ensuring proper runoff management. This includes the removal of 1,232 linear feet of existing pipe and the installation of 2,194 linear feet of new storm drain pipes, which will help improve the area's drainage capacity. Furthermore, 2,580 linear feet of pipe cleaning and video inspection are required to ensure the new system is free of blockages and functioning properly. Other activities include tree trimming and root pruning to ensure that the new infrastructure does not interfere with existing trees, as well as pavement striping to finalize the project and ensure clear traffic flow once the road is reopened.



Figure 2: Roosevelt Blvd. Northbound

DEI will deploy certified inspectors, including Gary Connerly, Wayne Lemoine, and others if needed, to perform resident inspections and field testing for quality assurance. These inspectors meet all of LADOTD's qualification and certification requirements, ensuring the highest professionalism and expertise on-site. As the CE&I contractor, DEI's role will center around Quality Assurance, Document Control, and Project Coordination. Quality assurance combines

quality control and acceptance processes to ensure the project delivers a durable, high-performing product to the public. DEI will conduct thorough inspections at each stage of construction, verifying that all work is completed according to contract specifications and LADOTD guidelines.

To enhance efficiency and accuracy, DEI leverages advanced technology, including smartphones, tablets, and aerial drones, to upload real-time project photos and documentation for immediate use by the office staff and the Owner. Additionally, DEI's extensive experience with LADOTD's software systems, including HeadLight and SiteManager, will allow us to maximize these tools' benefits, ensuring seamless document management, streamlined communication, and precise quality monitoring. These tools enable DEI to track and manage project data, monitor quality control procedures, and keep stakeholders informed of the project's progress.

Our comprehensive understanding of the project specifics (**we have reviewed the full plan set**), combined with our experienced team and innovative approach, ensures that DEI is well-equipped to deliver exceptional CE&I services tailored to the unique requirements of this reconstruction project. DEI's commitment to quality, safety, and client satisfaction ensures that this important infrastructure project will be completed on time, within budget, and to the highest standards of quality.

We have a daily working relationship with the LPA (City of Kenner) and have completed projects of the same scope and materials as this project.

Construction Phasing and Planning:

The construction process for this project will be phased to minimize disruption to the surrounding area and residences. The true traffic impacts will begin with Phase 3-1A, which involves the reconstruction of the northbound inside lane from West Metairie Avenue to 20th Street. The following

phases will move first across the traffic lanes and then advancing down stream toward West Napoleon for the next section.

We have prepared a simplified phasing diagram to share with the LPA as well as the residents as required (*Figure 3.*)

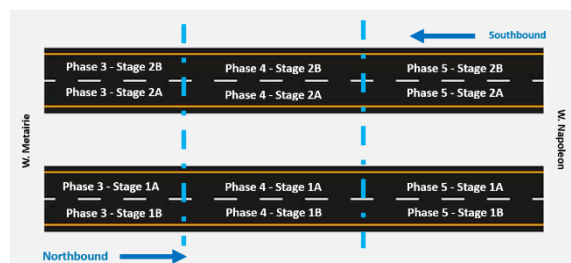

Figure 3 Simplified Phasing Diagram

Throughout the construction, DEI's team will closely monitor traffic impacts, coordinate lane closures, and ensure that access to residential and commercial areas is maintained. By carefully managing each phase of the project, DEI will work to minimize disruptions and ensure the efficient progression of the construction process. DEI will make certain that Traffic Control Devices are kept in order and in position throughout construction to facilitate this.

Potential Challenges:

A primary concern for this project is maintaining smooth traffic flow on Roosevelt Boulevard in Kenner while ensuring the safety of both drivers and pedestrians and minimizing disruptions to local residents. DEI is committed to addressing these challenges through several key strategies.

First, a comprehensive Maintenance of Traffic (MOT) plan will be implemented, which will include clearly marked detours, traffic signage, and regular updates to the public to keep everyone informed of any changes. To further minimize disruption, DEI will actively monitor residential access and coordinate with property owners to ensure that their access needs are met throughout the construction process.

Design Engineering, Inc.



DEI will provide oversight to ensure compliance with stormwater management practices, particularly during excavation and pipe installation, to prevent any negative environmental impacts. Figures depicting the construction sequence (figure 3) and typical section (figure 4) will be included to offer visual clarity and enhance understanding of the project's phasing and scope.

STAGE 4: PRE-CONSTRUCTION

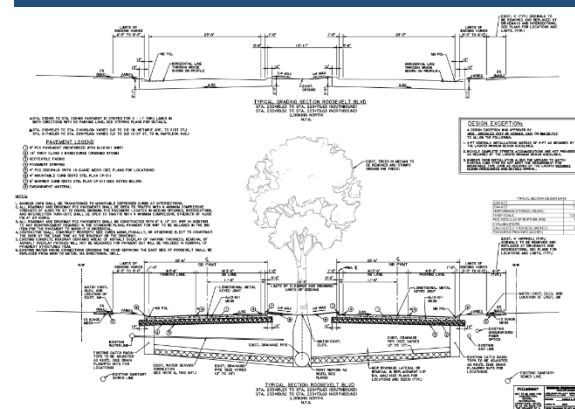

Figure 4 Roosevelt Typical Section from approved Plan Set

QA/QC Plan: Upon contract award, DEI's Engineering Team, including Taylor Hebert (Project Engineer), and Collin Gillen (Deputy Project Engineer), will submit a comprehensive Quality Assurance/Quality Control (QA/QC) Plan within ten (10) business days to the Department of Transportation and Development (DOTD). This plan will outline the specific quality controls to be applied throughout the project, ensuring compliance with DOTD standards and specifications.

Pre-Construction Meeting: The Project Engineer (Taylor Hebert) and Construction Manager (Jay Rafferty) will work closely with the Entity and the DOTD District personnel to schedule and conduct the pre-construction meeting. The meeting will follow the DOTD's Pre-Construction Meeting Checklist, ensuring all critical project aspects, such as scope, schedule, safety protocols, and communication strategies, are

reviewed and understood by all parties.

SiteManager/HeadLight Training: DEI will ensure that all engineers and inspectors are granted access to essential DOTD software platforms, including HeadLight, SiteManager, and other required systems. DEI will arrange for training on these platforms with assistance from the assigned DOTD trainer to ensure seamless integration and compliance with DOTD's project management systems.

STAGE 5: CONSTRUCTION

Construction Engineering & Inspection

Design Engineering, Inc. (DEI) will provide detailed construction contract administration and construction engineering inspection services that are typically performed by DOTD's Project Engineer and their staff. This includes overseeing tasks such as PCC pavement reconstruction, Class II base reconstruction, and drainage structure installation, all in alignment with DOTD's standards and procedures. These services will be conducted under the direct supervision of the Entity and in collaboration with DOTD personnel.

Construction Coordination: DEI's Project Engineer (Taylor Hebert) and Construction Manager (Jay Rafferty) will coordinate construction activities with the Entity, the Federal Highway Administration (FHWA), and the assigned DOTD representative. DEI will also hold regular progress meetings, conduct site visits, and conduct inspections with DOTD representatives. Furthermore, DEI will ensure construction procedures, materials, and equipment receive DOTD approval before any changes are made to the project plans.

Inspection: DEI's team of Resident Inspectors will perform daily inspections to ensure all construction activities adhere to project plans and specifications. This includes inspecting erosion control devices and reporting any deficiencies. DEI will also coordinate with DOTD representatives to

inspect pre-cast materials and verify compliance with MUTCD and Traffic Control standards. Inspection findings, including photos and notes, will be recorded using HeadLight to ensure compliance with DOTD procedures.

Maintain Records: DEI's Construction Manager will maintain accurate construction field records, including daily reports (DWR) that document personnel, equipment, work performed, traffic control status, and contract time. The manager will also prepare monthly pay estimates and progress reports, ensuring transparency and accountability throughout the construction process.

Submittals/RFI/Change Orders: DEI's engineering team will work closely with the Entity's Engineer/Representative to address any utility relocations or adjustments required during construction. They will review submittals, manage RFIs, and process change orders. This will ensure that all project adjustments are properly documented and executed in compliance with DOTD procedures.

Materials Testing: DEI will provide qualified personnel and equipment to perform required field testing for quality assurance in compliance with DOTD's Sampling and Testing Manual and the Quality Assurance Manual. All materials sampled for testing will be submitted to the DOTD District 02 Testing Laboratory or a certified independent testing lab, following DOTD's strict guidelines for material validation.

Acceptance Phase

Acceptance Inspection: DEI will prepare final estimate packages in accordance with DOTD guidelines, including Form 2059 – "Summary of Test Results." DEI will ensure that all inspection and testing data meet DOTD Construction Contract Administration Manual standards. The DEI team will also handle any necessary approvals as stipulated in the Standard Specifications.

Punch List: After the final inspection, DEI's Construction Manager will compile a punch list of any outstanding tasks or deficiencies that must be addressed before final acceptance. This list will guide the completion of the final steps to meet project specifications and

standards.



Figure 5: Roosevelt Blvd. Southbound

Closeout Phase

Final Estimate and Documentation: DEI will compile and submit the final estimate package, including Form 2059, as required by the DOTD Construction Contract Administration Manual. This package will include final payment calculations, summary of tests, and all submittal approvals necessary for project completion.

Final Checklist: DEI's Construction Manager will thoroughly review the final checklist to ensure that all project elements have been completed to satisfaction and in compliance with DOTD requirements. This checklist will include documentation of completed inspections, materials testing, and any adjustments made throughout construction.

As-Built Plans: DEI's engineering team will prepare comprehensive As-Built Plans, reflecting the final changes made to the project during construction. These plans will be submitted to DOTD as part of the final project documentation, providing a complete record of the construction process.

Document Submittal: To formally close out the project, DEI will submit all required documentation, including final reports, As-Built Plans, test results, and any other project-related files, to DOTD for review and final approval. This will ensure the project is fully compliant with DOTD standards and procedures.

DOTD Past Performance

DEI's extensive history of working with DOTD on CE&I projects showcases our reliability and expertise. Selected by DOTD over a dozen times for CE&I services, DEI consistently delivered exceptional results, earning grades as high as 4.7–5.0 before 2019, when DOTD ceased grading these projects. Since then, we have completed five DOTD Local Public Agency (LPA) projects and currently manage four ongoing projects in various phases of construction and closeout. Our team's ability to navigate challenges, such as unforeseen subsurface obstructions or delayed utility clearances, reflects our adaptability and problem-solving expertise. We leverage this experience to maintain strong relationships with LPAs, including Kenner, Jefferson Parish, New Orleans, and others, ensuring a seamless partnership with DOTD.

While the proposal format only allows us to include five projects, DEI has more than 5 CE&I LPA projects in Jefferson Parish alone.

Responsiveness

DEI's commitment to responsiveness is unmatched. Our "always on" approach ensures that DEI is accessible for urgent needs, inquiries, or project changes—day or night, weekday or holiday. This dedication to availability enhances communication and expedites decision-making, providing reassurance to DOTD and project stakeholders. Our team consistently prioritizes clear and timely communication, enabling effective coordination throughout all project phases. When working previously for this LPA, the City has reached out to various DEI personnel (including

principals) at all hours as needed.

DEI's CE&I DOTD and Entity Projects		
Project Name	Entity	Completion
Robert E. Lee Blvd. Improvements (Wickfield Dr. to Elysian Fields Ave)	City of New Orleans	2009
Robert E. Lee Blvd. Improvements (Pratt Dr. to Paris Ave)	City of New Orleans	2011
Fleur De Lis Drive Reconstruction - Phase II (Veterans Blvd. to N. 30th Street)	City of New Orleans	2011
MacArthur Drive Interchange Completion	Jefferson Parish	2016
Lake Forest Boulevard	City of New Orleans	2017
Washington Avenue Pedestrian Bridge Crossing	City of New Orleans	2018
Chateau Boulevard Resurfacing	City of Kenner	2018
Canal Boulevard (R.E. Lee to Amethyst)	City of New Orleans	2020
Westwood Drive (WB Expy to Lapalco)	Jefferson Parish	2020
Airline Park Boulevard (Camphor to W. Napoleon)	Jefferson Parish	2021
Ames Boulevard	Jefferson Parish	2022
Magazine Street	City of New Orleans	2024
Grafton Drive	Slidell	Ongoing
Power Blvd. Median Improvements	City of Kenner	Ongoing
Carey Street	Slidell	Ongoing
Nine Mile Point Road: US 90 – LA 18	Jefferson Parish	Ongoing
US 11 & US 190 Bicycle and Ped Crossings	Slidell	Ongoing
PR 929 Overlay: US 61 – LA 42	Ascension Parish	Ongoing
Scotlandville Pkwy to Dwtm BR Trail – PH 1	BREC	Ongoing

Work Quality

Quality is at the heart of every service DEI provides. Our engineers and project managers are widely regarded for their meticulous attention to detail, embodying the perfectionist mindset that defines DEI's approach.

Employing highly credentialed professionals from institutions like LSU, Tulane, Stanford, and Columbia, DEI maintains a standard of excellence that ensures design precision, efficient construction management, and reduced risk of cost overruns. We believe that superior work quality directly contributes to overall project success.

Cost Control

At DEI, we recognize that managing costs is a cornerstone of successful project delivery. Through careful planning, attention to design details, and strategic materials selection, DEI minimizes construction costs while maintaining high-quality outcomes. With a proven history of completing DOTD projects within budget, DEI is committed to financial prudence and delivering maximum value to our clients.

Ability to Meet Schedules and Deadlines

DEI's capacity to meet challenging deadlines is backed by a skilled team of over 25 professionals with extensive experience managing complex schedules. From unforeseen delays to aggressive project timelines, DEI's adaptive approach and deep understanding of DOTD LPA processes allow us to remain efficient and dependable. We align our resources with DOTD's objectives to ensure timely project delivery while maintaining the highest standards of quality.



Work Load

While our workload shows several projects, all except one are no longer "in the field." As such, when the Roosevelt project commences, we will have all available field resources to address

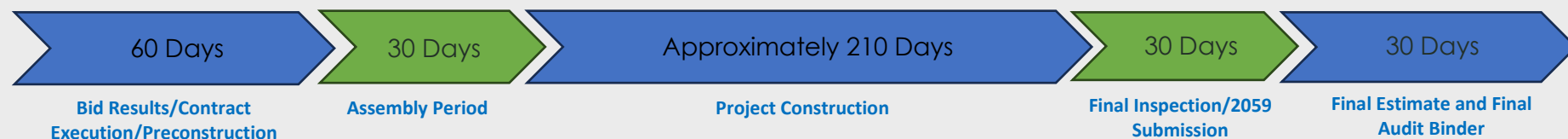
Project Schedule



19. Workload:

Firm(s) ALL FIRMS MUST BE REPRESENTED IN THIS TABLE	Discipline(s) *	Contract Number and State Project Number	Project Name	Remaining Unpaid Balance**
 Design Engineering, Inc.	Bridge	4400009382, H.002956.5	Earhart Expressway at Dakin Street	\$15,814
	CE&I/OV	4400026029, H.014315.6	Grafton Drive Pavement Rehabilitation	\$40,491
	CE&I/OV	4400026839, H.014317.6	Carey St Pavement Rehabilitation	\$10,348
	CE&I/OV	4400020651, H.013267.6	Scotlandville Pkwy to Dwtm BR Trail – PH 1	\$104,286
	CE&I/OV	4400027689, H.014681.6	Nine Mile Point Rd: US 90 – LA 18	\$9,502
	CE&I/OV	4400027404, H.014642.5	PR 929 Overlay: US 61 – LA 42	\$9,030
 Eustis Engineering, L.L.C.	Geotech	IDIQ Contract No. 4400019017, Task Order No. 3 S.P. No. H.015028.6 F.A.P. No. H015028. Purchase Order No. 2000730393	Louisiana, State of - Department of Transportation and Development, LA 302: Bayou Barataria Bridge Replacement, Phase 1, Engineering During Construction, Jefferson Parish, Louisiana, Eustis Engineering Project No. 24515.01	\$75,904
	Geotech	IDIQ Contract No. 4400019017. Task Order No. 5. S.P. No. H.011970.5 F.A.P. No. H011970.5. Purchase Order No. 2000866641	Louisiana, State of - Department of Transportation and Development (LaDOTD), Bayou Terrebonne Bridges, LA Highway 182 Houma (Terrebonne Parish), Louisiana, Eustis Engineering Project No. 25303	\$35,101
	Geotech	IDIQ Contract No. 4400019017. Task Order No. 6. S.P. No. H.015050.5 F.A.P. No. H015050. Purchase Order No. 2000866630	Louisiana, State of - Department of Transportation and Development (LaDOTD), Bridge Replacement and Embankment Widening, Gravolet Road Over Drainage Canal, Braithwaite (Plaquemines Parish), Louisiana, Eustis Engineering Project No. 25305	\$22,531
	Geotech	IDIQ Contract No. 4400019017. Task Order No. 8. S.P. No. H.015909 F.A.P. No. H015909. Purchase Order No. 2000899470	Louisiana, State of - Department of Transportation and Development (LaDOTD), Bayou Macon Bridge Replacement, U.S. Highway 80, Delhi (Richland Parish), Louisiana, Eustis Engineering Project No. 25396	\$108,201
	Geotech	S.P. No. H.013897. F.A.P. No. H013897. Boh Portion 20274-026	Louisiana, State of - Department of Transportation and Development, I-10 and I-12 College Flyover Ramp Design-Build Project, East Baton Rouge Parish, Louisiana, Project No. B0646	\$9,350
	Geotech	LADOTD Contract No. 4400021740. S.P. No. H.004100.6 F.A.P. No. H004100. 11265001.000 I-10 CMAR	Louisiana, State of - Department of Transportation and Development, I-10: LA Highway 415 to Essen Lane on I-10 and I-12, Phase I: West of Washington Street to Essen Lane, Phase I, Segment 01: West of Washington Street to Acadian Thruway, Route I-10, West and East	\$46,200

20. Certifications/Licenses:



Taylor Hebert, P.E.



Collin Gillen, P.E.

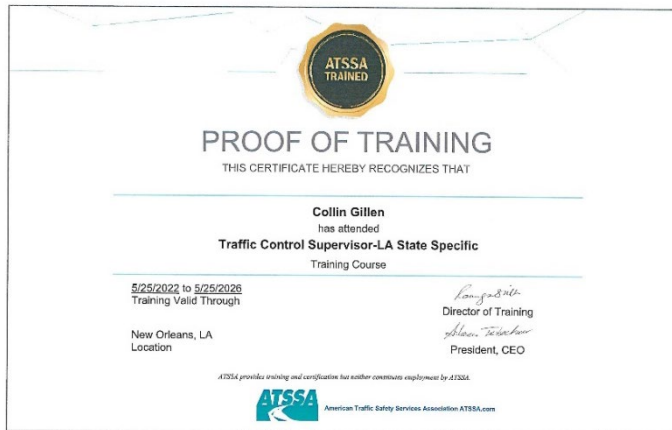



Jay Rafferty





Wayne "Dickie" Lemoine

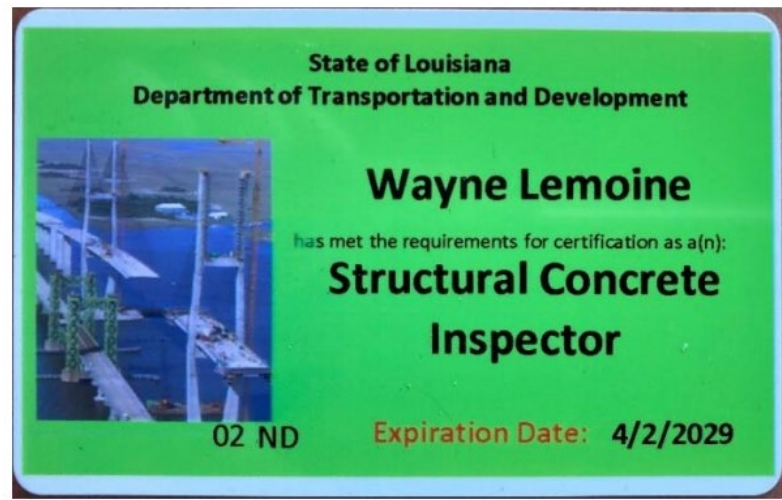



Gary Conerly





Louisiana
**SECRETARY
OF STATE**
NANCY LANDRY

(<https://www.sos.la.gov/Pages/default.aspx>)

Search for Louisiana Business Filings

[Buy Certificates and Certified Copies](#)

[Subscribe to Electronic Notification](#)

[Print Detailed Record](#)

Name	Type	City	Status
DESIGN ENGINEERING, INC.	Business Corporation	METAIRIE	Active

Previous Names

Business: DESIGN ENGINEERING, INC.

Charter Number: 34152346D

Registration Date: 8/15/1984

Domicile Address

3330 W. ESPLANADE AVE., STE. 205
METAIRIE, LA 70002

Mailing Address

C/O WALTER BAUDIER
3330 W. ESPLANADE AVE., STE. 205
METAIRIE, LA 70002

Principal Office Address

3330 W. ESPLANADE AVE., STE. 205
METAIRIE, LA 70002

Status

Status: Active

Annual Report Status: In Good Standing

File Date: 8/15/1984

Last Report Filed: 7/19/2024

Type: Business Corporation

Registered Agent(s)

Agent: WALTER BAUDIER
Address 1: 3330 W. ESPLANADE AVE., STE. 205
City, State, Zip: METAIRIE, LA 70002
Appointment Date: 10/22/1997

Officer(s)

Additional Officers: No

Officer: WALTER BAUDIER
Title: Director
Address 1: 6514 PRATT DR.
City, State, Zip: NEW ORLEANS, LA 70122

Officer: ALICE C. BAUDIER
Title: Director
Address 1: 6514 PRATT DR.
Address 2: SUITE 205
City, State, Zip: NEW ORLEANS, LA 70122

Amendments on File (3)

Description	Date
Domicile, Agent Change or Resign of Agent	8/14/1987
Disclosure of Ownership	2/20/1998
Disclosure of Ownership	4/26/2005

[Back to Search Results](#)

[New Search](#)

[View Shopping Cart](#)



Louisiana
**SECRETARY
OF STATE**
NANCY LANDRY

(<https://www.sos.la.gov/Pages/default.aspx>)

Search for Louisiana Business Filings

[Buy Certificates and Certified Copies](#)

[Subscribe to Electronic Notification](#)

[Print Detailed Record](#)

Name	Type	City	Status
EUSTIS ENGINEERING L.L.C.	Limited Liability Company	METAIRIE	Active

Previous Names

EUSTIS ENGINEERING SERVICES, L.L.C. (Changed: 3/31/2016)

Business: EUSTIS ENGINEERING L.L.C.

Charter Number: 36251453K

Registration Date: 8/17/2006

Domicile Address

3011 28TH STREET
METAIRIE, LA 700026019

Mailing Address

C/O GWENDOLYN P. SANDERS
3011 28TH ST.
METAIRIE, LA 700026019

Status

Status: **Active**

Annual Report Status: **In Good Standing**

File Date: 8/17/2006

Last Report Filed: 7/22/2024

Type: Limited Liability Company

Registered Agent(s)

Agent:	GWENDOLYN SANDERS
Address 1:	3011 28TH STREET
City, State, Zip:	METAIRIE, LA 700026019
Appointment Date:	3/16/2020

Officer(s)

Additional Officers: No

Officer:	GWENDOLYN P. SANDERS
Title:	Manager
Address 1:	3011 28TH STREET
City, State, Zip:	METAIRIE, LA 70002
Officer:	KATHY D. LEROUGE
Title:	Manager
Address 1:	3011 28TH STREET
City, State, Zip:	METAIRIE, LA 70002
Officer:	JAMES HANCE
Title:	Manager
Address 1:	3011 28TH STREET
City, State, Zip:	METAIRIE, LA 70002
Officer:	CHAD HELD
Title:	Manager
Address 1:	3011 28TH STREET
City, State, Zip:	METAIRIE, LA 70002
Officer:	TRAVIS RICHARDS
Title:	Manager
Address 1:	3011 28TH STREET
City, State, Zip:	METAIRIE, LA 70002
Officer:	LAWRENCE W. ROME
Title:	Manager
Address 1:	3011 28TH STREET
City, State, Zip:	METAIRIE, LA 70002-6019
Officer:	SEAN WALSH
Title:	Manager
Address 1:	3011 28TH STREET
City, State, Zip:	METAIRIE, LA 700026019
Officer:	BENJAMIN CODY
Title:	Manager
Address 1:	3011 28TH STREET
City, State, Zip:	METAIRIE, LA 700026019
Officer:	MATTHEW MORALES
Title:	Member
Address 1:	3011 28TH STREET
City, State, Zip:	METAIRIE, LA 700026019

Amendments on File (7)

Description	Date
Disclosure of Ownership	9/15/2006
Domestic LLC Agent/Domicile Change	5/28/2014
Domestic LLC Agent/Domicile Change	3/31/2016
Appointing, Change, or Resign of Officer	3/31/2016
Name Change	3/31/2016
Domestic LLC Agent/Domicile Change	3/16/2020
Appointing, Change, or Resign of Officer	3/8/2021

[Back to Search Results](#)
[New Search](#)
[View Shopping Cart](#)

21. QA/QC Plan:

If the advertisement requires submission of a QA/QC plan, include it here. **Otherwise, leave this section blank. If a QA/QC plan is included in this section and was not required by the advertisement, it will be redacted.**

22. Sub-consultant information:

Firm Name (Name must match <u>exactly</u> as registered with Louisiana's Secretary of State (SOS): <u>including punctuation, include screenshot(s) from SOS at the end of Section 20</u>)	Address	Point of Contact and email address	Phone Number
 Eustis Engineering L.L.C.	3011 28 th Street Metairie, Louisiana 70002	Gwendolyn P. Sanders, P.E. gsanders@eustiseng.com	504-834-0157

23. Location:

If location is an evaluation criterion for this advertisement (see page 2) and the prime consultant intends to establish a local presence, describe the plan for doing so. **Otherwise, leave this section blank. Any information included in this section will be redacted if not required by the Evaluation Criteria section of the advertisement.**