

DOTD FORM: 24-102

PROPOSAL TO PROVIDE CONSULTANT SERVICES

(Revised December 12, 2024)

Prime consultant shall complete the DOTD Form 24-102 without altering the Form's text; however, the instruction and/or guidance for Sections 12 through 23 can be removed but do not remove Section title and number.

ANY CONSULTANT FAILING TO SUBMIT ANY OF THE INFORMATION REQUIRED ON THE DOTD FORM 24-102, OR PROVIDING INACCURATE INFORMATION ON THE DOTD FORM 24-102, MAY BE CONSIDERED NON-RESPONSIVE.

1. Contract Name as shown in the advertisement	IDIQ CONTRACTS FOR CONSTRUCTION ENGINEERING AND INSPECTION SERVICES (CE&I) STATEWIDE WITH MAJORITY OF WORK IN DISTRICT 03
2. Contract Number(s) as shown in the advertisement	4400031761 AND 4400031762
3. State Project Number(s), if shown in the advertisement	N/A
4. Prime consultant name (name must match exactly as registered with the Louisiana Secretary of State (SOS) where such registration is required by law; including punctuation; include screenshot from SOS at the end of Section 20)	PIVOTAL ENGINEERING LLC
5. Prime consultant license number (as registered with the Louisiana Professional Engineering and Land Surveying Board (LAPELS) if registration is required under Louisiana law)	LA REGISTRATION #5213
6. Prime consultant mailing address	1515 Poydras Street, Suite 1150, New Orleans, LA ,70112
7. Prime consultant physical address (existing or to be established, if location is used as an evaluation criteria)	1515 Poydras Street, Suite 1150, New Orleans, LA ,70112
8. Name, title, phone number, and email address of prime consultant's contract point of contact	AVINASH MEHTA, P.E., PRESIDENT, 504-559-6518, amehta@pivotaleng.com
9. Name, title, phone number, and email address of the official with signing authority for this proposal	AVINASH MEHTA, P.E., PRESIDENT, 504-559-6518, amehta@pivotaleng.com

10. This is to certify that all information contained herein is accurate and true, and that the team presently has sufficient staff to perform these services within the designated time frame. By submitting this proposal, proposer certifies that it is not engaged in a boycott of Israel and it will, for the duration of its contract obligations, refrain from a boycott of Israel. Proposer also certifies and agrees that the following information is correct: In preparing its response, the proposer has considered all proposals submitted from qualified, potential subcontractors and suppliers, and has not, in the solicitation, selection, or commercial treatment of any subcontractor or supplier, refused to transact or terminated business activities, or taken other actions intended to limit commercial relations, with a person or entity that is engaging in commercial transactions in Israel or Israeli-controlled territories, with the specific intent to accomplish a boycott or divestment of Israel. The proposer also has not retaliated against any person or other entity for reporting such refusal, termination, or commercially limiting actions. DOTD reserves the right to reject the response of the bidder or proposer if this certification is subsequently determined to be false, and to terminate any contract awarded based on such a false response.



Signature above shall be the same person listed in Section 9:

Date:
April 1, 2025

Pursuant to Act No. 581 of the 2024 Louisiana Legislature Regular Session, proposer further certifies that it does not have a practice, policy, guidance, or directive that discriminates against a firearm entity or firearm trade association based solely on the entity's or association's status as a firearm entity or firearm trade association. In addition, proposer certifies it will not discriminate against a firearm entity or firearm trade association during the term of the contract based solely on the entity's or association's status as a firearm entity or firearm trade association.

11. If a Disadvantaged Business Enterprise (DBE) goal has been set for this advertisement, indicate which firm(s) will be used to meet the DBE goal and each firm(s)' percentage.

<u>Firm(s):</u>	<u>Firm(s)' %:</u>
GOTECH, INC	10%
PIVOTAL ENGINEERING LLC	90%

12. Past Performance Evaluation Discipline Table:

As indicated in the advertisement, insert a completed table here. The percentages for the prime and sub-consultants must total 100% for each past performance evaluation discipline, as well as the overall total percent of the contract.

The **only** past performance evaluation disciplines to be used are listed in the drop down in each row (Appraiser, Bridge, CE&I/OV, CPM, Data Collection, Environmental, Geotech, ITS, Other (must specify), Planning, Right-of-Way, Road, Survey, and Traffic). **Remove rows as needed.**

Past Performance Evaluation Discipline(s)	% of Overall Contract	Pivotal Engineering LLC	GoTech, Inc	Firm C	Firm D	Firm E	Each Discipline must total to 100%
CE&I/OV	100%	90%	10%				100%
Identify the percentage of work for the overall contract to be performed by the prime consultant and each sub-consultant.							
Percent of Contract	100%	90%	10%	N/A	N/A	N/A	100%

13. Firm Size:

For all firms that are part of this team, indicate the approximate number of personnel to be committed to this contract, by DOTD Job Classification and the total number of personnel within the firm that could provide support, if needed. If a specialized job classification is required and not included on the DOTD job classification list, specify “Other (must specify)” and include the classification title inside the parentheses.

The DOTD Job Classification(s) to be used can be found at the following link:
http://wwwsp.dotd.la.gov/Inside_LaDOTD/Divisions/Engineering/CCS/Job_Qualification/Job%20Classifications%20with%20Descriptions.pdf

Firm name	DOTD Job Classification	Number of personnel committed to this contract	Total number of personnel available in this DOTD Job Classification (if needed)
Pivotal Engineering LLC	Principal	1	2
Pivotal Engineering LLC	Supervisor - Eng	1	2
Pivotal Engineering LLC	Engineer	1	3
Pivotal Engineering LLC	CADD Drafter	2	2
Pivotal Engineering LLC	Engineer Intern	1	1
Pivotal Engineering LLC	Inspector	4	8
Pivotal Engineering LLC	Administrative	2	2
Pivotal Engineering LLC	GIS Analyst	1	1
Pivotal Engineering LLC	Professional	1	1
GOTECH, INC.	Engineer	1	4

14. Organizational Chart:

Provide an organizational chart showing ALL **relevant** prime consultant and sub-consultant (if applicable) personnel assigned to the contract, area of project responsibility for each, and reporting lines for the purposes of this contract. An individual's role does not necessarily have to match their DOTD job classification identified in Section 13. **If applicable, identify all personnel performing traffic engineering analysis and/or QC of traffic engineering analysis by placing an asterisk next to their name. Include the certificates required by the Traffic Engineering Process and Report Training Requirements article of the Advertisement in Section 20.** It is acceptable to use an 11x17 format for Section 14.

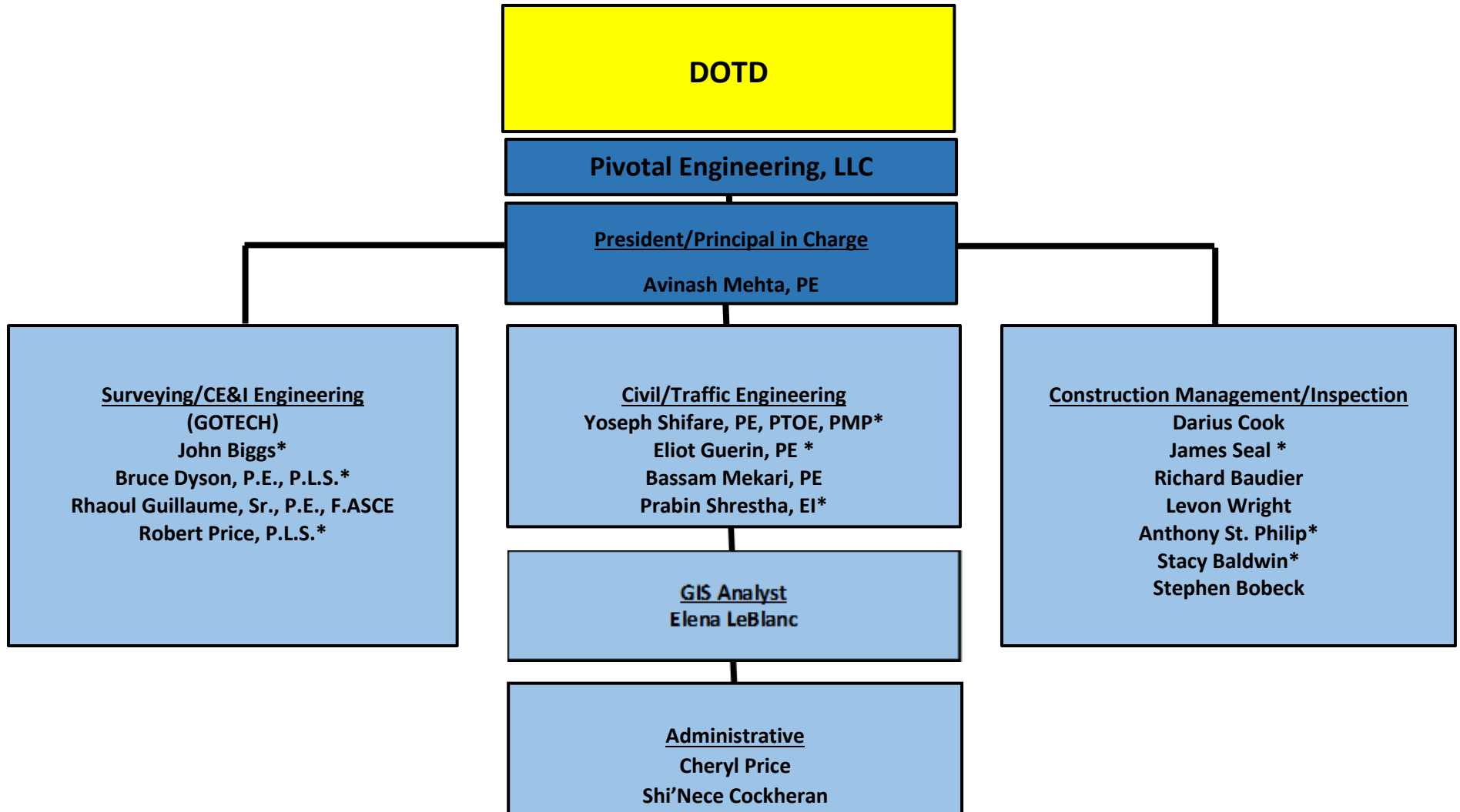

15. Minimum Personnel Requirements:

Use the table below to identify both prime consultant and sub-consultant staff designated to work on this contract meeting the Minimum Personnel Requirements (MPRs) specified in the advertisement. Ensure the résumé reflects the required experience stated in the MPR. Make sure the P.E. discipline is also listed (highlighted in table) that is meeting the MPR; e.g. professional civil engineer should show the discipline of the license as civil if meeting that MPR.

MPR No. Do not insert wording from ad	Personnel being used to meet the MPR (Individual(s) may not satisfy more than one MPR unless specifically allowed by Attachment B of the advertisement)	Firm employed by	Type of license and discipline meeting MPR/ certification & number (Ex: PE # - Civil)	State of license	License / certification expiration date
1	Avinash Mehta, P.E.	Pivotal Engineering, LLC	PE # 35100 – Civil	LA	03/31/2026
2	Avinash Mehta, P.E.	Pivotal Engineering, LLC	PE # 35100 – Civil	LA	03/31/2026
3	Avinash Mehta, P.E.	Pivotal Engineering, LLC	PE # 35100 – Civil	LA	03/31/2026
4	Yoseph Shifare, P.E.	Pivotal Engineering, LLC	PE # 42747 – Civil	LA	03/31/2026
5	Bruce Dyson, P.E., P.L. S	GOTECH, Inc.	PE#20162 PLS# 4670	LA	03/31/2026
6	Bassam Mekkari, P.E.	Pivotal Engineering, LLC	PE # 31801 – Electrical	LA	09/30/2026
7	Yoseph Shifare, P.E., PMP, PTOE	Pivotal Engineering, LLC	PE # 42747 – Civil	LA	03/31/2027

16. Staff Experience:

Résumés shall be provided for all prime and sub-consultant personnel listed in Sections 14 and/or 15 of the proposal. Résumés of personnel not identified in Section 14 or Section 15 of the proposal should not be included and will not be evaluated. Résumés **are limited to 2 pages per person**. Any certificates required by the advertisement are to be placed in Section 20.

Firm employed by Pivotal Engineering, LLC			
Name	Avinash Mehta, P.E.		Years of relevant experience with this employer
Title	President		Years of relevant experience with other employer(s)
Degree(s) / Years / Specialization		M.S. Civil Engineering, UCF, 2003 B.S. Civil Engineering, NMU – India, 2000	
Active registration number / state / expiration date		Louisiana PE#35100 / 03/31/2026	
Year registered	2009	Discipline	Civil
Contract role(s) / brief description of responsibilities		Mr. Mehta serves as the Principal of Pivotal Engineering. Mr. Mehta has over 20 years of experience managing Civil and Environmental Engineering projects including project budget, schedule and scope, coordination of resources, business development and client liaison activities. His experience includes the street design, pocket park improvements, roadway enhancements, drainage studies, process and design, water and wastewater master planning, drainage design permitting, wastewater system design, potable water system design and conceptual planning and design for coastal restoration projects.	
Experience dates (mm/yy–mm/yy)	Experience and qualifications relevant to the proposed contract; <i>i.e.</i> , “designed drainage”, “designed girders”, “designed intersection”, etc. Experience dates should cover the years of experience specified in the applicable MPR(s).		
06/17-09/22	<p><u>Wright Road Improvements: New Orleans, LA</u></p> <p>Mr. Mehta serves as the Principal in Charge for this project. Pivotal is retained by City of New Orleans to provide Design, Construction Administration and Resident Inspection Services for full roadway reconstruction project including subsurface improvements (drainage, sewer and water line improvement). The project entails roadway rehabs to 4 blocks (2435 ft). The resident inspection services are required to verify that the construction meets the plans and specs, rehabilitation goals set by FEMA and CNO, and water line replacement program set by S&WB. Since Pivotal is the design engineering firm of this project the resident inspection and coordination is outstanding. The CA and RI service also includes coordinating, contractor and utility companies in conformance to the construction documents of the project.</p>		
08/19- ongoing	<p><u>RR017 BW Cooper Gert Town Dixon Group D: New Orleans, LA</u></p> <p>Mr. Mehta serves as the principal-in-charge for this project. Pivotal is retained by City of New Orleans to provide Design, Construction Administration and Resident Inspection Services for full roadway reconstruction including subsurface improvements (drainage, sewer and water line improvement). The project entails roadway rehabilitation for twelve (12) blocks (4,015 ft) in the neighborhoods of B.W. Cooper, Gert Town and Dixon. This design of multiple streets is required to meet rehabilitation goals set by FEMA and CNO and water line replacement program set by S&WB. The project also included identifying and designing the geometrics of the streets, preparation of capital cost estimates and construction documents for the project. The project entails roadway rehabs to 12 blocks (4,015 ft) in the neighborhood of B.W. Cooper, Gert Town and Dixon.</p>		

08/19- 08/2022	<p><u>RR118-Marlyville-Fontainebleau Group C</u></p> <p>Mr. Mehta serves as the Principal in Charge for this project. Pivotal is retained by City of New Orleans to provide Resident Inspection Service for full roadway reconstruction project including subsurface improvements (drainage, sewer and water line improvement). The project entails roadway rehabs to 19 blocks (6,650 ft) in the neighborhood of Fontainebleau Dr. The resident inspection services are required to verify that the construction meets the plans and specs, rehabilitation goals set by FEMA and CNO, and water line replacement program set by S&WB. The inspection service also includes coordinating with the design engineering firm, contractor and utility companies in conformance to the construction documents of the project.</p>
08/19-ongoing	<p><u>RR019 BW Cooper Gert Town Dixon Group F: New Orleans, LA</u></p> <p>Mr. Mehta serves as the principal-in-charge for this project. Pivotal is retained by City of New Orleans to provide Design, Construction Administration and Resident Inspection for full roadway reconstruction including subsurface improvements (drainage, sewer and water line improvement). The project entails roadway rehabilitation for six (6) blocks (2,100 ft) in the neighborhoods of B.W. Cooper, Gert Town and Dixon. This design of multiple streets is required to meet rehabilitation goals set by FEMA and CNO and the water line replacement program set by S&WB. The project also included identifying and designing the geometrics of the streets, preparation of capital cost estimates and construction documents for the project.</p>
08/2020-08/2023	<p><u>RR038 Filmore North Group B; New Orleans, LA</u></p> <p>Mr. Mehta serves as the principal-in-charge for this project. Pivotal is retained by City of New Orleans to provide Resident Inspection Service for full roadway reconstruction project including subsurface improvements (drainage, sewer and water line improvement). The project entails roadway rehabs to 7 blocks (3800 ft) in the neighborhood of Bayou St. John. The resident inspection services are required to verify that the construction meets the plans and specs, rehabilitation goals set by FEMA and CNO, and water line replacement program set by S&WB. The inspection service also includes coordinating with the design engineering firm, contractor and utility companies in conformance to the construction documents of the project.</p>
05/20- ongoing	<p><u>RR076 Lake Vista Group D: New Orleans, LA</u></p> <p>Mr. Mehta serves as the principal-in-charge for this project. Pivotal is retained by City of New Orleans to provide roadway full reconstruction including subsurface improvements (drainage, sewer and water line improvement). The project entails roadway rehabilitation for five (5) blocks (1,750 ft) in the neighborhood of Lake Vista. This design of multiple streets is required to meet rehabilitation goals set by FEMA and CNO and water line replacement program set by S&WB. The project also included identifying and designing the geometrics of the streets, preparation of capital cost estimates and construction documents for the project.</p>

16. Staff Experience:

Résumés shall be provided for all prime and sub-consultant personnel listed in Sections 14 and/or 15 of the proposal. Résumés of personnel not identified in Section 14 or Section 15 of the proposal should not be included and will not be evaluated. Résumés **are limited to 2 pages per person**. Any certificates required by the advertisement are to be placed in Section 20.

Firm employed by Pivotal Engineering, LLC			
Name	Yoseph Shifare, P.E.		Years of relevant experience with this employer
Title	Project Director/Sr. Civil Engineer		Years of relevant experience with other employer(s)
Degree(s) / Years / Specialization		M.S. Civil Engineering, UOL, Kentucky, 2014 B.S. Civil Eng. UOA, Eritrea, 2001	
Active registration number / state / expiration date		Louisiana PE#42747 / 03/31/2025	
Year registered	2018	Discipline	Civil
Contract role(s) / brief description of responsibilities		Mr. Shifare serves as the project director of Pivotal Engineering in charge of civil/transportation projects. He has over 20 years engineering, project and construction management experience for public infrastructure as well as for industrial, commercial and private facility projects. As a project director, he leads and manages the day-to-day efforts of engineers on projects that include roadway, traffic analyses, pavement structural design, use of geosynthetics, geometric design, line/grade analyses, pavement marking, intersection improvements, pedestrian/bicycle lanes/paths, excavation/embankment, traffic, drainage/storm water management, water/wastewater infrastructure and landfills. Mr. Shifare has extensive experience in hydraulic and green infrastructure project design, such as experience providing complex engineering services for hazard mitigation projects for government clients	
Experience dates (mm/yy–mm/yy)	Experience and qualifications relevant to the proposed contract; <i>i.e.</i> , “designed drainage”, “designed girders”, “designed intersection”, etc. Experience dates should cover the years of experience specified in the applicable MPR(s).		
08/19- ongoing	<u>RR016 BW Cooper Gert Town Dixon Group C: New Orleans, LA</u> Mr. Shifare serves as the project director and civil engineer for this project. Pivotal is retained by City of New Orleans to provide Design, Construction Engineering and Resident inspection for full roadway reconstruction. The project includes the rehabilitation of nine (9) blocks of roadway (3245 ft) in the neighborhoods of B.W. Cooper, Gert Town and Dixon. Mr. Shifare is responsible for designing horizontal and vertical roadway alignment, drainage collection systems, water line replacements, sewer line replacements, geometrics of the streets as well as preparing both capital cost estimates and construction documents.		
08/19- ongoing	<u>RR017 BW Cooper Gert Town Dixon Group D: New Orleans, LA</u> Mr. Shifare serves as the project director and civil engineer for this project. Pivotal is retained by City of New Orleans to provide full roadway reconstruction including subsurface improvements (drainage, sewer and water line improvement). The project entails roadway rehabilitation for twelve (12) blocks (4,015 ft) in the neighborhoods of B.W. Cooper, Gert Town and Dixon. This design of multiple streets is required to meet rehabilitation goals set by FEMA and CNO and water line replacement program set by S&WB. The project also included identifying and designing the geometrics of the streets, preparation of capital cost estimates and construction documents for the project. The project entails roadway rehabs to 12 blocks (4,015 ft) in the neighborhood of B.W. Cooper, Gert Town and Dixon.		

08/19- ongoing	<p><u>RR018 BW Cooper Gert Town Dixon Group E (New Orleans, LA)</u></p> <p>Mr. Shifare serves as the project director and civil engineer for this project. Pivotal is retained by City of New Orleans to provide roadway full reconstruction including subsurface improvements (drainage, sewer and water line improvement). The project entails roadway rehabilitation for fifteen (15) blocks (6,075 ft) in the neighborhoods of B.W. Cooper, Gert Town and Dixon. This design of multiple streets is required to meet rehabilitation goals set by FEMA and CNO and water line replacement program set by S&WB. The project also includes identifying and designing the geometrics of the streets, preparation of capital cost estimates and construction documents for the project.</p>
08/19- ongoing	<p><u>RR019 BW Cooper Gert Town Dixon Group F: New Orleans, LA</u></p> <p>Mr. Shifare serves as the project director and civil engineer for this project. Pivotal is retained by City of New Orleans to provide roadway full reconstruction including subsurface improvements (drainage, sewer and water line improvement). The project entails roadway rehabilitation for six (6) blocks (2,100 ft) in the neighborhoods of B.W. Cooper, Gert Town and Dixon. This design of multiple streets is required to meet rehabilitation goals set by FEMA and CNO and the water line replacement program set by S&WB. The project also included identifying and designing the geometrics of the streets, preparation of capital cost estimates and construction documents for the project.</p>
06/17-09/22	<p><u>Wright Road Improvements: New Orleans, LA</u></p> <p>Mr. Shifare serves as the project director and civil engineer for this project. The project includes removing the existing street, drainage and sewer structures and designing new alignment and profile, drainage and sewer structures. He was responsible for designing horizontal and vertical roadway alignment, drainage collection systems, water line replacements, sewer line replacements, geometrics of the streets as well as preparing both capital cost estimates and construction documents. improvements (drainage, sewer and water line improvement). The project entails roadway rehabilitation for six (6) blocks (2,100 ft) in the neighborhoods of B.W. Cooper, Gert Town and Dixon. This design of multiple streets is required to meet rehabilitation goals set by FEMA and CNO and the water line replacement program set by S&WB.</p>
02/20-08/24	<p><u>Bonnabel Bike Path: Metairie Rd to Levee: Jefferson Parish, LA</u></p> <p>Mr. Shifare serves as the project director and civil engineer for this project. The project requirements included both drainage analysis and A/E design services for the Bonnabel Bike Path (Metairie Rd to Levee line). Mr. Shifare served a lead role as a Pivotal Engineering staff and performed a drainage analysis to calculate 10-year discharge from the identified contributing areas.</p>
05/20- ongoing	<p><u>RR076 Lake Vista Group D: New Orleans, LA</u></p> <p>Mr. Shifare serves as the project director and civil engineer for this project. Pivotal is retained by City of New Orleans to provide roadway full reconstruction including subsurface improvements (drainage, sewer and water line improvement). The project entails roadway rehabilitation for five (5) blocks (1,750 ft) in the neighborhood of Lake Vista. This design of multiple streets is required to meet rehabilitation goals set by FEMA and CNO and water line replacement program set by S&WB. The project also included identifying and designing the geometrics of the streets, preparation of capital cost estimates and construction documents for the project.</p>

16. Staff Experience:

Résumés shall be provided for all prime and sub-consultant personnel listed in Sections 14 and/or 15 of the proposal. Résumés of personnel not identified in Section 14 or Section 15 of the proposal should not be included and will not be evaluated. Résumés **are limited to 2 pages per person**. Any certificates required by the advertisement are to be placed in Section 20.

Firm employed by Pivotal Engineering, LLC			
Name	Eliot Guerin, P.E.		Years of relevant experience with this employer
Title	Civil Engineer		Years of relevant experience with other employer(s)
Degree(s) / Years / Specialization		B.S. / 2018 / Civil Engineering	
Active registration number / state / expiration date		Louisiana PE#47729 / 09/30/2025	
Year registered	2023	Discipline	Civil
Contract role(s) / brief description of responsibilities		<p>Mr. Guerin is a civil designer with over 4 years of experience at Pivotal Engineering. Throughout this time, he has focused on design of roadways, sanitary sewer systems and storm drainage collection systems (including applicable green infrastructure components) More specifically, he is well-established in traffic analyses, pavement structural design, use of geosynthetics, geometric design, line and grade analyses, pavement marking, intersection improvements, pedestrian and bicycle lanes or paths, excavation and embankment, traffic, drainage/storm water management, water and wastewater, and landfills. He is a very competent design engineer with strong skillset in hydraulic & hydrologic modeling and AutoCAD Civil 3D.</p>	
Experience dates (mm/yy–mm/yy)	Experience and qualifications relevant to the proposed contract; <i>i.e.</i> , “designed drainage”, “designed girders”, “designed intersection”, etc. Experience dates should cover the years of experience specified in the applicable MPR(s).		
08/19- ongoing	<p><u>RR016 BW Cooper Gert Town Dixon Group C: New Orleans, LA</u></p> <p>Mr. Guerin serves as a civil designer for this project. The project includes the rehabilitation of nine (9) blocks of roadway (3245 ft) in the neighborhoods of B.W. Cooper, Gert Town and Dixon. Mr. Mehta is responsible for designing horizontal and vertical roadway alignment, drainage collection systems, water line replacements, sewer line replacements, geometrics of the streets as well as preparing both capital cost estimates and construction documents.</p>		
08/19- ongoing	<p><u>RR017 BW Cooper Gert Town Dixon Group D: New Orleans, LA</u></p> <p>Mr. Guerin serves as a civil designer for this project. Pivotal is retained by City of New Orleans to provide Construction Engineering and Resident Inspection for full roadway reconstruction including subsurface improvements (drainage, sewer and water line improvement). The project entails roadway rehabilitation for twelve (12) blocks (4,015 ft) in the neighborhoods of B.W. Cooper, Gert Town and Dixon. This design of multiple streets is required to meet rehabilitation goals set by FEMA and CNO and water line replacement program set by S&WB. The project also included identifying and designing the geometrics of the streets, preparation of capital cost estimates and construction documents for the project. The project entails roadway rehabs to 12 blocks (4,015 ft) in the neighborhood of B.W. Cooper, Gert Town and Dixon.</p>		

08/19- ongoing	<p><u>RR018 BW Cooper Gert Town Dixon Group E (New Orleans, LA)</u></p> <p>Mr. Guerin serves as a civil designer for this project. Pivotal is retained by City of New Orleans to provide roadway full reconstruction including subsurface improvements (drainage, sewer and water line improvement). The project entails roadway rehabilitation for fifteen (15) blocks (6,075 ft) in the neighborhoods of B.W. Cooper, Gert Town and Dixon. This design of multiple streets is required to meet rehabilitation goals set by FEMA and CNO and water line replacement program set by S&WB. The project also includes identifying and designing the geometrics of the streets, preparation of capital cost estimates and construction documents for the project.</p>
08/19- ongoing	<p><u>RR019 BW Cooper Gert Town Dixon Group F: New Orleans, LA</u></p> <p>Mr. Guerin serves as a civil designer for this project. Pivotal is retained by City of New Orleans to provide Design, Construction Engineering and Resident inspection for full roadway reconstruction, including subsurface improvements (drainage, sewer and water line improvement). The project entails roadway rehabilitation for six (6) blocks (2,100 ft) in the neighborhoods of B.W. Cooper, Gert Town and Dixon. This design of multiple streets is required to meet rehabilitation goals set by FEMA and CNO and the water line replacement program set by S&WB. The project also included identifying and designing the geometrics of the streets, preparation of capital cost estimates and construction documents for the project.</p>
06/17-09/22	<p><u>Wright Road Improvements: New Orleans.</u></p> <p>Mr. Guerin serves as a civil designer for this project. The project includes removing the existing street, drainage and sewer structures and designing new alignment and profile, drainage and sewer structures. He was responsible for designing horizontal and vertical roadway alignment, drainage collection systems, water line replacements, sewer line replacements, geometrics of the streets as well as preparing both capital cost estimates and construction documents. The project entails roadway rehabilitation for six (6) blocks (2,100 ft) in the neighborhoods of B.W. Cooper, Gert Town and Dixon. This design of multiple streets is required to meet rehabilitation goals set by FEMA and CNO and the water line replacement program set by S&WB. The project also included identifying and designing the geometrics of the streets, preparation of capital cost estimates and construction documents for the project.</p>
02/20-08/24	<p><u>Bonnabel Bike Path: Metairie Rd to Levee: Jefferson Parish, LA</u></p> <p>Mr. Guerin serves as a civil designer for this project. The project requirements included both drainage analysis and A/E design services for the Bonnabel Bike Path (Metairie Rd to Levee line). Mr. Guerin served a lead role as a Pivotal Engineering staff and performed a drainage analysis to calculate 10-year discharge from the identified contributing areas.</p>
05/20- ongoing	<p><u>RR076 Lake Vista Group D: New Orleans, LA</u></p> <p>Mr. Guerin serves as a civil designer for this project. Pivotal is retained by City of New Orleans to provide Design, Construction Engineering and Resident inspection for full roadway reconstruction, including subsurface improvements (drainage, sewer and water line improvement). The project entails roadway rehabilitation for five (5) blocks (1,750 ft) in the neighborhood of Lake Vista. This design of multiple streets is required to meet rehabilitation goals set by FEMA and CNO and water line replacement program set by S&WB. The project also included identifying and designing the geometrics of the streets, preparation of capital cost estimates and construction documents for the project.</p>

16. Staff Experience:

Résumés shall be provided for all prime and sub-consultant personnel listed in Sections 14 and/or 15 of the proposal. Résumés of personnel not identified in Section 14 or Section 15 of the proposal should not be included and will not be evaluated. Résumés **are limited to 2 pages per person.** Any certificates required by the advertisement are to be placed in Section 20.

Firm employed by Pivotal Engineering, LLC			
Name	Bassam Mekari, P.E.		Years of relevant experience with this employer 12
Title	Sr. Electrical Engineer		Years of relevant experience with other employer(s) 25
Degree(s) / Years / Specialization		BS in Electrical Engineering, 1987, Louisiana State University	
Active registration number / state / expiration date		Louisiana PE#31801 / 03/31/2025	
Year registered	1990	Discipline	Electrical
Contract role(s) / brief description of responsibilities		Mr. Mekari serves as the principal of Pivotal Engineering and the Engineering Manager in charge of all of the electrical engineering projects. He has developed tremendous experience in designing and installing Medium and Low Voltage Electrical Distribution Systems for commercial and industrial facilities lift stations, water treatment plants, Schools, Justice Centers, Police Stations, and industrial Thermal Reactors. He also designed/built electrical sub-stations for industrial systems and supervised actual installations throughout the US and worldwide. Mr. Mekari has designed over 200 electrical projects and will be instrumental in the overall plant electrical systems design. He also developed tremendous experience in sizing VFDs, UPSs, LED lighting, Dry and Liquid-Fill Transformers, Motors, Medium and Low Voltage Grounding Systems, Panelboards and Switch Gears, ATSS, Back Up Generators and possesses hands on field installations' experience and construction administration. Mr. Mekari developed expertise is all applicable codes pertaining to his projects such as NEC, NFPA 70E, NFPA 820, UL and local codes.	
Experience dates (mm/yy–mm/yy)	Experience and qualifications relevant to the proposed contract; <i>i.e.</i> , “designed drainage”, “designed girders”, “designed intersection”, etc. Experience dates should cover the years of experience specified in the applicable MPR(s).		
06/18- 2020	<u>Causeway Street Lighting Improvements; Jefferson Parish, LA</u> Mr. Mekari served as the project main Electrical Engineer. Pivotal was retained by Jefferson Parish to provide design, construction administration and Resident Inspection Service Causeway Boulevard (Veterans Overpass to 6th Street) Street Lighting Improvement. The major scope of the improvement is removal and replacement of existing lighting system. The CA and RI service also includes coordinating, contractor and utility companies in conformance to the construction documents of the project. The project is valued at \$842,000.		

16. Staff Experience:

Résumés shall be provided for all prime and sub-consultant personnel listed in Sections 14 and/or 15 of the proposal. Résumés of personnel not identified in Section 14 or Section 15 of the proposal should not be included and will not be evaluated. Résumés **are limited to 2 pages per person**. Any certificates required by the advertisement are to be placed in Section 20.

Firm employed by Pivotal Engineering, LLC			
Name	Darius Cook		Years of relevant experience with this employer
Title	Project/Construction Manager		Years of relevant experience with other employer(s)
Degree(s) / Years / Specialization			
Active registration number / state / expiration date		LDEQ Asbestos Inspector; Asbestos Contractor/Supervisor; LDEQ Lead Inspector	
Year registered		Discipline	
Contract role(s) / brief description of responsibilities		Mr. Cook is experienced with overseeing the overall construction activities of the project; preparing daily diary reports of the construction activities; keeping daily, weekly and monthly quantities for the job cost tracking; meeting with contractor and owner's representatives to discuss job progress, concerns, project milestone dates, and contract time and scope; and interacting with the client to make sure all concerns and needs are addressed.	
Experience dates (mm/yy–mm/yy)	Experience and qualifications relevant to the proposed contract; <i>i.e.</i> , “designed drainage”, “designed girders”, “designed intersection”, etc. Experience dates should cover the years of experience specified in the applicable MPR(s).		
08/19- ongoing	<u>RR016 BW Cooper Gert Town Dixon Group C: New Orleans, LA</u> Mr. Cook serves as a Construction Manager for this project. The project includes the rehabilitation of nine (9) blocks of roadway (3245 ft) in the neighborhoods of B.W. Cooper, Gert Town and Dixon. Mr. Cook is responsible for designing horizontal and vertical roadway alignment, drainage collection systems, water line replacements, sewer line replacements, geometrics of the streets as well as preparing both capital cost estimates and construction documents.		
08/19- ongoing	<u>RR017 BW Cooper Gert Town Dixon Group D: New Orleans, LA</u> Mr. Cook serves as a Construction Manager for this project. Pivotal is retained by City of New Orleans to provide Design, Construction Engineering and Resident inspection for full roadway reconstruction, including subsurface improvements (drainage, sewer and water line improvement). The project entails roadway rehabilitation for twelve (12) blocks (4,015 ft) in the neighborhoods of B.W. Cooper, Gert Town and Dixon. This design of multiple streets is required to meet rehabilitation goals set by FEMA and CNO and water line replacement program set by S&WB. The project also included identifying and designing the geometrics of the streets, preparation of capital cost estimates and construction documents for the project. The project entails roadway rehabs to 12 blocks (4,015 ft) in the neighborhood of B.W. Cooper, Gert Town and Dixon.		
08/19- ongoing	<u>RR018 BW Cooper Gert Town Dixon Group E (New Orleans, LA)</u> Mr. Cook serves as a Construction Manager for this project. Pivotal is retained by City of New Orleans to provide roadway full reconstruction including subsurface improvements (drainage, sewer and water line improvement). The project entails roadway rehabilitation for fifteen (15) blocks (6,075 ft) in the neighborhoods of B.W. Cooper, Gert Town and Dixon. This design of		

	multiple streets are required to meet rehabilitation goals set by FEMA and CNO and water line replacement program set by S&WB. The project also includes identifying and designing the geometrics of the streets, preparation of capital cost estimates and construction documents for the project.
08/19- ongoing	<p><u>RR019 BW Cooper Gert Town Dixon Group F: New Orleans, LA</u></p> <p>Mr. Cook serves as a Construction Manager for this project. Pivotal is retained by City of New Orleans to provide roadway full reconstruction including subsurface improvements (drainage, sewer and water line improvement). The project entails roadway rehabilitation for six (6) blocks (2,100 ft) in the neighborhoods of B.W. Cooper, Gert Town and Dixon. This design of multiple streets is required to meet rehabilitation goals set by FEMA and CNO and the water line replacement program set by S&WB. The project also included identifying and designing the geometrics of the streets, preparation of capital cost estimates and construction documents for the project.</p>
06/17-09/22	<p><u>Wright Road Improvements: New Orleans, LA</u></p> <p>Mr. Cook serves as a Construction Manager for this project. The project includes removing the existing street, drainage and sewer structures and designing new alignment and profile, drainage and sewer structures. He was responsible for designing horizontal and vertical roadway alignment, drainage collection systems, water line replacements, sewer line replacements, geometrics of the streets as well as preparing both capital cost estimates and construction documents. The project entails roadway rehabilitation for six (6) blocks (2,100 ft) in the neighborhoods of B.W. Cooper, Gert Town and Dixon. This design of multiple streets is required to meet rehabilitation goals set by FEMA and CNO and the water line replacement program set by S&WB. The project also included identifying and designing the geometrics of the streets, preparation of capital cost estimates and construction documents for the project.</p>
02/20-08/24	<p><u>Bonnabel Bike Path: Metairie Rd to Levee: Jefferson Parish, LA</u></p> <p>Mr. Cook serves as a Construction Manager The project requirements included both drainage analysis and A/E design services for the Bonnabel Bike Path (Metairie Rd to Levee line). Mr. Cook served a lead role as a Pivotal Engineering staff and performed a drainage analysis to calculate 10-year discharge from the identified contributing areas.</p>
05/20- ongoing	<p><u>RR076 Lake Vista Group D: New Orleans,</u></p> <p>Mr. Cook serves as a Construction Manager for this project. Pivotal is retained by City of New Orleans to provide Design, Construction Engineering and Resident inspection for full roadway reconstruction. including subsurface improvements (drainage, sewer and water line improvement). The project entails roadway rehabilitation for five (5) blocks (1,750 ft) in the neighborhood of Lake Vista. This design of multiple streets is required to meet rehabilitation goals set by FEMA and CNO and water line replacement program set by S&WB. The project also included identifying and designing the geometrics of the streets, preparation of capital cost estimates and construction documents for the project.</p>

16. Staff Experience:

Résumés shall be provided for all prime and sub-consultant personnel listed in Sections 14 and/or 15 of the proposal. Résumés of personnel not identified in Section 14 or Section 15 of the proposal should not be included and will not be evaluated. Résumés **are limited to 2 pages per person**. Any certificates required by the advertisement are to be placed in Section 20.

Firm employed by Pivotal Engineering, LLC			
Name	James N Seal Jr		Years of relevant experience with this employer
Title	Inspector		Years of relevant experience with other employer(s)
Degree(s) / Years / Specialization		B.S./ 2022 / Construction Management	
Active registration number / state / expiration date		N/A	
Year registered	N/A	Discipline	N/A
Contract role(s) / brief description of responsibilities		Mr. Seal serves as a Construction Project Manager of Pivotal Engineering in charge of Civil/Transportation engineering projects construction management. He has over 20 years project and construction management experience for public and municipal infrastructures. Mr. Seal has successfully completed the Site Inspector and Project Delivery Manager courses at FEMA Emergency Management Institute. In addition, Mr. Seal has extensive training and experience in Hazzard Mitigation. He served as a FEMA contractor, deployed in Miami Florida for hurricane Irma where he managed the repair or replacement of various water and wastewater facilities, recreational facilities as well as beach erosion assessments. In addition, Mr. Seal Served as a Project manager on a program management team to provide administrative and technical services for FEMA related Katrina recovery projects in St. Bernard Parish, Louisiana. Projects involved in the program included various types of sewer lift station, sewage treatment plant, gravity sewer system, sewer force main, water treatment plant, water tower and distribution, fire hydrants, fire stations, drainage pump station, building, and recreational projects.	
Experience dates (mm/yy–mm/yy)	Experience and qualifications relevant to the proposed contract; <i>i.e.</i> , “designed drainage”, “designed girders”, “designed intersection”, etc. Experience dates should cover the years of experience specified in the applicable MPR(s).		
08/19-Ongoing	<u>RR016 BW Cooper Gert Town Dixon Group C: New Orleans, LA</u> Mr. Seal serves as construction inspector for this project. The project includes the rehabilitation of nine (9) blocks of roadway (3245 ft) in the neighborhoods of B.W. Cooper, Gert Town and Dixon.		
08/19-Ongoing	<u>RR017 BW Cooper Gert Town Dixon Group D: New Orleans, LA</u> Mr. Seal serves as construction inspector for this project. Pivotal is retained by City of New Orleans to provide roadway full reconstruction including subsurface improvements (drainage, sewer and water line improvement). The project entails roadway rehabilitation for twelve (12) blocks (4,015 ft) in the neighborhoods of B.W. Cooper, Gert Town and Dixon. This design of multiple streets is required to meet rehabilitation goals set by FEMA and CNO and water line replacement program set by S&WB. The project also included identifying and designing the geometrics of the streets, preparation of capital cost estimates and construction documents for the project.		

08/19-Ongoing	<p><u>RR018 BW Cooper Gert Town Dixon Group E (New Orleans, LA)</u></p> <p>Mr. Seal serves as construction inspector for this project. Pivotal is retained by City of New Orleans to provide roadway full reconstruction including subsurface improvements (drainage, sewer and water line improvement). The project entails roadway rehabilitation for fifteen (15) blocks (6,075 ft) in the neighborhoods of B.W. Cooper, Gert Town and Dixon. This design of multiple streets is required to meet rehabilitation goals set by FEMA and CNO and water line replacement program set by S&WB. The project also includes identifying and designing the geometrics of the streets, preparation of capital cost estimates and construction documents for the project.</p>
08/19-Ongoing	<p><u>RR019 BW Cooper Gert Town Dixon Group F: New Orleans, LA</u></p> <p>Mr. Seal serves as construction inspector for this project. Pivotal is retained by City of New Orleans to provide roadway full reconstruction including subsurface improvements (drainage, sewer and water line improvement). The project entails roadway rehabilitation for six (6) blocks (2,100 ft) in the neighborhoods of B.W. Cooper, Gert Town and Dixon. This design of multiple streets is required to meet rehabilitation goals set by FEMA and CNO and the water line replacement program set by S&WB. The project also included identifying and designing the geometrics of the streets, preparation of capital cost estimates and construction documents for the project.</p>
06/17-09/22	<p><u>Wright Road Improvements: New Orleans, LA</u></p> <p>Mr. Seal serves as construction inspector for this project. The project entails roadway rehabs to 4 blocks (2435 ft). The resident inspection services are required to verify that the construction meets the plans and specs, rehabilitation goals set by FEMA and CNO, and water line replacement program set by S&WB. Since Pivotal is the design engineering firm of this project the resident inspection and coordination is outstanding. The CA and RI service also includes coordinating, contractor and utility companies in conformance to the construction documents of the project.</p>

16. Staff Experience:

Résumés shall be provided for all prime and sub-consultant personnel listed in Sections 14 and/or 15 of the proposal. Résumés of personnel not identified in Section 14 or Section 15 of the proposal should not be included and will not be evaluated. Résumés **are limited to 2 pages per person**. Any certificates required by the advertisement are to be placed in Section 20.

Firm employed by Pivotal Engineering, LLC			
Name	Prabin Shrestha		Years of relevant experience with this employer
Title	CADD Drafter/ Civil Designer		Years of relevant experience with other employer(s)
Degree(s) / Years / Specialization		B.S. / 2019 / Civil Engineering	
Active registration number / state / expiration date		N/A	
Year registered	N/A	Discipline	N/A
Contract role(s) / brief description of responsibilities		Mr. Shrestha serves as a civil designer/CADD drafter and inspector for Pivotal Engineering. Mr. Shrestha is responsible for preparing civil engineering drawings (using Autodesk Civil 3D CAD) in line with established standards and procedures and preparing schematic, design development, and final (construction) drawings as required.	
Experience dates (mm/yy–mm/yy)	Experience and qualifications relevant to the proposed contract; <i>i.e.</i> , “designed drainage”, “designed girders”, “designed intersection”, etc. Experience dates should cover the years of experience specified in the applicable MPR(s).		
08/19-Ongoing	<u>RR016 BW Cooper Gert Town Dixon Group C: New Orleans, LA</u> Mr. Shrestha serves as the civil designer for this project. The project includes the rehabilitation of nine (9) blocks of roadway (3245 ft) in the neighborhoods of B.W. Cooper, Gert Town and Dixon. He is responsible for designing horizontal and vertical roadway alignment, drainage collection systems, water line replacements, and sewer line replacements.		
08/19-Ongoing	<u>RR017 BW Cooper Gert Town Dixon Group D: New Orleans, LA</u> Mr. Shrestha serves as the civil designer for this project. Pivotal is retained by City of New Orleans to provide roadway full reconstruction including subsurface improvements (drainage, sewer and water line improvement). The project entails roadway rehabilitation for twelve (12) blocks (4,015 ft) in the neighborhoods of B.W. Cooper, Gert Town and Dixon. This design of multiple streets is required to meet rehabilitation goals set by FEMA and CNO and water line replacement program set by S&WB. The project also included identifying and designing the geometrics of the streets, preparation of capital cost estimates and construction documents for the project. The project entails roadway rehabs to 12 blocks (4,015 ft) in the neighborhood of B.W. Cooper, Gert Town and Dixon.		
08/19-Ongoing	<u>RR018 BW Cooper Gert Town Dixon Group E (New Orleans, LA</u> Mr. Shrestha serves as the civil designer for this project. Pivotal is retained by City of New Orleans to provide roadway full reconstruction including subsurface improvements (drainage, sewer and water line improvement). The project entails roadway rehabilitation for fifteen (15) blocks (6,075 ft) in the neighborhoods of B.W. Cooper, Gert Town and Dixon. This design of multiple streets is required to meet rehabilitation goals set by FEMA and CNO and water line replacement program set by S&WB. The project also includes identifying and designing the geometrics of the streets, preparation of capital cost estimates and construction documents for the project.		

08/19-Ongoing	<p><u>RR019 BW Cooper Gert Town Dixon Group F: New Orleans, LA</u></p> <p>Mr. Shrestha serves as the civil designer for this project. Pivotal is retained by City of New Orleans to provide roadway full reconstruction including subsurface improvements (drainage, sewer and water line improvement). The project entails roadway rehabilitation for six (6) blocks (2,100 ft) in the neighborhoods of B.W. Cooper, Gert Town and Dixon. This design of multiple streets is required to meet rehabilitation goals set by FEMA and CNO and the water line replacement program set by S&WB. The project also included identifying and designing the geometrics of the streets, preparation of capital cost estimates and construction documents for the project.</p>
05/20-Ongoing	<p><u>RR076 Lake Vista Group D: New Orleans, LA</u></p> <p>Mr. Shrestha serves as the civil designer for this project. Pivotal is retained by City of New Orleans to provide roadway full reconstruction including subsurface improvements (drainage, sewer and water line improvement). The project entails roadway rehabilitation for five (5) blocks (1,750 ft) in the neighborhood of Lake Vista. This design of multiple streets is required to meet rehabilitation goals set by FEMA and CNO and water line replacement program set by S&WB. The project also included identifying and designing the geometrics of the streets, preparation of capital cost estimates and construction documents for the project.</p>

16. Staff Experience:

Résumés shall be provided for all prime and sub-consultant personnel listed in Sections 14 and/or 15 of the proposal. Résumés of personnel not identified in Section 14 or Section 15 of the proposal should not be included and will not be evaluated. Résumés **are limited to 2 pages per person**. Any certificates required by the advertisement are to be placed in Section 20.

Firm employed by Pivotal Engineering, LLC			
Name	Richard A. Baudier		Years of relevant experience with this employer
Title	Inspector		Years of relevant experience with other employer(s)
Degree(s) / Years / Specialization		A.S. / 1990 / Electronic Engineering	
Active registration number / state / expiration date		N/A	
Year registered	N/A	Discipline	N/A
Contract role(s) / brief description of responsibilities		Mr. Baudier serves as a bridge and roadway inspector for Pivotal Engineering. Mr. Baudier has forty-one years of experience as a bridge and roadway inspector for various projects that include cast-in-place structural concrete for bridge and roadway constructions. His experience also includes Installation and repair of underground utilities in and around the New Orleans area with emphasis on: Sewer, sewer force mains, water mains, drainage, electrical conduit and related structures. Mr. Baudier is also responsible for Operation, repair, maintenance, and capacities of construction equipment, estimating, submitting proposals, monthly estimates, purchasing, change orders, quantity verifications, and cost control reporting.	
Experience dates (mm/yy–mm/yy)	Experience and qualifications relevant to the proposed contract; <i>i.e.</i> , “designed drainage”, “designed girders”, “designed intersection”, etc. Experience dates should cover the years of experience specified in the applicable MPR(s).		
08/19-Ongoing	<p><u>RR016 BW Cooper Gert Town Dixon Group C: New Orleans, LA</u></p> <p>Mr. Baudier serves as a construction inspector for this project. He is one of Pivotal’s inspectors, providing on-site oversight and drafting daily reports of the project’s daily quantities. The project includes the rehabilitation of nine (9) blocks of roadway (3245 ft) in the neighborhoods of B.W. Cooper, Gert Town and Dixon.</p>		
08/19-Ongoing	<p><u>RR017 BW Cooper Gert Town Dixon Group D: New Orleans, LA</u></p> <p>Mr. Baudier serves as a construction inspector for this project. He is one of Pivotal’s inspectors, providing on-site oversight and drafting daily reports of the project’s daily quantities. Pivotal is retained by City of New Orleans to provide roadway full reconstruction including subsurface improvements (drainage, sewer and water line improvement). The project entails roadway rehabilitation for twelve (12) blocks (4,015 ft) in the neighborhoods of B.W. Cooper, Gert Town and Dixon. This design of multiple streets is required to meet rehabilitation goals set by FEMA and CNO and water line replacement program set by S&WB. The project also included identifying and designing the geometrics of the streets, preparation of capital cost estimates and construction documents for the project.</p>		

08/19-Ongoing	<p><u>RR018 BW Cooper Gert Town Dixon Group E (New Orleans, LA)</u></p> <p>Mr. Baudier serves as a construction inspector for this project. He is one of Pivotal's inspectors, providing on-site oversight and drafting daily reports of the project's daily quantities. Pivotal is retained by City of New Orleans to provide roadway full reconstruction including subsurface improvements (drainage, sewer and water line improvement). The project entails roadway rehabilitation for fifteen (15) blocks (6,075 ft) in the neighborhoods of B.W. Cooper, Gert Town and Dixon. This design of multiple streets is required to meet rehabilitation goals set by FEMA and CNO and water line replacement program set by S&WB. The project also includes identifying and designing the geometrics of the streets, preparation of capital cost estimates and construction documents for the project.</p>
08/19-Ongoing	<p><u>RR019 BW Cooper Gert Town Dixon Group F: New Orleans, LA</u></p> <p>Mr. Baudier serves as a construction inspector for this project. He is one of Pivotal's inspectors, providing on-site oversight and drafting daily reports of the project's daily quantities. Pivotal is retained by City of New Orleans to provide roadway full reconstruction including subsurface improvements (drainage, sewer and water line improvement). The project entails roadway rehabilitation for six (6) blocks (2,100 ft) in the neighborhoods of B.W. Cooper, Gert Town and Dixon. This design of multiple streets is required to meet rehabilitation goals set by FEMA and CNO and the water line replacement program set by S&WB. The project also included identifying and designing the geometrics of the streets, preparation of capital cost estimates and construction documents for the project.</p>

16. Staff Experience:

Résumés shall be provided for all prime and sub-consultant personnel listed in Sections 14 and/or 15 of the proposal. Résumés of personnel not identified in Section 14 or Section 15 of the proposal should not be included and will not be evaluated. Résumés **are limited to 2 pages per person**. Any certificates required by the advertisement are to be placed in Section 20.

Firm employed by Pivotal Engineering, LLC			
Name	Levon Demetris Wright		Years of relevant experience with this employer
Title	Inspector		Years of relevant experience with other employer(s)
Degree(s) / Years / Specialization		B.S. / 2004 / Civil Engineering	
Active registration number / state / expiration date		N/A	
Year registered	N/A	Discipline	N/A
Contract role(s) / brief description of responsibilities		Mr. Wright has over 20 years of experience in transportation construction inspection. He excels in coordinating tasks and is effective at managing multiple priorities under tight deadlines. Mr. Wright is highly capable of providing solutions for complex problems while on site. His responsibilities include direct supervision of team members, budget management, reporting, documenting procedures, problem solving, and demonstrating knowledge of applicable laws, regulations, and contract review.	
Experience dates (mm/yy–mm/yy)	Experience and qualifications relevant to the proposed contract; <i>i.e.</i> , “designed drainage”, “designed girders”, “designed intersection”, etc. Experience dates should cover the years of experience specified in the applicable MPR(s).		
08/19-Ongoing	<u>RR016 BW Cooper Gert Town Dixon Group C: New Orleans, LA</u> Mr. Wright serves as a construction inspector for this project. He is one of Pivotal’s inspectors, providing on-site oversight and drafting daily reports of the project’s daily quantities. The project includes the rehabilitation of nine (9) blocks of roadway (3245 ft) in the neighborhoods of B.W. Cooper, Gert Town and Dixon.		
08/19-Ongoing	<u>RR017 BW Cooper Gert Town Dixon Group D: New Orleans, LA</u> Mr. Wright serves as a construction inspector for this project. He is one of Pivotal’s inspectors, providing on-site oversight and drafting daily reports of the project’s daily quantities. Pivotal is retained by City of New Orleans to provide roadway full reconstruction including subsurface improvements (drainage, sewer and water line improvement). The project entails roadway rehabilitation for twelve (12) blocks (4,015 ft) in the neighborhoods of B.W. Cooper, Gert Town and Dixon. This design of multiple streets is required to meet rehabilitation goals set by FEMA and CNO and water line replacement program set by S&WB. The project also included identifying and designing the geometrics of the streets, preparation of capital cost estimates and construction documents for the project.		

08/19-Ongoing	<p><u>RR018 BW Cooper Gert Town Dixon Group E (New Orleans, LA)</u></p> <p>Mr. Wright serves as a construction inspector for this project. He is one of Pivotal's inspectors, providing on-site oversight and drafting daily reports of the project's daily quantities. Pivotal is retained by City of New Orleans to provide roadway full reconstruction including subsurface improvements (drainage, sewer and water line improvement). The project entails roadway rehabilitation for fifteen (15) blocks (6,075 ft) in the neighborhoods of B.W. Cooper, Gert Town and Dixon. This design of multiple streets is required to meet rehabilitation goals set by FEMA and CNO and water line replacement program set by S&WB. The project also includes identifying and designing the geometrics of the streets, preparation of capital cost estimates and construction documents for the project.</p>
08/19-Ongoing	<p><u>RR019 BW Cooper Gert Town Dixon Group F: New Orleans, LA</u></p> <p>Mr. Wright serves as a construction inspector for this project. He is one of Pivotal's inspectors, providing on-site oversight and drafting daily reports of the project's daily quantities. Pivotal is retained by City of New Orleans to provide roadway full reconstruction including subsurface improvements (drainage, sewer and water line improvement). The project entails roadway rehabilitation for six (6) blocks (2,100 ft) in the neighborhoods of B.W. Cooper, Gert Town and Dixon. This design of multiple streets is required to meet rehabilitation goals set by FEMA and CNO and the water line replacement program set by S&WB. The project also included identifying and designing the geometrics of the streets, preparation of capital cost estimates and construction documents for the project.</p>

16. Staff Experience:

Résumés shall be provided for all prime and sub-consultant personnel listed in Sections 14 and/or 15 of the proposal. Résumés of personnel not identified in Section 14 or Section 15 of the proposal should not be included and will not be evaluated. Résumés **are limited to 2 pages per person**. Any certificates required by the advertisement are to be placed in Section 20.

Firm employed by Pivotal Engineering, LLC			
Name	Terry Gerdes		Years of relevant experience with this employer
Title	CADD Drafter/ Civil Designer		Years of relevant experience with other employer(s)
Degree(s) / Years / Specialization		A.S. / CADD	
Active registration number / state / expiration date		N/A	
Year registered	N/A	Discipline	N/A
Contract role(s) / brief description of responsibilities		Terry Gerdes serves Pivotal as a designer/drafter concentrating on roadway and utility design as well as architectural design. He produces conceptual plans, renderings and documents, and works in tandem with highly collaborative multi-discipline design teams. Mr. Gerdes designs for civil, roadway, and highway reconstruction which includes drainages, levee systems, sewage, structural systems, plans and profile and cross sections.	
Experience dates (mm/yy–mm/yy)	Experience and qualifications relevant to the proposed contract; <i>i.e.</i> , “designed drainage”, “designed girders”, “designed intersection”, etc. Experience dates should cover the years of experience specified in the applicable MPR(s).		
08/19-Ongoing	<u>RR017 BW Cooper Gert Town Dixon Group D: New Orleans, LA</u> Mr. Gerdes serves as a civil designer for this project. Pivotal is retained by City of New Orleans to provide Construction Engineering and Resident Inspection services for full roadway reconstruction including subsurface improvements (drainage, sewer and water line improvement). The project entails roadway rehabilitation for twelve (12) blocks (4,015 ft) in the neighborhoods of B.W. Cooper, Gert Town and Dixon. This design of multiple streets is required to meet rehabilitation goals set by FEMA and CNO and water line replacement program set by S&WB.		
08/19-Ongoing	<u>RR018 BW Cooper Gert Town Dixon Group E (New Orleans, LA</u> Mr. Gerdes serves as a civil designer for this project. Pivotal is retained by City of New Orleans to provide Construction Engineering and Resident Inspection services for full roadway reconstruction including subsurface improvements (drainage, sewer and water line improvement). The project entails roadway rehabilitation for fifteen (15) blocks (6,075 ft) in the neighborhoods of B.W. Cooper, Gert Town and Dixon. This design of multiple streets is required to meet rehabilitation goals set by FEMA and CNO and water line replacement program set by S&WB. The project also includes identifying and designing the geometrics of the streets, preparation of capital cost estimates and construction documents for the project.		
08/19-Ongoing	<u>RR019 BW Cooper Gert Town Dixon Group F: New Orleans, LA</u> Mr. Gerdes serves as a designer for this project. Pivotal is retained by City of New Orleans to provide Construction Engineering and Resident Inspection services for full road reconstruction including subsurface improvements (drainage, sewer and water line improvement). The project entails roadway rehabilitation for six (6) blocks (2,100 ft) in the neighborhoods of B.W. Cooper, Gert Town and Dixon. This design of multiple streets is required to meet rehabilitation goals set by FEMA and CNO and the water line replacement program set by S&WB. The project also included identifying and designing the geometrics of the streets, preparation of capital cost estimates and construction documents for the project.		

05/20-Ongoing	<p><u>RR076 Lake Vista Group D; New Orleans, LA</u></p> <p>Mr. Gerdes serves as a designer for this project. Pivotal is retained by City of New Orleans to provide roadway full reconstruction including subsurface improvements (drainage, sewer and water line improvement). The project entails roadway rehabilitation for five (5) blocks (1,750 ft) in the neighborhood of Lake Vista. This design of multiple streets is required to meet rehabilitation goals set by FEMA and CNO and water line replacement program set by S&WB. The project also included identifying and designing the geometrics of the streets, preparation of capital cost estimates and construction documents for the project.</p>
---------------	--

16. Staff Experience:

Résumés shall be provided for all prime and sub-consultant personnel listed in Sections 14 and/or 15 of the proposal. Résumés of personnel not identified in Section 14 or Section 15 of the proposal should not be included and will not be evaluated. Résumés **are limited to 2 pages per person**. Any certificates required by the advertisement are to be placed in Section 20.

Firm employed by Pivotal Engineering, LLC			
Name	Elena LeBlanc		Years of relevant experience with this employer
Title	GIS Analyst		Years of relevant experience with other employer(s)
Degree(s) / Years / Specialization		B.S. / 2019/ Industrial Engineering	
Active registration number / state / expiration date		N/A	
Year registered	N/A	Discipline	N/A
Contract role(s) / brief description of responsibilities		Ms. LeBlanc serves as a GIS analyst and quality control specialist at Pivotal Engineering, LLC in support of projects across all departments. She has experience in data collection, data management, large-scale roadway & disaster recovery projects, project planning & development, lean & six sigma, and community outreach. Ms. LeBlanc has organized incoming data while providing QA/QC that positively impacted project success.	
Experience dates (mm/yy–mm/yy)	Experience and qualifications relevant to the proposed contract; <i>i.e.</i> , “designed drainage”, “designed girders”, “designed intersection”, etc. Experience dates should cover the years of experience specified in the applicable MPR(s).		
08/19-Ongoing	<u>RR016 BW Cooper Gert Town Dixon Group C: New Orleans, LA</u> Ms. LeBlanc serves as the GIA analyst for this project. The project includes the rehabilitation of nine (9) blocks of roadway (3245 ft) in the neighborhoods of B.W. Cooper, Gert Town and Dixon. She is responsible for data tracking of the drainage collection systems, water line replacements, sewer line replacements, and geometrics of the streets.		
08/19-Ongoing	<u>RR017 BW Cooper Gert Town Dixon Group D: New Orleans, LA</u> Ms. LeBlanc serves as the GIS analyst for this project. Pivotal is retained by City of New Orleans to provide roadway full reconstruction including subsurface improvements (drainage, sewer and water line improvement). The project entails roadway rehabilitation for twelve (12) blocks (4,015 ft) in the neighborhoods of B.W. Cooper, Gert Town and Dixon. This design of multiple streets is required to meet rehabilitation goals set by FEMA and CNO and water line replacement program set by S&WB. The project also included identifying and designing the geometrics of the streets, preparation of capital cost estimates and construction documents for the project. The project entails roadway rehabs to 12 blocks (4,015 ft) in the neighborhood of B.W. Cooper, Gert Town and Dixon. She is responsible for data tracking of the drainage collection systems, water line replacements, sewer line replacements, and geometrics of the streets.		
08/19-Ongoing	<u>RR018 BW Cooper Gert Town Dixon Group E (New Orleans, LA</u> Ms. LeBlanc serves as the GIS analyst for this project. Pivotal is retained by City of New Orleans to provide roadway full reconstruction including subsurface improvements (drainage, sewer and water line improvement). The project entails roadway rehabilitation for fifteen (15) blocks (6,075 ft) in the neighborhoods of B.W. Cooper, Gert Town and Dixon. This design of multiple streets is required to meet rehabilitation goals set by FEMA and CNO and water line replacement program set by S&WB. The project also includes identifying and designing the geometrics of the streets, preparation of capital cost estimates		

	and construction documents for the project. She is responsible for data tracking of the drainage collection systems, water line replacements, sewer line replacements, and geometrics of the streets.
08/19-Ongoing	<p><u>RR019 BW Cooper Gert Town Dixon Group F; New Orleans, LA</u></p> <p>Ms. LeBlanc serves as the GIS analyst for this project. Pivotal is retained by City of New Orleans to provide roadway full reconstruction including subsurface improvements (drainage, sewer and water line improvement). The project entails roadway rehabilitation for six (6) blocks (2,100 ft) in the neighborhoods of B.W. Cooper, Gert Town and Dixon. This design of multiple streets is required to meet rehabilitation goals set by FEMA and CNO and the water line replacement program set by S&WB. The project also included identifying and designing the geometrics of the streets, preparation of capital cost estimates and construction documents for the project. She is responsible for data tracking of the drainage collection systems, water line replacements, sewer line replacements, and geometrics of the streets.</p>
12/21-09/22	<p><u>Disaster Recovery Post-Hurricane Ida Street Light and Traffic Sign Assessment; New Orleans, LA</u></p> <p>Ms. LeBlanc assisted with the data tracking of street light/traffic sign assessments. She participated in the QA/QC of assessments, and documentation of the final report.</p>
12/21-09/22	<p><u>Disaster Recovery Post-Hurricane Ida Traffic Signal Construction Management; New Orleans, LA</u></p> <p>Ms. LeBlanc tracked the statuses of over 50 intersections throughout New Orleans, managing data of material quantities and compiling daily and weekly reports submitted to the city. She built out the real-time dashboard, used for clear data visualization. Ms. LeBlanc also tracked material costs in conjunction with the project budget.</p>

16. Staff Experience:

Résumés shall be provided for all prime and sub-consultant personnel listed in Sections 14 and/or 15 of the proposal. Résumés of personnel not identified in Section 14 or Section 15 of the proposal should not be included and will not be evaluated. Résumés **are limited to 2 pages per person**. Any certificates required by the advertisement are to be placed in Section 20.

Firm employed by Pivotal Engineering, LLC			
Name	Cheryl Price		Years of relevant experience with this employer
Title	Office Administrator		Years of relevant experience with other employer(s)
Degree(s) / Years / Specialization		B.A. / 1983 / Business Administration	
Active registration number / state / expiration date		N/A	
Year registered	N/A	Discipline	N/A
Contract role(s) / brief description of responsibilities		Mrs. Price serves as the HR Specialist/Office Administrator of Pivotal Engineering, LLC. She is responsible for providing the clerical support, human resource functions, and accounting for the company. Her tasks include creating and maintaining databases on projects; creating and maintaining files on employees, vendors, and projects; maintaining the office supplies inventory; maintaining the employee retirement accounts; processing and maintaining payroll records; prepare and issue checks; handle the accounts receivable and payable & generate monthly financial reports to the principals.	
Experience dates (mm/yy–mm/yy)	Experience and qualifications relevant to the proposed contract; <i>i.e.</i> , “designed drainage”, “designed girders”, “designed intersection”, etc. Experience dates should cover the years of experience specified in the applicable MPR(s).		
08/19-Ongoing	<u>RR016 BW Cooper Gert Town Dixon Group C; New Orleans, LA</u> Mrs. Price serves as the administrator for this project. The project includes the rehabilitation of nine (9) blocks of roadway (3245 ft) in the neighborhoods of B.W. Cooper, Gert Town and Dixon. Mrs. Price is responsible for creating and maintaining the database for this project and correspondence between pivotal and the client.		
08/19-Ongoing	<u>RR017 BW Cooper Gert Town Dixon Group D; New Orleans, LA</u> Mrs. Price serves as the administrator for this project. Pivotal is retained by City of New Orleans to provide roadway full reconstruction including subsurface improvements (drainage, sewer and water line improvement). The project entails roadway rehabilitation for twelve (12) blocks (4,015 ft) in the neighborhoods of B.W. Cooper, Gert Town and Dixon. This design of multiple streets is required to meet rehabilitation goals set by FEMA and CNO and water line replacement program set by S&WB. The project also included identifying and designing the geometrics of the streets, preparation of capital cost estimates and construction documents for the project. The project entails roadway rehabs to 12 blocks (4,015 ft) in the neighborhood of B.W. Cooper, Gert Town and Dixon. Mrs. Price is responsible for creating and maintaining the database for this project and correspondence between pivotal and the client.		
08/19-Ongoing	<u>RR018 BW Cooper Gert Town Dixon Group E (New Orleans, LA)</u> Mrs. Price serves as the administrator for this project. Pivotal is retained by City of New Orleans to provide roadway full reconstruction including subsurface improvements (drainage, sewer and water line improvement). The project entails roadway rehabilitation for fifteen (15) blocks (6,075 ft) in the neighborhoods of B.W. Cooper, Gert Town and Dixon. This design of multiple streets is required to meet rehabilitation goals set by FEMA and CNO and water line replacement program set by		

	S&WB. The project also includes identifying and designing the geometrics of the streets, preparation of capital cost estimates and construction documents for the project. Mrs. Price is responsible for creating and maintaining the database for this project and correspondence between pivotal and the client.
08/19-Ongoing	<u>RR019 BW Cooper Gert Town Dixon Group E: New Orleans, LA</u> Mrs. Price serves as the administrator for this project. Pivotal is retained by City of New Orleans to provide roadway full reconstruction including subsurface improvements (drainage, sewer and water line improvement). The project entails roadway rehabilitation for six (6) blocks (2,100 ft) in the neighborhoods of B.W. Cooper, Gert Town and Dixon. This design of multiple streets is required to meet rehabilitation goals set by FEMA and CNO and the water line replacement program set by S&WB. The project also included identifying and designing the geometrics of the streets, preparation of capital cost estimates and construction documents for the project. Mrs. Price is responsible for creating and maintaining the database for this project and correspondence between pivotal and the client.
06/17-09/22	<u>Wright Road Improvements: New Orleans, LA</u> Mrs. Price serves as the administrator for this project. The project includes removing the existing street, drainage and sewer structures and designing new alignment and profile, drainage and sewer structures. The project entails roadway rehabilitation for six (6) blocks (2,100 ft) in the neighborhoods of B.W. Cooper, Gert Town and Dixon. This design of multiple streets is required to meet rehabilitation goals set by FEMA and CNO and the water line replacement program set by S&WB. Mrs. Price is responsible for creating and maintaining the database for this project and correspondence between pivotal and the client.
02/20-08/24	<u>Bonnabel Bike Path: Metairie Rd to Levee: Jefferson Parish, LA</u> Mrs. Price serves as the administrator for this project. The project requirements included both drainage analysis and A/E design services for the Bonnabel Bike Path (Metairie Rd to Levee line). Mrs. Price is responsible for creating and maintaining the database for this project and correspondence between pivotal and the client.
05/20- Ongoing	<u>RR076 Lake Vista Group D: New Orleans, LA</u> Mrs. Price serves as the administrator for this project. Pivotal is retained by City of New Orleans to provide roadway full reconstruction including subsurface improvements (drainage, sewer and water line improvement). The project entails roadway rehabilitation for five (5) blocks (1,750 ft) in the neighborhood of Lake Vista. This design of multiple streets is required to meet rehabilitation goals set by FEMA and CNO and water line replacement program set by S&WB. The project also included identifying and designing the geometrics of the streets, preparation of capital cost estimates and construction documents for the project. Mrs. Price is responsible for creating and maintaining the database for this project and correspondence between pivotal and the client.

16. Staff Experience:

Résumés shall be provided for all prime and sub-consultant personnel listed in Sections 14 and/or 15 of the proposal. Résumés of personnel not identified in Section 14 or Section 15 of the proposal should not be included and will not be evaluated. Résumés **are limited to 2 pages per person**. Any certificates required by the advertisement are to be placed in Section 20.

Firm employed by Pivotal Engineering, LLC			
Name	Shi'Nece Cockheran		Years of relevant experience with this employer
Title	Administrative Assistant		Years of relevant experience with other employer(s)
Degree(s) / Years / Specialization		B.S. / 2014/ Sociology	
Active registration number / state / expiration date		N/A	
Year registered	N/A	Discipline	N/A
Contract role(s) / brief description of responsibilities		Ms. Cockheran serves as the Administrative Assistant at Pivotal Engineering. She has over 9 years of experience. Her responsibilities include drafting and editing proposal documents, providing support to principals and clients, answering and directing phone calls, and managing mail and packages. She is also responsible for attending client meetings and maintaining digital filing systems and proposal submittals.	
Experience dates (mm/yy–mm/yy)	Experience and qualifications relevant to the proposed contract; <i>i.e.</i> , “designed drainage”, “designed girders”, “designed intersection”, etc. Experience dates should cover the years of experience specified in the applicable MPR(s).		
08/19-Ongoing	<u>RR016 BW Cooper Gert Town Dixon Group C: New Orleans, LA</u> Ms. Cockheran serves as the administrative assistant to the project manager for this project. The project includes the rehabilitation of nine (9) blocks of roadway (3245 ft) in the neighborhoods of B.W. Cooper, Gert Town and Dixon. The project also included identifying and designing the geometrics of the streets, preparation of capital cost estimates and construction documents for the project.		
08/19-Ongoing	<u>RR017 BW Cooper Gert Town Dixon Group D: New Orleans, LA</u> Ms. Cockheran serves as the administrative assistant to the project manager for this project. Pivotal is retained by City of New Orleans to provide roadway full reconstruction including subsurface improvements (drainage, sewer and water line improvement). The project entails roadway rehabilitation for twelve (12) blocks (4,015 ft) in the neighborhoods of B.W. Cooper, Gert Town and Dixon. This design of multiple streets is required to meet rehabilitation goals set by FEMA and CNO and water line replacement program set by S&WB. The project also included identifying and designing the geometrics of the streets, preparation of capital cost estimates and construction documents for the project. The project entails roadway rehabs to 12 blocks (4,015 ft) in the neighborhood of B.W. Cooper, Gert Town and Dixon.		
08/19-Ongoing	<u>RR018 BW Cooper Gert Town Dixon Group E (New Orleans, LA)</u> Ms. Cockheran serves as the administrative assistant to the project manager for this project. Pivotal is retained by City of New Orleans to provide roadway full reconstruction including subsurface improvements (drainage, sewer and water line improvement). The project entails roadway rehabilitation for fifteen (15) blocks (6,075 ft) in the neighborhoods of B.W. Cooper, Gert Town and Dixon. This design of multiple streets is required to meet rehabilitation goals set by FEMA and CNO and water line replacement program set by S&WB. The project also includes identifying and designing the geometrics of the streets, preparation of capital cost estimates and construction documents for the project.		

08/19-Ongoing	<p><u>RR019 BW Cooper Gert Town Dixon Group F: New Orleans, LA</u></p> <p>Ms. Cockheran serves as the administrative assistant to the project manager for this project. Pivotal is retained by City of New Orleans to provide construction engineering and resident inspection services for full roadway reconstruction including subsurface improvements (drainage, sewer and water line improvement). The project entails roadway rehabilitation for six (6) blocks (2,100 ft) in the neighborhoods of B.W. Cooper, Gert Town and Dixon. This design of multiple streets is required to meet rehabilitation goals set by FEMA and CNO and the water line replacement program set by S&WB. The project also included identifying and designing the geometrics of the streets, preparation of capital cost estimates and construction documents for the project.</p>
05/20- Ongoing	<p><u>RR076 Lake Vista Group D: New Orleans, LA</u></p> <p>Ms. Cockheran serves as the administrative assistant to the project manager for this project. Pivotal is retained by City of New Orleans to provide construction engineering and resident inspection services for full roadway reconstruction including subsurface improvements (drainage, sewer and water line improvement). The project entails roadway rehabilitation for five (5) blocks (1,750 ft) in the neighborhood of Lake Vista. This design of multiple streets is required to meet rehabilitation goals set by FEMA and CNO and water line replacement program set by S&WB. The project also included identifying and designing the geometrics of the streets, preparation of capital cost estimates and construction documents for the project.</p>

16. Staff Experience:

Résumés shall be provided for all prime and sub-consultant personnel listed in Sections 14 and/or 15 of the proposal. Résumés of personnel not identified in Section 14 or Section 15 of the proposal should not be included and will not be evaluated. Résumés **are limited to 2 pages per person.**

Any certificates required by the advertisement are to be placed in Section 20.

(Add rows as needed)

Firm employed by GOTECH, Inc.			
Name	John Biggs		Years of relevant experience with this employer
Title	Survey Party Chief		Years of relevant experience with other employer(s)
Degree(s) / Years / Specialization	N/A		
Active registration number / state / expiration date	N/A		
Year registered	N/A	Discipline	N/A
Contract role(s) / brief description of responsibilities	<p>Mr. Biggs is presently a Survey Party Chief with over 20 years of survey experience. Mr. Biggs has a working knowledge of total station operation, EDM equipment, Fathometer/Hydro equipment, data collection and GPS equipment. He has been involved in nearly every aspect of field surveying to include:</p> <ul style="list-style-type: none"> - First order baseline traversing - Property boundary surveys - Cadastral layout - Cross section surveys - Topographic surveys - Construction layout - Automated hydrographic surveys - Photogrammetric surveys - Infra-structure surveys - Levee centerline profile surveys <ul style="list-style-type: none"> ▪ Certified Traffic Control Technician – ATSSA Expires 7/11/2027 ▪ Certified Traffic Control Supervisor – ATSSA Expires 7/12/2027 ▪ Registered Flagger – ATSSA Expires 10/21/2026 • OSHA 10-hour Construction Safety & Health • TWIC Expires 11/26/2024 • Security Passport – Safety Council – BR ID# 9711780 		
Experience dates (mm/yy–mm/yy)	Experience and qualifications relevant to the proposed contract; <i>i.e.</i> , “designed drainage”, “designed girders”, “designed intersection”, etc. Experience dates should cover the years of experience specified in the applicable MPR(s).		
09/21-08/22	<p>LA DOTD (4400017068) Louisiana Watershed Initiative (LWI) Modeling Contract Region No. 2 Jackson, Lincoln, Caldwell, Franklin and Catahoula Parishes / subconsultant to Freese & Nichols</p> <p>Mr. Biggs was the survey technician for the Region 2 Master Drainage Plan work. The sites were in North Louisiana in the Ouachita Basin and lower Red River Basin. Hundreds of miles of streams were surveyed and hundreds of structures were surveyed to provide the raw data for the Freese & Nichols modeling technicians.</p>		
11/22-06/23	<p>LA DOTD (4400017069) Louisiana Watershed Initiative (LWI) Modeling Contract Region No. 3 Carroll, West Carroll, Morehouse, Richland, Madison and Tensas Parishes / subconsultant to WSP</p> <p>Working as a subconsultant to WSP, GOTECH provided stream cross section data and structure details for the modeling effort. Mr. Biggs was the survey technician for the project providing quality control reviews for the project and providing coordination for the transmittal of raw data to the modelers.</p>		

02/19-Present	<p>Pointe-Marie: A New Village, Baton Rouge, LA</p> <p>Mr. Biggs is currently the Lead Survey Technician for the on-going design and construction of Pointe-Marie. This project entails a planned community development of a mixed-use village encompassing over 120 acres. His duties include the layout of roadways, drainage, grading, sanitary sewer system, utility layout and coordination and overseeing construction activities. Phase I is complete and he is working on Phase II.</p> <p>Mr. Biggs also has been responsible for the boundary survey field work on the development. This work includes geometric calculations, property corner setting, elevation surveys and lot layouts. Working to improve drainage across overhead utilities and underground pipelines in the north end of the property to include Entergy Transmission and Distribution, Shell Pipeline, Baton Rouge Sewer Force Main and Entergy Gulf States.</p>
11/19-05/21	<p>New Orleans Street Rehabilitation: RR101, RR102 – New Orleans Department of Public Works, Orleans Parish, LA</p> <p>Mr. Biggs was a Survey Technician providing topographic surveying services for roadway rehabilitation design. The project included static GPS control surveys, elevation level loop runs, and conventional topographic field surveys. Topographic field information gathered included roadway/pavement surface features, drainage structures, both surface and subsurface utilities, and survey data on all features within the apparent right-of-way. All field data was collected in standard DOTD electronic feature code format.</p>
11/19-06/21	<p>New Orleans Streets Rehab: RR119 RR120 – New Orleans Department of Public Works, Orleans Parish, LA</p> <p>For the roadway improvement projects in New Orleans, Mr. Biggs was the Lead Survey Technician for GOTECH. He has conducted topographic surveys that were used as the basis for new roadway improvement designs. Gutter line surveys were used for drainage calculation and his pavement surveys were used as the basis for new roadway geometric designs (vertical curves and horizontal geometry). All survey data was compiled in detailed plan/profile sheets resulting in a complete construction document package.</p>

16. Staff Experience:

Résumés shall be provided for all prime and sub-consultant personnel listed in Sections 14 and/or 15 of the proposal. Résumés of personnel not identified in Section 14 or Section 15 of the proposal should not be included and will not be evaluated. Résumés **are limited to 2 pages per person.**

Any certificates required by the advertisement are to be placed in Section 20.

(Add rows as needed)

Firm employed by GOTECH, Inc.				
Name	Bruce Dyson, P.E., P.L.S.		Years of experience with this firm/employer	29
Title	Engineering & Surveying Manager		Years of experience with other firm(s)/employer(s)	16
Degree(s) / Years / Specialization			Bachelor's-of-Science / 1978 / Civil Engineering	
Active registration number / state / expiration date			P.E. License No. 20162 / LA / 3-31-2026; P.L.S. License No. 4670 / LA / 3-31-2026	
Year registered	1982; 1992	Discipline	Registered Professional Civil Engineer; Professional Land Surveyor	
Contract role(s) / brief description of responsibilities			<p>Mr. Dyson has been involved in a variety of survey projects. He is experienced in the areas of civil engineering, project management, construction administration and management, and cost estimating. Specific areas of expertise include drainage improvements, land surveying and flood control.</p> <p>Mr. Dyson has supervised up to five survey crews at GOTECH working on a variety of public and private contracts such as contracts with LA DOTD, US Army Corps of Engineers, Federal Aviation Administration, Parish governments, and New Orleans Sewerage & Water Board.</p> <ul style="list-style-type: none"> ▪ Traffic Control Technician – ATSSA Expires 06/21/2026 ▪ Traffic Control Supervisor – ATSSA Expires 06/22/2026 ▪ Registered Flagger – ATSSA Expires 08/04/2026 	
Experience dates (mm/yy–mm/yy)	Experience and qualifications relevant to the proposed contract; <i>i.e.</i> , “designed drainage”, “designed girders”, “designed intersection”, etc. Experience dates should cover the <u>years of experience</u> specified in the applicable MPR(s).			
04/15 - Present	LADOTD Contract No. 4400004485; State Project No. H.009320: Acadian Rd Roundabout, Route LA 20 (Canal Blvd) & Local Routes (Back Street, Jackson Street, Thompson Place), Thibodaux, LA - Mr. Dyson was the Engineering / Survey Manager providing professional supervision and project management oversight for the right-of-way mapping services to support parcel acquisition required for design of a new road roundabout in Thibodeaux, Louisiana. Project included field property surveys performed to DOTD survey standards and parcel title work reviews of affected properties. Final right-of-way map and parcel description deliverables, along with MicroStation parcel mapping files, were reviewed and submitted in accordance with established DOTD Location and Survey delivery requirements.			
10/17 - 03/18	LADOTD Contract No. 4400002746; State Project No. H. 012602.5: I-10 at Morrison Rd Interstate Lighting, Orleans Parish, LA – Mr. Dyson provided project oversight as Engineering / Surveyor Manager with supervision and project management of topographic surveys to support various interstate lighting design projects. The projects included static GPS control surveys and topographic field surveys performed to DOTD survey standards within the full limits of the highway interchange. The survey field information gathered included roadway surface features, drainage structures, designated subsurface utility locations, and structure data on elevated portions of the interstate bridge overpass. Final deliverables, and MicroStation mapping files, were certified and submitted in accordance with established DOTD Location and Survey delivery requirements.			

02/14 - 11/16	LADOTD Project No. H.007855: LA Hwy 431 at LA Hwy 934 Intersection Improvements, Ascension Parish, LA – Mr. Dyson was the quality control reviewer for the Hwy 431 / 934 Intersection Improvements project. GOTECH provided topographic surveying and mapping services for the project. The work was located in Ascension Parish on what are currently two-lane highways with narrow shoulders and adjacent open ditch drainage. GOTECH field crews obtained field data in a format that was used in MicroStation CADD drawings with Inroad's software. GOTECH also mapped the data in an AutoCAD version for the designers to use. The topographic map showed existing features as pavement, ditches, culverts, lighting, signs, utility poles, traffic controls, driveways, and other utilities. GOTECH also developed an existing drainage map for the project. The watershed covered approximately 25 acres of contributing drainage area.
10/12 - 12/14	LADOTD Project No. H.009276: I-10 (LA 30 to LA 22), Ascension Parish, LA – Mr. Dyson was the quality control reviewer for the Interstate 10 project in Ascension Parish. The project included a segment of the Interstate from LA Hwy 30 to LA Hwy 22. Cross Sections were taken from right-of-way line to right-of-way line to provide data for the Interstate widening design. Overpass details were obtained to show bridge details, bent locations, piling spacing and clearance dimensions.
09/07 - 09/13	LADOTD Project No. 704-92-0036 & 704-92-0037: New Orleans Submerged Streets Repair-Permanent Repair to Federal Aid Eligible Roads as a Result of Damage Due to Hurricane Katrina in 2005 - Mr. Dyson was the Engineering Coordinator for this project. GOTECH provided topographic surveying, preliminary and final roadway plans, and construction support for the project streets located in Jefferson and Orleans Parishes.
02/06 - 08/11	LADOTD Project No. 052-02-0024: John James Audubon Bridge Design/Build Project, St. Francisville, LA - Mr. Dyson was an assistant design engineer on the project, performing quality control reviews on the construction documents. The cable-stayed bridge structure crossed the Mississippi River linking the St. Francisville area with the New Roads community. Approximately 3.5 miles of mainline and sideroad network were designed by GOTECH. The project involved intersection designs, drainage analysis, alignment geometric designs, profile/grade analysis and cost estimating.

16. Staff Experience:

Résumés shall be provided for all prime and sub-consultant personnel listed in Sections 14 and/or 15 of the proposal. Résumés of personnel not identified in Section 14 or Section 15 of the proposal should not be included and will not be evaluated. Résumés **are limited to 2 pages per person.**

Any certificates required by the advertisement are to be placed in Section 20.

(Add rows as needed)

Firm employed by GOTECH, Inc.			
Name	Rhaoul Guillaume, Sr., P.E., F. ASCE		Years of relevant experience with this employer
Title	President		43
		Years of relevant experience with other employer(s)	10
Degree(s) / Years / Specialization		Bachelor-of-Science / 1971 / Civil Engineering; Bachelor of Arts / 1971 / Mathematics	
Active registration number / state / expiration date		P.E. License No. 20083 / LA / 9-30-2024	
Year registered	1982	Discipline	Civil Engineering
Contract role(s) / brief description of responsibilities		Principal-in-Charge / Mr. Guillaume, as principal of GOTECH, Inc. supervises all corporate activities to include project management for all contract requirements. Mr. Guillaume's also include client liaison, project budgeting, manpower assignments, contract administration, design supervision, production of contract documents and quality control. Mr. Guillaume is an experienced civil engineer with a background in hydrographic, topographic and control surveying, project management and estimating.	
Experience dates (mm/yy-mm/yy)	Experience and qualifications relevant to the proposed contract; <i>i.e.</i> , "designed drainage", "designed girders", "designed intersection", etc. Experience dates should cover the <u>years of experience</u> specified in the applicable MPR(s).		
04/15 - Present	LADOTD Contract for Engineering and Surveying Services (Contract No. 4400004485; Project No. H.009320) – Acadian Rd Roundabout, Route LA 20 (Canal Blvd) & Local Routes (Back Street, Jackson Street, Thompson Place), Thibodaux, LA: Mr. Guillaume is overall responsible for providing the required services for the project. GOTECH serves as Sub-Consultant to Hartman Engineering.		
05/18 - Present	LA DOTD Retainer Contract for Electrical Services (Contract No. 4400002746; Project No. H.013442.5) – I-10 at Crowder Blvd Interstate Lighting, Orleans Parish, LA: Mr. Guillaume is the client liaison and is overall responsible for providing the required engineering and surveying services for the project. GOTECH serves as a Sub-Consultant to GEC, Inc..		
01/18 - Present	LADOTD Prospect Blvd Sidewalks, Terrebonne Parish, (Contract No. 4400010389) – Prospect Blvd Sidewalks, Terrebonne Parish, LA: Mr. Guillaume is the client liaison and is overall responsible for providing the required engineering and surveying services for this project. GOTECH is the Prime Consultant.		
10/14 - Present	LADOTD Retainer Contract for Construction Engineering Management & Staff Augmentation Services (Contract No. 4400004729) — District 03 (Acadia, Lafayette, Evangeline, Iberia, St. Landry, St. Martin, St. Mary & Vermilion Parishes, LA): Mr. Guillaume is the client liaison and is overall responsible for providing the required engineering and inspection services for the project. GOTECH is a Sub-Consultant to GEC, Inc.		
02/18 - 04/18	LADOTD North Kenner Pedestrian Improvements, Orleans Parish, LA (Contract No. 4400005891): Mr. Guillaume was the client liaison and was overall responsible for providing the required engineering and surveying services for the project. GOTECH was a Sub-Consultant to Digital Engineering and Imaging, Inc.		
09/07 - 09/13	LA DOTD New Orleans Submerged Streets Repair, Jefferson & Orleans Parishes, LA (Project No. 704-92-0036 & 704-92-0037): Mr. Guillaume was the client liaison and was overall responsible for providing the required engineering and surveying services for the project. GOTECH was a Sub-Consultant to HNTB.		

02/09 - 08/12	LADOTD I-12 Widening Design-Build, East Baton Rouge & Livingston Parishes, LA (Project No. 454-01-0047 & 454-02-0025): Mr. Guillaume was the client liaison and was overall responsible for providing the required engineering, inspection and surveying services for the project. GOTECH was a Sub-Consultant to James Construction Group.
02/06 - 05/11	LA DOTD John James Audubon Bridge Design / Build Project, St. Francisville, LA (Project No. 052-02-0024): Mr. Guillaume was the client liaison and was overall responsible for providing the required engineering, inspection and surveying services for the project. GOTECH was a Sub-Consultant to Audubon Bridge Constructors.

16. Staff Experience:

Résumés shall be provided for all prime and sub-consultant personnel listed in Sections 14 and/or 15 of the proposal. Résumés of personnel not identified in Section 14 or Section 15 of the proposal should not be included and will not be evaluated. Résumés **are limited to 2 pages per person.**

Any certificates required by the advertisement are to be placed in Section 20.

(Add rows as needed)

Firm employed by GOTECH, Inc.				
Name	Robert Price, P.L.S.		Years of relevant experience with this employer	5
Title	Director of Operations		Years of relevant experience with other employer(s)	20
Degree(s) / Years / Specialization		Master of Science / 2009 / Engineering & Technology Management Bachelor of Science / 1997 / Survey & Mapping Bachelor of Science / 1993 / Industrial Technology & Building Construction		
Active registration number / state / expiration date		P.L.S. License No. 4889 / LA / 3-31-2026		
Year registered	1992	Discipline	Professional Land Surveyor	
Contract role(s) / brief description of responsibilities		Mr. Robert Price is a Licensed Professional Land Surveyor with more than 20 years of experience in land surveying and mapping; project management; and personnel management. He has provided surveying and utility location designation support for pipeline, road improvement, LNG facilities, oil and gas well locations, and private development projects. ▪ Traffic Control Technician – ATSSA Expires 06/21/2026 ▪ Traffic Control Supervisor – ATSSA Expires 06/22/2026 ▪ Registered Flagger – ATSSA Expires 08/12/2026		
Experience dates (mm/yy–mm/yy)	Experience and qualifications relevant to the proposed contract; <i>i.e.</i> , “designed drainage”, “designed girders”, “designed intersection”, etc. Experience dates should cover the years of experience specified in the applicable MPR(s).			
04/15 - Present	LADOTD Contract No. 4400004485; State Project No. H.009320: Acadian Rd Roundabout, Route LA 20 (Canal Blvd) & Local Routes (Back Street, Jackson Street, Thompson Place), Thibodaux, LA Mr. Price is the Professional Land Surveyor providing professional supervision and project management oversight for the right-of-way mapping services to support parcel acquisition required for design of a new road roundabout in Thibodaux, Louisiana. Project included field property surveys performed to DOTD survey standards and parcel title work reviews of affected properties. Final right-of-way map and parcel description deliverables, along with MicroStation parcel mapping files, were reviewed and submitted in accordance with established DOTD Location and Survey delivery requirements.			
10/17 - Present	Move Ascension Henry Road Safety Widening (LA 73 Tillotson Road/Akins Road) Ascension Parish, LA Mr. Price is the project manager providing the topographic surveying and mapping services to support the design and right-of-way acquisition for the Move Ascension - Henry Road widening project. Project surveys were in support of new design to widen approximately 8-miles of roadway in Ascension Parish. GOTECH is a Sub-Consultant to GSA, Inc.			
04/18 - 06/18	LADOTD Contract No. 4400005891; State Project No. H.012479: Local Road Safety Program / Safe Routes to School Peltier Park Sidewalks Mr. Price was the Survey Project Manager managing the topographic survey to support design for various sidewalk, driveway and handicapped curbed ramp improvements along the perimeter of Peltier Park in Thibodaux, Louisiana. Project field activities included a 2,400-linear foot existing conditions and utility survey utilizing Louisiana DOTD electronic data collection standards. The final deliverables for the project consisted of detailed plan/profile sheets drawn for the project alignment.			

05/17 - 07/17	<p>LADOTD Contract No. 4400005660; State Project No. H.012874.5: I-55 at Hwy 22 Interchange Lighting, Tangipahoa Parish, LA</p> <p>As Survey Project Manager, Mr. Price professionally managed the topographic and utility location survey services in support of design plans and specifications for the I-55 at LA Hwy 22 Interchange Lighting in Tangipahoa Parish. Survey crews conducted a complete topographic, elevation and utility survey within the entire limits of the I-55 Interchange with LA Highway 22. The topographic survey included data collected on the highway crossing exit/entrance ramps and elevated overpasses in addition to the location of both above ground and subsurface utilities required to facilitate design of lighting structures. All final deliverables were certified and submitted in strict accordance with DOTD Location and Survey standards.</p>
10/17 - 03/18	<p>LADOTD Contract No. 4400002746; State Project No. H.012602.5: I-10 at Morrison Rd Interstate Lighting, Orleans Parish, LA</p> <p>Mr. Price provided project oversight as a Professional Land Surveyor with supervision and project management of topographic surveys to support various interstate lighting design projects. The projects included static GPS control surveys and topographic field surveys performed to DOTD survey standards within the full limits of the highway interchange. The survey field information gathered included roadway surface features, drainage structures, designated subsurface utility locations, and structure data on elevated portions of the interstate bridge overpass. Final deliverables, and MicroStation mapping files, were certified and submitted in accordance with established DOTD Location and survey delivery requirements.</p>
08/03 - 10/07	<p>LADOTD U.S Hwy 165, Georgetown to Tullos, Grant and LaSalle Parishes, Louisiana</p> <p>Mr. Price served as the Survey Coordinator responsible for deed research and property monument recovery in connection with the property survey along a six (6) mile section of the existing U.S. Hwy 165 roadway from Georgetown to Tullos. The survey consisted of locating and retracing the boundary lines of approximately 100 property owners. Several restorations of Public Land Survey corners were undertaken as required in the determination of boundary lines.</p>

17. Firm Experience:

Identify the team's project experience **most relevant** to the scope in the advertisement. **The projects should be limited to a total of 20, with no more than 5 projects being represented by the prime consultant and with no more than 3 projects represented by each sub-consultant on the team. If more than 5 projects are identified for the prime consultant, all projects identified after the first 5 will not be evaluated. If more than 3 projects are identified for a single sub-consultant, all projects identified after the first 3 from that sub-consultant will not be evaluated.** Include no more than one page per project. Projects identified shall only include work performed by firms on the team. The projects identified do not necessarily need to have been DOTD projects.

Firm name	Pivotal Engineering, LLC		Past Performance Evaluation Discipline(s)*	CE&I/OV, Road	
Project name	RR016, B.W. Cooper Gert Town, Dixon Group, C			Firm responsibility (prime or sub?)	Prime
Project number	RR-016	Owner's name	City of New Orleans, DPW		
Project location	New Orleans, LA		Owner's Project Manager	Khalid L Saleh	
Owner's address, phone, email	1300 Perdido Street/RM 6W03, New Orleans, LA, 70112, 504-658-8465, ksaleh@nola.gov				
Services commenced by this firm (mm/yy)	08/19	Total consultant contract cost (\$1,000's)			\$480
Services completed by this firm (mm/yy)	Ongoing	Cost of consultant services provided by this firm (\$1,000's)			\$423

Describe the project including the firm's role and members involved. (Highlight staff to be used in this proposal.)

Project Description and Firm's Role: Pivotal is retained by City of New Orleans to provide roadway full reconstruction including subsurface improvements (drainage, sewer and water line improvement). The project entails roadway rehabs 9 blocks (3245 ft) in the neighborhood of B.W. Cooper, Gert Town and Dixon. This design of multiple streets is required to meet rehabilitation goals set by FEMA and CNO and water line replacement program set by S&WB. The project also included identifying and designing the geometrics of the streets, preparation of capital cost estimates and construction documents for the project.

Pivotal is also responsible for administering the required topographical survey of existing site conditions prior to start of design phase.

Pivotal is also responsible for coordinating all efforts with various private & public utility companies, state & local agencies, as well as civic & community organizations. This project was federally funded.



Members Involved: Avinash Mehta, PE, Principal, Yoseph Shifare, PE, Project Director, Eliot Guerin, PE, Civil Engineer, Darius Cook, Construction Manager, Sundiata Marcelin, P.E., Civil Engineer

Performed in LA: 100%

17. Firm Experience:

Identify the team's project experience **most relevant** to the scope in the advertisement. **The projects should be limited to a total of 20, with no more than 5 projects being represented by the prime consultant and with no more than 3 projects represented by each sub-consultant on the team. If more than 5 projects are identified for the prime consultant, all projects identified after the first 5 will not be evaluated. If more than 3 projects are identified for a single sub-consultant, all projects identified after the first 3 from that sub-consultant will not be evaluated.** Include no more than one page per project. Projects identified shall only include work performed by firms on the team. The projects identified do not necessarily need to have been DOTD projects.

Firm name	Pivotal Engineering, LLC	Past Performance Evaluation Discipline(s)*	CE&I/OV, Road
Project name	RR139 Plum Orchard/West Lake Forest Group B		Firm responsibility (prime or sub?) Prime
Project number	RR139	Owner's name	City of New Orleans, DPW
Project location	New Orleans, LA	Owner's Project Manager	Nguyen Phan, P.E.
Owner's address, phone, email	1300 Perdido Street/RM 6W03, New Orleans, LA, 70112, (504) 658-8000 , nphan@nola.gov		
Services commenced by this firm (mm/yy)	2017	Total consultant contract cost (\$1,000's)	\$1000
Services completed by this firm (mm/yy)	2021	Cost of consultant services provided by this firm (\$1,000's)	\$580

Describe the project including the firm's role and members involved. (Highlight staff to be used in this proposal.)

Project Description and Firm's Role:

Pivotal Engineering was retained by the City of New Orleans Department of Public Works to perform the design and construction management for the Recovery Roads Project in New Orleans East. The project included street and subsurface design. As of 2021, Pivotal is providing inspection services in support of the construction activities. The resident inspection services are required to verify that the construction meets the plans and specs, rehabilitation goals set by FEMA and CNO, and water line replacement program set by S&WB. The inspection service also includes coordinating with the design engineering firm, contractor and utility companies in conformance to the construction documents of the project.

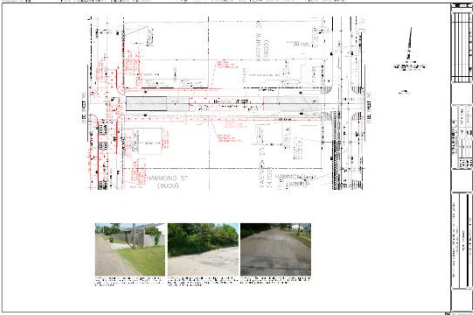
Design Engineering Scope: <ul style="list-style-type: none"> • Street Reconstruction including <ul style="list-style-type: none"> ○ Pavement, curb, sidewalk, driveway, drainage, water and sewer ○ installation of ramps for the handicapped at intersections ○ roadway pavement condition assessments • Survey Services • Schematic design • Preliminary Design • Final design 		Construction Management Scope: <ul style="list-style-type: none"> • Construction admin. Including <ul style="list-style-type: none"> ○ Reviewing design plans and specifications ○ Reviewing and updating plans and specifications ○ Attending the pre-construction meeting ○ Reviewing and approving a project schedule ○ Monitoring and documenting construction activities.
--	---	--

Members Involved: Avinash Mehta, PE, Principal, Yoseph Shifare, PE, Project Director, Eliot Guerin, PE, Civil Engineer, Darius Cook, Construction Manager, Sundiata Marcelin, P.E., Civil Engineer

Performed in LA: 100%

PIVOTAL ENGINEERING, LLC

17. Firm Experience:

Identify the team's project experience **most relevant** to the scope in the advertisement. **The projects should be limited to a total of 20, with no more than 5 projects being represented by the prime consultant and with no more than 3 projects represented by each sub-consultant on the team. If more than 5 projects are identified for the prime consultant, all projects identified after the first 5 will not be evaluated. If more than 3 projects are identified for a single sub-consultant, all projects identified after the first 3 from that sub-consultant will not be evaluated.** Include no more than one page per project. Projects identified shall only include work performed by firms on the team. The projects identified do not necessarily need to have been DOTD projects.

Firm name	Pivotal Engineering, LLC	Past Performance Evaluation Discipline(s)*	CE&I/OV, Road
Project name	RR018, B.W. Cooper Gert, Dixon Group, Town E	Firm responsibility (prime or sub?)	Prime
Project number	RR-018	Owner's name	City of New Orleans, DPW
Project location	New Orleans, LA	Owner's Project Manager	Khalid L Saleh
Owner's address, phone, email	1300 Perdido Street, New Orleans, LA, 70112, 504-658-8465, ksaleh@nola.gov		
Services commenced by this firm (mm/yy)	08/19	Total consultant contract cost (\$1,000's)	\$330
Services completed by this firm (mm/yy)	Ongoing	Cost of consultant services provided by this firm (\$1,000's)	\$300

Describe the project including the firm's role and members involved. (Highlight staff to be used in this proposal.)

Project Description and Firm's Role: Pivotal is retained by City of New Orleans to provide roadway full reconstruction including subsurface improvements (drainage, sewer and water line improvement). The project entails roadway rehabs to 15 blocks (6.075 ft) in the neighborhood of B.W. Cooper, Gert Town and Dixon. This design of multiple streets is required to meet rehabilitation goals set by FEMA and CNO and water line replacement program set by S&WB. The project also included identifying and designing the geometrics of the streets, preparation of capital cost estimates and construction documents for the project.

Pivotal is also responsible for administering the required topographical survey of existing site conditions prior to start of design phase.

Pivotal is also responsible for coordinating all efforts with various private & public utility companies, state & local agencies, as well as civic & community organizations. This project was federally funded.



Members Involved: Avinash Mehta, PE, Principal, Yoseph Shifare, PE, Project Director, Eliot Guerin, PE, Civil Engineer, Darius Cook, Construction Manager

Performed in LA: 100%

17. Firm Experience:

Identify the team's project experience **most relevant** to the scope in the advertisement. **The projects should be limited to a total of 20, with no more than 5 projects being represented by the prime consultant and with no more than 3 projects represented by each sub-consultant on the team. If more than 5 projects are identified for the prime consultant, all projects identified after the first 5 will not be evaluated. If more than 3 projects are identified for a single sub-consultant, all projects identified after the first 3 from that sub-consultant will not be evaluated.** Include no more than one page per project. Projects identified shall only include work performed by firms on the team. The projects identified do not necessarily need to have been DOTD projects.

Firm name	Pivotal Engineering, LLC	Past Performance Evaluation Discipline(s)*	CE&I/OV, Road
Project name	RR038 Filmore North Group B		Firm responsibility (prime or sub?) Prime
Project number	RR-038	Owner's name	City of New Orleans, DPW
Project location	New Orleans, LA	Owner's Project Manager	Khalid L Saleh
Owner's address, phone, email	1300 Perdido Street/RM 6W03, New Orleans, LA, 70112, 504-658-8465, ksaleh@nola.gov		
Services commenced by this firm (mm/yy)	08/2020	Total consultant contract cost (\$1,000's)	\$420
Services completed by this firm (mm/yy)	08/2023	Cost of consultant services provided by this firm (\$1,000's)	\$380

Describe the project including the firm's role and members involved. (Highlight staff to be used in this proposal.)

Project Description and Firm's Role: Pivotal is retained by City of New Orleans to provide Resident Inspection Service for full roadway reconstruction project including subsurface improvements (drainage, sewer and water line improvement). The project entails roadway rehabs to 7 blocks (3800 ft) in the neighborhood of Bayou St. John. The resident inspection services are required to verify that the construction meets the plans and specs, rehabilitation goals set by FEMA and CNO, and water line replacement program set by S&WB. The inspection service also includes coordinating with the design engineering firm, contractor and utility companies in conformance to the construction documents of the project. The project is valued at \$ 4.2 million.



Design Engineering Scope:

Street Reconstruction including

- Pavement, curb, sidewalk, driveway, drainage, water and sewer
- installation of ramps for the handicapped at intersections
- roadway pavement condition assessments

- Survey Services
- Schematic design, Preliminary and Final Design

Construction Management Scope:

- Reviewing design plans and specifications
- Reviewing and updating plans and specifications
- Attending the pre-construction meeting
- Reviewing and approving a project schedule

Members Involved: Avinash Mehta, PE, Principal, Yoseph Shifare, PE, Project Director, Eliot Guerin, PE, Civil Engineer, Darius Cook, Construction Manager

Performed in LA: 100%

17. Firm Experience:

Identify the team's project experience **most relevant** to the scope in the advertisement. **The projects should be limited to a total of 20, with no more than 5 projects being represented by the prime consultant and with no more than 3 projects represented by each sub-consultant on the team. If more than 5 projects are identified for the prime consultant, all projects identified after the first 5 will not be evaluated. If more than 3 projects are identified for a single sub-consultant, all projects identified after the first 3 from that sub-consultant will not be evaluated.** Include no more than one page per project. Projects identified shall only include work performed by firms on the team. The projects identified do not necessarily need to have been DOTD projects.

Firm name	Pivotal Engineering, LLC	Past Performance Evaluation Discipline(s)*	CE&I/OV, Road
Project name	Wright Road Improvements	Firm responsibility (prime or sub?)	Prime
Project number	DPW-2005-04E	Owner's name	City of New Orleans, DPW
Project location	New Orleans, LA	Owner's Project Manager	Nguyen Phan
Owner's address, phone, email	1300 Perdido Street/RM 6W03, New Orleans, LA, 70112, 504-658-8000, nphan@nola.gov		
Services commenced by this firm (mm/yy)	06/17	Total consultant contract cost (\$1,000's)	\$900
Services completed by this firm (mm/yy)	09/22	Cost of consultant services provided by this firm (\$1,000's)	\$810

Describe the project including the firm's role and members involved. (Highlight staff to be used in this proposal.)

Project Description and Firm's Role: Pivotal personnel are retained by the City of New Orleans for the design of Wright Road located in New Orleans East. The project entails the design of a new roadway section, subsurface sewer, water and drainage facilities, the relocation of conflicting utilities, as well as the development of specifications and construction oversight. Pivotal engineering staff have also been required to provide public coordination, agency approvals, oversee contractor compliance, and represent the Owner at various public meetings.

- Review the required topographical survey of existing site conditions prior to start of design phase.
- Design new drainage network for 10 years return period.
- Design new gravity sewer collection system to replace existing system that had been in service for more than 40 years.
- Design new water main and located it on the median.
- Design new street for tie-in to side streets.
- Coordinate all efforts with various private & public utility companies, state & local agencies, as well as civic & community organizations.



Members Involved: Avinash Mehta, PE, Principal, Yoseph Shifare, PE, Project Director, Eliot Guerin, PE, Civil Engineer, Darius Cook, Construction Manager

Performed in LA: 100%

17. Firm Experience:

Identify the team's project experience **most relevant** to the scope in the advertisement. **The projects should be limited to a total of 20, with no more than 5 projects being represented by the prime consultant and with no more than 3 projects represented by each sub-consultant on the team. If more than 5 projects are identified for the prime consultant, all projects identified after the first 5 will not be evaluated. If more than 3 projects are identified for a single sub-consultant, all projects identified after the first 3 from that sub-consultant will not be evaluated.** Include no more than one page per project. Projects identified shall only include work performed by firms on the team. The projects identified do not necessarily need to have been DOTD projects.

Firm name	GOTECH, Inc.			Past Performance Evaluation Discipline(s)*		**Survey	
Project name	IDIQ Contract for Design of Safety Projects Statewide with Majority of Work in District 02, 61 & 62				Firm responsibility (prime or sub?)		sub
Project number	4400015487		Owner's name	LADOTD			
Project location	Statewide			Owner's Project Manager		Mark Chenevert	
Owner's address, phone, email		1201 Capitol Access Road, Room 405-E, Baton Rouge, LA 70802-4438, 225-379-1591, mark.chenevert@la.gov					
Services commenced by this firm (mm/yy)			01/20	Total consultant contract cost (\$1,000's)			\$N/A
Services completed by this firm (mm/yy)			05/20	Cost of consultant services provided by this firm (\$1,000's)			\$84

GOTECH provided topographic and utility location survey services in support of design plans and specifications for a complete lighting system for the I-10 at Read Boulevard Interchange in Orleans Parish. Survey crews conducted a complete topographic, elevation and utility survey within the entire limits of the I-10 Interchange with Read Boulevard. The topographic survey also included the location of both above ground and subsurface utilities. In addition, gathered survey data included information on the highway crossing exit/entrance ramps and elevated overpasses to facilitate lighting designs under elevated portions of I-10. All final deliverables were certified and submitted in strict accordance with DOTD Location and Survey standards.

GOTECH provided topographic survey in support of design for the closing of an existing ditch and installation of a sidewalk/multi-use path and handicapped ramps on a roadside design project. The survey was along Bootlegger Road (LA Hwy 1085) from Coquille Park to White Chapel Road. The overall length of the survey was approximately 3,600 feet. GOTECH was a subconsultant to Digital Engineering.

Project staff includes the following:

Rhaoul Guillaume, Sr., P.E., Bruce Dyson, P.E., P.L.S., Robert Price, P.L.S.

Survey Crew:

Brice Baker, Raymond Belmer, Jacob Belmer, Michael Major & Sean McKisson



17. Firm Experience:

Identify the team's project experience **most relevant** to the scope in the advertisement. **The projects should be limited to a total of 20, with no more than 5 projects being represented by the prime consultant and with no more than 3 projects represented by each sub-consultant on the team. If more than 5 projects are identified for the prime consultant, all projects identified after the first 5 will not be evaluated. If more than 3 projects are identified for a single sub-consultant, all projects identified after the first 3 from that sub-consultant will not be evaluated.** Include no more than one page per project. Projects identified shall only include work performed by firms on the team. The projects identified do not necessarily need to have been DOTD projects.

Firm name	GOTECH, Inc.			Past Performance Evaluation Discipline(s)*		** CE&I/OV & Survey	
Project name	I-12 Widening Design / Build				Firm responsibility (prime or sub?)		sub
Project number	454-01-0047 & 454-02-0025	Owner's name	LADOTD				
Project location	East Baton Rouge & Livingston Parishes, LA			Owner's Project Manager	Mark Chenevert		
Owner's address, phone, email	1201 Capitol Access Road, Room 405-E, Baton Rouge, LA 70802-4438, 225-379-1591, mark.chenevert@la.gov						
Services commenced by this firm (mm/yy)		02/09	Total consultant contract cost (\$1,000's)				N/A
Services completed by this firm (mm/yy)		08/12	Cost of consultant services provided by this firm (\$1,000's)				\$2950

GOTECH provided surveying, utility coordination, and construction inspection. For the I-12 Widening Project, GOTECH provided inspections services during the construction phase of the project. GOTECH provided a certified structural inspector, concrete paving inspection, coordinated the utility relocation work, prepared daily reports, witnessed testing of cylinder strength for early breaks to allow traffic to roll as soon as they obtained minimum strength, monitoring the construction of the roadway bridges and overpasses.

Survey work included the establishment of primary vertical and horizontal control within the project limits that will construction layout, and any surveying that is required to complete the design phase of the project.

The I-12 widening project consisted of expanding the interstate roadway to three travel lanes in each direction for a approximately nine miles. The project extended from the O'Neal Lane intersection in East Baton Rouge Parish to the in Livingston Parish. GOTECH was a Sub-Consultant to James Construction Group.

Project staff includes the following: **Rhaoul Guillaume, Sr., P.E., Bruce Dyson, P.E., P.L.S.**

CE&I Department: Terry Cormier, Nathan Millard, John Poche, Kenneth Prescott & Charles Stewart

Survey Crew: Raymond Belmer & Jacob Belmer



facilitate

distance of
Walker exit

17. Firm Experience:

Identify the team's project experience **most relevant** to the scope in the advertisement. **The projects should be limited to a total of 20, with no more than 5 projects being represented by the prime consultant and with no more than 3 projects represented by each sub-consultant on the team. If more than 5 projects are identified for the prime consultant, all projects identified after the first 5 will not be evaluated. If more than 3 projects are identified for a single sub-consultant, all projects identified after the first 3 from that sub-consultant will not be evaluated.** Include no more than one page per project. Projects identified shall only include work performed by firms on the team. The projects identified do not necessarily need to have been DOTD projects.

Firm name	GOTECH, Inc.		Past Performance Evaluation Discipline(s)*	**Survey
Project name	MOVEBR's Nicholson - Plank Bus Rapid Transit Corridor Project		Firm responsibility (prime or sub?)	Sub
Project number	16 CI-US-0032	Owner's name	City of Baton Rouge & Parish of East Baton Rouge	
Project location	Baton Rouge, LA		Owner's Project Manager	Tom Stephens
Owner's address, phone, email	1100 Laurel Street, Baton Rouge, LA 70802, (225)389-3186, tstephens@brgov.com			
Services commenced by this firm (mm/yy)	3/21	Total consultant contract cost (\$1,000's)		Unknown
Services completed by this firm (mm/yy)	Present	Cost of consultant services provided by this firm (\$1,000's)		\$725

As part of MOVEBR's Enhancement Program, GOTECH was selected to perform surveying and mapping services for the Nicholson-Plank Bus Rapid Transit Corridor Project. The project footprint extends from Nicholson Drive (LA 30) at Skip Bertman Drive to Plank Road (LA 67) at Airline Highway (US 61 / US190). The scope of work includes a topographic survey, cross section survey, right-of-way survey, utility survey, and mapping services. This 8.2-mile-long corridor survey includes different design elements such as subsurface utilities, subsurface drainage, median cross sections, urban and suburban contexts, pedestrian and transit facilities, and a significant amount of data overall.

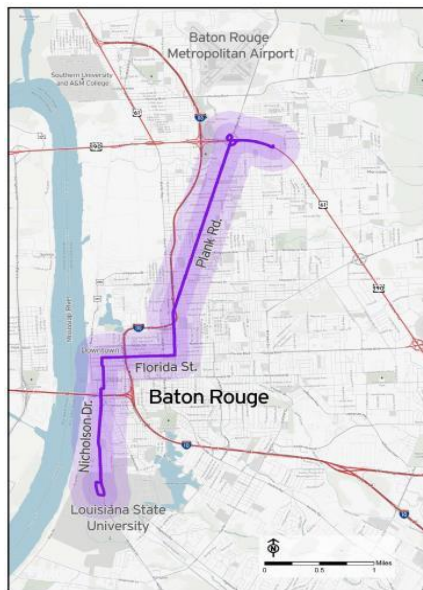

Project staff includes: **Rhaoul Guillaume, Sr., P.E., Bruce Dyson, P.E., PLS, Rob Price, P.L.S., Hogan Smith, P.E.**

Survey Crew: **Raymond Belmer**, Jacob Belmer, **Michael Major, John Biggs**, Brice Baker

PIVOTAL ENGINEERING, LLC

18. Approach and Methodology:

Provide a description of how the work will be performed and **provide the proposed project schedule**. Include any additional information or description of unique resources that are planned to be used to produce the deliverables. Include any proprietary technologies, methods or approaches that will be used on this project to improve quality or efficiency. If the proposal is for an IDIQ contract, the consultant should review the scope of services in Attachment A to the advertisement to obtain a general understanding of what a typical task order would entail. Based upon that understanding, the consultant should provide a sample schedule that identifies the major milestones, deliverables, tasks, etc., to demonstrate sufficient understanding of a typical task order. The duration of the task order is not required. This section shall be limited to four pages. **If more than four pages are included, all pages after the fourth page will not be evaluated. If the consultant has information, it believes is proprietary, label it accordingly.**

Pivotal Engineering, LLC is a full-service engineering design firm based in New Orleans, Louisiana. Pivotal has established a reputation for providing superior service to its clients and delivering quality work on time and within budget. Pivotal's principals and staff have in excess of 200 years of combined experience in civil engineering, mechanical engineering, electrical engineering, environmental engineering and program/project management for both public and private entities across the Gulf South Region. Pivotal Engineering is a certified Small Business Enterprise with both the Small Business Administration and the New Orleans Regional Transit Authority. Furthermore, Pivotal is certified as a Disadvantaged Business Enterprise by the City of Baton Rouge. Pivotal Engineering is also certified by the Louisiana Department of Economic Development as a Small Entrepreneurship SE (Hudson Initiative) firm.

(1) Firm Qualifications & Experience

Pivotal Engineering possesses the specialized experience and technical competence required to execute Construction Administration & Resident Inspection services effectively. Our inspectors are collaborative, well-versed in all phases of roadway and utility construction activities, and have access to engineering support staff to ensure efficient workflow and collaboration. **Certified inspectors** conduct daily on-site inspections to monitor construction activities, ensuring that everything is in strict compliance with project plans and specifications. Our Project Coordination efforts involve facilitating stakeholder meetings where we bring together clients, contractors, and subcontractors to align project goals and timelines.

Pivotal Engineering has extensive experience leveraging Procore to enhance Inspection and Construction Management on various infrastructure and roadway projects. As a technology-driven firm, we utilize Procore's suite of tools to streamline workflows, improve communication, and ensure timely project delivery while maintaining the highest quality standards. Pivotal's use of **Procore's Construction Management** features has significantly improved project coordination and oversight. From **project scheduling** and **cost management** to **document control** and **RFIs**, Procore centralizes all project data and communication in one platform. This has led to better tracking of budgets, change orders, and timelines, ensuring that projects remain on track and within budget. With **Procore's cloud-based system**, all project documents and correspondence are accessible by the entire project team, improving collaboration and reducing the risk of miscommunication. Pivotal Engineering has adopted advanced business intelligence software to streamline workflow, improve data sharing, and reduce transcription errors. Our modern solutions include customized, real-time, cloud-based data dashboards, GIS-based data dashboards, drone photogrammetry, and iOS-based data collection for field data and daily inspection report generation.

(2) Key Personnel Qualifications & Experience

Our team has the manpower, equipment, and expertise to execute Construction Engineering and Inspection services for the proposed IDIQ contracts of DOTD. The qualified team at Pivotal Engineering is ready to provide solutions that are informed and innovative. The majority of Pivotal's staff has extensive design as well as construction experience. This advantage minimizes contractor change orders, expedites project schedules and improves project details. Our Engineers have great track records with helping our clients meet compressed deadlines while eliminating unnecessary expenses yet delivering better than the intended product. We have also proven to our clients our added "Value Engineering" on several projects, which resulted in direct savings of hundreds of thousands of dollars. **Pivotal Construction Managers** possess extensive expertise in **utility coordination** for roadway projects, ensuring that construction activities proceed smoothly without disrupting essential services. They play a crucial role in utility relocation planning, creating detailed maps of existing utilities to identify potential conflicts with construction activities. This meticulous mapping process allows them to develop comprehensive relocation plans that include timelines, cost estimates, and coordination requirements.

Pivotal Engineering and its team have an exceptional reputation for personal and professional integrity and competence. Kindly refer to the detailed resumes attached in section 16 of this form.

(3) Size of firm, considering the number of professional and support personnel required to perform the type of engineering tasks

The Pivotal staff includes over 40 professionals driven to excellence and focused on our client's needs. We are made up of 9 Louisiana Licensed Professional Engineers, 7 Engineering Interns, 5 Program and Grant Management personnel, 10 Construction Inspectors, and 1 Licensed Architect. Our staff also includes program managers, CADD technicians, grant specialist, field monitors and administrative support staff, all of which provides years of experience to help ensure that our work is exceptional.

Pivotal not only presents the number of professional and support personnel available to perform this type of construction engineering and inspection tasks, but also demonstrates the breadth and diversity of the capabilities of the staff. Beyond this diversity of capabilities, Pivotal Engineering's Environmental, Planning, Design and Inspection staff has combined experience of greater than 200 years of experience in all phases of project delivery, including electrical, civil, mechanical, environmental, planning, management, design, and construction supervision experience. Professional qualifications include city, state, and federal certifications in safety, management, and a list of other certifications. The Pivotal drafting team is well versed in a variety of software including CIVIL 3D, HEC RAS, H2O MAP and Arc GIS.

(4) Past Performance on similar DOTD Projects

Pivotal Team has not worked on the DOTD projects in the past.

(5) Current work load with DOTD

Pivotal Engineering currently has no ongoing projects with DOTD.

(6) Approach and Methodology

As a firm with a strong background in roadway design and construction engineering and inspection services, we are well-established to perform all tasks required under this opportunity. Pivotal Engineering gives strong attention to every project consideration and requirement. We have an efficient team of professional engineers and engineering interns available to perform and manage all aspects of this project.

Looking at our current workload and projected availability of key staff, we are confident that our team will be positioned to perform the scope within the established project timeline and stand ready to begin the project.

Understanding Project Requirements

We understand that this opportunity is a critical infrastructure enhancement for both State of Louisiana and the surrounding communities. Furthermore, we understand that this project presents a number of technical and logistical challenges. With our understanding of local and state guidelines as well as state and federal regulations, we are fully prepared to carry each task of this project into successful completion. We have reviewed the solicitation documents and understand the following deliverables and activities to be required under this opportunity:

1. **Provide Construction Engineering and Inspection services:** Pivotal Engineering has provided construction-phase engineering services for many projects, in the Greater New Orleans area. Pivotal Engineering clearly understands the various tasks required under this phase such as: to act as a project engineer and coordinate with DOTD personnel and other parties to schedule and conduct pre construction meeting, maintain all construction field records, coordinate for utility relocation, provide all necessary personnel, equipment and materials to perform required field testing , ensure proper documentation, approve change orders, review and coordinate with DOTD District laboratory the final estimate package, provide appropriately trained staff , submit As-Built Plans with final estimate, manage the RFI process, review and approve the Contractor's Critical path Method and to assist the department in administering the contract, ensuring all work done as per DOTD's Standards and Procedures. **We are confident that our staff will provide complete and timely services during this phase of the project.**
2. **Provide Staff Augmentation Services:** Pivotal Engineering has provided staff augmentation services for many projects in the Greater New Orleans area. Pivotal engineering is ready to provide staff augmentation to the DOTD Project engineer during the design stage of the project, for the duration of the project or on call basis on one or multiple projects as Consultant Resident Engineer, Consultant Assistant resident engineer, Consultant Certified Inspector, Consultant construction Inspector, and/or Consultant Office Manager. **We ensure DOTD that all work under this contract will be performed in accordance with Standards, Specifications, Policies and Procedures established by DOTD.**
3. **Provide Design -Build Contract Engineering and Administration:** Pivotal Engineering is ready to provide contract engineering and administration services for Design -Build projects. Pivotal will provide assistance and support to the DOTD project manager to assure that the contract document requirements are administered fairly and thoroughly. QA/QC team at Pivotal will ensure assistance in coordinating, overseeing and implementing the sampling, testing and data tracking activities of DOTD's OV operations. **We also assure that we will provide both engineering and administrative research, documentation and records to assist DOTD in any potential claims or dispute resolutions.**

Pivotal Engineering and its team stand out as the ideal partner for inspection and construction engineering services for roadway projects. We are committed to timely and thorough completion of any projects given to us. Please find detailed information for our methodologies, in the following sections:

Collaborative Expertise in Construction Engineering and Inspection services: Pivotal Engineering (Pivotal) is uniquely positioned to manage and coordinate with multiple stakeholders, ensuring the successful delivery of roadway and infrastructure projects. Pivotal's track record of diligent engagement in complex, multi-stakeholder projects reflect our commitment to excellence. We recognize that strong partnerships are vital for successful outcomes and leverage our extensive experience, technical expertise, and collaborative mindset to ensure seamless project execution. By choosing Pivotal Engineering for construction administration and resident inspection services, the DOTD can be confident that our team will deliver the coordination and oversight needed to advance these critical roadway projects with precision, efficiency, and professionalism.

Best Practices in Roadway Construction Management Utilizing Procore

At Pivotal Engineering, we adhere to industry best practices in roadway construction management to ensure projects are completed efficiently, on time, and within budget. A cornerstone of our approach is the effective utilization of the Procore Construction Management Software platform, which enhances our capabilities in managing change orders, tracking quantities, and maintaining comprehensive progress documentation.

Change Order Management

Pivotal will prepare independent cost estimates (ICE) and coordinate with the EOR and DOTD before contractors submit change orders. Procore's Change Order tool streamlines the traditionally manual process of change management, allowing for faster approvals and improved communication among stakeholders. This tool enables us to track potential cost impacts in real-time, ensuring that no detail is overlooked and eliminating the need to proceed at risk. In cases where contractor pricing exceeds the ICE, Pivotal will negotiate with the contractor in coordination with DOTD'S requirements.

Quantity Tracking and Progress Documentation

Procore's platform allows for efficient tracking and distribution of contract documents, change orders, and payment applications. Payment applications processed through Procore will generate a standard G702/G703 document, which will be reviewed by Pivotal inspectors and construction managers. We will coordinate with all stakeholders before approving these applications.

Commitment to Procore Proficiency

Pivotal Engineering ensures that all project staff are well-versed in Procore and other data software platforms. Our team comprises numerous inspectors, construction managers, and engineers with thorough knowledge of Procore. To further enhance our team's proficiency, we have developed an in-house Procore wiki and associated workshops. This resource provides team members with ready access to the information needed to perform their duties effectively, fostering continuous learning and adaptation to evolving project requirements.

In Summary

We are excited for the opportunity to manage any projects entrusted to us. Pivotal Engineering takes great pride in our experienced and dedicated team, who use a wide range of advanced data solutions to ensure that each phase of a construction project is managed with precision and efficiency. From communication and coordination to tracking, reporting, and documenting through platforms like Procore, we maintain a strong focus on delivering accurate, timely results. Our team's proven track record with this client and our commitment to excellent project management ensure that we are well-equipped to meet the needs of all stakeholders and successfully navigate any challenges that arise.

19. Workload:

For all contracts where a firm on the team is a prime consultant or sub-consultant and where **a)** the consultant selection was made by DOTD, and **b)** a contract was executed by the consultant and the contracting entity by the date the advertisement for this proposal was posted, list all work meeting the following criteria:

- 1) one of the team's firms is responsible for the performance of the work;
- 2) authorization to perform the work has been provided, as provided in the contract between the consultant and the contracting entity;
- 3) the work has not yet been performed and invoiced; and
- 4) the work is not currently suspended for an indefinite period of time.

For indefinite delivery/indefinite quantity (IDIQ) contracts, list open Task Orders individually.

List only the portion of the fees attributable to firms on the team.

Firm(s) <u>ALL FIRMS</u> MUST BE REPRESENTED IN THIS TABLE	Past Performance Evaluation Discipline(s) *	Contract Number and State Project Number	Project Name	Remaining Unpaid Balance**
Pivotal Engineering, LLC	N/A	N/A	None to report	N/A
GOTECH, Inc. (Subconsultant to GEC, Inc.)	CE&I/OV	4400017006; TO: H.011670	I-10 / Loyola Interchange Improvements (Jefferson Parish)	\$81,130
GOTECH, Inc. (Subconsultant to R.C. Lambert Consultants, LLC)	CE&I/OV	4400019550; SPN: H.001234	LA 1: Port Allen Canal Bridge Replacement Phase 1 (HBI) (CE&I) Route LA 1 (West Baton Rouge Parish)	\$265,755
GOTECH, Inc. (Subconsultant to GEC, Inc.)	CE&I/OV	4400023074; TO: H.012465	IDIQ Contract for Construction, Engineering & Inspection & Staff Augmentation - Pecan Island Rd District 61(Hammond)	\$54,591
GOTECH, Inc. (Subconsultant to GEC, Inc.)	CE&I/OV	4400023074; TO: H.014694.6	LA 426:LA 73 Sherwood Forest District 61(Hammond)	\$40,520
GOTECH, Inc. (Subconsultant to GEC, Inc.)	CE&I/OV	4400023074; TO: H.014930	Rumble Strips - District 61(Hammond)	\$21,449
GOTECH, Inc. (Subconsultant to Volkert)	CE&I/OV	4400021740; SPN: H.004100.6	I-10: LA 415 to Essen Ln on I-10 & I-12 (West & East Baton Rouge Parish)	\$1,354,573
GOTECH, Inc. (Subconsultant to GEC, Inc.)	Survey	4400025040; SPN: H.015530	Infrastructure Investment Off-System Bridge Program – Devall Rd over Drainage Ditch District 61 (Ascension Parish)	\$3,150

GOTECH, Inc. (Subconsultant to GEC, Inc.)	Survey	4400025040; H.015531	Rue De Kajun over Bayou Pierre Part (Ascension Parish)	\$3,150
GOTECH, Inc. (Subconsultant to GEC, Inc.)	Survey	4400025040; H.015532	Beco Rd over Duckroos Bayou (Ascension Parish)	\$3,150
GOTECH, Inc. (Subconsultant to GEC, Inc.)	Survey	4400025040; H.015540	Section Rd over Poydras (Point Coupee & WBRP)	\$3,150
GOTECH, Inc. (Subconsultant to GEC, Inc.)	Survey	4400025040; H.015534	Line Rd over Black Creek (E Feliciana Parish)	\$4,500
GOTECH, Inc. (Subconsultant to GEC, Inc.)	Survey	4400025040; H.015535	Billy Goat Rd over Palmers Ranch (E Feliciana	\$4,500
GOTECH, Inc. (Subconsultant to GEC, Inc.)	Survey	4400025040; H.015533	Midway Rd over Black Creek (E Feliciana Parish)	\$4,500
GOTECH, Inc. (Subconsultant to GEC, Inc.)	Survey	4400025040; H.015536	Thompson Creek Rd over Shady Grv Bayou (Iberville Parish)	\$4,500
GOTECH, Inc. (Subconsultant to GEC, Inc.)	Survey	4400025040; H.015538	Callegan Rd over Drainage Bayou (Iberville Parish)	\$4,500
GOTECH, Inc. (Subconsultant to GEC, Inc.)	Survey	4400025040; H.015542	Highland Rd over Madden Creek (W Feliciana Parish)	\$4,500
GOTECH, Inc. (Subconsultant to GEC, Inc.)	Survey	4400025040; H.015542	Greenwood Rd over Old Creek (W Feliciana Parish)	\$4,500
GOTECH, Inc. (Subconsultant to GEC, Inc.)	Survey	4400025040; H.015541	Canfield Rd over West Fork Bayou (W Feliciana	\$4,500
GOTECH, Inc. (Subconsultant to GEC, Inc.)	Survey	4400025040; H.015539	Lorio Dairy Rd over Bayou Sere (Point Coupee	\$4,500
GOTECH, Inc. (Subconsultant to GEC, Inc.)	CE&I/OV	4400024438; SPN: H.010673 Control Section No. 283-09	US90Z: Harvey Canal Tunnel Rehab Route US 90-Z Federal Aid Project (Jefferson Parish)	\$190,550
GOTECH, Inc. (Subconsultant to ECM)	Survey; CE&I/OV	4400021680; SPN: H.008145.6	LA 1: Leeville to Golden Meadow (Lafourche Parish)	\$718,942
GOTECH, Inc. (Subconsultant to Michael Baker)	CE&I/OV	4400025536; SPN: H.013956.6	IDIQ CE&I District 61 – Beamon Rd Bridge (Pointe Coupee Parish)	\$39,703
GOTECH, Inc. (Subconsultant to GEC, Inc.)	CE&I/OV	4400028884; SPN: H.003931.5	Calcasieu River Bridge (Calcasieu Parish)	\$89,115
GOTECH, Inc. (Subconsultant to HNTB)	Survey	4400023512; TO: 1	IDIQ Bridge Inspection – John James Audubon Bridge Monitor (Statewide)	\$6,146

GOTECH, Inc. (Subconsultant to Digital Engineering & Imaging, Inc.)	Survey	4400026910 & 4400026911; SPN: H.015210.5	IDIQ Design of Safety Project–Judge Tanner Blvd Sidewalk (St. Tammany Parish)	\$33,444
---	--------	---	--	----------

20. Certifications/Licenses:

If the advertisement requires submission of licenses and/or certificates, include them here. **Otherwise, leave this section blank.**

All the required licenses and certifications are attached for your reference.

Louisiana Professional Engineering and Land Surveying Board

Hereby Certifies that

Pivotal Engineering LLC

*has complied with the regulation of this Board and is authorized
to provide or to offer to provide engineering services in the State of
Louisiana contingent upon payment of the annual renewal fee.*

Baton Rouge, Louisiana · 12/20/2012

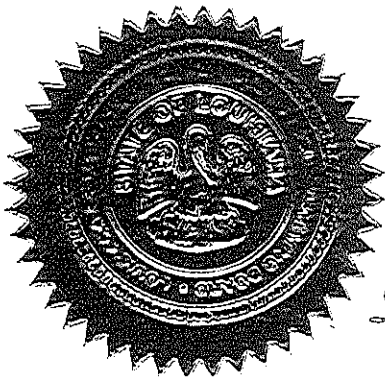

License Number 5213

Michael J. Davis

Jane E. Bawie *Chairman*

Secretary



CITY OF BATON ROUGE

PARISH OF EAST BATON ROUGE

PIVOTAL ENGINEERING, LLC.

has successfully completed the requirements approved by the
City of Baton Rouge, Parish of East Baton Rouge and is
therefore awarded this

**CERTIFICATE OF
SEDBE CERTIFICATION**

OCTOBER 17, 2023



LOUISIANA PROFESSIONAL ENGINEERING AND LAND SURVEYING BOARD

As of 8/29/2024 the Louisiana Professional Engineering and Land Surveying Board (LPELS) has the following information on file:

Mr. Avinash Mehta
1201 Giuffrias Avenue
Metairie, Louisiana 70001

	LOUISIANA PROFESSIONAL ENGINEERING & LAND SURVEYING BOARD (LPELS)	
	9643 Brookline Avenue, Suite 121 Baton Rouge, LA 70809 Phone (225) 925-6291 www.lapels.com	
Mr. Avinash Mehta		
License/Certificate Type - Number	Expiration Date	
PE.0035100	03/31/2026	
Status: Active		
<p>Please be advised that your license must be in "Active" status in order for you to (a) provide or offer to provide engineering or land surveying services in Louisiana or (b) use the words "engineer", "engineering", "land surveyor", "land surveying" or any modification or derivative thereof in your name or in connection with your business or activities in Louisiana. Licensees whose licenses are in "Retired", "Inactive", or "Expired" status are prohibited from engaging in the activities described above in items (a) and (b).</p> <p>LA R. S. 37:689 requires firms practicing or offering to practice engineering or land surveying in the state of Louisiana to be licensed by the Board prior to offering such services.</p>		

Print and keep the following information for your record or verification. The pocket card may also be printed on card stock or laminated to keep with you as license/certificate verification.

Disclaimer

All information provided by LPELS on this web page, and on its other web pages and internet sites, is made available to provide immediate access for the convenience of interested persons. While LPELS believes the information to be reliable, human or mechanical error remains a possibility, as does delay in the posting or updating of information. Therefore, LPELS makes no guarantee as to the accuracy, completeness, timeliness, currency, or correct sequencing of the information. Neither LPELS, nor any of the sources of the information, shall be responsible for any errors or omissions, or for the use or results obtained from the use of this information. Other specific cautionary notices may be included on other web pages maintained by LPELS.



LOUISIANA PROFESSIONAL ENGINEERING AND LAND SURVEYING BOARD

As of 5/30/2025 the Louisiana Professional Engineering and Land Surveying Board (LPELS) has the following information on file:

Mr. Yoseph Yemane Shifare
63 Eugenie Court
New Orleans, Louisiana 70131

	LOUISIANA PROFESSIONAL ENGINEERING & LAND SURVEYING BOARD (LPELS) 9643 Brookline Avenue, Suite 121 Baton Rouge, LA 70809 Phone (225) 925-6291 www.lapels.com
	Mr. Yoseph Yemane Shifare License/Certificate Type - Number PE.0042747 Status: Active Exp Date: 03/31/2027
<p>Please be advised that your license must be in "Active" status in order for you to (a) provide or offer to provide engineering or land surveying services in Louisiana or (b) use the words "engineer", "engineering", "land surveyor", "land surveying" or any modification or derivative thereof in your name or in connection with your business or activities in Louisiana. Licensees whose licenses are in "Retired", "Inactive", or "Expired" status are prohibited from engaging in the activities described above in items (a) and (b).</p> <p>LA R. S. 37:689 requires firms practicing or offering to practice engineering or land surveying in the state of Louisiana to be licensed by the Board prior to offering such services.</p>	

Print and keep the following information for your record or verification. The pocket card may also be printed on card stock or laminated to keep with you as license/certificate verification.

Disclaimer

All information provided by LPELS on this web page, and on its other web pages and internet sites, is made available to provide immediate access for the convenience of interested persons. While LPELS believes the information to be reliable, human or mechanical error remains a possibility, as does delay in the posting or updating of information. Therefore, LPELS makes no guarantee as to the accuracy, completeness, timeliness, currency, or correct sequencing of the information. Neither LPELS, nor any of the sources of the information, shall be responsible for any errors or omissions, or for the use or results obtained from the use of this information. Other specific cautionary notices may be included on other web pages maintained by LPELS.



LOUISIANA PROFESSIONAL ENGINEERING AND LAND SURVEYING BOARD

As of 3/7/2025 the Louisiana Professional Engineering and Land Surveying Board (LPELS) has the following information on file:

Mr. Bassam Abdallah Mekari
1515 Poydras Street, Suite 1875
New Orleans, Louisiana 70112

	LOUISIANA PROFESSIONAL ENGINEERING & LAND SURVEYING BOARD (LPELS) 9643 Brookline Avenue, Suite 121 Baton Rouge, LA 70809 Phone (225) 925-6291 www.lapels.com
	Mr. Bassam Abdallah Mekari License/Certificate Type - Number PE.0031801 Status: Active Exp Date: 09/30/2026
<p>Please be advised that your license must be in "Active" status in order for you to (a) provide or offer to provide engineering or land surveying services in Louisiana or (b) use the words "engineer", "engineering", "land surveyor", "land surveying" or any modification or derivative thereof in your name or in connection with your business or activities in Louisiana. Licensees whose licenses are in "Retired", "Inactive", or "Expired" status are prohibited from engaging in the activities described above in items (a) and (b).</p> <p>LA R. S. 37:689 requires firms practicing or offering to practice engineering or land surveying in the state of Louisiana to be licensed by the Board prior to offering such services.</p>	

Print and keep the following information for your record or verification. The pocket card may also be printed on card stock or laminated to keep with you as license/certificate verification.

Disclaimer

All information provided by LPELS on this web page, and on its other web pages and internet sites, is made available to provide immediate access for the convenience of interested persons. While LPELS believes the information to be reliable, human or mechanical error remains a possibility, as does delay in the posting or updating of information. Therefore, LPELS makes no guarantee as to the accuracy, completeness, timeliness, currency, or correct sequencing of the information. Neither LPELS, nor any of the sources of the information, shall be responsible for any errors or omissions, or for the use or results obtained from the use of this information. Other specific cautionary notices may be included on other web pages maintained by LPELS.



LOUISIANA PROFESSIONAL ENGINEERING AND LAND SURVEYING BOARD

As of 10/8/2024 the Louisiana Professional Engineering and Land Surveying Board (LPELS) has the following information on file:

Mr. Eliot Joseph Guerin
5700 St. Anthony Avenue
New Orleans, Louisiana 70122

	LOUISIANA PROFESSIONAL ENGINEERING & LAND SURVEYING BOARD (LPELS) 9643 Brookline Avenue, Suite 121 Baton Rouge, LA 70809 Phone (225) 925-6291 www.lapels.com
	Mr. Eliot Joseph Guerin License/Certificate Type - Number PE.0047729 Status: Active Exp Date: 09/30/2025
<p>Please be advised that your license must be in "Active" status in order for you to (a) provide or offer to provide engineering or land surveying services in Louisiana or (b) use the words "engineer", "engineering", "land surveyor", "land surveying" or any modification or derivative thereof in your name or in connection with your business or activities in Louisiana. Licensees whose licenses are in "Retired", "Inactive", or "Expired" status are prohibited from engaging in the activities described above in items (a) and (b).</p> <p>LA R. S. 37:689 requires firms practicing or offering to practice engineering or land surveying in the state of Louisiana to be licensed by the Board prior to offering such services.</p>	

Print and keep the following information for your record or verification. The pocket card may also be printed on card stock or laminated to keep with you as license/certificate verification.

Disclaimer

All information provided by LPELS on this web page, and on its other web pages and internet sites, is made available to provide immediate access for the convenience of interested persons. While LPELS believes the information to be reliable, human or mechanical error remains a possibility, as does delay in the posting or updating of information. Therefore, LPELS makes no guarantee as to the accuracy, completeness, timeliness, currency, or correct sequencing of the information. Neither LPELS, nor any of the sources of the information, shall be responsible for any errors or omissions, or for the use or results obtained from the use of this information. Other specific cautionary notices may be included on other web pages maintained by LPELS.



LOUISIANA PROFESSIONAL ENGINEERING AND LAND SURVEYING BOARD

As of 1/25/2024 the Louisiana Professional Engineering and Land Surveying Board (LPELS) has the following information on file:

Mr. Tarek Elnaggar
192 Forest Oaks Drive
New Orleans, Louisiana 70131

	LOUISIANA PROFESSIONAL ENGINEERING & LAND SURVEYING BOARD (LPELS)	
	9643 Brookline Avenue, Suite 121 Baton Rouge, LA 70809 Phone (225) 925-6291 www.lapels.com	
Mr. Tarek Elnaggar		
License/Certificate Type - Number	Expiration Date	
PE.0023832	03/31/2025	
Status: Active		
<p>Please be advised that your license must be in "Active" status in order for you to (a) provide or offer to provide engineering or land surveying services in Louisiana or (b) use the words "engineer", "engineering", "land surveyor", "land surveying" or any modification or derivative thereof in your name or in connection with your business or activities in Louisiana. Licensees whose licenses are in "Retired", "Inactive", or "Expired" status are prohibited from engaging in the activities described above in items (a) and (b).</p> <p>LA R. S. 37:689 requires firms practicing or offering to practice engineering or land surveying in the state of Louisiana to be licensed by the Board prior to offering such services.</p>		

Print and keep the following information for your record or verification. The pocket card may also be printed on card stock or laminated to keep with you as license/certificate verification.

Disclaimer

All information provided by LPELS on this web page, and on its other web pages and internet sites, is made available to provide immediate access for the convenience of interested persons. While LPELS believes the information to be reliable, human or mechanical error remains a possibility, as does delay in the posting or updating of information. Therefore, LPELS makes no guarantee as to the accuracy, completeness, timeliness, currency, or correct sequencing of the information. Neither LPELS, nor any of the sources of the information, shall be responsible for any errors or omissions, or for the use or results obtained from the use of this information. Other specific cautionary notices may be included on other web pages maintained by LPELS.

If you need to make changes to your contact information, please choose one of the following options below:

Contact update for [Individuals and Firms](#)

License/Certificate Types:

EF = Engineering Firm

VF = Land Surveying Firm

CPD = Continuing Professional Development Sponsor/Provider

*PE = Professional Engineer

*PLS = Professional Land Surveyor

*EI = Engineer Intern

*LSI = Land Surveyor Intern

*PE Discipline Codes

AG	Agricultural	ME	Mechanical
AR	Architectural	MI	Mining or Mineral
CH	Chemical	MT	Metallurgical
CE	Civil	MU	Manufacturing
CS	Control Systems	NV	Naval Architecture & Marine
EE	Electrical & Computer	NU	Nuclear
EV	Environmental	ST	Structural *
FP	Fire Protection	PT	Petroleum
IE	Industrial		
* An engineer that has passed the Structural I exam is listed as a Civil Engineer. An engineer that has passed both the Structural I and II exams is listed as Structural (ST) and a Civil (CE) Engineer.			



The Transportation Professional Certification Board

Certifies that

Mr. Yoseph Shifare, P.E., PTOE

successfully holds the Professional Traffic Operations Engineer® certification

Original Certification Date: 8/3/2021

Certification Valid Through: 8/3/2027

Steve Kuciemba,
Executive Director and CEO

Joseph C. Balskus, P.E., PTOE, RSP1
TPCB Chair

Certification Number: 5118



Eliot Guerin
has attended
Louisiana Traffic Control Technician

Completed: 30-JUL-2024

CEU (If Applicable): 0.75

ATSSA provides training and certification but neither constitutes employment by ATSSA.

This certificate provides proof of training, not certification.

American Traffic Safety Services Association
ATSSA.com



Eliot Guerin
has attended
Louisiana Traffic Control Supervisor

Completed: 01-AUG-2024

CEU (If Applicable): 1.5

ATSSA provides training and certification but neither constitutes employment by ATSSA.
This certificate provides proof of training, not certification.

American Traffic Safety Services Association
ATSSA.com



Kepal Patel
has attended
Louisiana Traffic Control Technician

Completed: 30-JUL-2024

CEU (If Applicable): 0.75

ATSSA provides training and certification but neither constitutes employment by ATSSA.

This certificate provides proof of training, not certification.

American Traffic Safety Services Association
ATSSA.com



Kepal Patel
has attended
Louisiana Traffic Control Supervisor

Completed: 01-AUG-2024

CEU (If Applicable): 1.5

ATSSA provides training and certification but neither constitutes employment by ATSSA.

This certificate provides proof of training, not certification.

American Traffic Safety Services Association
ATSSA.com



James Seal
has attended
Louisiana Traffic Control Technician

Completed: 30-JUL-2024

CEU (If Applicable): 0.75

ATSSA provides training and certification but neither constitutes employment by ATSSA.

This certificate provides proof of training, not certification.

American Traffic Safety Services Association
ATSSA.com



James Seal
has attended
Louisiana Traffic Control Supervisor

Completed: 01-AUG-2024

CEU (If Applicable): 1.5

ATSSA provides training and certification but neither constitutes employment by ATSSA.

This certificate provides proof of training, not certification.

American Traffic Safety Services Association
ATSSA.com



Prabin Shrestha
has attended
Louisiana Traffic Control Technician

Completed: 30-JUL-2024

CEU (If Applicable): 0.75

ATSSA provides training and certification but neither constitutes employment by ATSSA.

This certificate provides proof of training, not certification.

American Traffic Safety Services Association
ATSSA.com



Prabin Shrestha
has attended
Louisiana Traffic Control Supervisor

Completed: 01-AUG-2024

CEU (If Applicable): 1.5

ATSSA provides training and certification but neither constitutes employment by ATSSA.

This certificate provides proof of training, not certification.

American Traffic Safety Services Association
ATSSA.com



PROOF OF TRAINING

THIS CERTIFICATE HEREBY RECOGNIZES THAT

John Biggs

has attended

Louisiana Traffic Control Technician

Training Course

7/11/2023 to 7/11/2027
Training Valid Through

Baton Rouge, LA
Location

A handwritten signature in black ink, appearing to read "Donna M. Clark".

Vice President of Education and Technical Services

A handwritten signature in black ink, appearing to read "Alex T. Taylor".

President, CEO

ATSSA provides training and certification but neither constitutes employment by ATSSA.



American Traffic Safety Services Association ATSSA.com



PROOF OF TRAINING

THIS CERTIFICATE HEREBY RECOGNIZES THAT

John Biggs

has attended

Louisiana Traffic Control Supervisor

Training Course

7/12/2023 to 7/12/2027
Training Valid Through

Baton Rouge, LA
Location

A handwritten signature in black ink, appearing to read "Don M. Clark".

Vice President of Education and Technical Services

A handwritten signature in black ink, appearing to read "Alan Tetlow".

President, CEO

ATSSA provides training and certification but neither constitutes employment by ATSSA.



American Traffic Safety Services Association ATSSA.com

Essential Flagger Checklist:

1. STOP/SLOW paddle
2. Proper positioning of flagging station
3. High-visibility safety apparel
4. Communication devices (two-way radio, etc.)
5. Other
 - Air horn or whistle
 - Personal protection equipment
 - Water/snacks
 - Supervisor's phone number
 - Emergency procedures

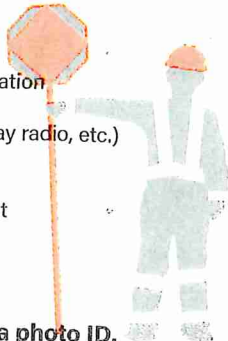

This card is not valid without a photo ID.



**American Traffic Safety
Services Association**

This is to affirm that

JOHN BIGGS

has satisfied the requirements to be designated as a

CERTIFIED FLAGGER

Issue Date 10/21/2022

Debbie Purcella

Instructor Name

Exp. Date 10/21/2026

State Issued LA

Debbie Purcella

Instructor Signature

V0000159954

Verify at Flagger.com



PROOF OF TRAINING

THIS CERTIFICATE HEREBY RECOGNIZES THAT

Bruce K Dyson

has attended

Traffic Control Technician-LA State Specific

Training Course

6/21/2022 to 6/21/2026
Training Valid Through

Baton Rouge, LA
Location

Lamgash
Director of Training

Allen Tetakow
President, CEO

ATSSA provides training and certification but neither constitutes employment by ATSSA.



American Traffic Safety Services Association ATSSA.com



PROOF OF TRAINING

THIS CERTIFICATE HEREBY RECOGNIZES THAT

Bruce K Dyson

has attended

Traffic Control Supervisor-LA State Specific

Training Course

6/22/2022 to 6/22/2026
Training Valid Through

Baton Rouge, LA
Location

Ramona Smith
Director of Training

Allen Teterman
President, CEO

ATSSA provides training and certification but neither constitutes employment by ATSSA.



American Traffic Safety Services Association ATSSA.com



Dear Certified Flagger:

Enclosed, please find your card signifying you as an ATSSA Certified Flagger. This card should be carried and presented to employers while performing work on our nation's roadways. Please be aware that the card is not valid without a Photo I.D.

We commend you on your decision to become an ATSSA Certified Flagger. This distinction reflects that you have been trained by the leader in roadway safety and also entitles you to be listed on our National Flagger Database. Please review your state requirements for expiration of your flagger card. Also, please inform us of any errors or changes in your name or address so we may keep our records up to date.

Once again, ATSSA thanks you for your dedication to ensuring that our work zones are safe and that lives will be saved with proper training. Please visit our website at www.atssa.com for additional training courses and work zone safety products.

Sincerely,

Director of Training

Laminating the front of your card with Dual Laminate:

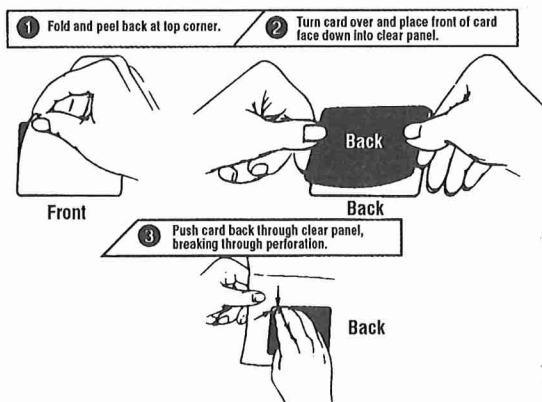

 American Traffic Safety Services Association	
This is to affirm that	
BRUCE DYSON	
has satisfied the requirements to be designated as a CERTIFIED FLAGGER	
Issue Date <u>8/4/2022</u>	<u>Debbie Purcella</u> Instructor Name
Exp. Date <u>8/4/2026</u>	 Instructor Signature
State Issued <u>LA</u>	
V0000058731	Verify at Flagger.com



PROOF OF TRAINING

THIS CERTIFICATE HEREBY RECOGNIZES THAT

John Hoffman

has attended

Louisiana Traffic Control Supervisor

Training Course

11/8/2023 to 11/8/2027
Training Valid Through

Baton Rouge, LA
Location

A handwritten signature in black ink, appearing to read "Don M. Clark".

Vice President of Education and Technical Services

A handwritten signature in black ink, appearing to read "Alan T. Johnson".

President, CEO

ATSSA provides training and certification but neither constitutes employment by ATSSA.



American Traffic Safety Services Association ATSSA.com



PROOF OF TRAINING

THIS CERTIFICATE HEREBY RECOGNIZES THAT

John Hoffman

has attended

Louisiana Traffic Control Technician

Training Course

11/7/2023 to 11/7/2027
Training Valid Through

Baton Rouge, LA
Location

A handwritten signature in black ink, appearing to read "Don M. Clark".

Vice President of Education and Technical Services

A handwritten signature in black ink, appearing to read "Allen T. Taylor".

President, CEO

ATSSA provides training and certification but neither constitutes employment by ATSSA.



American Traffic Safety Services Association ATSSA.com





PROOF OF TRAINING

THIS CERTIFICATE HEREBY RECOGNIZES THAT

Robert Price

has attended

Traffic Control Technician-LA State Specific

Training Course

6/21/2022 to 6/21/2026
Training Valid Through

Baton Rouge, LA
Location

Ramona Smith
Director of Training

Alan Tetlow
President, CEO

ATSSA provides training and certification but neither constitutes employment by ATSSA.



American Traffic Safety Services Association ATSSA.com



PROOF OF TRAINING

THIS CERTIFICATE HEREBY RECOGNIZES THAT

Robert Price

has attended

Traffic Control Supervisor-LA State Specific

Training Course

6/22/2022 to 6/22/2026
Training Valid Through

Baton Rouge, LA
Location

Laurel Smith
Director of Training

Alan Tetachner
President, CEO

ATSSA provides training and certification but neither constitutes employment by ATSSA.



American Traffic Safety Services Association ATSSA.com



Dear Certified Flagger:

Enclosed, please find your card signifying you as an ATSSA Certified Flagger. This card should be carried and presented to employers while performing work on our nation's roadways. Please be aware that the card is not valid without a Photo I.D.

We commend you on your decision to become an ATSSA Certified Flagger. This distinction reflects that you have been trained by the leader in roadway safety and also entitles you to be listed on our National Flagger Database. Please review your state requirements for expiration of your flagger card. Also, please inform us of any errors or changes in your name or address so we may keep our records up to date.

Once again, ATSSA thanks you for your dedication to ensuring that our work zones are safe and that lives will be saved with proper training. Please visit our website at www.atssa.com for additional training courses and work zone safety products.

Sincerely,

Director of Training

Laminating the front of your card with Dual Laminate:

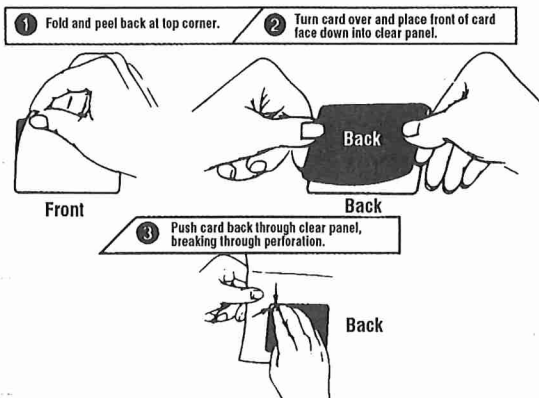

		American Traffic Safety Services Association	
<i>This is to affirm that</i>			
ROBERT PRICE			
<i>has satisfied the requirements to be designated as a</i>			
CERTIFIED FLAGGER			
Issue Date	8/12/2022	Instructor Name	Debbie Purcella
Exp. Date	8/12/2026	Instructor Signature	
State Issued	LA		
V0000058875		Verify at Flagger.com	



PROOF OF TRAINING

THIS CERTIFICATE HEREBY RECOGNIZES THAT

James Walsh

has attended

Traffic Control Supervisor-LA State Specific

Training Course

4/5/2023 to 4/5/2027
Training Valid Through

Baton Rouge, LA
Location

A handwritten signature in black ink, appearing to read "Don M. Clark".

Vice President of Education and Technical Services

A handwritten signature in black ink, appearing to read "Alan T. Tabor".

President, CEO

ATSSA provides training and certification but neither constitutes employment by ATSSA.



American Traffic Safety Services Association ATSSA.com



PROOF OF TRAINING

THIS CERTIFICATE HEREBY RECOGNIZES THAT

James Walsh

has attended

Traffic Control Technician-LA State Specific

Training Course

4/4/2023 to 4/4/2027
Training Valid Through

Baton Rouge, LA
Location

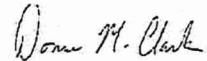
Vice President of Education and Technical Services

President, CEO

ATSSA provides training and certification but neither constitutes employment by ATSSA.



American Traffic Safety Services Association ATSSA.com



Louisiana
**SECRETARY
OF STATE**
NANCY LANDRY

(<https://www.sos.la.gov/Pages/default.aspx>)

Search for Louisiana Business Filings

[Buy Certificates and Certified Copies](#)

[Subscribe to Electronic Notification](#)

[Print Detailed Record](#)

Name	Type	City	Status
GOTECH, INC.	Business Corporation	BATON ROUGE	Active

Previous Names

Business: GOTECH, INC.
Charter Number: 33323660D
Registration Date: 2/11/1981

Domicile Address

8383 BLUEBONNET BLVD.
BATON ROUGE, LA 70810

Mailing Address

C/O RHAOUL A. GUILLAUME
8383 BLUEBONNET BLVD.
BATON ROUGE, LA 70810

Principal Office Address

8383 BLUEBONNET BLVD
BATON ROUGE, LA 70810

Status

Status: Active
Annual Report Status: In Good Standing
File Date: 2/11/1981
Last Report Filed: 2/20/2024
Type: Business Corporation

Registered Agent(s)

Agent:	RHAOUL A. GUILLAUME
Address 1:	8383 BLUEBONNET BLVD.
City, State, Zip:	BATON ROUGE, LA 70810
Appointment Date:	2/4/1983

Officer(s)

Additional Officers: No

Officer:	GERETTA H. GUILLAUME
Title:	Secretary
Address 1:	203 W. WOODGATE CT.
City, State, Zip:	BATON ROUGE, LA 70808
Officer:	RHAOUL A. GUILLAME
Title:	President
Address 1:	8383 BLUEBONNET BLVD.
City, State, Zip:	BATON ROUGE, LA 70810

Amendments on File (5)

Description	Date
Domicile, Agent Change or Resign of Agent	4/21/1981
Domicile, Agent Change or Resign of Agent	2/4/1983
Disclosure of Ownership	5/2/1995
Disclosure of Ownership	8/20/1998
Amendment	1/18/2007

[Back to Search Results](#)
[New Search](#)
[View Shopping Cart](#)

21. QA/QC Plan:

If the advertisement requires submission of a QA/QC plan, include it here. Otherwise, leave this section blank. **If a QA/QC plan is included in this section and was not required by the advertisement, it will be redacted.**

Not required by the advertisement

22. Sub-consultant information:

If one or more sub-consultants will be used, provide the name, address, point of contact and phone number for each. Otherwise, leave this section blank.

Firm Name	Address	Point of Contact and email address	Phone Number
(Name must match exactly as registered with Louisiana's Secretary of State (SOS): including punctuation, include screenshot(s) from SOS at the end of Section 20)			
GOTECH, INC.	8383 Bluebonnet Boulevard Baton Rouge, LA 70810	Rhaoul A. Guillaume, Sr., P.E., F.ASCE rhaoul@gotech-inc.com	225-766-5358

23. Location:

If location is an evaluation criterion for this advertisement (see page 2) and the prime consultant intends to establish a local presence, describe the plan for doing so. **Otherwise, leave this section blank. Any information included in this section will be redacted if not required by the Evaluation Criteria section of the advertisement.**