

IDIQ CONTRACTS FOR PROFESSIONAL SURVEYING SERVICES STATEWIDE

Contract No. 4400031905, 4400031906, 4400031907, 4400031908, and 4400031909

April 29, 2025

SECTION 01-16

H.004113

LA 3241: LA 435 to LA 40/41

(I-12 to Bush)

St. Tammany Parish

Surveyor of Record: Matthew J. Ledet, PLS

PROPOSAL TO PROVIDE CONSULTANT SERVICES

Prime consultant shall complete the DOTD Form 24-102 without altering the Form's text; however, the instruction and/or guidance for Sections 12 through 23 can be removed but do not remove Section title and number.

ANY CONSULTANT FAILING TO SUBMIT ANY OF THE INFORMATION REQUIRED ON THE DOTD FORM 24-102, OR PROVIDING INACCURATE INFORMATION ON THE DOTD FORM 24-102, MAY BE CONSIDERED NON-RESPONSIVE.

Prime consultant should enter the firm name in the footer at the bottom of this page. (It will carry over to subsequent pages.)

1. Contract title as shown in the advertisement	IDIQ CONTRACT FOR PROFESSIONAL SURVEYING SERVICES STATEWIDE
2. Contract number(s) as shown in the advertisement	4400031905, 4400031906, 4400031907, 4400031908, & 4400031909
3. State Project Number(s), if shown in the advertisement	N/A
4. Prime consultant name (name must match as registered with the Louisiana Secretary of State where such registration is required by law)	Crescent Engineering & Mapping, LLC 
5. Prime consultant license number (as registered with the Louisiana Professional Engineering and Land Surveying Board (LAPELS) if registration is required under Louisiana law)	Engineering: EF-0007140 Surveying: VF-0000871
6. Prime consultant mailing address	PO Box 370, Vacherie, LA 70090
7. Prime consultant physical address (existing or to be established, if location is used as an evaluation criteria)	1815 LA 18, Vacherie, LA 70090
8. Name, title, phone number, and email address of prime consultant's contract point of contact	Dennis M. Hymel, Jr., PE, President/Manager 225.329.1742 Dennis.Hymel@crescentengla.com
9. Name, title, phone number, and email address of the official with signing authority for this proposal	Dennis M. Hymel, Jr., PE, President/Manager 225.329.1742 Dennis.Hymel@crescentengla.com

10. This is to certify that all information contained herein is accurate and true, and that the team presently has sufficient staff to perform these services within the designated time frame. By submitting this proposal, proposer certifies that it is not engaged in a boycott of Israel and it will, for the duration of its contract obligations, refrain from a boycott of Israel. Proposer also certifies and agrees that the following information is correct: In preparing its response, the proposer has considered all proposals submitted from qualified, potential subcontractors and suppliers, and has not, in the solicitation, selection, or commercial treatment of any subcontractor or supplier, refused to transact or terminated business activities, or taken other actions intended to limit commercial relations, with a person or entity that is engaging in commercial transactions in Israel or Israeli-controlled territories, with the specific intent to accomplish a boycott or divestment of Israel. The proposer also has not retaliated against any person or other entity for reporting such refusal, termination, or commercially limiting actions. DOTD reserves the right to reject the response of the bidder or proposer if this certification is subsequently determined to be false, and to terminate any contract awarded based on such a false response.

Pursuant to Act No. 581 of the 2024 Louisiana Legislature Regular Session, proposer further certifies that it does not have a practice, policy, guidance, or directive that discriminates against a firearm entity or firearm trade association based solely on the entity's or association's status as a firearm entity or firearm trade association. In addition, proposer certifies it will not discriminate against a firearm entity or firearm trade association during the term of the contract based solely on the entity's or association's status as a firearm entity or firearm trade association.

11. If a Disadvantaged Business Enterprise (DBE) goal has been set for this advertisement, indicate which firm(s) will be used to meet the DBE goal and each firm(s)' percentage.

Signature above shall be the same person listed in Section 9:

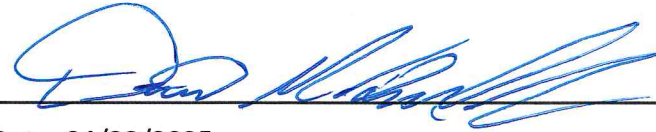

Date: 04/29/2025

Firm(s):

Firm(s)' %:

12. Discipline Table:

Sub-consultants are not allowed to be used for this proposal. Fill in the table by identifying only those disciplines consistent with the approach and methodology proposed in Section 18 of the DOTD Form 24-102*, and the percentage of work in each discipline to be performed. The percentage estimated for each discipline is for evaluation purposes only and will not control the actual performance or payment of the work. (Add rows as needed)

Discipline(s)	% of Overall Contract
Survey	100%

13. Firm Size:

For all firms that are part of this team, indicate the approximate number of personnel to be committed to this contract, by DOTD Job Classification and the total number of personnel within the firm that could provide support, if needed. If a specialized job classification is required and not included on the DOTD job classification list, specify "Other (must specify)" and include the classification title inside the parentheses.

The DOTD Job Classification(s) to be used can be found at the following link:

http://wwwsp.dotd.la.gov/Inside_LaDOTD/Divisions/Engineering/CCS/Job_Qualification/Job%20Classifications%20with%20Descriptions.pdf

Firm name	DOTD Job Classification	Number of personnel committed to this contract	Total number of personnel available in this DOTD Job Classification (if needed)
	Supervisor - Eng	0	2
	Engineer	0	4
	Engineer Intern	0	1
	Surveyor	1	1
	Senior Technician	1	2
	Party Chief	2	2
	Instrument Man	1	1
	Clerical	1	1

14. Organizational Chart:

LEGEND

▲ ATSSA Certified



PRINCIPAL

Dennis M. Hymel, Jr., PE▲

PROJECT MANAGER

Matthew J. Ledet, PLS▲

PARTY CHIEFS

Dakotah "Kody" Holley▲
Joseph Maurin▲

SURVEY TECHNICIAN

Kelly G. Jones

15. Minimum Personnel Requirements:

Use the table below to identify both prime consultant and sub-consultant staff designated to work on this contract meeting the Minimum Personnel Requirements (MPRs) specified in the advertisement. Ensure the résumé reflects the required experience stated in the MPR. Make sure the P.E. discipline is also listed (highlighted in table) that is meeting the MPR; e.g. professional civil engineer should show the discipline of the license as civil if meeting that MPR.

MPR No.	Personnel being used to meet the MPR (Individual(s) may not satisfy more than one MPR unless specifically allowed by Attachment B of the advertisement)	Firm employed by	Type of license and discipline meeting MPR/ certification & number (Ex: PE # - Civil)	State of license	License / certification expiration date
1	Dennis M. Hymel Jr., PE		LA PE# 38172 - Civil	LA	09/30/2025
	Matthew J. Ledet, PLS		LA Registered Surveyor PLS #5104	LA	09/30/2026
2	Matthew J. Ledet, PLS		LA Registered Surveyor PLS #5104	LA	09/30/2026

16. Staff Experience:

Firm employed by: Crescent Engineering & Mapping, LLC

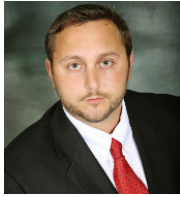

Dennis M. Hymel, Jr., PE
President/Manager



Years of relevant experience with this employer	3
Years of relevant experience with other employer(s)	17



Degree(s) / Years / Specialization			Bachelor of Science/2009/Civil Engineering
Active registration number / state / expiration date			38172/LA/09-30-2025
Year registered	2013	Discipline	PE/Civil Engineering
Contract role(s) / brief description of responsibilities			Dennis will serve as the Principal. His experience fulfills MPR #1 .
Experience dates (mm/yy–mm/yy)	Experience and qualifications relevant to the proposed contract; i.e., “designed drainage”, “designed girders”, “designed intersection”, etc. Experience dates should cover the years of experience specified in the applicable MPR(s).		
04/22 – Ongoing	LA 3127 Widening (LA 20 to LA 3213), St. James Parish, LA (St. James Parish) – Project Manager/EOR. Responsible for overall project management, oversight and supervision of all project elements including topographic surveys , traffic analysis and report, roadway widening design, roundabout geometrics, pavement design, drainage design and H&V geometrics. The project involves widening the existing 2-lane roadway to a 4-lane, divided median roadway and includes two multi-lane roundabouts, an R-Cut intersection and multiple J-Turn intersections for over 4 miles of arterial widening. Also responsible for the oversight of geotechnical and environmental subconsultants.		
03/22 – Ongoing	S.P. No.s H.015333, H.015404, H.015407 - Tangipahoa IJA Bridge Replacements, Tangipahoa Parish, LA (LADOTD) – Project Manager/Engineer of Record. Responsible for project coordination, design and plan production, and performed QC reviews of topographic surveys . Served as the EOR for hydraulic analysis, EOR for roadway and urban and rural bridge design elements including H&V geometry, roadside drainage, QA of plan production, LRFR for RCB structures for the replacement of four (4) Off-System bridge sites in Tangipahoa with RC slab spans and RCB's.		
03/14 – 08/21 (previous employer)	S.P. H.004113, I-12 to Bush: LA 3241 (LA 435 to LA 40/41), St. Tammany Parish, LA (LADOTD) – Project Manager/Engineer of Record. Performed field and office QC of topographic surveys , lead the design team as EOR and was responsible for all roadway design elements including hydraulics, roadway H&V geometrics, superelevation, intersection design, R-CUT and J-turn intersections, prepared Level 3 Traffic Management Plan, prepared roadway plans, served as bridge design QC engineer for twin 4-span AASHTO Type III girder bridges over Talisheek Creek, oversaw entire plan production for 5.5-mile, greenfield, new corridor including a four-lane rural roadway from LA 435 to Bush, LA that included R/W mapping with 101 parcels.		
04/23 – 05/24	S.P. No. H.015025, McLin Road over Darling Creek, St. Helena Parish, LA (LADOTD) – Project Manager. Responsible for the coordination and production of topographic surveys and all roadway and bridge design elements including H&V geometrics, drainage design, hydraulics and scour analysis, foundation layout, non-standard curved slab span design, curved approach slabs, guardrail design, GP&E, low profile runaround, inroads modeling, bridge TS&L, and oversight of road and bridge plan production for the 4-span Off-System Bridge replacement in St. Helena Parish. Project was completed under an accelerated design schedule.		

16. Staff Experience:

05/20 – 08/21 (previous employer)	Contract 44-17598 - Rural Bridge Replacement Initiative Phase I (47 bridge structures), Districts 04, 05, 08, 58 (LADOTD) - Project Manager/Supervising Engineer. Performed QC review of topographic surveys and R/W Maps and served as the supervising engineer for roadway, geometrics, and bridge design elements including hydraulics analysis, scour, horizontal/vertical alignments, Level 1/2 TMP's, bridge design & LRFR (non-standard structures) including RC Slab Span and LG-25 girders, coordination and oversight of geotechnical and environmental services, SOV's, CE document preparation and permit applications for the spot replacement of 47 bridge structures in northern Louisiana containing nine (9) Off-System Bridges.
03/23 – 06/24	S.P. No. H.014993, Lemon Road over Drainage Bayou, East Baton Rouge Parish, LA (LADOTD) - Project Manager. Responsible for the coordination and production of topographic surveys and all roadway and bridge design elements including H&V geometrics, roadside drainage design, hydraulics and scour analysis, foundation layout, end bent and approach slab details to accommodate tapered barrier railing, guardrail design, GP&E, bridge TS&L, and oversight of road and bridge plan production for the 4-span Off-System Bridge replacement near Slaughter, LA.
03/23 – Ongoing	S.P. No. H.014984, Libuse Cutoff Road over Flagon Bayou, Rapides Parish, LA (LADOTD) - Project Manager. Responsible for the coordination and production of topographic surveys and all roadway and bridge design elements including H&V geometrics, roadside drainage design, hydraulics and scour analysis, foundation layout, non-standard curved slab span design, curved approach slabs, guardrail design, GP&E, bridge TS&L, and oversight of road and bridge plan production for the 5-span Off-System bridge replacement near Pineville, LA.
05/22 – Ongoing	EN22-0181, Rousseau Rd. Bridge over Tchefuncte River, St. Tammany Parish, LA (St. Tammany Parish Government) – Project Manager/Supervising Engineer. Responsible for the coordination and oversight of topographic surveys , R/W Mapping, roadway and bridge design elements including H&V geometrics, channel hydraulics, roadside drainage, bridge design elements including non-standard slab spans and bents to accommodate phased construction, LRFR of replacement bridge and rehabilitated structure, and served as the EOR for the bridge rehabilitation design using steel framed helper bents. Responsible for environmental assistance and subconsultant coordination for the replacement of the existing 4-span bridge with a 7-span concrete, slab span Off System Bridge near Covington, LA.
04/23 - Ongoing	Bridges Near Amite, Tangipahoa Parish, LA (Tangipahoa Parish) – Project Manager/Supervising Engineer. Responsible for the coordination and oversight of topographic surveys , R/W Mapping, roadway and bridge design elements including, developed structure alternatives and bridge TS&L, H&V geometry, urban drainage design, performed hydraulics analysis and scour, Inroads modeling, preparation of road and bridge plans for the replacement of five (5) bridge structures in Amite City and Independence, LA.
10/17 – 12/18 (previous employer)	MA-17-01, Roddy Road Widening (LA 935 to LA 621), Ascension Parish, LA (Ascension Parish) – Project Manager/Supervising Engineer. Responsible for the coordination and oversight of topographic surveys , R/W Mapping, with roadway and bridge design elements including the 68 parcels for the 1.5-mile road widening project for the Parish.
04/16 – 08/21 (previous employer)	S.P. H.013116, LA 20 Widening (LA 307 to S. Vacherie), St. James & Lafourche Parishes (LADOTD) – Project Manager/Supervising Engineer. Responsible for the oversight of topographic survey , roadway and bridge design services for the 1.9-mile safety widening of LA 20 near Vacherie, LA. Supervised all plan production activities and major roadway and bridge design elements including H&V geometrics, striping/signing, drainage design, roadway/bridge construction phasing, bridge superstructure and substructure elements, LRFR analysis and rating. Also responsible for the oversight of the geotechnical design of pavement and settlement analysis as well as concrete pile design.
01/12 – 08/15 (previous employer)	S.P. No. 713-29-0103, Tiger Drive Bridge over Bayou Lafourche, Lafourche Parish, LA (LADOTD) – Project Engineer. Responsible for roadway and bridge design elements including H&V alignments, bridge TS&L and non-standard bridge design elements to accommodate a 23' long span and water line attached to the bent caps for the 183' long Off-System bridge over Bayou Lafourche, in Thibodaux, LA.

16. Staff Experience:

Firm employed by: **Crescent Engineering & Mapping, LLC**



	Matthew J. Ledet, PLS Survey Manager			Years of relevant experience with this employer	3
				Years of relevant experience with other employer(s)	17
Degree(s) / Years / Specialization			Bachelor of Science/2008/Manufacturing Engineering Technology Bachelor of Science/2010/Geomatics		
Active registration number / state / expiration date			5104/LA/9-30-2026		
Year registered		2014	Discipline	PLS/Surveying	
Contract role(s) / brief description of responsibilities			Survey Lead/Surveyor of Record. Matt’s experience fulfills MPRs #1-2.		
Experience dates (mm/yy–mm/yy)		Experience and qualifications relevant to the proposed contract; i.e., “designed drainage”, “designed girders”, “designed intersection”, etc. Experience dates should cover the years of experience specified in the applicable MPR(s).			
11/24 – Ongoing		S.P. No. H.014056, I-69 Frontage Road Connector (Stonewall Frierson), Desoto & Caddo Parishes, LA (LADOTD) – Lead/Surveyor of Record. Led control and topographic survey. Establishing and leveling through 8 deep rod monuments driven to refusal for entire project. Performed data processing, coordinated survey field crews for the topographic surveys of 4 miles of existing road to be widened for future frontage road of I-69 to LA1.			
04/22 – 02/23		LA 3127 Widening (LA 20 to LA 3213), St. James Parish, LA (St. James Parish) – Lead/Surveyor of Record. Led topographic survey, performed and reviewed data processing and corrections, performed digital leveling of control monuments, coordinated survey field crews for the topographic surveys of 4.5 miles of roadway widening with a 350’ wide .DTM in accordance with LADOTD survey standards using Microstation/Inroads and CAD conform including GPS control establishment and SUE locates. Oversaw preparation of control and topographic survey deliverables.			
04/14 – 12/18 (previous employer)		S.P. H.004113, I-12 to Bush: LA 3241 (LA 435 to LA 40/41), St. Tammany Parish, LA (LADOTD) – Lead/Surveyor of Record. Led topographic survey, performed data processing and corrections, coordinated survey field crews for the topographic surveys of 5.5 miles of virgin, wooded, greenfield terrain with a 300’ wide .DTM, including control densification and SUE locates. Prepared all topo survey deliverables. Performed property surveys and created 60% Base and Final R/W maps including 101 parcels for the 5.5-mile, four-lane, new corridor roadway from Talisheek to Bush, LA.			
08/22 – Ongoing		S.P. H.015101, Lowes Ave at LA 44 Roundabout, Ascension Parish, LA (Ascension Parish Government) - Lead/Surveyor of Record. Led urban topographic and boundary survey efforts including survey along LA 44 and Lowes Ave in Gonzales for the design of a multi-lane roundabout, performed GPS control establishment and digital levels, field reconnaissance, field packs, title research and monument recovery, processed data and prepared LADOTD topo and Property Survey deliverables. Right of way maps to be completed.			
03/22 – 07/22		S.P. H.015333, H.015404, H.015407 – Tangipahoa IJA Bridge Replacements, Tangipahoa Parish, LA (LADOTD) – Lead/Surveyor of Record. Responsible for topographic surveys, crew coordination, data processing, existing drainage maps, GPS control establishment and digital leveling for the replacement of 5 bridge sites Parish-wide in Tangipahoa with RC Slab spans and RCB’s.			
01/24 - Ongoing		FP&C No. 50-J47-22-01, West Shore Connector Levee, St. James Parish, LA (St. James Parish Government) – Lead/Surveyor of record. Led topographic and boundary survey efforts for a new connector levee approximately 2.7 miles long including leveling of additional monuments and survey of the existing berm and borrow canal in the Lutcher/Grand Point area. The property base map covers 83 parcels. Survey and mapping efforts are still ongoing and adhere to USACE standards. Right of way maps to be completed.			

16. Staff Experience:

10/17 – 12/18 (previous employer)	MA-17-01, Roddy Road Widening (LA 935 to LA 621), Ascension Parish, LA (Ascension Parish) – Lead/Surveyor of Record. Led the topographic survey effort of the existing roadway, bridge, utilities and drainage systems as well as performed title take offs, property surveys, and prepared 60% Base and Final Right-of-Way Maps including 68 parcels for the 1.5-mile road widening project.
05/20 – 12/21 (previous employer)	Contract 44-17598 – Rural Bridge Replacement Initiative Phase I (47 bridge structures), Districts 04, 05, 08, 58 (LADOTD) – Lead/Surveyor of Record. Led survey effort including GPS control establishment, topographic surveys, data processing, deliverable preparation, property surveys and Right of Way Mapping for the replacement of 47 bridge structures in northern Louisiana containing nine (9) Off-System Bridges.
05/24 – 09/24	LA 1256 at Carlyss Dr., Calcasieu Parish, LA (Calcasieu Parish Government) - Lead/Surveyor of Record. Led urban topographic survey effort including survey of existing roadway, structures, utilities, and storm drainage systems along LA 1256 and Carlyss Dr. just outside the city of Sulphur for the design of intersection improvements including turn lanes and shoulders, performed GPS control establishment and digital levels, field reconnaissance, field packs, processed data and prepared LADOTD topographic survey deliverables.
10/23 – Ongoing	S.P. H.015334 9 St. Over St. Louis Canal, Terrebonne Parish, LA (LADOTD) – Lead/Surveyor of Record. Led establishment of control points, topographic survey, performed data processing and corrections , title take offs, established RW and property lines, coordinated survey field crews for the survey of the existing bridge. Created property surveys and 60% Base maps. Final Right of way maps to be completed.
03/23 – 04/23	S.P. No. H.014993, Lemon Road over Drainage Bayou, East Baton Rouge Parish, LA (LADOTD) – Lead Surveyor/Surveyor of Record. Responsible for topographic survey, crew coordination, oversight of data processing, LiDAR processing, field book documentation, development of topographic field roll , and channel cross sections associated with the replacement of an Off-System Bridge.
07/22 – 08/24	EN22-0181, Rousseau Rd. over Tchefuncte River, St. Tammany Parish, LA (St. Tammany Parish Government) – Lead Surveyor/Surveyor of Record. Responsible for topographic survey, additional emergency structure surveys , crew coordination, data processing, deliverable preparation, title take offs, property surveys and base and final right-of-way maps associated with the roadway re-alignment and Off-System bridge replacement along Rousseau Rd. in Covington, LA.
04/16 – 08/21 (previous employer)	S.P. H.013116, LA 20 Widening (LA 307 to S. Vacherie), St. James & Lafourche Parishes (LADOTD) – Lead/Surveyor of Record. Led survey effort for the 2.7-mile rural safety widening project including control establishment, topographic surveys, and property surveys. Performed field reconnaissance, prepared survey field crew packs, processed data and prepared deliverables. Prepared Title Take offs, base and Final Right of Way Maps including 9 parcels.
06/14 – 07/15 (previous employer)	S.P. No. H.011289, LA 70 Bypass (Detour Route), LA 70 Assumption Parish, LA (LADOTD) – Lead surveyor/Project Manager. Responsible for establishing control, topographic survey , Property Surveys, location of property markers for properties crossed by proposed by pass emergency route through the swamp to avoid issues with existing sinkhole to the south.
04/23 – 08/23	Bridges Near Amite and Bridges Near Independence, Tangipahoa Parish, LA (Tangipahoa Parish) – Lead/Surveyor of Record. Responsible for topographic surveys, crew coordination, data processing, existing drainage maps, GPS control establishment and digital leveling , prepared LADOTD topo survey deliverables using Microstation, Inroads and Cad Conform for the replacement of five (5) bridge structures within Amite City and Independence, LA. Also responsible for the creation and development of property maps and 60% Base Right-of-Way Maps for all 5 sites.
08/22-12/21 (previous employer)	MA-20-01, Move Ascension, Bluff Rd, LA 73 Connector, Ascension Parish, LA (Ascension Parish) - Lead/Surveyor of Record. Responsible for Topographic and Property Surveys, approximately 7000' connecting Bluff Rd. and LA 73 . Location of property markers for properties crossed along proposed route and creation of Base Right-of-Way Maps and Final Maps for the proposed route.
01/24 – 03/24	Oak Harbor Blvd. / Landmark Dr. Intersection, (St. Tammany Parish Government) - Lead/Surveyor of Record. Led urban topographic survey effort including survey of existing roadway, sidewalks, utilities, and storm drainage systems along Oak Harbor Blvd. and Landmark Dr. in Slidell for the design of a multi-lane roundabout, performed GPS control establishment and digital levels, field reconnaissance, field packs, processed data and prepared LADOTD topographic survey deliverables.

16. Staff Experience:

Firm employed by: **Crescent Engineering & Mapping, LLC**



	Kelly G. Jones Senior Technician		Years of relevant experience with this employer	2
			Years of relevant experience with other employer(s)	3
Degree(s) / Years / Specialization			Bachelor of Arts/2012/Mathematics & English	
Active registration number / state / expiration date			N/A	
Year registered	N/A	Discipline	N/A	
Contract role(s) / brief description of responsibilities			Survey Technician - Kelly will assist with data processing, topographic survey deliverables, and development of topographic surveys.	
Experience dates (mm/yy–mm/yy)	Experience and qualifications relevant to the proposed contract; i.e., “designed drainage”, “designed girders”, “designed intersection”, etc. Experience dates should cover the years of experience specified in the applicable MPR(s).			
04/22 – 02/23	LA 3127 Widening (LA 20 to LA 3213), St. James Parish, LA (St. James Parish) – Project Technician. Processed survey data and prepared survey deliverables for the survey of 5 miles of roadway widening with a 350’ wide .DTM, utilities, prepared GPS control sketches, survey alignments, survey .DTM surfaces, prepared survey control reports, forms and letters for the LADOTD topographic survey deliverables in Microstation, Inroads and CAD Conform.			
11/24 – Ongoing	S.P. No. H.014056, I-69 Frontage Road Connector (Stonewall Frierson), Desoto & Caddo Parishes, LA (LADOTD) – Survey Technician. Processed survey data and prepared survey deliverables for topographic survey efforts. Including road, utilities, and drainage elements. Create control sketches and reports for level loops and primary control for the I-69 Frontage Road segment SIU 15 near Stonewall, and the overall project from I-49 to LA-1.			
08/22 – Ongoing	S.P. H.015101, Lowes Ave at LA 44 Roundabout, Ascension Parish, LA (Ascension Parish Government) - Survey Technician. Processed survey data and prepared survey deliverables for topographic and boundary survey efforts, including survey along LA 44 and Lowes Ave in Gonzales for the design of a multi-lane roundabout, performed GPS control establishment and digital levels, field packs, title research and monument recovery, processed data and prepared LADOTD topographic and Property Survey deliverables .			
06/20 – 05/22 (previous employer)	Contract 44-17598 – Rural Bridge Replacement Initiative Phase I (47 bridge structures), Districts 04, 05, 08 & 58, (LADOTD) – Survey Technician. Processed survey data and prepared survey deliverables for the replacement of forty (47) bridge structures in northern Louisiana. Also assisted with Title Take Offs and the creation and development of property surveys and right-of-way maps.			
07/21 – 05/22 (previous employer)	Contract 44-19336 – Rural Bridge Replacement Initiative Phase II (40 bridge structures), Districts 04 & 05, (LADOTD) – Survey Technician. Processed survey data and prepared survey deliverables for the replacement of forty (40) bridge structures in northern Louisiana. Also assisted with Title Take Offs and the creation and development of property surveys and right-of-way maps.			
04/22 – 08/22	S.P. No.s H.015333, H.015404, H.015407 – Tangipahoa IJIA Bridge Replacements, Tangipahoa Parish, LA (LADOTD) – Survey Technician. Processed survey data and prepared survey deliverables for the survey of four (4) Off-System Bridge sites , prepared GPS control sketches, survey alignments, survey .DTM surfaces, prepared survey control reports, forms and letters for the LADOTD topographic survey deliverables in Microstation, Inroads and CAD Conform.			

16. Staff Experience:

01/24 - Ongoing	FP&C No. 50-J47-22-01, West Shore Connector Levee, St. James Parish, LA (St. James Parish Government) – Survey Technician. Processed topographic and boundary survey data for a new connector levee approximately 2.7 miles long in the Lutchter/Grand Point area. The property base map covers 83 parcels. Also helped construct Title take offs for all parcels. Survey and mapping efforts are still ongoing and adhere to USACE standards.
03/23 – 04/23	S.P. No. H.014993, Lemon Road over Drainage Bayou, East Baton Rouge Parish, LA (LADOTD) – Survey Technician. Processed survey data and prepared survey deliverables for the survey of a single Off-System Bridge replacement , prepared GPS control sketches, survey alignments, survey .DTM surfaces, prepared survey control reports, forms and letters and LADOTD survey deliverables in Microstation, Inroads and CAD Conform.
07/22 – 08/24	EN22-0181, Rousseau Rd. over Tchefuncte River, St. Tammany Parish, LA (St. Tammany Parish Government) – Survey Technician. Responsible for data processing, GPS control reports and sketches, prepared LADOTD topographic survey deliverables using Microstation, Inroads and Cad Conform for the replacement and re-alignment of the bridge. Also responsible title research, and for the creation and development of property maps and 60% and Final Right-of-Way Maps.
12/22 – 04/23	S.P. No. H.014980, Chinaberry Dr. over Unnamed Coulee, Acadia Parish, LA (LADOTD) – Survey Technician. Processed survey data and prepared survey deliverables for the survey of a single Off-System Bridge replacement, prepared GPS control sketches, survey alignments, survey .DTM surfaces, prepared survey control reports, forms and letters and LADOTD survey deliverables in Microstation, Inroads and CAD Conform.
04/23 – 08/23	Bridges Near Amite and Bridges Near Independence, Tangipahoa Parish, LA (Tangipahoa Parish) – Survey Technician. Responsible for data processing, GPS control reports and sketches, prepared LADOTD topographic survey deliverables using Microstation, Inroads and Cad Conform for the replacement of five (5) bridge structures within Amite City and Independence, LA. Also responsible title research, and for the creation and development of property maps and 60% Base Right-of-Way Maps for all 5 sites.
10/23 – Ongoing	S.P. H.015334 9th St. Over St. Louis Canal, Terrebonne Parish, LA (LADOTD) – Survey Technician. Responsible for data processing, GPS control reports and sketches, prepared LADOTD topographic survey deliverables using Microstation, Inroads and Cad Conform for the replacement and re-alignment of the bridge. Also responsible title research and for the creation and development of property maps and 60% Right-of-Way Maps. Awaiting Final Check Maps.
07/24 – 09/24	Brownswitch Rd. Bridge Replacement, St. Tammany Parish (St. Tammany Parish Government) - Survey Technician. Responsible for data processing, GPS control reports and sketches, prepared LADOTD topographic survey deliverables using Microstation, Inroads and Cad Conform. Also responsible title research, and for the creation and development of property maps including 6 parcels for the Off-System Bridge replacement and detour project near Slidell, LA.
05/20 – 08/21 (previous employer)	S.P. H.013116, LA 20 Widening (LA 307 to S. Vacherie), St. James & Lafourche Parishes (LADOTD) – Surveyor Technician. Processed topographic survey effort for the 2.7-mile rural safety widening project including control establishment, topographic surveys, and property surveys. Performed field reconnaissance, prepared survey field crew packs, prepared deliverables. Prepared base and Final Right of Way Maps including 9 parcels.
01/19 – 05/22 (previous employer)	ENG-17-013, LA 3127 Extension (LA 70 to LA 1), Ascension Parish, LA (Ascension Parish Government) – Survey Technician. Data processing using Microstation/Inroads and DOTD coding for topographic surveys and SUE deliverables, title take offs, processing, analyzing and calculating property surveys, assisted with preparation of base right of way including 12 parcels for the 6.8-mile roadway extension project .
05/19 – 05/22 (previous employer)	Harrison Improvements, St. Tammany Parish, LA (St. Tammany Parish Government) – Survey Technician. Data processing using Microstation/Inroads and DOTD coding for topographic surveys and SUE deliverables, title take offs, processing, analyzing and calculating property surveys, assisted with the preparation of right-of-way maps including 100 parcels for the 2.5 mile road widening project .
01/19 – 2/22 (previous employer)	MA-20-01, Move Ascension, Bluff Rd, LA 73 Connector, Ascension Parish, LA (Ascension Parish) - Survey Technician. Responsible for processing Topographic and Property survey data , approximately 7000' connecting Bluff Rd. and LA 73 . Location of property markers for properties crossed along proposed route and creation of Base Right-of-Way Maps and Final Maps for the proposed route.



16. Staff Experience:

Firm employed by: Crescent Engineering & Mapping, LLC

 <div>Dakota “Kody” Holley Survey Party Chief</div> 	Years of relevant experience with this employer		2
	Years of relevant experience with other employer(s)		4
Degree(s) / Years / Specialization			High School Diploma/2017
Active registration number / state / expiration date			N/A
Year registered	N/A	Discipline	N/A
Contract role(s) / brief description of responsibilities			Survey Party Chief
Experience dates (mm/yy–mm/yy)	Experience and qualifications relevant to the proposed contract; i.e., “designed drainage”, “designed girders”, “designed intersection”, etc. Experience dates should cover the years of experience specified in the applicable MPR(s).		
11/24 – Ongoing	S.P. No. H.014056, I-69 Frontage Road Connector (Stonewall Frierson), Desoto & Caddo Parishes, LA (LADOTD) – Survey Party Chief. Installed stainless steel deep-rod monuments for long-term, primary control, performed GPS static control surveys, ran digital levels for three (3) State projects over 20 miles long , performed topographic surveys for the I-69 Frontage Road segment SIU 15 near Stonewall, LA.		
04/22 – 02/23	LA 3127 Widening (LA 20 to LA 3213), St. James Parish, LA (St. James Parish) – Party Chief. Led topographic survey efforts for the survey of 5 miles of roadway widening with a 350’ wide .DTM, utilities, set GPS control, performed survey of existing road, drainage structures, and utilities using LADOTD codes and procedures.		
08/22 – Ongoing	S.P. H.015101, Lowes Ave at LA 44 Roundabout, Ascension Parish, LA (Ascension Parish Government) – Party Chief. Performed GPS topographic and boundary surveys of the existing road, drainage features, and property corners for use in design, drainage maps, and Property Survey maps, using LADOTD codes and procedures.		
01/24 – Ongoing	FP&C No. 50-J47-22-01, West Shore Connector Levee, St. James Parish, LA (St. James Parish Government) –Party Chief. Led topographic and boundary survey field efforts for a new connector levee approximately 2.7 miles long in the Lutchter/Grand Point area. Performing digital level loops, topographic surveys and property surveys for Right of Way maps including 83 parcels. Survey and mapping efforts are still ongoing and adhere to USACE standards. Right of way maps to be completed.		
05/23 – 06/23	S.P. No. H.015025, McLin Road over Darling Creek, St. Helena Parish, LA (LADOTD) – Party Chief. Performed GPS static control establishment, digital levels, and field topographic surveys of the existing bridge site, roadway, utilities and other features associated with the replacement of an Off-System Bridge in St. Helena Parish using LADOTD codes and procedures.		
03/23 – 04/23	S.P. No. H.014993, Lemon Road over Drainage Bayou, East Baton Rouge Parish, LA (LADOTD) – Party Chief. Performed GPS static control establishment, digital levels, and field topographic surveys of the existing bridge site, roadway, utilities and other features associated with the replacement of an Off-System Bridge near Slaughter, LA using LADOTD codes and procedures.		
04/23 – 05/23	S.P. No. H.014984, Libuse Cutoff Road over Flagon Bayou, Rapides Parish, LA (LADOTD) – Party Chief. Performed GPS static control establishment, digital levels, and field topographic surveys of the existing bridge site, roadway, utilities and other features associated with the replacement of an Off-System Bridge near Pineville, LA using LADOTD codes and procedures.		

16. Staff Experience:

Firm employed by: Crescent Engineering & Mapping, LLC

	Joseph C. Maurin Survey Party Chief			Years of relevant experience with this employer	1
				Years of relevant experience with other employer(s)	5.5
Degree(s) / Years / Specialization			High School Diploma/2017		
Active registration number / state / expiration date			N/A		
Year registered	N/A	Discipline	N/A		
Contract role(s) / brief description of responsibilities			Survey Party Chief		
Experience dates (mm/yy–mm/yy)	Experience and qualifications relevant to the proposed contract; i.e., “designed drainage”, “designed girders”, “designed intersection”, etc. Experience dates should cover the years of experience specified in the applicable MPR(s).				
11/24 – Ongoing	S.P. No. H.014056, I-69 Frontage Road Connector (Stonewall Frierson), Desoto & Caddo Parishes, LA (LADOTD) – Survey Party Chief. Installed stainless steel deep-rod monuments for long-term, primary control, performed GPS static control surveys, ran digital levels for three (3) State projects over 20 miles long, performed topographic surveys for the I-69 Frontage Road segment SIU 15 near Stonewall, LA.				
05/24 – Ongoing	S.P. H.015101, Lowes Ave at LA 44 Roundabout, Ascension Parish, LA (Ascension Parish Government) – Party Chief. Performed GPS topographic and boundary surveys of the existing road, drainage features, and property corners for use in design, drainage maps, and Property Survey maps, using LADOTD codes and procedures.				
05/24 – Ongoing	FP&C No. 50-J47-22-01, West Shore Connector Levee, St. James Parish, LA (St. James Parish Government) –Party Chief. Led topographic and boundary survey field efforts for a new connector levee approximately 2.7 miles long in the Lucher/Grand Point area. Performing digital level loops, topographic surveys and property surveys for Right of Way maps including 83 parcels. Survey and mapping efforts are still ongoing and adhere to USACE standards. Right of way maps to be completed.				
05/24 – 09/24	LA 1256 at Carlyss Dr., Calcasieu Parish, LA (Calcasieu Parish Government) - Party Chief. Performed GPS static control establishment, digital levels, field topographic surveys of the existing roadway, utilities, SUE locates, drainage and other features, survey for property maps for intersection improvements with a 250’ wide .DTM, using LADOTD codes and procedures.				
09/24 – 10/24	S.P. No. H.014984, Libuse Cutoff Road over Flagon Bayou, Rapides Parish, LA (LADOTD) – Party Chief. Performed additional field topographic surveys of the existing bridge site, roadway, utilities and other features associated with the replacement of an Off-System Bridge.				
07/24 – 09/24	Brownswitch Rd. Bridge Replacement, St. Tammany Parish (St. Tammany Parish Government) - Party Chief. Performed GPS static control surveys, digital levels, topographic surveys and property surveys for Right of Way maps including 6 parcels for the Off-System Bridge replacement and detour project near Slidell, LA. Right of way maps to be completed.				
05/24 – 09/24	LA 1256 at Carlyss Dr., Calcasieu Parish, LA (Calcasieu Parish Government) - Party Chief. Performed GPS static control establishment, digital levels, field topographic surveys of the existing roadway, utilities, SUE locates, drainage and other features, survey for property maps for intersection improvements with a 250’ wide .DTM, using LADOTD codes and procedures.				
05/24 – 06/24	S.P. No. H.015334, 9th Street over St. Louis Canal, Terrebonne Parish, LA (LADOTD) – Party Chief. Performed GPS static control establishment, digital levels, property surveys and field topographic surveys of the existing bridge site, roadway, utilities and other features associated with the Off-System Bridge replacement in Houma, LA as a part of the District 02 IJA Program.				

SECTION 17

GPS 8

RTK 7

FP&C 50-J47-21-01

LA 3127 Widening (LA 20 to LA 3213)

St. James Parish

Topographic Survey of 5 Miles of Roadway

Surveyor of Record: Matthew J. Ledet, PLS

17. Firm Experience:

Firm name	Crescent Engineering & Mapping, LLC			Discipline(s)*	Survey
LA 3127 Widening (LA 20 to LA 3213)				Firm responsibility (prime or sub?)	Prime
Project number	50-J47-21-01	Owner's name	St. James Parish Government/LADOTD		
Project location	Vacherie, LA		Owner's Project Manager	Ryan Larousse/Jacob Fusilier, P.E., PMP (LADOTD)	
Owner's address, phone, email		5800 LA Hwy 44, Convent, LA 70723 225-206-1379 ryan.larousse@stjamesparishla.gov			
Services commenced by this firm (mm/yy)		04/22	Total consultant contract cost (\$1,000's)		\$1,525
Services completed by this firm (mm/yy)		Ongoing	Cost of consultant services provided by this firm (\$1,000's)		\$1,180

The LA 3127 Widening project involves widening 3.5 miles of existing 2-lane roadway to a 4-lane divided section with a 64' wide, depressed median, directional U-turns, Restricted Crossing U-turns (R-CUT's) and multi-lane roundabouts at the LA 3213 and LA 20 intersections with LA 3127.

Crescent Engineering & Mapping, LLC is the prime consultant for the project and is responsible for all **topographic surveying**, hydraulic analysis and design, Level 3 TMP, roadway/J-Turn/roundabout geometrics, **property surveys, R/W mapping**, inroads modeling, utility coordination, permit drawings, patching, mill/overlay and reconstruction of the existing LA 3127 roadway, agency coordination, construction support, geotechnical and environmental coordination, and plan production. Crescent has completed the control and topographic surveying for a total of **5 miles of roadway** in the project, including **establishment of primary monumentation, digital level runs, capturing data for a 350' wide DTM along LA 3127 and LA 3213 as well as a varying DTM along LA 20**. Additional drainage structures were also captured for the **existing drainage maps which encompass approximately 8500 acres**. Other efforts completed include traffic studies and the 60% Preliminary Plans. Preliminary Plans are currently ongoing. The project is being reviewed by LADOTD and FP&C at all submittal stages. All deliverables are being developed **per LADOTD design guidelines and plan requirements** using Microstation/Inroads, and all survey efforts conform to the Location & Survey Manual.

Team Members Highlighted in this Proposal: Dennis M. Hymel Jr., P.E., Matthew Ledet, P.L.S., Kelly Jones, Dakota Holley

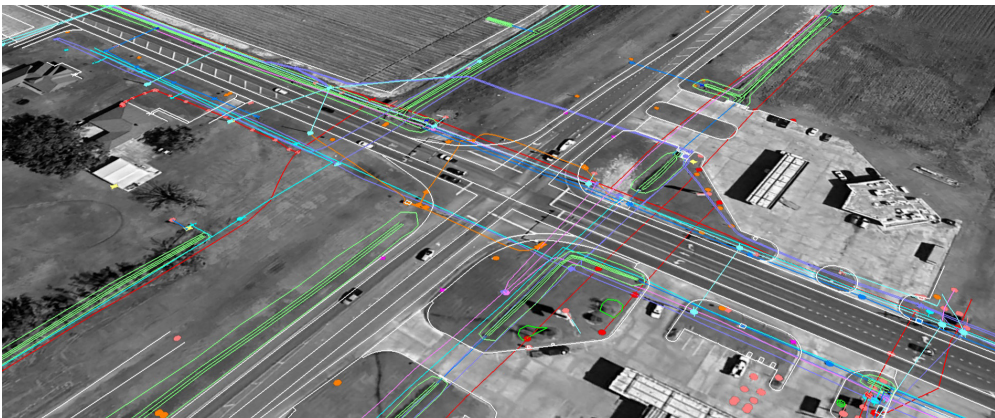

17. Firm Experience:

Firm name	Crescent Engineering & Mapping, LLC			Discipline(s)*	Survey
Tangipahoa IJIA Bridge Replacements				Firm responsibility (prime or sub?)	Prime
Project number	H.015404, H.015407, H.015333	Owner's name	Tangipahoa Parish/LADOTD		
Project location	Tangipahoa Parish, LA		Owner's Project Manager	Kevin Greer / Ryan Rodney	
Owner's address, phone, email	206 E. Mulberry St., Amite, LA 70422; 985-244-6880; kgreer@tangipahoa.org				
Services commenced by this firm (mm/yy)		04/22	Total consultant contract cost (\$1,000's)		\$677
Services completed by this firm (mm/yy)		Ongoing	Cost of consultant services provided by this firm (\$1,000's)		\$447

The Tangipahoa Parish IJIA Bridges is part of the District 62 IJIA (BIL) bridge replacement project and involves the replacement of 4 bridge structures on E. Lewiston, Easley and Old Genessee roads in Tangipahoa Parish. Grouped into three (3) state projects, each project includes topographic surveys, hydraulics analysis, scour, bridge design, roadway design, geotechnical, environmental and contract management.

Crescent Engineering & Mapping, LLC is the prime consultant for the project and is responsible for the **topographic surveys**, hydraulic analyses and modeling, scour analyses, bridge design, roadway design, LRFR, utility surveys and roadway/bridge plan production. Crescent has completed the control and topographic surveying for the **4 bridge sites** in the project, including **establishment of primary monumentation, digital level runs, and capturing necessary data** at each bridge site for the designers use. The project's deliverables are being developed per LADOTD design guidelines and plan requirements using Microstation/Inroads, creating the required DGNs and DTM.

Crescent has completed the topographic surveys, hydraulic analysis, road design, bridge design, Preliminary Plans and received environmental clearance for all 3 projects. Crescent has submitted 98% Final Plans on 2 of the 3 state projects and is currently anticipating on submitting 95% Final Plans on the third project by the end of November 2025.

Team Members Highlighted in this Proposal: Dennis M. Hymel Jr., P.E., Matthew Ledet, P.L.S., Kelly Jones

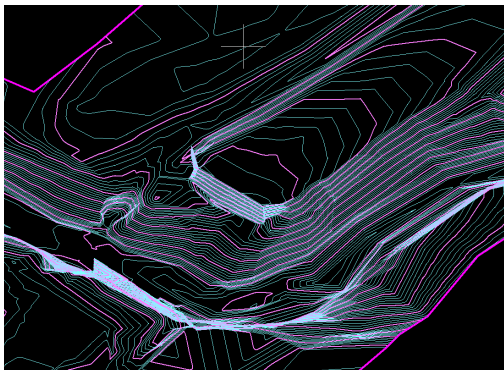

17. Firm Experience:

Firm name	Crescent Engineering & Mapping, LLC			Discipline(s)*	Survey
West Shore Connector Levee				Firm responsibility (prime or sub?)	Sub
Project number	50-J47-22-01	Owner's name	St. James Parish Government		
Project location	St. James Parish, LA		Owner's Project Manager	Ryan Larousse	
Owner's address, phone, email		5800 Hwy 44, Convent, LA 70723; 225-206-1379; ryan.larousse@stjamesparishla.gov			
Services commenced by this firm (mm/yy)		02/24	Total consultant contract cost (\$1,000's)		Unknown
Services completed by this firm (mm/yy)		Ongoing	Cost of consultant services provided by this firm (\$1,000's)		\$1,163

The Westshore Lake Pontchartrain Connector Levee project includes a 2.7 mile earthen levee, pump stations, bridges and sector gates through virgin terrain following along the St. James Parish M-2 canal and connecting to two (2) US Army Corps of Engineers (USACE) approved ring levees in the communities of Gramercy/Lutcher and Grand Point, LA. The project is being designed and constructed in accordance with USACE's Hurricane and Storm Damage Risk Reduction System Design (HSDRRS) standards with the ultimate goal of becoming part of the Westshore Lake Pontchartrain system, which stretches from the east bank of St. James Parish to the Bonnet Carre spillway in St. Charles Parish.

Crescent Engineering & Mapping, LLC, as a subconsultant, is responsible for all **topographic, bathymetric, and Right of Way surveys** necessary for the project's hydraulic modeling, access roads/bridges, pump stations, sector gates and the levee section itself. Initial surveying for the hydraulic modeling including all canals and lateral channels was completed in 2023 and included major channel transects and general land transects for LiDAR ground-truthing. Crescent completed the primary control establishment, over **15 miles of digital levels** and full topographic survey of the levee alignment, pump station and gate locations in late 2024 which included nearly **3 miles of topographic survey with a .DTM width of 300' through virgin, forested swamplands** with boat access only. In 2024, Crescent **performed title take-offs and property surveys on 86 parcels** to develop the Base R/W maps, many of these parcels are legacy tracts which have never been surveyed. Crescent is currently preparing the Title Research reports for all 86 parcels and will begin Final R/W map production in the summer of 2025 along with Title Update Reports and will assist in the R/W acquisition process.

Team Members Highlighted in this Proposal: Dennis M. Hymel Jr., P.E., Matthew Ledet, P.L.S., Kelly Jones, Dakota Holley, Joseph Maurin



17. Firm Experience:

Firm name	Crescent Engineering & Mapping, LLC			Discipline(s)*	Survey
I-69 Frontage Road Connector (Stonewall Frierson)				Firm responsibility (prime or sub?)	Sub
Project number	H.005184, H.014054, H.014056	Owner's name	Louisiana Department of Transportation and Development (LADOTD)		
Project location	Caddo and Desoto Parishes		Owner's Project Manager	Timothy Nickel, PE	
Owner's address, phone, email	1201 Capitol Access Rd., Baton Rouge, LA 70802; 225-379-1110; timothy.nickel@la.gov				
Services commenced by this firm (mm/yy)		10/24	Total consultant contract cost (\$1,000's)		Unknown
Services completed by this firm (mm/yy)		Ongoing	Cost of consultant services provided by this firm (\$1,000's)		\$1,214

The I-69 Frontage Road Connector (Stonewall Frierson) project is part of the overall I-69 Frontage Road corridor from I-49 to LA Hwy 1 located south of Shreveport, LA in Desoto and Caddo Parishes, as provided for in the I-69 Environmental Impact Statement (EIS), Segment of Independent Utility 15 (SIU-15). Three projects (H.014056, H.005184 and H.014054) combine to construct over 10 miles of Frontage Road for the future I-69 corridor. The frontage road is proposed as two (2) 12' lanes with 10' shoulders, with a portion consisting of the reconstruction and widening of Stonewall-Frierson Rd. (H.014056) from I-49 to Wallace Lake Rd., approximately 3.2 miles in length and the remainder (H.005184 and H.014054) through virgin terrain, terminating at LA Hwy 1 near the Caddo-Bossier Port.

Crescent Engineering & Mapping, LLC is a subconsultant on this project team and is responsible for setting all **primary survey control for all three (3) project segments, topographic survey of the I-69 Frontage Road Connector (Stonewall Frierson)** (H.014056) segment, roadway design for the I-69 Frontage Road Connector segment and bridge design for two structures on the I-69 FRTG. RD. CONN. (Ellerbe Rd to LA 1) segment at Bayou Pierre and Chico Bayou Relief. The project's primary control included **eight (8) deep rod monuments** driven to refusal and encapsulated in anti-settlement sleeves and nearly **30 miles of digital leveling** through these monuments. The topographic survey of the H.014056 segment consists of **3.7 miles of ± 250' wide .DTM full topographic surveys and drainage maps** as well as nearly **1 mile of ±450' wide .DTM survey along I-49**. Crescent has completed the primary survey control network and is scheduled to complete the topographic surveys by mid-2025.

Team Members Highlighted in this Proposal: Dennis M. Hymel Jr., P.E., Matthew Ledet, P.L.S., Kelly Jones, Dakotah Holley, Joseph Maurin

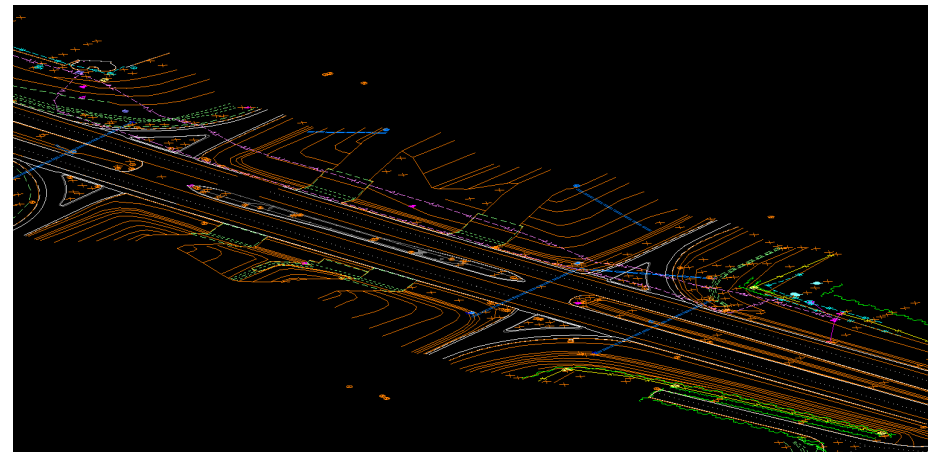

SECTION 18

H.015101

Lowes Ave at LA 44 Roundabout

Ascension Parish, LA

Topographic and Right of Way Surveying



18. Approach and Methodology:

INTRODUCTION

The **Crescent Engineering & Mapping (Crescent)** team brings **37 years** of combined experience producing **Topographic Survey deliverables** for LADOTD and transportation projects. This experience spans the entire project life cycle, from early coordination and man-hour negotiations, site visits and utility coordination, establishing control and capturing field data, data processing, and generating final deliverables. Crescent's staff have completed this work under past **LADOTD Topographic retainer contracts**, State projects, and parish/city-level transportation initiatives, all across the state using LADOTD standards to ensure quality and consistency.

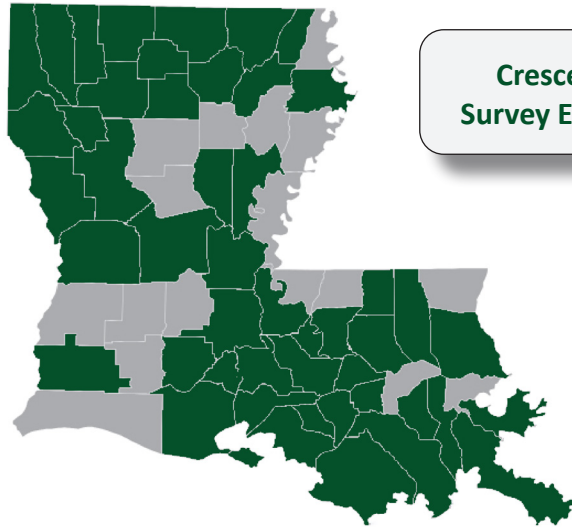

Crescent Staff LADOTD
Survey Experience by Parish

YOUR PROJECT TEAM

Crescent's Survey Manager, Matthew Ledet, PLS, brings over a **decade** of experience managing LADOTD survey efforts and has worked on Topographic Surveying projects since 2004. His background spans all aspects of survey execution, including field operations, office production, and project administration. He is actively involved throughout the project lifecycle, from coordinating daily field operations, collecting and processing survey data, and producing final survey deliverables. Mr. Ledet's experience **includes complex**

transportation corridors in both urban and rural settings, **roundabout and bridge replacement sites**, and **roadway rehabilitation efforts** requiring a **high level of topographic detail**.



Kelly Jones brings a strong attention to detail, structure, and a strong command of LADOTD topographic standards to every project. As Crescent's **Senior Survey Technician**, she is responsible for managing the translation of raw field data into accurate and complete topographic deliverables. She reviews the attributes and recodes as necessary to ensure connectivity of each day's data. To ensure the quality of the data, Mrs. Jones expanded Crescent's internal QA/QC checklist by incorporating feedback and best practices from previous task orders, which helps streamline submittals.

Client Project No.: Crescent Project No.: Project Name: Technician: Kelly Jones Reviewer: Matthew Ledet, PLS		Crescent Engineering & Mapping, LLC	
Surveyor of Record: Matthew Ledet, PLS		Vertical:	Horizontal:
No.	General Survey	Task:	Box:
1	Survey matches the survey request form (scope, a control points are)		
2	SPM width is accurate to what was requested by the requesting state agency		
3	Horizontal/vertical data from the request form have been verified		
4	Reconnaissance form received versus survey for compatibility		
5	File for consistency of field notes		
6	Field book review conducted. Station match survey/field corrected		
7	Photographs included and available for future reference		
No.	Control	Task:	Box:
1	Control points are visible from the project		
2	Length of station section is sufficient		
3	Control points are located correctly (left, right, back)		
4	Control points are located on the primary station points (GPS, LGS)		
5	Control points are located on the primary station points (GPS, LGS)		
6	Control points are located on the primary station points (GPS, LGS)		
7	Control points are located on the primary station points (GPS, LGS)		
8	Control points are located on the primary station points (GPS, LGS)		
9	Control points are located on the primary station points (GPS, LGS)		
10	Control points are located on the primary station points (GPS, LGS)		
11	Control points are located on the primary station points (GPS, LGS)		
12	Control points are located on the primary station points (GPS, LGS)		
13	Control points are located on the primary station points (GPS, LGS)		
14	Control points are located on the primary station points (GPS, LGS)		
15	Control points are located on the primary station points (GPS, LGS)		
16	Control points are located on the primary station points (GPS, LGS)		
17	Control points are located on the primary station points (GPS, LGS)		
18	Control points are located on the primary station points (GPS, LGS)		
19	Control points are located on the primary station points (GPS, LGS)		
20	Control points are located on the primary station points (GPS, LGS)		
21	Control points are located on the primary station points (GPS, LGS)		
22	Control points are located on the primary station points (GPS, LGS)		
23	Control points are located on the primary station points (GPS, LGS)		
24	Control points are located on the primary station points (GPS, LGS)		
25	Control points are located on the primary station points (GPS, LGS)		
26	Control points are located on the primary station points (GPS, LGS)		
27	Control points are located on the primary station points (GPS, LGS)		
28	Control points are located on the primary station points (GPS, LGS)		
29	Control points are located on the primary station points (GPS, LGS)		
30	Control points are located on the primary station points (GPS, LGS)		
31	Control points are located on the primary station points (GPS, LGS)		
32	Control points are located on the primary station points (GPS, LGS)		
33	Control points are located on the primary station points (GPS, LGS)		
34	Control points are located on the primary station points (GPS, LGS)		
35	Control points are located on the primary station points (GPS, LGS)		
36	Control points are located on the primary station points (GPS, LGS)		
37	Control points are located on the primary station points (GPS, LGS)		
38	Control points are located on the primary station points (GPS, LGS)		
39	Control points are located on the primary station points (GPS, LGS)		
40	Control points are located on the primary station points (GPS, LGS)		
41	Control points are located on the primary station points (GPS, LGS)		
42	Control points are located on the primary station points (GPS, LGS)		
43	Control points are located on the primary station points (GPS, LGS)		
44	Control points are located on the primary station points (GPS, LGS)		
45	Control points are located on the primary station points (GPS, LGS)		
46	Control points are located on the primary station points (GPS, LGS)		
47	Control points are located on the primary station points (GPS, LGS)		
48	Control points are located on the primary station points (GPS, LGS)		
49	Control points are located on the primary station points (GPS, LGS)		
50	Control points are located on the primary station points (GPS, LGS)		
51	Control points are located on the primary station points (GPS, LGS)		
52	Control points are located on the primary station points (GPS, LGS)		
53	Control points are located on the primary station points (GPS, LGS)		
54	Control points are located on the primary station points (GPS, LGS)		
55	Control points are located on the primary station points (GPS, LGS)		
56	Control points are located on the primary station points (GPS, LGS)		
57	Control points are located on the primary station points (GPS, LGS)		
58	Control points are located on the primary station points (GPS, LGS)		
59	Control points are located on the primary station points (GPS, LGS)		
60	Control points are located on the primary station points (GPS, LGS)		
61	Control points are located on the primary station points (GPS, LGS)		
62	Control points are located on the primary station points (GPS, LGS)		
63	Control points are located on the primary station points (GPS, LGS)		
64	Control points are located on the primary station points (GPS, LGS)		
65	Control points are located on the primary station points (GPS, LGS)		
66	Control points are located on the primary station points (GPS, LGS)		
67	Control points are located on the primary station points (GPS, LGS)		
68	Control points are located on the primary station points (GPS, LGS)		
69	Control points are located on the primary station points (GPS, LGS)		
70	Control points are located on the primary station points (GPS, LGS)		
71	Control points are located on the primary station points (GPS, LGS)		
72	Control points are located on the primary station points (GPS, LGS)		
73	Control points are located on the primary station points (GPS, LGS)		
74	Control points are located on the primary station points (GPS, LGS)		
75	Control points are located on the primary station points (GPS, LGS)		
76	Control points are located on the primary station points (GPS, LGS)		
77	Control points are located on the primary station points (GPS, LGS)		
78	Control points are located on the primary station points (GPS, LGS)		
79	Control points are located on the primary station points (GPS, LGS)		
80	Control points are located on the primary station points (GPS, LGS)		
81	Control points are located on the primary station points (GPS, LGS)		
82	Control points are located on the primary station points (GPS, LGS)		
83	Control points are located on the primary station points (GPS, LGS)		
84	Control points are located on the primary station points (GPS, LGS)		
85	Control points are located on the primary station points (GPS, LGS)		
86	Control points are located on the primary station points (GPS, LGS)		
87	Control points are located on the primary station points (GPS, LGS)		
88	Control points are located on the primary station points (GPS, LGS)		
89	Control points are located on the primary station points (GPS, LGS)		
90	Control points are located on the primary station points (GPS, LGS)		
91	Control points are located on the primary station points (GPS, LGS)		
92	Control points are located on the primary station points (GPS, LGS)		
93	Control points are located on the primary station points (GPS, LGS)		
94	Control points are located on the primary station points (GPS, LGS)		
95	Control points are located on the primary station points (GPS, LGS)		
96	Control points are located on the primary station points (GPS, LGS)		
97	Control points are located on the primary station points (GPS, LGS)		
98	Control points are located on the primary station points (GPS, LGS)		
99	Control points are located on the primary station points (GPS, LGS)		
100	Control points are located on the primary station points (GPS, LGS)		

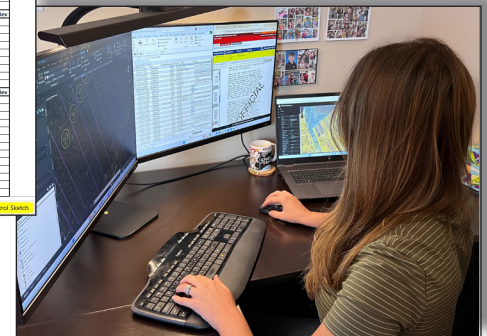

18. Approach and Methodology:

Dakotah Holley and **Joseph Maurin** serve as Crescent's **Party Chiefs**, working together to execute field operations. Their dual-lead approach allows them to collaborate on most assignments, split up tasks when needed, and problem-solve in real time, which boosts both productivity and data quality in the field.



Dakotah works directly with the Survey Manager to coordinate daily field efforts, and regularly incorporates feedback from both the PLS and CAD technician to refine field coding and reduce in-office corrections.

Joseph brings a sharp eye for detail and is especially known for maintaining a thorough and well-organized field book. His consistent notes and clear field sketches enhance the team's internal QA/QC process, allowing for easy verification of attributes and streamlines the office review process.

Dakotah and Joseph are both proficient in operating Crescent's GNSS GPS receivers, total stations, and digital level equipment, and in collecting field data for all types of topographic projects. On projects with expedited timelines, Dakotah and Joseph can divide responsibilities; for example, one may focus on setting control monuments and leveling, while the other paints section locations or begins collecting features with RTK. On more detail-oriented tasks, however, they work side by side, taking continuous notes and photos, cross-checking data as it's collected. This approach of having two party chiefs on one project allows Crescent to maintain accuracy and efficiency and allows them to collaborate on the spot.

TEAM STRUCTURE AND INTEGRATION

Crescent's flexible team structure allows Mr. Ledet to rotate into the field to support tight schedules or to deploy two complete crews on separate projects. While Kelly manages data processing and project support from the office, Dakotah and Joseph can lead independent crews in the field. The strength of Crescent's surveying team lies in the fact that they are a close-knit group that communicates directly between the office and the field, with everyone clearly understanding the project scope and expectations.

To ensure Crescent's work remains aligned with current LADOTD standards, Crescent's team regularly review the LADOTD website for updates to the Location and Survey Manual and maintains communication with members of the Location and Survey section. Looking towards the future for LADOTD's transition to **OpenRoads Designer (ORD)**, both Kelly and Matthew completed a **4-day DOTD training course** in October 2024 from Zen Engineering, LLC.

FIRM RESOURCES

Crescent utilizes the latest in-office and field technology to deliver survey projects for our clients, including Bentley Power Inroads/Open Roads Designer, Trimble Business Center, Bluebeam CAD Revu, Altiva CadConform, Trimble R12 GNSS/GLONASS Survey units with Trimble Access and Trimble S7 Robotic Total Stations. Crescent also has multiple vessels for accessing waterways, and ATVs for use in off road or virgin terrain.

CRESCENT EQUIPMENT/ITEM	QTY
Trimble R10 and R12 RTK/GNSS Units	6
Field Data Collectors	3
Conventional Total Stations	1
Trimble S7 Robotic Total Station	1
Utility Vehicles/ATVs	3
16'-18' Vessel with Outboard	2
10' Skiff	1
Schonstedt GA-52Cx	4

PROJECT UNDERSTANDING

Crescent Engineering understands the vital role that topographic survey services play in the successful delivery of DOTD's projects. The survey data is the first step to beginning design and moving projects along, and having accurate and complete survey data reduces project delays and rework. We've supported DOTD across previous IDIQ contracts and understand the need to tailor survey scopes to fit design intent, whether it's a simple pavement preservation project, a bridge replacement, corridor widening, or new road through virgin terrain. Crescent has the capacity to support multiple projects concurrently, including those requiring rapid mobilization or difficult terrain.

18. Approach and Methodology:

PROPOSED SCHEDULE

Proposed Project Schedule (Typical 1.5 Mile x 150' Topo)						
Stage/Task	1	2	3	4	5	6
Pre-field Coordination						
Establish Control						
Control Sketch/Report						
Topographic Survey						
Data Processing						
Final Deliverables & QA/QC						

Crescent understands overall schedule will vary greatly due to the project size and location.

PROJECT SCOPING AND NEGOTIATIONS

Upon notification of a new Task Order, Crescent will coordinate a meeting with DOTD personnel to review the Survey Request Form, finalize the scope and survey limits, deliverables, and make a site visit, as this will reveal any special considerations of the site. Communication protocols will be established, and an initial schedule developed to reflect critical milestones or potential delays, such as access issues or 811 response times. Crescent will then prepare a detailed man-hour estimates to support efficient and transparent negotiations with DOTD. Crescent's staff have negotiated numerous contracts with DOTD successfully on past survey projects.

FIELDWORK COORDINATION

Upon issuance of the finalized Task Order and the Notice to Proceed, Crescent will initialize the work by issuing Land Owner Notification letters, coordinating utility information through 811 locates, and review of any previous data, if available. An excel spreadsheet will be kept of responses from land owners and 811 responses with any additional information such as size and material of lines.

Another initial coordination effort will be for any needed temporary traffic control. Crescent will coordinate with the DOTD District for appropriate timing of work to maximize safety, minimize inconvenience to motorist, or scheduling around other ongoing work. Field books will be requested and received from DOTD and these along with detailed field packs will be given to the crew to start the field survey.

ESTABLISHING CONTROL

Control is the foundation of successful data collection. Crescent will identify optimal control point locations, whether caps and rods in concrete or deep rod monuments driven to refusal as decided during scoping. Ideal sites are free from overhead obstructions and electrical interference, minimizing GPS signal errors. Control points are placed where they are both accessible and unlikely to be disturbed. Static GNSS data will be collected on these monuments and processed using Trimble Access within Trimble Business Center, which uploads the data to OPUS for precise solutions. The processor automatically selects the correct antenna type from observation files, eliminating user error. OPUS reports are reviewed for runtime and acceptable error percentages. All solutions are averaged and converted via NGS's NCAT tool.



Vertical control is established through digital level loops starting and ending on the same control point, using Trimble DiNi digital levels. These loops encompass all primary/secondary monuments, TBMs, and topo nails used for collecting data. Final misclosures are checked against required tolerances. GPS vertical values are assessed based on statistical accuracy, and level loop elevations are adjusted to align with the most reliable GPS-derived value.

CONTROL SKETCH/REPORT

All of the field procedures and findings are compiled into a comprehensive control report, including the processes used to establish horizontal and vertical control. A stamped and signed GPS Control Sketch of the traverse for project monumentation, OPUS Solution printouts, the NGS Opus Solution Reduction Report, NGS Coordinate Conversion and Transformation data, adjusted level loops, benchmark tabulations, and data sheets for GPS and RTK control points are included in the control report. The data sheets include each point's location, driving directions, reference points, photos of monument locations, and final northing/easting coordinates, latitude, longitude, and elevation.

18. Approach and Methodology:

The Control Sketch undergoes a verification process, with OPUS reports, NCAT transformation, and final state plane spreadsheet values all cross-checked for consistency. Once the Control Sketch is approved by DOTD, Crescent is ready to begin actual topographic data collection.

TOPOGRAPHIC SURVEY

Crescent's Party Chiefs and field crews are trained to collect topographic data in accordance with LADOTD's Location and Survey Manual. Each field crew is equipped with robotic total stations and RTK GPS systems, allowing for flexible workflows in both open and developed environments.

Crescent captures pavement edges, sidewalks, bridges, fences, utilities, culverts, signs, trees, and other visible improvements using LADOTD feature code library. Ground shots are collected in open areas, with tighter spacing in drainage-critical zones or areas of elevation change. Hydraulic features such as ditches, culvert inverts, and channel bottoms are measured with sufficient detail to support accurate surface modeling and design. Manholes, valves, overhead lines, and any 811-marked subsurface features are surveyed and identified in the field, with field notes and photos taken to aid CAD and QA/QC workflows. The spreadsheet information for the initial 811 contacts are also referenced to add in additional attribute information received from the locators.

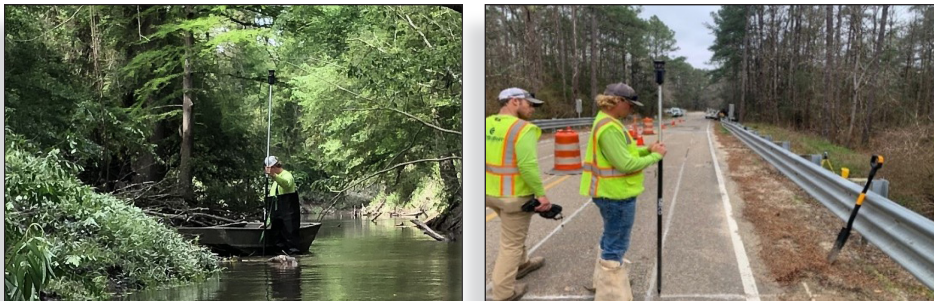

On past projects, Crescent has successfully adapted these techniques to complex environments. On a levee project with the United States Army Corps of Engineers (USACE), Crescent performed a 3 mile long topographic survey to support levee design. This work required extensive tree and underbrush clearing through swampy terrain which is only accessible via boat. Other transportation projects, such as the LA 44 Lowes Roundabout required work be performed at 4 AM on a Sunday morning to mitigate for heavy traffic. The ability for Crescent to adapt to different sites and conditions ensures that the same quality field work is produced regardless of the project size and location.

DATA PROCESSING

The data is imported into Trimble and adjusted to the project's control. Each day is exported into either a .DC or .SDR file and imported into a .fwd in Microstation/InRoads. The data is reviewed for accuracy of location and attributes employing the aid of site pictures along with aerial imagery. When updated street view is available, data is overlaid to assist with processing. Crescent technicians clean the raw data, confirm feature codes, resolve disconnected linework, and begin constructing a Digital Terrain Model (DTM) or Triangulated Irregular Network (TIN) for surface modeling.

FINAL DELIVERABLES/QAQC

Crescent applies multiple levels of QA/QC throughout the process. Field data is reviewed against field notes and photos, as well as comparisons for control points to verify for their correct and final adjustments. Each deliverable is reviewed by a second team member, by the technician and by the PLS, prior to submittal. This review process ensures nothing is missed and helps us maintain consistency and quality across all projects.

When Crescent is performing survey work for our in-house engineering team, we coordinate closely with them and utilize their own experience during the review process. This allows us to confirm that all desired features have been captured and that the survey reflects the full extent of site conditions necessary for them to design the proposed improvements.

All survey deliverables are created according to LADOTD Location and Survey Manual guidelines. Crescent is able to provide complete topographic deliverables that can be used in the design of projects, and if needed, can also be used for the basis of additional efforts such as for Right of Way maps.

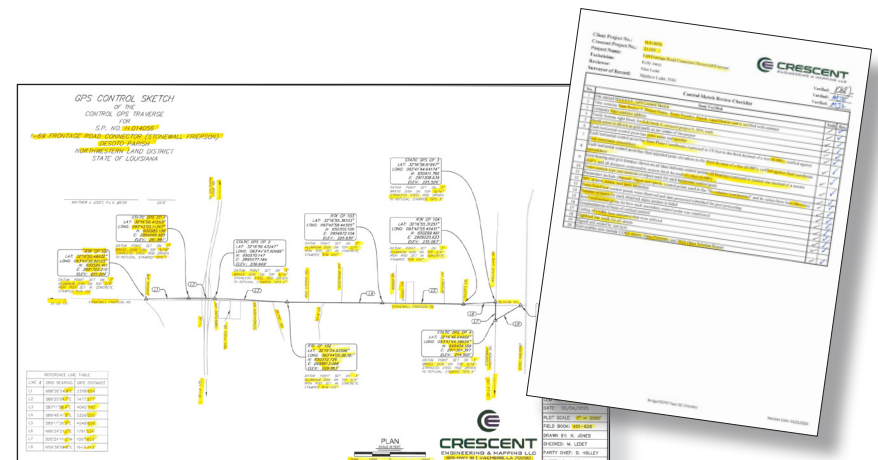

The background of the entire page is a topographic map of a river area. The map features contour lines in cyan and magenta, indicating elevation changes. A river channel is visible, flowing from the top left towards the bottom right. Overlaid on the map are numerous red circular markers, which represent survey points. These points are concentrated in a cluster in the center of the image, where the river appears to be crossing a bridge or a narrow section. The markers vary slightly in size and are connected by thin red lines, suggesting a specific survey path or area of interest. The overall color palette is muted, with the map's colors being the primary visual elements.

SECTION 19-23

H.015404 / H.015407 / H.015333

Tangipahoa IJJA Bridge Replacements

Tangipahoa Parish

Topographic Survey of 4 Existing Bridge Sites

Surveyor of Record: Matthew J. Ledet, PLS

19. Workload:

Firm(s) ALL FIRMS MUST BE REPRESENTED IN THIS TABLE	Discipline(s) *	Contract Number and State Project Number	Project name	Remaining Unpaid Balance**
	Road	44-24591; H.014992	McHugh Road Over Brushy Bayou	\$2,323
	Bridge	44-24591; H.014992	McHugh Road Over Brushy Bayou	\$995
	Planning	44-27180; H.016012	Transportation Alternatives Program (TAP), Task Order No. 1 (Technical Assistance to LPA's)	\$361
	Road	44-25035; H.014984	Libuse Cutoff Road Over Flagon Bayou	\$7,073
	Bridge	44-25035; H.014984	Libuse Cutoff Road Over Flagon Bayou	\$10,610
	Road	44-28434; H.015568	LA 44: Pelican Point Roundabout and Widen	\$318,421
	Bridge	44-28434; H.015568	LA 44: Pelican Point Roundabout and Widen	\$56,192
	Survey	44-27735; H.014056	I-69 Frontage Road Connector (Stonewall Frierson)	\$450,532
	Road	44-27735; H.014056	I-69 Frontage Road Connector (Stonewall Frierson)	\$379,580
	Bridge	44-27735; H.014054	I-69 Frontage Road Connector (Ellerbe Rd to LA 1)	\$119,262
	Road	44-24585; H.014980	Chinaberry Drive over Unnamed Coulee	\$6,155
	Bridge	44-24585; H.014980	Chinaberry Drive over Unnamed Coulee	\$1,086

20. Certifications/Licenses:

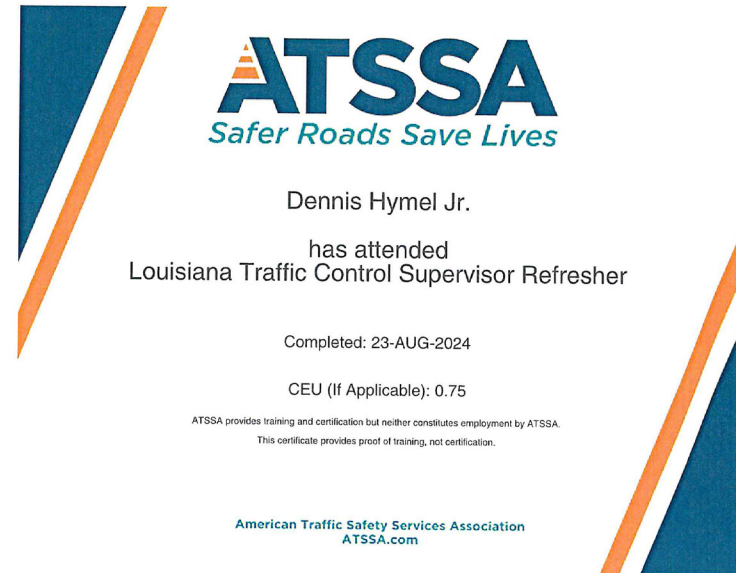

20. Certifications/Licenses:

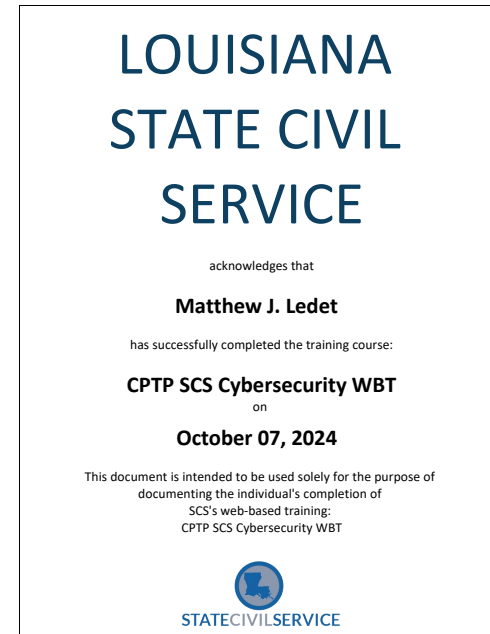

20. Certifications/Licenses:



20. Certifications/Licenses:



ATSSA
Safer Roads Save Lives

Joseph Mavrin
has attended
Louisiana Traffic Control Technician

Completed: 30-JUL-2024

CEU (If Applicable): 0.75

ATSSA provides training and certification but neither constitutes employment by ATSSA.
This certificate provides proof of training, not certification.

American Traffic Safety Services Association
ATSSA.com



ATSSA
Safer Roads Save Lives

Joseph Maurin
has attended
National Flagger Certification Training Course

Completed: 03-SEP-2024

CEU (If Applicable): 0

ATSSA provides training and certification but neither constitutes employment by ATSSA.
This certificate provides proof of training, not certification.

American Traffic Safety Services Association
ATSSA.com



ATSSA
Safer Roads Save Lives

Joseph Mavrin
has attended
Louisiana Traffic Control Supervisor

Completed: 01-AUG-2024

CEU (If Applicable): 1.5

ATSSA provides training and certification but neither constitutes employment by ATSSA.
This certificate provides proof of training, not certification.

American Traffic Safety Services Association
ATSSA.com



20. Certifications/Licenses:

Search for Louisiana Business Filings			
<div>Buy Certificates and Certified Copies</div> <div>Subscribe to Electronic Notification</div> <div>Print Detailed Record</div>			
Name	Type	City	Status
CRESCENT ENGINEERING & MAPPING, LLC	Limited Liability Company	VACHERIE	Active

21. QA/QC Plan and/or Work Plan:

QA/QC PLAN NOT PROVIDED PER ADVERTISEMENT

22. Sub-consultant information:

If one or more sub will be used, provide the name, address, point of contact and phone number for each. Otherwise, leave this section blank.

23. Location:

If location is an evaluation criterion for this advertisement and the prime consultant intends to establish a local presence, describe the plan for doing so. Otherwise, leave this section blank. Any information included in this section will be redacted if not required by the advertisement.



CRESCENT

ENGINEERING & MAPPING LLC

“Committed to Excellence, Focused on Delivery”

Vacherie, LA, 225.329.1742 | Thibodaux, LA, 985.200.1508 | www.crescentengla.com