

LEGEND

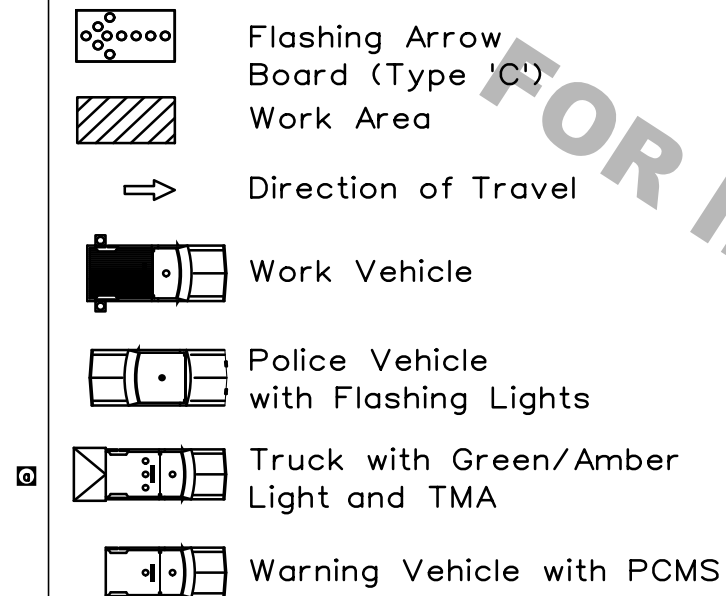

NOTES

This sheet shall be used with the Temporary Traffic Control General Notes Sheets TTC-00(A), TTC-00(B) and TTC-00(C).

1. This layout represents the minimum traffic controls required for moving operations, such as striping, street sweeping, etc., on interstates and multi-lane roadways. This layout shall not be used for placing signs or pavement legends along the roadway.
2. Distances between vehicles shall vary and should be adjusted due to drying time and sign obstructions such as overpasses and hills.
3. Striping operation is shown for the right lane. Left lane operation is the same, but opposite. If the roadway is greater than 2 lanes, a traffic control plan will be designed.
4. If a queue greater than 30 minutes (about 2 miles) exists, the contractor shall cease operations and pull over to the shoulder until the queue dissipates.
5. The protection vehicles shall be equipped with a flashing green/amber light and a truck mounted attenuator. This vehicle shall move with work operations not to exceed the roll-ahead distance required by the manufacturer plus 100 feet.
6. All construction vehicles with flashing lights shall use green/amber colors.

ALL TTC STANDARDS SHOW MINIMUM CONSTRUCTION SIGNING.
ALL SITUATIONS SHALL BE REVIEWED AND/OR DESIGNED BY THE ENGINEER.
CONTRACTORS ARE RESPONSIBLE FOR COMPLYING WITH ALL TTC STANDARDS.

