

## SIGNAL WORK ON A MULTI-LANE ROADWAY FOR UP TO ONE HOUR

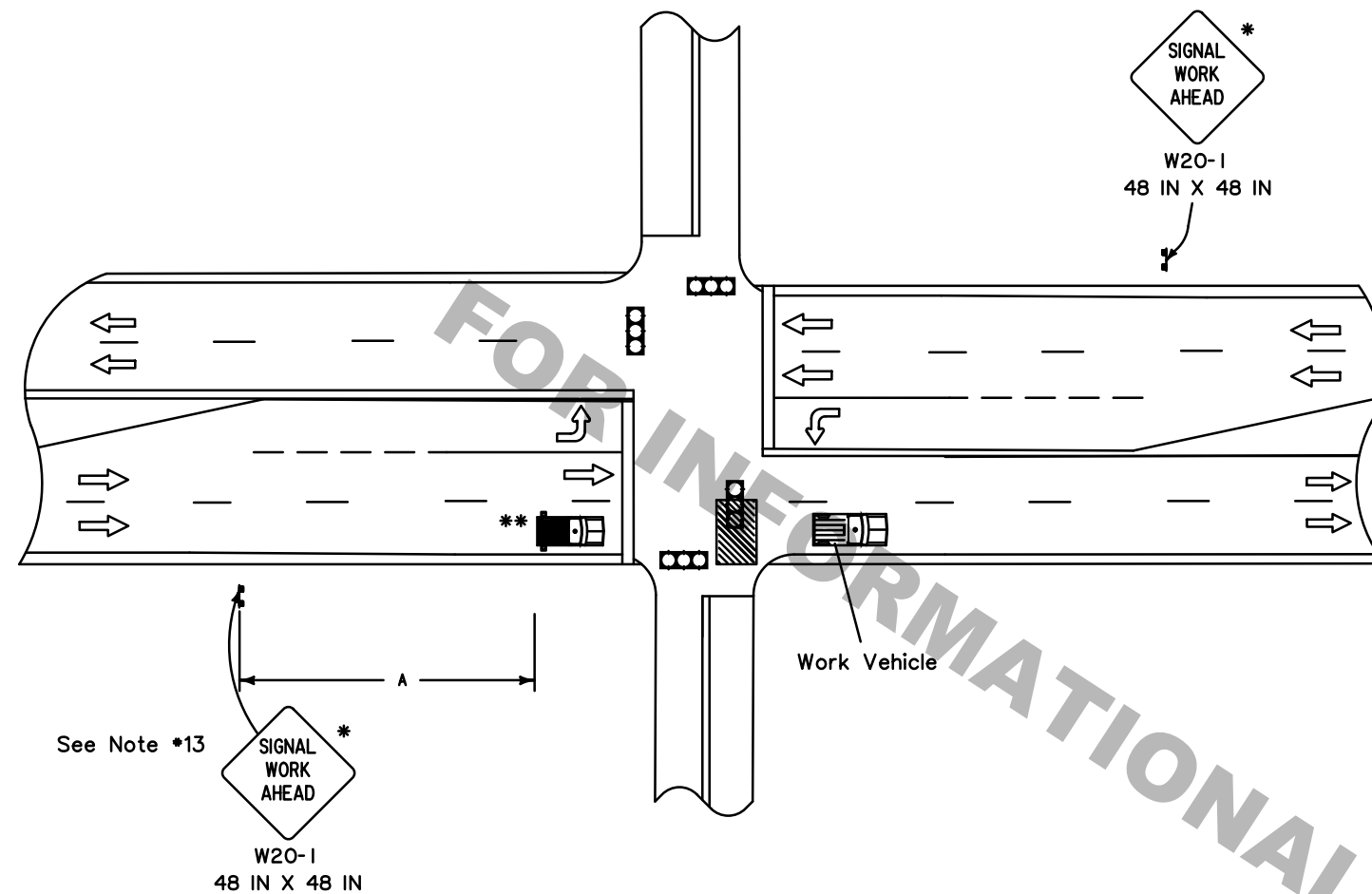

## SIGNAL WORK ON A TWO-LANE TWO-WAY ROADWAY

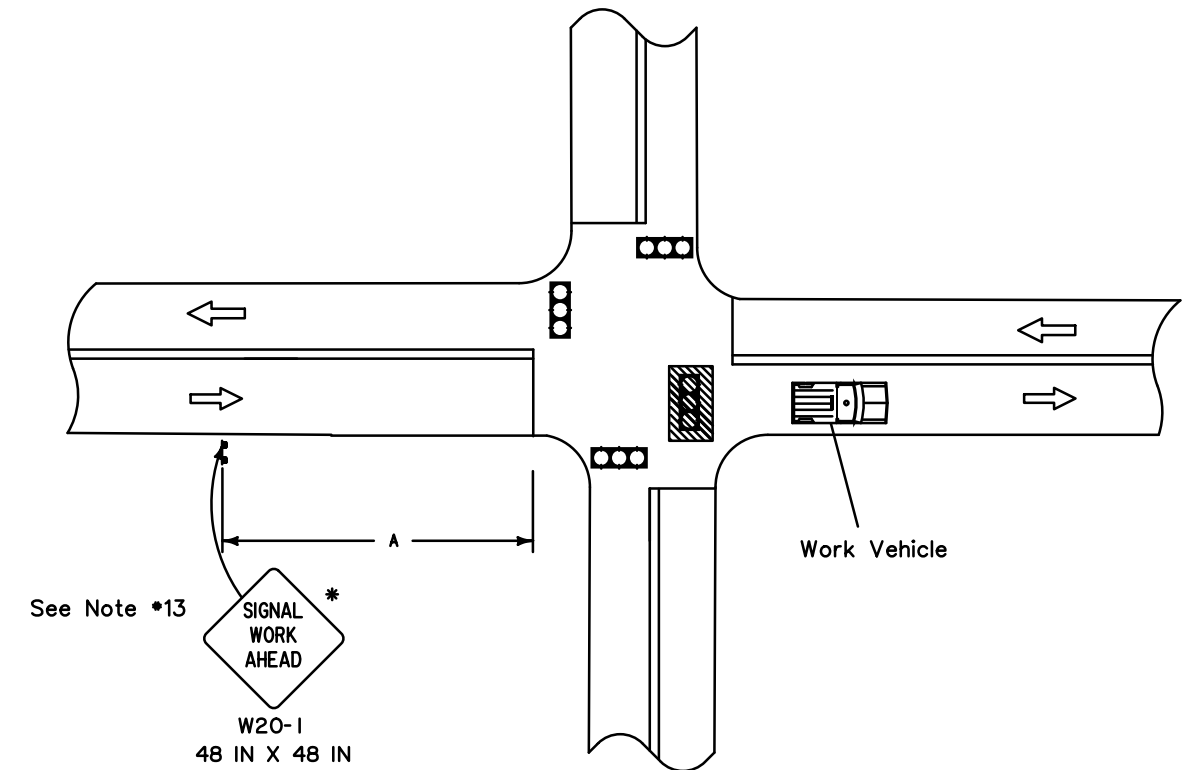







\* Any sign of the W20-1 series may be used.

**\*\* For posted speed over 45 mph, use TMA.**

SPEED LIMIT (prior to construction)	SPACING
	'A'
≤ 40 mph	125 FT
45-50 mph	350 FT
> 50 mph	500 FT

### LEGEND

-  Traffic Sign
-  Work Vehicle
-  Truck with Flashing Arrow Panel
-  Work Area
-  Direction of Travel
-  Traffic Signal

## NOTES

This sheet shall be used with the Temporary Traffic Control General Notes Sheets TTC-00(A), TTC-00(B), and TTC-00(C).

1. This layout represents the minimum traffic controls required during signal construction and maintenance.
2. For projects with multiple signals, the contractor shall construct only one signal at a time.
3. If the signal at an intersection is turned off, the intersection may operate as a 4-way stop with approval by the Engineer and the DTOE. The contractor shall be responsible for installing and removing all stop signs at the intersection.
4. A detour plan is required if the road will be closed to through traffic at all approaches.
5. A uniformed police officer shall direct traffic for short duration lane closures and signal turn-ons.
6. The turn lane may be used as a through lane if a minimum 10-foot lateral clearance can be maintained and opposing traffic is not impeded.
7. A signal timing and phasing plan shall be developed for each phase of construction.
8. Place "Road Work Ahead" sign prior to an intersecting alternate route, no more than 1500 feet from the work area.
9. The sign height shall be at least 7 feet in business, commercial, and residential areas and also near parking, pedestrians, bicyclists, or other obstructions.
10. All work must be done during off-peak hours.
11. The contractor shall not work on both through lanes at the same time.
12. For signal work on a multi-lane roadway greater than 1 hour, see TTC-09 or TTC-10.
13. If the expected or actual queue length exceeds the distance in Table 2C-4 in the MUTCD, place an additional "Signal Work Ahead" sign (W20-1) at the end of the queue.
14. For two-lane two-way roadways, a police car with flashing lights and 2 police officers will be required for intersection traffic control.
15. Left turn lanes shall be closed whenever work is being performed in path of left hand turner.
16. Position of work vehicle may vary according to work required.

ALL TTC STANDARDS SHOW MINIMUM CONSTRUCTION SIGNING.  
ALL SITUATIONS SHALL BE REVIEWED AND/OR DESIGNED BY THE ENGINEER.  
CONTRACTORS ARE RESPONSIBLE FOR COMPLYING WITH ALL TTC STANDARDS.