



# STATEMENT OF QUALIFICATIONS

**CONTRACT NOS. 4400023837 AND 4400023838**

**IDIQ CONTRACTS FOR CE&I SERVICES FOR SAFETY PROJECTS  
STATEWIDE WITH MAJORITY OF WORK IN DISTRICT 02, 61 & 62**



*Submitted To:*

Department of Transportation & Development  
Attn: Mr. Michael "Mike" Gorbaty  
Consultant Contract Services Administrator  
1201 Capitol Access Road, Room 405-E  
Baton Rouge, LA 70802  
**Via email: [DOTDConsultantAds80@la.gov](mailto:DOTDConsultantAds80@la.gov)**

*Submitted By:*

***ECM Consultants, Inc.***

8048 One Calais Ave., Suite F  
Baton Rouge, Louisiana 70809

Telephone: 225-615-7885 • Fax: 225-615-8548

[kazem@ecmconsultants.com](mailto:kazem@ecmconsultants.com)

*In Association with:*

Arcadis U.S., Inc.

GoTech, Inc. (DBE)

APS Engineering & Testing, LLC. (DBE)

**April 21, 2022**

# ***ECM Consultants, Inc.***

***Engineers • Architects • Construction Managers***

[www.ecmconsultants.com](http://www.ecmconsultants.com) [mail@ecmconsultants.com](mailto:mail@ecmconsultants.com)

1301 Clearview Parkway,  
Suite 200 Metairie, LA 70001  
Phone (504) 885-4080

8048 One Calais Avenue, Suite F  
Baton Rouge, LA 70809  
Phone (225) 615-7885

120 Rue Beauregard, Suite 120  
Lafayette, LA 70508  
Phone (504) 885-4080

Department of Transportation and Development  
ATTN: Mr. Michael "Mike" Gorbaty  
Consultant Contract Services Administrator  
1201 Capital Access Road, Room 405-E  
Baton Rouge, LA 70802

April 21, 2022

**Re: Statement of Qualifications for  
Contract No. 4400023837 and 4400023838  
IDIQ Contract for Construction Engineering and  
Inspection Services for Safety Projects (CE&I)  
Statewide with majority of work in Districts 02, 61, and 62**

Dear Mr. Gorbaty:

ECM Consultants, Inc., a locally owned consulting engineering firm, is pleased to submit an electronic PDF of our Statement of Qualifications DOTD Form 24-102 dated March 1, 2022, in response to Request for Qualifications for the above-referenced contract.

ECM has extensive experience providing Construction Contract Administration and Construction Engineering & Inspection (CE&I) services for Safety Projects in various Districts. These projects include performing CE&I services for sidewalks, ADA compliant ramps and crosswalks, pavement markings, signing, roadways improvements, drainage improvements, and high friction surfaces. ECM also provided CE&I for other projects that include roadway reconstructions, new subsurface drainage, utilities, lighting, traffic and pedestrian signals etc.

Our staff includes highly qualified Project Engineers and inspectors with the required licenses, certifications, and experience to provide exceptional services to LADOTD. The ECM Team is comprised of APS Engineering & Testing, LLC (DBE), to provide material laboratory testing, Arcadis U.S. Inc., for electrical for traffic signalization and ITS, and GoTech, Inc. (DBE) to provide verification surveying services. As our completed 24-102 will indicate, ECM Team substantially exceeds the minimum personnel requirements as stated in the Request for Qualifications.

We appreciate the opportunity to submit our statement of qualifications and hope our interest will receive favorable consideration. We are committed to providing exceptional CE&I services and continuing our excellent working relationship with LADOTD.

Should you have any questions or require any additional information, please contact us.

Respectfully submitted,

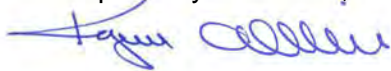

Kazem Alikhani, P.E.  
Chief Executive Officer

# **DOTD FORM: 24-102**

(Revised March 1, 2022)

## **PROPOSAL TO PROVIDE CONSULTANT SERVICES**

Prime consultant shall complete the DOTD Form 24-102 without altering the Form's text; however, the instruction and/or guidance for Sections 12 through 23 can be removed but do not remove Section title and number.

ANY CONSULTANT FAILING TO SUBMIT ANY OF THE INFORMATION REQUIRED ON THE DOTD FORM 24-102, OR PROVIDING INACCURATE INFORMATION ON THE DOTD FORM 24-102, MAY BE CONSIDERED NON-RESPONSIVE.

Prime consultant should enter the firm name in the footer at the bottom of this page. (It will carry over to subsequent pages.)

1. Contract title as shown in the advertisement	<b>IDIQ CONTRACTS FOR CE&amp;I SERVICES FOR SAFETY PROJECTS STATEWIDE WITH MAJORITY OF WORK IN DISTRICTS 02, 61 AND 62</b>
2. Contract number(s) as shown in the advertisement	<b>4400023837 AND 4400023838</b>
3. State Project Number(s), if shown in the advertisement	<b>NA</b>
4. Prime consultant name (as registered with the Louisiana Secretary of State where such registration is required by law)	<b><i>ECM Consultants, Inc.</i></b>
5. Prime consultant license number (as registered with the Louisiana Professional Engineering and Land Surveying Board (LAPELS) if registration is required under Louisiana law)	<b>EF.0002003</b> <b>DUNS: 957392723</b>
6. Prime consultant mailing address	<b>1301 Clearview Parkway, Suite 200</b> <b>Metairie, LA 70001</b>
7. Prime consultant physical address (existing or to be established, if location is used as an evaluation criteria)	<b>8048 One Calais Avenue, Suite F</b> <b>Baton Rouge, LA 70809</b>
8. Name, title, phone number, and email address of prime consultant's contract point of contact	<b>Kazem Alikhani, P.E.</b> <b>Chief Executive Officer</b> <b>O: (504) 885-4080, C: (504) 352-8531</b> <b><u><a href="mailto:kazem@ecmconsultants.com">kazem@ecmconsultants.com</a></u></b>

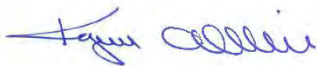
<p>9. Name, title, phone number, and email address of the official with signing authority for this proposal</p>	<p><b>Kazem Alikhani, P.E.</b>  <b>Chief Executive Officer</b>  <b>O: (504) 885-4080, C: (504) 352-8531</b>  <u><a href="mailto:kazem@ecmconsultants.com">kazem@ecmconsultants.com</a></u></p>	
<p>10. This is to certify that all information contained herein is accurate and true, and that the team presently has sufficient staff to perform these services within the designated time frame. By submitting this proposal, proposer certifies that it is not engaged in a boycott of Israel, and it will, for the duration of its contract obligations, refrain from a boycott of Israel. Proposer also certifies and agrees that the following information is correct: In preparing its response, the proposer has considered all proposals submitted from qualified, potential subcontractors and suppliers, and has not, in the solicitation, selection, or commercial treatment of any subcontractor or supplier, refused to transact or terminated business activities, or taken other actions intended to limit commercial relations, with a person or entity that is engaging in commercial transactions in Israel or Israeli-controlled territories, with the specific intent to accomplish a boycott or divestment of Israel. The proposer also has not retaliated against any person or other entity for reporting such refusal, termination, or commercially limiting actions. DOTD reserves the right to reject the response of the bidder or proposer if this certification is subsequently determined to be false, and to terminate any contract awarded based on such a false response.</p>	<p>Signature (shall be the same person as #9):</p>  <hr/> <p>Date: April 21, 2022</p>	
<p>11. If a Disadvantaged Business Enterprise (DBE) goal has been set for this advertisement, indicate which firm(s) will be used to meet the DBE goal and each firm(s)' percentage.</p>	<p><u>Firm(s):</u></p> <p><b>APS Engineering and Testing, Inc.</b>  <b>GoTech, Inc.</b></p>	<p><u>Firm(s)' %:</u></p> <p><b>3%</b>  <b>2%</b></p>



## 12. Past Performance Evaluation Discipline Table:

**Sub-consultants are allowed to be used for this proposal.** Fill in the table by identifying only those evaluation disciplines consistent with the approach and methodology proposed in Section 18 of the DOTD Form 24-102\*, the name of each firm that is part of the proposal, and the percentage of work in each past performance evaluation discipline to be performed by that firm. The percentage estimated for each evaluation discipline is for evaluation purposes only and will not control the actual performance or payment of the work. The percentages for the prime and sub-consultants must total 100% for each past performance evaluation discipline, as well as the overall total percent of the contract. (Add rows and columns as needed)

Evaluation Discipline(s)	% of Overall Contract	Prime ECM	Firm B ARCADIS	Firm C GOTECH	Firm D APS	Each Discipline must total to 100%
CE&I/OV	90	100				100%
Traffic/ITS	5		100			100%
Survey	2			100		100%
Other/Materials and Field Testing	3				100	100%
Identify the percentage of work for the <b>overall contract</b> to be performed by the prime consultant and each sub-consultant.						
Percent of Contract	100%	90%	5%	2%	3%	100%

The only past performance evaluation disciplines to be used are: Road, Bridge, Traffic, CE&I/OV, Geotech, Survey, Environmental, Data Collection, Planning, Right-of-Way, CPM, ITS, Appraiser and Other. The crosswalk from the old categories to the new categories can be found at the link below:

[http://wwwsp.dotd.la.gov/Inside\\_LaDOTD/Divisions/Engineering/CCS/General%20Information/CPPR%20Crosswalk%20to%20New%20Evaluation%20Disciplines.pdf](http://wwwsp.dotd.la.gov/Inside_LaDOTD/Divisions/Engineering/CCS/General%20Information/CPPR%20Crosswalk%20to%20New%20Evaluation%20Disciplines.pdf). (same link as in the advertisement)

Prime consultant name: *ECM Consultants, Inc.*

**13. Firm Size:**

For all firms that are part of this team, indicate the approximate number of personnel to be committed to this contract, by DOTD Job Classification and the total number of personnel within the firm that could provide support, if needed. If a specialized job classification is required and not included on the DOTD job classification list, specify "Other (xxxx)" and include the classification title inside the parentheses. The DOTD Job Classification(s) to be used can be found at the following link:

[http://wwwsp.dotd.la.gov/Inside\\_LaDOTD/Divisions/Engineering/CCS/Job\\_Qualification/Job%20Classifications%20with%20Descriptions.pdf](http://wwwsp.dotd.la.gov/Inside_LaDOTD/Divisions/Engineering/CCS/Job_Qualification/Job%20Classifications%20with%20Descriptions.pdf)

Firm name	DOTD Job Classification	Number of personnel committed to this contract	Total number of personnel available in this DOTD Job Classification (if needed)
ECM Consultants, Inc.	Principal	2	2
ECM Consultants, Inc.	Supervisor Engineer	1	3
ECM Consultants, Inc.	Engineer	4	8
ECM Consultants, Inc.	Supervisor - Others	1	3
ECM Consultants, Inc.	Senior Technician	1	2
ECM Consultants, Inc.	Inspector - Lead	3	4
ECM Consultants, Inc.	Inspector - Certified	4	8
ECM Consultants, Inc.	Inspector	3	4
ECM Consultants, Inc.	CADD Technician	1	2
Arcadis U.S., Inc.	Principal	1	4
Arcadis U.S., Inc.	Supervisor Engineer	1	3
Arcadis U.S., Inc.	Senior Technician	2	5
Arcadis U.S., Inc.	Engineer	1	9
APS Engineering and Testing, Inc.	Engineer	1	5
APS Engineering and Testing, Inc.	Technician	2	12
GOTECH, Inc.	Surveyor	1	2
GOTECH, Inc.	Party Chief	1	3

(Add rows as needed)

Prime consultant name: *ECM Consultants, Inc.*

#### 14. Organizational Chart:

Provide an organizational chart showing ALL **relevant** prime consultant and sub-consultant (if applicable) personnel assigned to the contract, area of project responsibility for each, and reporting lines for the purposes of this contract. An individual's role does not necessarily have to match their DOTD job classification identified in Section 13.

**If applicable, identify all personnel performing traffic engineering analysis and/or QC of traffic engineering analysis by placing an asterisk next to their name. Include the certificates required by the Traffic Engineering Process and Report Training Requirements article of the Advertisement in Section 20.** It is acceptable to use an 11x17 format for Section 14.

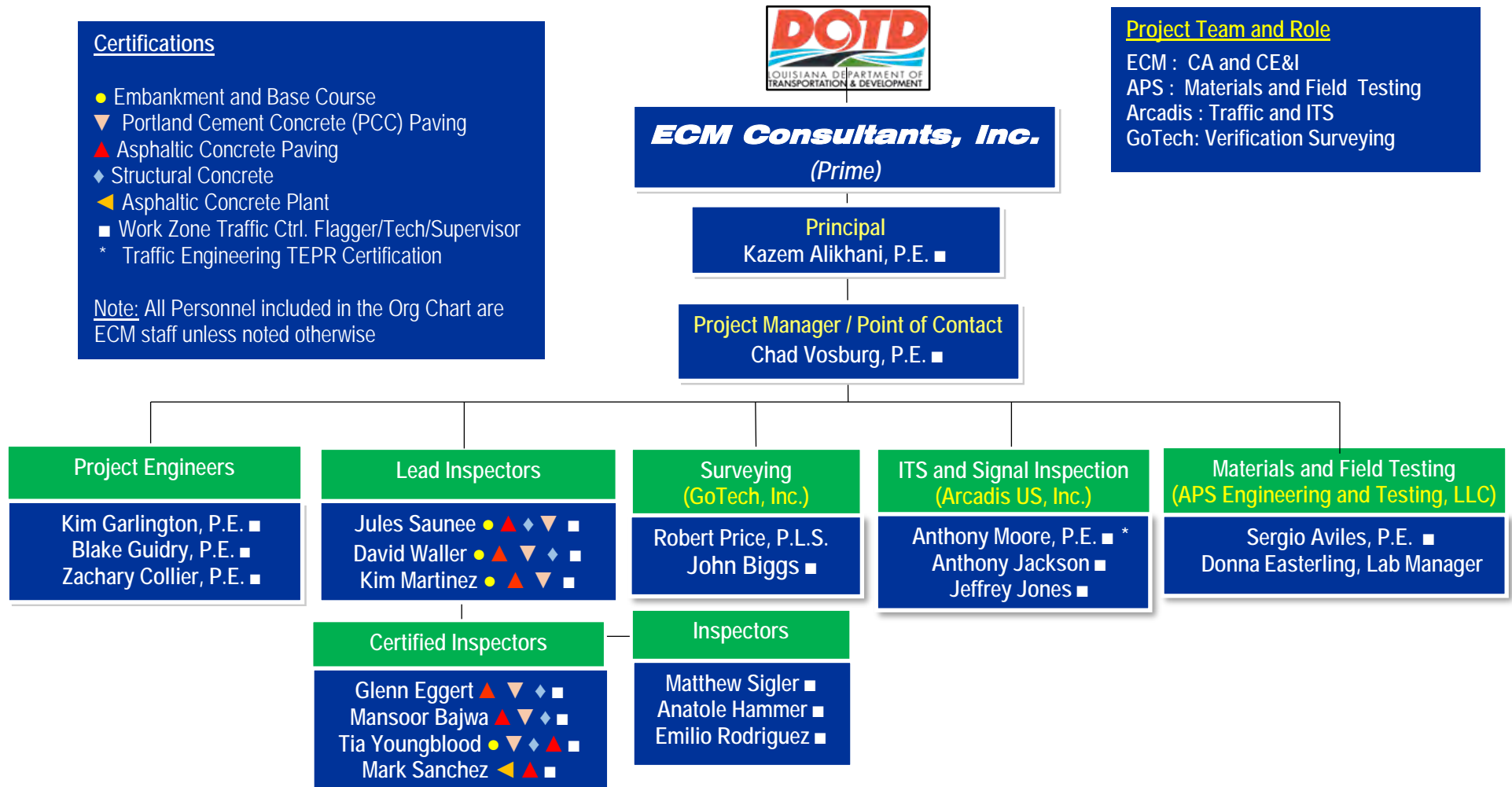

**15. Minimum Personnel Requirements:**

Use the table below to identify both prime consultant and sub-consultant staff designated to work on this contract meeting the Minimum Personnel Requirements (MPRs) specified in the advertisement. Ensure the résumé reflects the required experience stated in the MPR.

MPR No. Do not insert wording from ad	Personnel being used to meet the MPR (Individual(s) may not satisfy more than one MPR unless specifically allowed by Attachment B of the advertisement)	Firm employed by	Type of license / certification & number	Stat e of lice nse	License / certification expiration date
1	Kazem Alikhani, P.E. (41 years' experience)	ECM Consultants, Inc. (Prime)	Mechanical Engineer, Environmental Engineer, Professional Engineer (P.E.) PE.0025073	LA	PE.0025073 Exp. 03/31/2024
2	Chad Vosburg, P.E. (27 years' experience)	ECM Consultants, Inc. (Prime)	Civil Engineer Professional Engineer (P.E.) PE.0027677	LA	PE.0027677 Exp. 09/30/2022
	Kim Garlington, P.E. (36 years' experience)	ECM Consultants, Inc. (Prime)	Civil Engineer Professional Engineer (P.E.) PE.0023848	LA	PE.0023848 Exp. 09/30/2022
3	Chad Vosburg, P.E. (27 years' experience)	ECM Consultants, Inc. (Prime)	Civil Engineer Professional Engineer (P.E.) PE.0027677	LA	PE.0027677 Exp. 09/30/2022
	Blake Guidry, P.E. (10 years' experience)	ECM Consultants, Inc. (Prime)	Civil Engineer Professional Engineer (P.E.) PE.0041362	LA	PE.0041362 Exp. 03/31/2023
4	Kim Garlington, P.E. (36 years' experience)	ECM Consultants, Inc. (Prime)	Civil Engineer Professional Engineer (P.E.) PE.0023848	LA	PE.0023848 Exp. 09/30/2022
	Zachary Collier, P.E. (8 years' experience)	ECM Consultants, Inc. (Prime)	Civil Engineer Professional Engineer (P.E.) PE.0042957	LA	PE.0042957 Exp. 03/31/2023
5	Tony Moore, P.E. (30 years' experience)	Arcadis (Sub-consultant)	Civil Engineer Professional Engineer (P.E.) PE 0037887	LA	PE 0037887 Exp. 09/30/2023

Prime consultant name: *ECM Consultants, Inc.*

**16. Staff Experience:**

Résumés shall be provided for all prime and sub-consultant personnel listed in Sections 14 and/or 15 of the proposal. Résumés of personnel not identified in Section 14 or Section 15 of the proposal should not be included and will not be evaluated. Résumés should be limited to 2 pages per person. Any certificates required by the advertisement are to be placed in Section 20.

Firm employed by: <b>ECM Consultants, Inc.</b>			
Name	<b>Kazem H. Alikhani, P.E.</b>		Years of relevant experience with this employer
Title	<b>Chief Executive Officer</b>		Years of relevant experience with other employer(s)
Degree(s) / Years / Specialization		M.S./1984/Engineering Concentration in Civil, Hydraulic & Hydrology B.S./1980/Mechanical Engineering	
Active registration number / state / expiration date		PE 25073/Louisiana/Exp. 03/31/2024	
Year registered	<b>1992</b>	Discipline	Mechanical & Environmental Engineering
Contract role(s) / brief description of responsibilities		Mr. Alikhani will serve as Project Principal under this contract. <b>He is a registered Professional Engineer and meets MPR No. 1.</b>	
Experience dates (mm/yy–mm/yy)	Experience and qualifications relevant to the proposed contract; <i>i.e.</i> , “designed drainage”, “designed girders”, “designed intersection”, etc. Experience dates should cover the time specified in the applicable MPR(s).		
09/16 – 11/21	<b>Safe Routes to School, LADOTD; New Orleans, LA:</b> Mr. Alikhani served as Principal in Charge for this contract and has overseen projects in 11 locations across Districts 03, 07 & 61, <b>including sidewalk and intersection improvements, ADA access, traffic calming and speed-reduction improvements, off-street bicycle and pedestrian facilities, secure bike parking facilities, and traffic diversion improvements.</b> Locations have included Barbe Elementary in Calcasieu Parish, Pesson Elementary and LA-675/Jefferson Island in Iberia Parish, White Castle High School in Iberville Parish, Bernard Terrace & Westdale Middle School in East Baton Rouge Parish, Martin Street Sidewalks in St. Martin Parish, Choctaw Road in Lafourche Parish, Lafayette Local Roads HFST, Sidewalks in St. John the Baptist Parish, and St. Tammany Parish roadways.		
04/19-11/19	<b>S.P. No. H.009282 St. John the Baptist Parish Sidewalks, St. John the Baptist Parish, LA:</b> Mr. Alikhani served as Principal for this sidewalk and bike path project which is part of the <b>LA DOTD Safe Routes to School Program</b> . Work on this project included installation of sidewalks and handicapped curb ramps to provide safe pedestrian facilities for East St. John Preparatory Academy and the surrounding neighborhood. This project also completed a multi-use path which connects LaPlace Elementary School with the surrounding neighborhood.		
08/19-08/20	<b>S.P. No. H.009460 St. Tammany Parish Signing and Striping, St. Tammany Parish, LA:</b> Mr. Alikhani served as Principal for this safety project which is part <b>LA DOTD Safe Routes to Public Places Program</b> . This project includes implementation of safety features such as radar speed signs and flashing curve warning signs in several locations across the parish		

Prime consultant name: **ECM Consultants, Inc.**

06/19-02/20	<b>S.P. No. H.012236 North Kenner Pedestrian Safety Improvements, Jefferson Parish, LA:</b> Mr. Alikhani served as Principal for this sidewalk construction project which is part <b>LA DOTD Safe Routes to School Program</b> . This project includes ADA compliant pedestrian facilities
10/16-02/18	<b>Gravier Street (South Galvez to Broad St), New Orleans, LA:</b> Mr. Alikhani served as Principal for this \$5.8 million roadway reconstruction project. He was responsible for overall performance of design and resident inspection services for the project that included roadway removal, aggregate base, new PCC roadway pavement, <b>concrete sidewalks including ADA ramps</b> at all intersections and driveways. installation of new subsurface drainage, new waterlines, and sewer lines including service connections.
04/19-06/20	<b>S.P. No. H.006546 Intersection Upgrade N Canal &amp; 7<sup>th</sup> St., Lafourche Parish, LA:</b> Mr. Alikhani served as Principal for this <b>safety project which is part LA DOTD Safe Routes to Public Places Program</b> . Work on this project included installation of new turn lanes, traffic signals, sidewalks, and handicapped curb ramps. The project also included installation of new drainage pipes and structures and milling and overlay
10/18-03/20	<b>City Park Group A, New Orleans, LA:</b> Mr. Alikhani is in Principal in Charge for civil engineering design and CE&I services for this \$2.3 million City Park Group A project. The project scope includes full reconstruction of Taft Pl, Allard Blvd and St John Court and incidental patching for other streets in City Park Group A project. The project included design and preparation of plans, specifications, and cost estimates; hydraulic analysis to determine size of drain lines and number of catch basins for St John Court and Taft Place; replacement of all water and sewer mains; and removal and <b>reconstruction of sidewalks including ADA compliant ramps</b> at roadway intersections. Some streets under this project are in Parkview Historic District and the design for this followed all the required FEMA guideline for the Historic Area.
05/18 – 03/22	<b>Oakwood Smart Growth – Hector Avenue Improvements (Whitney Ave. to Terry Parkway):</b> Mr. Alikhani served as Principal for this project involving providing design and CE&I services. Scope of work included design for a 12-foot-wide pervious concrete shared-use pedestrian/bike path on the north side of Hector Avenue from Whitney Avenue to Terry Parkway with a pedestrian bridge crossing the canal at Wright Avenue. It also includes five 115-foot-long parking bays on the north side of Hector Ave. Where parking bays are not added, the road will be widened by two feet using pervious concrete for drainage. The project also includes creating a <b>pedestrian walkway on the south side of the roadway, striping and solar powered high visibility flashing lights on the pavement</b> , landscaping, trees, and green areas along both sides of the roadway
2018 – On going	<b>Severn Ave Corridor Improvements, Metairie, LA :</b> Mr. Alikhani is serving as principal in charge of this \$12 million six-lane roadway, bike and pedestrian improvement project from Veterans Blvd. to West Esplanade Ave. including subsurface drainage, <b>new ADA-compliant sidewalks, crosswalks, striping, pedestrian lighting</b> , landscaping, street lighting, pocket parks and. The area is densely populated by residences and businesses

Prime consultant name: *ECM Consultants, Inc.*



**16. Staff Experience:**

Résumés shall be provided for all prime and sub-consultant personnel listed in Sections 14 and/or 15 of the proposal. Résumés of personnel not identified in Section 14 or Section 15 of the proposal should not be included and will not be evaluated. Résumés should be limited to 2 pages per person. Any certificates required by the advertisement are to be placed in Section 20.

Firm employed by <b>ECM Consultants, Inc.</b>			
Name	<b>Chad Vosburg, P.E.</b>		Years of relevant experience with this employer
Title	<b>Vice President of Construction Services</b>		Years of relevant experience with other employer(s)
Degree(s) / Years / Specialization		<b>B.S. / 1993 / Civil Engineering</b>	
Active registration number / state / expiration date		<b>PE 27677 / LA / 09-2022</b>	
Year registered	<b>1984</b>	Discipline	<b>Civil Engineering</b>
Contract role(s) / brief description of responsibilities		<b>Mr. Vosburg will serve as Project Manager/POC under this contract. He meets MPR Nos. 2 and 3.</b>	
Experience dates (mm/yy–mm/yy)	Experience and qualifications relevant to the proposed contract; <i>i.e.</i> , “designed drainage”, “designed girders”, “designed intersection”, etc. Experience dates should cover the time specified in the applicable MPR(s).		
09/17-09/18	<b>Essen Lane Widening, LADOTD, East Baton Rouge Parish, LA:</b> Mr. Vosburg served as DOTD District Administrator for this <b>\$6.7 million construction project</b> involving installation of a cable safety barrier in the median for a 12-mile section, embankment, <b>pavement patching, asphalt overlay, guard railings, emergency crossovers and related work</b> . In addition to being responsible for Construction Engineering and Inspection work, Mr. Vosburg was also involved in Project Development that took place to meet safety initiative goals for LADOTD.		
01/16-06/18	<b>Baton Rouge Downtown Greenway, LADOTD, East Baton Rouge Parish, LA:</b> Mr. Vosburg served as DOTD District Administrator for this project in conjunction with the City of Baton Rouge. In addition to Construction Engineering and Inspection work, Mr. Vosburg was also involved in Project Selection, Project Design and Development, Public Outreach, working with City officials, Public Meetings, and Design and Constructability reviews. <b>Project Cost: \$1.8 million</b>		
01/16-07/18	<b>US 190: Guard Rail, Rutting repair, and J-turns, LADOTD, Pointe Coupee Parish, LA:</b> Mr. Vosburg served as DOTD District Administrator for this <b>\$14 million construction project</b> involving replacement of double sided thrie-beam rail throughout a 14-mile section. Repair work included removal of the existing guardrail, installation of new guardrail that <b>met current safety standards, asphaltic pavement overlay</b> , approach guardrail installation at bridge ends at all overpasses and at the Morganza Floodway Bridge. The project also included installation of J-turns inside the City limits of Livonia to improve left turning movements. Mr. Vosburg's role included development of the project scope, attendance of public meetings for DOTD, and he was responsible for Construction Contract Administration for the project.		

Prime consultant name: *ECM Consultants, Inc.*

08/00-05/03	<b>US 190: LA 415 to LA 983, Continuously Reinforced Concrete Pavement, LADOTD, West Baton Rouge Parish, LA:</b> Mr. Vosburg served as DOTD Project Engineer for this <b>\$17 million construction project</b> involving installation of 11" CRCP pavement. The project included phased work that converted a section of US highway with a center rail to be upgraded to current standards and included widening the existing drainage structure to be able to include a depressed median that conformed to the upgraded roadway section. This project upgraded a 10-mile section of US 190 including embankment, CRCP and asphalt paving, guard railings, turn lanes, crossovers and related work. In addition to being responsible for Construction Engineering and Inspection work, Mr. Vosburg was also involved in <b>Project Development to meet safety initiative goals for LADOTD.</b>
01/14-09/17	<b>Government St., East Blvd- Lobdell, LADOTD, East Baton Rouge Parish, LA/ Road Transfer Project:</b> , Mr. Vosburg served as DOTD District Administrator for this project in conjunction with the City of Baton Rouge. In addition to preparing for Construction Engineering and Inspection work, Mr. Vosburg was also involved in Project Design and Development, Public Outreach, working with City officials, Public Meetings, and Design and Constructability reviews. Work included several phases where traffic lanes were adjusted to allow for the completion of the project section by section. The project included <b>rehabilitating the existing pavement and implementing a "road diet" to incorporate bicycle and pedestrian friendly concepts.</b> Approximately 4.2 miles of Government street will be transformed into a more <b>bike and pedestrian friendly corridor.</b> A roundabout will replace the signalized intersection at Lobdell Avenue and Independence Park Boulevard. The turning geometry at Jefferson Highway will also be improved. <b>Project Cost: \$11.7 million</b>
08/16-08/18	<b>I-10: Cable Barrier installation, LADOTD, West Baton Rouge and Iberville parishes, LA:</b> Mr. Vosburg served as District Administrator for this construction inspection project that involved the installation of <b>a cable safety barrier in the median</b> for a 12-mile section, embankment, pavement patching, asphalt overlay, <b>guard railings, emergency crossovers</b> and related work. In addition to being responsible for the Construction Engineering and Inspection work, Mr. Vosburg also was involved in the Project Development that took place <b>to meet safety initiative goals for LADOTD Cost: Const. \$3.8M</b>
07/97-10/01	<b>Widening Jct. I-10 to US 61, LADOTD, East Baton Rouge Parish, LA:</b> Mr. Vosburg served as LADOTD Project Engineer for this <b>\$44 million construction project</b> to add an additional lane to I-12 from I-10 to US 61. The project included reconstruction of the Jefferson/Drusilla overpass. Work included drilled shafts, steel girders, concrete median barrier, concrete patching jointed concrete pavement, stabilized embankment, temporary sheet piling, lime treatment, class 2 base course, drainage and sign truss installation, along with other incidental items. In addition to being responsible for the Construction Engineering and Inspection work, Mr. Vosburg also was involved in Public Outreach for DOTD necessary throughout project phasing. Work included several phases where traffic lanes were adjusted to allow for the completion of the project section by section.

Prime consultant name: *ECM Consultants, Inc.*

**16. Staff Experience:**

Résumés shall be provided for all prime and sub-consultant personnel listed in Sections 14 and/or 15 of the proposal. Résumés of personnel not identified in Section 14 or Section 15 of the proposal should not be included and will not be evaluated. Résumés should be limited to 2 pages per person. Any certificates required by the advertisement are to be placed in Section 20.

Firm employed by <b>ECM Consultants, Inc.</b>			
Name	<b>Kim Martindale Garlington, P.E.</b>		Years of relevant experience with this employer
Title	<b>Senior Project Engineer</b>		Years of relevant experience with other employer(s)
Degree(s) / Years / Specialization		<b>B.S. / 1982 / Civil Engineering</b> ATSSA Work Zone Traffic Control Flagger, Technician, Supervisor	
Active registration number / state / expiration date		<b>#23848/LA/ 9/30/2022</b>	
Year registered	<b>1990</b>	Discipline	<b>Civil Engineering</b>
Contract role(s) / brief description of responsibilities		<b>Ms. Garlington will serve as Senior Project Engineer for this Contract. She meets MPR 2 and 4 .</b>	
Experience dates (mm/yy–mm/yy)	Experience and qualifications relevant to the proposed contract, <i>i.e.</i> , “designed drainage”, “designed girders”, “designed intersection”, etc. Experience dates should cover the time specified in the applicable MPR(s).		
<b>06/19-On going</b>	<b>S.P. No. H.003370, I-220 / I-20 Interchange IMP &amp; BAFB Access Road- Design-Build, LADOTD, Bossier Parish, LA.</b> Ms. Garlington is serving as Senior <b>Project Engineer</b> for this <b>\$77 million</b> design-build project to construct a new I-220 extension South of I-20 that will provide access to Barksdale Air Force Base, adding access ramps and enhancing capacity at the I-20/220 interchange including construction of four <b>bridge/overpass</b> over the existing KCS railway and Musselshell bayou. This includes a NB and SB I-220 overpass over I-20, and a NB and SB overpass over the KCS railway crossing. Ms. Garlington leads a team of inspectors responsible for the Contractor’s bridge construction activities that include pile driving, field pile acceptance, inspection of drilled shafts, installing bridge caps/abutments/columns, LG 78-54 & 45 prestressed concrete girders, diaphragms, shear keys and constructing bridge decks and approach slabs. Also included are <b>on grade roadway</b> including earthwork, <b>subbase and base, PCC pavement, Asphaltic Concrete pavement. drainage, and utilities relocation.</b> Ms. Garlington works with the OV Inspection team to interpret construction inspection specifications and contract performance specifications. Ms. Garlington wrote the Quality Control portion of the Construction Quality Management Plan (CQMP) for the project as required by the LADOTD Construction Quality Assurance Plan (CQAP). <b>Ms. Garlington utilizes the LADOTD’s Site Manager/Site Manager Materials/HEADLIGHT software daily.</b> Ms. Garlington evaluates QC/QA test results and generates Materials Test reports, Construction Inspection reports and writes Non-Conformance Reports (NCR’s) on materials and Construction activities when specifications are not met.		
<b>09/14 - 08/16</b>	<b>LADOTD - Natchitoches Parish – LA 490, LA 119, LA 488, LA 1220, LA 493, LA 495, LA 120, LA 480:</b> Ms. Garlington served as a <b>Project Engineer</b> for the reconstruction projects in the parish. Her responsibilities included preconstruction activities, plan review and <b>administration of the CE&amp;I contracts.</b> Work included clearing and		

Prime consultant name: **ECM Consultants, Inc.**

	grubbing, utility relocation, subgrade treatments, base rehabilitation, geosynthetic remediation measures, and <b>asphalt pavement activities</b> . Ms. Garlington drafted change orders, reviewed invoices and recommend contractor payments. Ms. Garlington <b>also implemented the Department's Site Manager Materials software for quality assurance on several projects.</b>
<b>02/11 – 03/12</b>	<b>840-43-0001 - LADOTD – Buhlow Bridge US 165 – Alexandria District:</b> Ms. Garlington served as <b>District 08's Construction Coordinator</b> and Laboratory Engineer during the Buhlow Bridge replacement over Red River. Work included concrete decks, girders, cofferdams, piles and drilled shaft foundations, embankment, class 2 base course, <b>asphalt pavement, concrete barriers, and drainage</b> . Ms. Garlington consulted regularly with the <b>LADOTD's Consultant Project Engineer performing CE&amp;I Services</b> on several Geotechnical issues that arose regarding cofferdam stability, Pile driving and acceptance criteria, changed site conditions, drilled shaft installation issues and slope stability issues. She reviewed cofferdam stability calculations, shop drawings and field installation plans for the cofferdam piles – pier drilled shafts and railroad bridge pile foundations.
<b>11/09 – 09/14</b>	<b>LADOTD – District 08 Construction Coordinator and Laboratory Engineer – 34 Projects in the District -</b> Ms. Garlington attended all preconstruction meetings for District 08, provided sampling plans and documentation of IA Testing of Materials required by FHWA. She supervised the district laboratory which provided materials testing for quality assurance of all materials utilized on District 08 projects. Ms. Garlington interacted with <b>PE's and Area Engineers</b> to resolve issues regarding failing materials and their use or removal on the projects. She <b>implemented the Department's Site Manager Materials software for quality assurance on several projects.</b>
<b>10/05 - 10/06</b>	<b>LADOTD – I-10 Twin Spans Replacement after Hurricane Katrina:</b> Ms. Garlington <b>served as Administrator</b> of the Pavement and Geotechnical Section working with Consultant Geotechnical Exploration and Design Consultants to provide the pile foundations for the new I-10 Twin Spans structures. Work consisted of obtaining deep borings and Cone Penetrometer soundings followed by accelerated design of the pile foundations, developing a load test program, and analyzing field driving data during the installation of the footing piles. Field monitoring with Department's Pile Driving Analyzer (PDA) was also incorporated to expedite approval of the pile foundations. Ms. Garlington reviewed pile installation plans, pile driving log data, field reports, GRLWEAP wave equation analysis, CAPWAP Pile capacity results and approved Consultant recommendations to accept footing piles.
<b>04/01 – 11/09</b>	<b>LADOTD - Administrator of the Pavement and Geotechnical Section – As Administrator,</b> Ms. Garlington managed the Section that designed most <b>bridge structures</b> let by LADOTD during this time. Items included <b>geotechnical</b> foundations, embankment slopes, walls, and pavements. She led the team that wrote the 2008 LSSRB Section 804 for piles and 814 for drilled shaft. This incorporated using PDA/GRLWEAP/CAPWAP analysis to approve hammers and pile installation plans and provided the process for approving piles in the field based on inspector's <b>charts</b> . Ms. Garlington and the staff were involved in the initial stages of bridge foundation construction during the load testing and quality assurance of piles and drilled shafts. Ms. Garlington analyzed test and monitor pile data and recommended acceptance criteria for field personnel. All statewide construction issues with pile driving or drilled shafts were directed to this Section during this time. Ms. Garlington consulted on statewide bridge projects with Project Engineers and Headquarters Construction personnel when acceptance criteria were not met during installation. Ms. Garlington provided recommendations for remedial actions to the PE's.

Prime consultant name: *ECM Consultants, Inc.*

**16. Staff Experience:**

Résumés shall be provided for all prime and sub-consultant personnel listed in Sections 14 and/or 15 of the proposal. Résumés of personnel not identified in Section 14 or Section 15 of the proposal should not be included and will not be evaluated. Résumés should be limited to 2 pages per person. Any certificates required by the advertisement are to be placed in Section 20.

Firm employed by <b>ECM Consultants, Inc.</b>				
Name	<b>Blake Guidry, P.E.</b>		Years of relevant experience with this employer	<b>3</b>
Title	<b>Project Engineer</b>		Years of relevant experience with other employer(s)	<b>7</b>
Degree(s) / Years / Specialization			<b>B.S. / 2012 / Civil Engineering</b>	
Active registration number / state / expiration date			<b>PE 41362 / LA / 03-2023</b>	
Year registered	<b>2017</b>	Discipline	<b>Civil Engineering</b>	
Contract role(s) / brief description of responsibilities			Mr. Guidry will serve as Project Engineer. <b>He meets MPR No. 3</b>	
Experience dates (mm/yy–mm/yy)	Experience and qualifications relevant to the proposed contract; <i>i.e.</i> , “designed drainage”, “designed girders”, “designed intersection”, etc. Experience dates should cover the time specified in the applicable MPR(s).			
04/14 – 04/15	<b>S.P. No. H.010638: Widening of River Road (Government St – Centerville St)</b> : Mr. Guidry served as an <b>Assistant Project Engineer</b> for this construction Engineering and inspection ( <b>CE&amp;I</b> ) <b>project</b> involving the widening, patching, and overlay on River Road in Denham Springs in Livingston Parish. His was the point of contact for the LADOTD Project coordinator and the City of Denham Springs, the client. He coordinated with the contractor for scheduling and assigning DOTD staff inspectors on the job and to notify the local public for lane closures. His responsibilities for included overseeing the inspectors, preparing change orders, monthly pay estimates, coordination with all utility entities, document management and compiled the Form 2059, final closeout documentation for final acceptance.			
08/19 – 05/20	<b>S.P. No. H.006531: Roundabout at Girard Park and Hospital Dr:</b> Mr. Guidry served as <b>Project Engineer</b> for this construction Engineering and inspection ( <b>CE&amp;I</b> ) <b>project</b> involving the construction of a portland cement concrete pavement (PCCP) roundabout at the formerly four-way stop at Girard Park Drive and Hospital Drive. Work activities also included the installation of drainage pipe and erection of a structural retaining wall, signing, and striping. Mr. Guidry acted as the contact for the client, Lafayette Consolidated Government, and the LADOTD Project Coordinator. His responsible included overseeing inspections, reviewing contractor pay requests, preparing change orders, document management, entering data in <b>SiteManager</b> , and project closeout documentation for final acceptance, including the 2059.			

Prime consultant name: *ECM Consultants, Inc.*



08/19-10/20	<b>S.P. No. 009250 I-10: Highland to LA 73</b> Design-Build Project, <b>LADOTD, East Baton Rouge/Ascension Parish, LA.</b> Mr. Guidry served as <b>Assistant Project Engineer</b> for <b>Construction Quality Assurance (CQA) services</b> for this \$72 million highway construction project to widen I-10 from four to six lanes in both east and westbound directions including adding deceleration and acceleration lanes at the Highland Road and LA 73 interchanges. Work included unclassified excavations, embankment, base course, PCC roadway paving, concrete guard rails, striping, drainage, roadway lighting replacement, and bridge modifications at seven locations. He assisted Project Engineer and prepared close out documents including final estimate and 2059
08/15-12/16	<b>H.011668 Essen Lane Bridge Widening</b> Mr. Guidry served as <b>DOTD Assistant Project Engineer</b> for this construction Engineering & inspection ( <b>CE&amp;I</b> ) <b>project</b> . In addition to widening of the deck, work also included addition of an additional travel lane on northbound Essen Lane, new signalized intersections, <b>new ADA ramps at all driveways and intersections</b> and additional drainage capacity. His responsibilities included coordination for utility relocations, attend weekly public relation meetings, attend progress meetings, review monthly pay estimates, review RFIs, prepare plan changes, coordination with Kansas City Railroad and the contractor and prepare final close out documents for acceptance including 2059.
10/17-07/19	<b>S.P. No. H.011295: LA. 73 : (Government Street - East Blvd - Lobdell), LADOTD, East Baton Rouge Parish, LA</b> Mr. Guidry served as <b>DOTD Project Engineer</b> for this Road Transfer project. In addition to overseeing <b>CE&amp;I project</b> , he was also involved in Public Outreach, working with City officials and Public Meetings to assist the District Administrator. Work included several phases where traffic lanes were adjusted to allow for the completion of the project section by section. The project included <b>rehabilitating the existing pavement</b> and implementing a “road diet” and access management to <b>incorporate bicycle and pedestrian friendly concepts and safety improvements</b> including a roundabout installation at the intersection of Lobdell and Government Street His duties included project coordination, attending progress meetings, document management, data entry in <b>SiteManager</b> , manage RFIs, review plan change requests, review monthly pay estimates, prepare plan changes, and keeping concise record of all documents.
01/17-07/19	<b>Widening of River Road ( Florida to Phlox) Multi-use Path , East Baton Rouge Parish, LA:</b> This Construction Engineering and Inspection ( <b>CE&amp;I</b> ) <b>project</b> was a part of the road transfer agreement between LADOTD and the City of Baton Rouge that incorporated the road diet technique to construct a multi-use path, <b>ADA accessible ramps and crosswalks, and rehabilitating the roadway</b> on River Road (US-61X). Mr. Guidry served as the <b>Project Engineer</b> and was responsible for overseeing contract administration, inspection, and coordinating with the City of Baton Rouge to ensure an acceptance and transfer between the two entities.

Prime consultant name: *ECM Consultants, Inc.*



**16. Staff Experience:**

Résumés shall be provided for all prime and sub-consultant personnel listed in Sections 14 and/or 15 of the proposal. Résumés of personnel not identified in Section 14 or Section 15 of the proposal should not be included and will not be evaluated. Résumés should be limited to 2 pages per person. Any certificates required by the advertisement are to be placed in Section 20.

Firm employed by <b>ECM Consultants, Inc.</b>			
Name	<b>Zachary Collier, P.E.</b>	Years of relevant experience with this employer	<b>2</b>
Title	<b>Project Engineer</b>	Years of relevant experience with other employer(s)	<b>5</b>
Degree(s) / Years / Specialization		<b>B.S. /2014/ Civil Engineering</b>	
Active registration number / state / expiration date		<b>#42957/LA/ 3/31/2023</b>	
Year registered	<b>2018</b>	Discipline	<b>Civil Engineering</b>
Contract role(s) / brief description of responsibilities		Mr. Collier will serve as Project Engineer for this contract. <b>He meets MPR No. 4</b>	
Experience dates (mm/yy–mm/yy)	Experience and qualifications relevant to the proposed contract, <i>i.e.</i> , “designed drainage”, “designed girders”, “designed intersection”, etc. Experience dates should cover the time specified in the applicable MPR(s).		
04/19-11/19	<b>S.P. No. H.009282 St. John the Baptist Parish Sidewalks, St. John the Baptist Parish, LA:</b> Mr. Collier served as Project Engineer for this sidewalk and bike path project which is part of <b>the LA DOTD Safe Routes to School Program</b> . Work on this project included installation of sidewalks and handicapped curb ramps to provide safe pedestrian facilities for East St. John Preparatory Academy and the surrounding neighborhood. This project also completed a multi-use path which connects LaPlace Elementary School with the surrounding neighborhood		
06/19-02/20	<b>S.P. No. H.012236 North Kenner Pedestrian Safety Improvements, Jefferson Parish, LA:</b> Mr. Collier served as Project Engineer for this sidewalk project which is <b>part LA DOTD Safe Routes to School Program</b> . This project includes ADA compliant pedestrian facilities		
04/19-06/20	<b>S.P. No. H.006546 Intersection Upgrade N Canal &amp; 7<sup>th</sup> St., Lafourche Parish, LA:</b> Mr. Collier served as Project Engineer for this safety project which is part LA DOTD Safe Routes to Public Places Program. Work on this project included installation of new turn lanes, traffic signals, sidewalks, and handicapped curb ramps. The project also included installation of new drainage pipes and structures and milling and overlay.		
04/19-11/19	<b>S.P. No. H.012479 – Audubon Avenue and Ardoyne Drive, Mini-Roundabout, Lafourche Parish, LA:</b> Mr. Collier served as <b>Project Engineer</b> and provided CE&I services for this roundabout project which is part LA DOTD Safe Routes to School Program		

07/20- on going	<b>Severn Avenue Reconstruction: Veterans to W. Esplanade, Jefferson Parish, LA:</b> Mr. Collier served as the <b>Project Engineer</b> for this <b>\$12 million</b> complete street construction project. This project includes PCC paving, major drainage improvements, <b>ADA facilities, the addition of dedicated bike lanes</b> , addition of turn lanes, traffic and pedestrian signals, street lighting and landscaping etc. He is providing <b>CE&amp;I services</b> that includes project coordination, managing inspection services, data entry in <b>SiteManager</b> , manage RFIs and submittals, review monthly pay estimates, and keep concise record of all documents in chronological order so that project closeout documentation will be completed timely for final acceptance.
09/19-5/20	<b>S.P. No. H.010109 Raceland and Bayou Blue Sidewalks, Lafourche Parish, LA:</b> Mr. Collier served as Project Engineer for this <b>\$1.05 M</b> sidewalk and drainage project that included nearly 3000 feet of new drainage and 2 mile of sidewalks which included ADA compliant pedestrian facilities
10/17–10/18	<b>Essen Lane Widening, LADOTD, S.P. No. H.010560, East Baton Rouge Parish, LA:</b> Mr. Collier served on the Project Engineering team for this <b>\$8 million roadway</b> widening project. Work included adding an additional travel lane on northbound Essen Lane, new signalized intersections, new ADA ramps at all driveways and intersections, and additional drainage capacity. He provided <b>contract administration</b> support that included project coordination, managing inspection services, data entry in <b>SiteManager</b> , manage RFIs and submittals, review monthly pay estimates, and keep concise record of all documents in chronological order.
10/17–10/18	<b>S.P. No. H.011295 – Government Street Rehabilitation, East Baton Rouge Parish, LA:</b> Mr. Collier served on the Project Engineering team for this <b>\$12 million</b> project which consists of rehabilitating the <b>sidewalks, driveways, and pavement on Government Street to add a bike lane and to create a more pedestrian friendly facility</b> . This project also includes a roundabout at Government Streets intersection with Lobdell Avenue. Mr. Collier's responsibilities included <b>contract administration</b> services for the project.
1/20-Ongoing	<b>S.P. No. H.004791, Belle Chasse Bridge and Tunnel Replacement, P3, Design-Build Project, Plaquemines Parish, LA.</b> Mr. Collier is serving as <b>Project Engineer for this \$162 million, P3 design-build</b> project to construct a new Mid-Level fixed span bridge that will span the Intracoastal Waterway on Louisiana Highway 23. The project will include the demolition of the existing Perez Bridge and Tunnel. The new bridge is being constructed to current clearance standards for marine vessels as required by the US Coast Guard. This work includes pile load testing, pile driving, installing prestressed concrete girders, steel girders, concrete deck, on grade roadway including earthwork, subbase and base, drainage, utilities relocation, PCC pavement, Asphaltic Concrete pavement, concrete barrier railing, roadway lighting, MSE Wall construction and striping. ECM's Quality Control team of engineers and LADOTD certified inspectors are responsible for sampling and testing to ensure compliance with the project.
07/19-01/20	<b>S.P. No. H.013084 Peltier Park Sidewalks, Lafourche Parish, LA:</b> Mr. Collier served as Project Engineer for this sidewalk project which is part LA DOTD Safe Routes to School Program. Work on this project included installation sidewalks, roadway crossings, and handicapped curb ramps to provide safe pedestrian facilities in Peltier Park and connection to nearby ED White Catholic School Nicolls State University.

**16. Staff Experience:**

Résumés shall be provided for all prime and sub-consultant personnel listed in Sections 14 and/or 15 of the proposal. Résumés of personnel not identified in Section 14 or Section 15 of the proposal should not be included and will not be evaluated. Résumés should be limited to 2 pages per person. Any certificates required by the advertisement are to be placed in Section 20.

Firm employed by <b>ECM Consultants, Inc.</b>			
Name	<b>Jules Saunee</b>		Years of relevant experience with this employer
Title	<b>Certified Lead Inspector</b>		Years of relevant experience with other employer(s)
Degree(s) / Years / Specialization		Bachelor of Science Construction Engineering Technology	
Active registration number / state / expiration date		NA	
Year registered		Discipline	NA
Contract role(s) / brief description of responsibilities		<b>Mr. Saunee will serve as a LADOTD certified Lead Inspector for this contract.</b> He is a LADOTD certified Embankment and Base Course Inspector; Asphalt Paving Inspector; PCC paving inspector; Structural Concrete Inspector and ATSSA Certified Flagger, Technician, Supervisor	
Experience dates (mm/yy–mm/yy)	Experience and qualifications relevant to the proposed contract, <i>i.e.</i> , “designed drainage”, “designed girders”, “designed intersection”, etc. Experience dates should cover the time specified in the applicable MPR(s).		
04/16-04/17	<b>Ormond Blvd Repair/Mill/Overlay:</b> Mr. Saunee served as the <b>Lead Inspector</b> for the <b>asphalt mill/overlay</b> of Ormond Blvd in St. Charles Parish at a cost of <b>\$1 Million</b> . He also assisted in the PCCP inspection of Ormond Blvd. and compiled monthly estimates for Project Engineer’s review		
06/11-08/11	<b>Jefferson Parish Submerged Roads Program:</b> Mr. Saunee served as the <b>lead inspector</b> for the Jefferson Parish <b>submerged roads program</b> in Old Metairie which provided PCCP panel replacements for roads that were damaged in Hurricane Katrina. Mr. Saunee oversaw the removal and replacement of all damaged panels in the contracts. This portion of the program was at a cost of <b>\$1.5 Million</b> . He prepared monthly estimates for Project Engineer’s review		
02/16-08/16	<b>Our Lady of The Lake Medical Complex:</b> Mr. Saunee served as the <b>lead inspector</b> for the <b>street/pedestrian ramp repair</b> around the Our Lady of the Lake Medical Complex. Mr. Saunee inspected the removal and replacement of cracked panels, the removal of existing pedestrian ramps and the replacement of said ramps with <b>ADA compliant ramps</b> , and the sealing of the minor cracks in concrete panels. Prepared monthly estimates for Project Engineer’s review		
12/10-05/12	<b>Huey P Long Bridge Widening:</b> Mr. Saunee served as one of the Inspector for the <b>\$1.2 Billion</b> widening of the Huey P Long Bridge in Jefferson Parish, LA. Project included erecting new railroad support structures, constructing a 3-lane bridge on both sides by widening the existing bridge. Work also included construction of major elevated bridge approaches and <b>PCC roadway</b> on both east and west banks. The existing asphaltic concrete Jefferson Highway on the East Bank was <b>repaved</b> , and a new PCC U S 90 Highway was constructed		

	on Westbank. Mr. Saunee served as the <b>lead Inspector PCC roadway, asphaltic concrete repaving</b> and infrastructure installation.
04/17-04/20	<b>I-10 Widening Breaux Bridge to Lafayette:</b> Mr. Saunee served as one of the inspectors for this <b>\$100 Million</b> Widening of I-10 for seven (7) miles between Breaux Bridge and Lafayette. The project included the construction of a 2-lane <b>asphaltic concrete</b> interstate, widening 5 existing bridges, replacing 1 bridge, and the removal/replacement of the existing 2-lane asphaltic concrete interstate in each direction. Mr. Saunee served as the <b>lead Inspector on Asphalt work</b> on the job involving approximately 300,00 tons of asphalt and all Electrical items. He also assisted Office and Project Engineers with monthly estimates and coordinated all <b>SiteManger</b> reports and final submittal package
04/20-09/21	<b>I-10 Loyola Interchange.</b> Mr. Saunee served as <b>one of the inspectors</b> for <b>\$125 Million Interstate Overpass</b> Exit/Entrance to the Louis Armstrong International Airport. The Project entails construction 2 new overpasses exiting and entering I-10 at Loyola Avenue in Kenner, LA. and the reconstruction of Loyola Avenue under the I-10. Mr. Saunee performed inspection of Prestressed Precast Concrete piles driving operation as well as frequently performed nighttime traffic safety inspections.
3/22 -Ongoing	<b>S.P. No. H.004791, Belle Chasse Bridge and Tunnel Replacement, P3, Design-Build Project, Plaquemines Parish, LA.</b> Mr. Saunee is serving as <b>DOTD certified Inspector</b> for this <b>\$162 million</b> , P3 design-build project to construct a new Mid-Level fixed span bridge that will span the Intracoastal Waterway on Louisiana Highway 23. The project scope includes the demolition of the existing Perez Bridge and Tunnel. The new bridge is being constructed to current clearance standards for marine vessels as required by the US Coast Guard. This work includes pile load testing, pile driving, installing prestressed concrete girders, steel girders, concrete deck, <b>on grade roadway</b> including earthwork, subbase and base, drainage, utilities relocation, <b>PCC pavement, Asphaltic Concrete pavement</b> , concrete barrier railing, roadway lighting, MSE Wall construction and striping.
05/12-05/14	<b>Sanitary Sewer Repair St. Bernard Parish:</b> Mr. Saunee served as an inspector for the Parish wide repair of sanitary sewer lines damaged by Hurricane Katrina at cost of <b>\$6 Million</b> . Mr. Saunee inspected the excavation and <b>point repairs</b> of sanitary sewer lines. Mr. Saunee oversaw the restoration of the roads, sidewalks and other features, <b>both PCCP and Asphalt</b> . He also inspected Pipe bursting operations when entire length of any sanitary sewer lines between the manholes was required to be replaced.
09/21- 03/22	<b>S.P. No. H.011752 Severn Ave: Veterans to W. Esplanade, Jefferson Parish, LA:</b> Mr. Saunee served as interim <b>DOTD certified Inspector</b> for this <b>\$12 million</b> complete street construction project. This project includes <b>PCC paving</b> , major drainage improvements, <b>ADA facilities, the addition of dedicated bike lanes</b> , addition of turn lanes, traffic and <b>pedestrian signals</b> , street lighting and landscaping etc. He was responsible for monitoring construction work to ascertain that all works are in conformance with contract plans and specification, kept record of quantities of work performed on daily basis and perform all work assigned by the Lead inspector.

**16. Staff Experience:**

Résumés shall be provided for all prime and sub-consultant personnel listed in Sections 14 and/or 15 of the proposal. Résumés of personnel not identified in Section 14 or Section 15 of the proposal should not be included and will not be evaluated. Résumés should be limited to 2 pages per person. Any certificates required by the advertisement are to be placed in Section 20.

Firm employed by <b>ECM Consultants, Inc.</b>				
Name	<b>David Waller</b>		Years of relevant experience with this employer	<b>10</b>
Title	<b>DOTD Certified Lead Inspector</b>		Years of relevant experience with other employer(s)	<b>15</b>
Degree(s) / Years / Specialization			High School Diploma.	
Active registration number / state / expiration date			NA	
Year registered		Discipline	NA	
Contract role(s) / brief description of responsibilities			<b>Mr. Waller will serve as a DOTD Certified Lead Inspector for this Contract.</b> He has the following certifications: LADOTD Certified Structural Concrete Inspector; Asphaltic Paving Inspector; Embankment and Base Course Inspector; and Portland Cement Concrete Paving Inspector; Work Zone Traffic Control Flagger/Technician/Supervisor	
Experience dates (mm/yy–mm/yy)	Experience and qualifications relevant to the proposed contract; <i>i.e.</i> , “designed drainage”, “designed girders”, “designed intersection”, etc. Experience dates should cover the time specified in the applicable MPR(s).			
03/09-08/11	<b>S.P. No. 817-41-0008: O’Neal Lane, LADOTD; Baton Rouge, LA:</b> Mr. Waller provided construction inspection services for this project that involved construction of three miles of new concrete cement roadway. The project included relocation of sewer and new tie-ins, drainage, and utilities relocation. He served as the primary construction inspector and safety person on site, prepared work reports, estimated quantities, ensured smooth and efficient operations of technician and/or consultant personnel, etc.			
06/18- 10/20	<b>S.P. No. 009250: I-10 Widening-Highland to LA 73 Design-Build Project, LADOTD, East Baton Rouge/Ascension Parish, LA:</b> Mr. Waller is serving as <b>Lead Inspector for this \$72 million CQA project</b> to widen I-10 from four to six lanes in both east and westbound directions, add deceleration and acceleration lanes at the Highland Road and LA 73 interchanges, roadway lighting replacement, and bridge modifications including replacing I-10 bridge over Highland Road, widening and rehabilitating I-10 bridge over Bayou Manchac, increasing the vertical clearance and rehabilitating LA 928 over I-10, and replacing I-10 over LA 73.			
02/08-08/10	<b>S.P. No. 817-08-0023: Joor Road; Baton Rouge, LA:</b> Mr. Waller provided construction inspection services for this project that involved the widening of Joor Road from two lanes to five lanes. The project included asphalt concrete paving, Portland concrete cement paving, drainage, sewer, and utility relocations. He served as the primary construction inspector and safety person on site, prepared work reports, estimated quantities, ensured smooth and efficient operations of technician and/or consultant personnel			

06/18 – 10/19	<b>S.P. H.012420.6 : I-110 Interchange Modifications @ Terrace, Baton Rouge, LADOTD:</b> Mr. Waller provided CE&I services for this \$8.80 million I-110 Terrace Ave Interchange Project that will provide connectivity from I-110 southbound to the existing I-10 eastbound at the Washington Street exit. The project consists of an exit ramp that was constructed on the left side of I-110 southbound allowing traffic to exit onto Terrace Ave. Nineteen (19) drill shafts was installed that included 6-24" shafts, 2-36" shafts, 2-48" shafts and 9-96" shafts ranging in length from 55' to 102'. Additionally, this project included a widening of the I-110 southbound roadway span, installation of new Hwy guide signage and camera equipment.
06/18 -07/19	<b>S.P. No. H.010661.6-2 : N. Flannery/Firewood/Cloverland Bridges, East Baton Rouge Parish, LA:</b> Mr. Waller is providing construction inspection services for the replacement of three bridges in East Baton Rouge Parish. He is responsible for inspecting contractors works and gathering totals on materials used, manpower and equipment and filling out a daily report.
02/14-09/16	<b>S.P. No. H. 0106059: Rafe Meyer Bridges in Baker, LA for LADOTD:</b> Mr. Waller provided construction inspection for this project involving demolition and construction of two off-system bridges for LADOTD in East Baton Rouge Parish. This project includes precast concrete pile driving, cast-in-place concrete bents, decks, approach slabs and asphaltic concrete roadway transition. He provided inspection for asphalt paving as a LADOTD certified inspector in addition to other inspection services.
02/10-04/11	<b>S.P. No. 737-99-1059: I-12 Ramp Meters; Baton Rouge, LA:</b> Mr. Waller provided construction inspection services for this project that involved the installation of ramp meters along I-12. He served as the primary construction inspector and safety person on site, prepared work reports and estimated quantities.
04/10-06/11	<b>S.P. No. 257-04-0025: West Lee and Burbank; Baton Rouge, LA:</b> Mr. Waller provided construction inspection services for this project that involved the construction of turn lanes at the intersection of West Lee and Burbank. The project included Portland concrete cement paving, drainage, sewer, and utility relocations. He served as the primary construction inspector and safety person on site, prepared work reports, estimated quantities, ensured smooth and efficient operations of technician and/or consultant personnel, etc.
08/11-12/13	<b>S.P. No. 255-30-0013: Wax Road; Baton Rouge, LA:</b> Mr. Waller provided construction inspection services for this project that involved the widening of Wax Road and the addition of turn lanes. The project included asphalt concrete paving, drainage, sewer, and utility relocations. He served as the primary inspector and safety person on site, prepared work reports, estimated quantities, ensured smooth and efficient operations of technician and/or consultant personnel, etc.

Prime consultant name: *ECM Consultants, Inc.*



**16. Staff Experience:**

Résumés shall be provided for all prime and sub-consultant personnel listed in Sections 14 and/or 15 of the proposal. Résumés of personnel not identified in Section 14 or Section 15 of the proposal should not be included and will not be evaluated. Résumés should be limited to 2 pages per person. Any certificates required by the advertisement are to be placed in Section 22.

Firm employed by <b>ECM Consultants, Inc.</b>			
Name	<b>Kim Martinez</b>		Years of relevant experience with this employer
Title	<b>Lead DOTD Certified Inspector</b>		Years of relevant experience with other employer(s)
Degree(s) / Years / Specialization		High School Diploma.	
Active registration number / state / expiration date		<b>N/A</b>	
Year registered	N/A	Discipline	<b>N/A</b>
Contract role(s) / brief description of responsibilities		<b>Ms. Martinez will serve as a Certified Lead Inspector for this contract.</b> Ms. Martinez has <b>41 years of experience</b> in performing construction inspection of roads and bridges, drainage and utilities construction projects. She is a certified LADOTD Asphalt and PCC Paving Inspector; Embankment and Base Course Inspector, ATSSA Work Zone Traffic Control Flagger, Technician & Supervisor, Nighttime Traffic Control and OSHA 10. She is highly proficient in documenting daily activities in <b>Site Manager</b> data base.	
Experience dates (mm/yy–mm/yy)	Experience and qualifications relevant to the proposed contract, i.e., “designed drainage”, “designed girders”, “designed intersection”, etc. Experience dates should cover the time specified in the applicable MPR(s).		
02/18-0/18	<b>S.P. No. 009250 I-10: Highland to LA 73 Design-Build Project, LADOTD, East Baton Rouge/Ascension Parish, LA.</b> Ms. Martinez is serving as <b>Construction Inspector</b> for this <b>\$72 million design-build project</b> to widen I-10 from four to six lanes in both east and westbound directions, add deceleration and acceleration lanes at the Highland Road and LA 73 interchanges, <b>roadway</b> lighting replacement, and <b>bridge</b> modifications including replacing I-10 <b>bridge</b> over Highland Road, widening and rehabilitating I-10 <b>bridge</b> over Bayou Manchac, increasing the vertical clearance and rehabilitating LA 928 over I-10, and replacing I-10 over LA 73.		
05/20 - Ongoing	<b>Severn Avenue Corridor Improvement, Jefferson parish-DPW, Jefferson, LA;</b> Ms. Martinez is serving as the <b>Lead Construction Inspector</b> on the project. Scope of project include removal and replacement of existing PCC pavement with <b>new PCC pavement</b> , sidewalks with 8’ wide brick paver sidewalks, ADA compliant ramps, striping, crosswalks at intersections, driveway aprons, corridor improvements to facilitate new bike lane, addition of Turn lane at 17 <sup>th</sup> street and West Esplanade, replacement and upgrade of subsurface drainage system, streetscaping, new bike path., new decorative <b>street lighting</b> , pedestrian lighting and pedestrian signals		
11/16—5/19	<b>S.P. No. H.007259: Fleur De Lis Drive Reconstruction (30th-Old Hammond Hwy), (CE&amp;I) LADOTD; Orleans Parish, LA:</b> Ms. Martinez is providing <b>construction inspection</b> services as <b>Lead Inspector</b> for this <b>\$12 million roadway reconstruction</b> of Fleur de Lis Drive, a main artery in a residential corridor. The project includes grading, drainage, drainage structures and utilities, class II base course, superpave asphaltic concrete pavement, Portland cement concrete pavement, as well as ADA accessible ramps, sidewalks, curb and gutter, driveways and removal/replacement of sewer force mains		

	and water mains. Ms. Martinez provides oversight of contractors' operations, provides daily documentation in Site Manager, prepares field changes and records change orders, and assists in coordinating testing/sampling.
06/16-11/17	<b>DPW No. 2000-B01: Gravier St. (S. Galvez to Broad St) City of New Orleans-DPW, LA:</b> Ms. Martinez provided inspection services as <b>Lead Inspector</b> for this <b>\$5.8 million roadway</b> reconstruction project involving <b>roadway</b> removal, new subsurface drainage, 20" waterline, sewer lines, PCC roadways pavement, concrete sidewalks and driveways. She served as the primary construction inspector on site, monitored, prepared daily reports, computed quantities of work items, reviews monthly pay estimates and coordinates with Project Engineer and contractor.
10/18 – 03/20	<b>Taft Place Reconstruction – City Park Neighborhood – Group A FEMA Funded Roadway Capital Improvements Program, New Orleans, LA:</b> Ms. Martinez provided construction inspection as <b>Lead Inspector</b> for this <b>\$2.3 million</b> Taft street reconstruction project which is a part of the City Park neighborhood roadway improvement program. The project scope included removal and reconstruction of 800 and 900 blocks of Taft Place including the intersections at Dumaine street, Allard Blvd., Dumaine and St John Court and other street intersections. Work for roadway reconstruction included PCC paving, roadway intersections with handicap ramps conforming to current ADA standards, new sidewalk, driveways and subsurface drainage system.
07/10-08/11	<b>Terrebonne Parish Turn Lanes, Terrebonne Parish, LA:</b> Ms. Martinez provided construction inspection for this project that involved widen of existing roadways and add new turn lanes at ten intersections across Houma. The project was undertaken by LADOTD under the Urban System Roadway Improvement Program. Project scope included excavations for roadway widening for turn lanes and intersections, class II base course, asphaltic concrete paving, PCC paving, striping and pavement marking, installing drainage structures and utilities relocation
02/07-06/08	<b>S.P. No. 742-55-0004: Westside Blvd Road Extension (Marie Dr to St. Louis Canal); LADOTD, Terrebonne Parish, LA:</b> Ms. Martinez provided <b>inspection services</b> for this <b>\$2.8 million roadway</b> project involving construction of new PCC pavement <b>roadway</b> for extension of the existing Westside Blvd from Marie Dr to St. Louis Canal. Scope of work included new drainage system, utilities, unclassified excavation, grading, lime treatment, class II base course, PCC Pavement, Superpave asphaltic concrete shoulders, and associated items. She provided inspection services for compliance with contract documents, documentation and daily reports, reviewed pay estimates, monitored contractor activities and coordinated with the Project Engineer
12/10-08/13	<b>S.P. No. 742-52-0012: I-10 SW Frontage Road Extension, (CE&amp;I), LADOTD; Slidell, LA:</b> Ms. Martinez provided <b>inspection services</b> for <b>\$3 million new road and bridge</b> construction of 0.988 miles of I-10 SW Frontage Rd extension and accompanying <b>7-span bridge</b> . Scope of work for the <b>roadway</b> included grading and earthwork, lime treatment, base course, PCC paving, pavement markings, and permanent signing. Scope also included driving concrete piles, cast-in-place concrete deck, concrete wing walls, PCC approach slabs, guardrails, and striping. She prepared daily reports, reviewed pay estimates, monitored contractor activities and coordinated with the Project Engineer.
01/12-06/13	<b>S.P. No. 742-38-0006: F. Edward Hebert Boulevard Improvements, (CE&amp;I), LADOTD; Belle Chasse, LA:</b> Ms. Martinez provided <b>construction inspection services</b> for this project, which includes new concrete <b>roadway</b> , overlaying asphalt roadway, excavation, embankment, grading, class II base course, drainage, and utilities. She provided inspection services, documentation and prepared daily reports, monitored contractor activities, reviewed pay estimates and coordinated with Project Engineer and contractors.

**16. Staff Experience:**

Résumés shall be provided for all prime and sub-consultant personnel listed in Sections 14 and/or 15 of the proposal. Résumés of personnel not identified in Section 14 or Section 15 of the proposal should not be included and will not be evaluated. Résumés should be limited to 2 pages per person. Any certificates required by the advertisement are to be placed in Section 20.

Firm employed by <b>ECM Consultants, Inc.</b>				
Name	<b>Glenn Eggert</b>		Years of relevant experience with this employer	<b>8</b>
Title	<b>Lead DOTD Certified Inspector</b>		Years of relevant experience with other employer(s)	<b>16</b>
Degree(s) / Years / Specialization			High School Diploma	
Active registration number / state / expiration date			NA	
Year registered		Discipline	NA	
Contract role(s) / brief description of responsibilities			<b>Mr. Eggert will serve as a DOTD Certified Lead Inspector for this Contract.</b> He has the following certifications: DOTD Certified: Structural Concrete Inspector; PCC Paving Inspector and Asphalt Paving Inspector; Work Zone Traffic Control Flagger, Technician, Supervisor.	
Experience dates (mm/yy–mm/yy)	Experience and qualifications relevant to the proposed contract; <i>i.e.</i> , “designed drainage”, “designed girders”, “designed intersection”, etc. Experience dates should cover the time specified in the applicable MPR(s).			
04/13 -05/18	<b>Roadway Restoration Specialist, City of Baton Rouge/Parish of East Baton Rouge:</b> Mr. Eggert has been providing road restoration inspection and quality assurance inspection for all road restoration activities involved in the SSO program. The Program has approximately <b>80 individual construction projects requiring roadway work within City/Parish and LA DOTD ROWs</b> . The road restoration work has included base course, roadway surfacing with asphalt overlay and/or PCC pavement, curbs and gutters, drainage structures, sidewalks, striping and markings			
05/18 -05/20	<b>I-110 Interchange Modifications @ Terrace, Baton Rouge, LA:</b> Mr. Eggert provided construction inspection services for this <b>\$8.80 million</b> I-110 Terrace Ave Interchange Project that will provide connectivity from I-110 southbound to the existing I-10 eastbound at the Washington Street exit. The project consists of an exit ramp that was constructed on the left side of I-110 southbound allowing traffic to exit onto Terrace Ave. Nineteen (19) drill shafts were installed that consisted of 6-24” shafts, 2-36” shafts, 2-48” shafts and 9-96” shafts ranging in length from 55’ to 102’. Additionally, this project also included widening of the I-110 southbound roadway span, installation of new Hwy signage and the installation of poles with new camera equipment for ITS system.			
05/19- On going	<b>Pecue Lane/I-10 Interchange Phase II: Bridges Over I-10, East Baton Rouge Parish, LA:</b> Mr. Eggard serves as the <b>Lead Inspector</b> for this <b>\$14.6 million</b> construction project which includes two new multi-lane bridges over I-10 in Baton Rouge which will form the center of one of the state’s first diverging diamond interchanges.			

Prime consultant name: *ECM Consultants, Inc.*

	He is providing <b>inspection services</b> that includes daily monitoring construction activities for compliance with plans and specifications, preparing daily diary, keeping track o daily work item quantities, attending progress meetings, Maintaining all construction field records, review plan change requests, review monthly pay estimates.
03/09-02/11	<b>Roadway Restoration for Sewer Rehabilitation Projects, New Orleans, LA:</b> Mr. Eggert provided inspection services on <b>several roadway restorations</b> for sewer rehabilitation projects throughout New Orleans. This included Gentilly, French Quarter, Lakefront, and the New Orleans East sewer rehabilitation projects. Work included demolition of the existing roadway, excavation, repair of sewer lines, backfilling of the excavations, and the placing of new <b>PCC and/or asphalt paving for roadways</b> . He also conducted compaction tests on the backfill material, made cylinders for concrete testing
06/09-02/11	<b>West Esplanade Bridge Crossing Elmwood Canal for USACE, in Jefferson Parish, LA:</b> Mr. Eggert provided inspection services for field testing, materials sampling & testing and inspection for the bridge involving pile load tests, pile driving, soil classifications, moisture tests, compaction tests and structural concrete inspections.
04/07-10/08	<b>Leon C. Simon Bridge for U.S. Army Corps of Engineers- New Orleans District, New Orleans, LA:</b> Mr. Eggert provided construction inspection for this bridge project. He performed structural concrete inspections, pile load tests, piling driving inspections, soil classifications, moisture tests, compaction tests, and field inspections for these projects.
01/06-03/09	<b>17<sup>th</sup> Street Bridge Construction under SELA Program, U.S. Army Corps of Engineers, New Orleans District:</b> Mr. Eggert provided construction inspection for 17th Street Canal Bridge. He conducted structural concrete inspections, pile load tests, pile driving inspections and performed sampling and testing for concrete, soil moisture and field compaction tests for roadway base.
03/09-02/11	<b>Roadway Restoration in connection with Sewer Rehabilitation Projects, New Orleans, LA:</b> Mr. Eggert provided inspection services on several roadway restorations for sewer rehabilitation projects throughout New Orleans. This included Gentilly, French Quarter, Lakefront, and the New Orleans East sewer rehabilitation projects. Work included demolition of the existing roadway, excavation, repair of sewer lines, backfilling of the excavations, and the placing of new PCC and/or asphalt paving for roadways. He also conducted compaction tests on the backfill material, made cylinders for concrete testing.
09/10-02/12	<b>Highland Road – Burbank Drive Sewer Area Upgrades, City of Baton Rouge/Parish of East Baton Rouge, LA:</b> Mr. Eggert served field inspector for this project that includes the upsizing of force mains in an area that extends north to the intersection of Jefferson Highway and Tiger Bend Road and continues south to the Staring Lane extension and Burbank Drive intersection. The scope of work included roadway restoration after installation of force mains including sand subbase, aggregate base course and PCC and/or asphalt pavement.

Prime consultant name: *ECM Consultants, Inc.*

**16. Staff Experience:**

Résumés shall be provided for all prime and sub-consultant personnel listed in Sections 14 and/or 15 of the proposal. Résumés of personnel not identified in Section 14 or Section 15 of the proposal should not be included and will not be evaluated. Résumés should be limited to 2 pages per person. Any certificates required by the advertisement are to be placed in Section 20.

Firm employed by <b>ECM Consultants, Inc.</b>				
Name	<b>Mansoor Bajwa, E.I.</b>		Years of relevant experience with this employer	<b>7</b>
Title	<b>DOTD Certified Inspector</b>		Years of relevant experience with other employer(s)	<b>20</b>
Degree(s) / Years / Specialization			<b>B.S / 1978 / Civil Engineering</b>	
Active registration number / state / expiration date			<b>41304 / MD / Does not expire</b>	
Year registered	<b>2012</b>	Discipline	<b>Civil Engineering</b>	
Contract role(s) / brief description of responsibilities			<b>Mr. Bajwa will serve as a DOTD certified Inspector for this contract.</b> He has the following certifications: DOTD Structural Concrete Inspector; DOTD Asphaltic Concrete Paving Inspector; and PCC pavement Inspector and ATSSA Work Zone Traffic Control Flagger, Technician, Supervisor	
Experience dates (mm/yy–mm/yy)	Experience and qualifications relevant to the proposed contract; <i>i.e.</i> , “designed drainage”, “designed girders”, “designed intersection”, etc. Experience dates should cover the time specified in the applicable MPR(s).			
09 /20- on going	<b>S.P. No. H.011752 Severn Ave: Veterans to W. Esplanade, Jefferson Parish, LA:</b> Mr. Bajwa serves as the <b>DOTD certified Inspector</b> for this <b>\$12 million</b> complete street construction project. This project includes PCC paving, major drainage improvements, <b>ADA facilities, the addition of dedicated bike lanes</b> , addition of turn lanes, traffic and <b>pedestrian signals</b> , street lighting and landscaping etc. He is responsible for monitoring construction work to ascertain that all works are in conformance with contract plans and specification, keep record of quantities of work performed on daily basis and perform all work assigned by the Lead inspector.			
08/11-02/12	<b>Reconstruction of Holiday Drive, City of New Orleans-DPW No. 086, New Orleans, LA:</b> Mr. Bajwa served as Construction Inspector for the reconstruction of Holiday Drive <b>with asphaltic concrete paving</b> . He monitored ongoing work for compliance with approved specifications, plans, and standards. He measured and calculated quantities of work done for different items; monitored contractor's progress as compared to approved schedule and prepared progress reports; reviewed change order requests; and prepared as-built plans.			
04/12-07/13	<b>Submerged Roads, Phase B, LADOTD, New Orleans, LA</b> Mr. Bajwa served as Senior Construction Inspector for this project, providing inspection of <b>asphaltic concrete pavement, PCC pavement, patching, ADA compliant ramps, and pavement markings</b> . Duties included monitoring ongoing work being performed by the contractor for compliance with approved plans, specifications, and standards. He calculated quantities of work			

Prime consultant name: **ECM Consultants, Inc.**



	done and recorded in Daily Reports. Mr. Bajwa also performed field acceptance testing and sampling of materials to implement LADOTD Sampling Plan for QA of all work items included in the project.
02/18 -05/20	<b>N. Flannery/Firewood/Cloverland Bridges, LADOTD, East Baton Rouge Parish, LA:</b> Mr. Bajwa served as lead construction inspector for this project that involves the complete replacement of the N. Flannery, Firewood and Cloverland bridges. The project includes the removal of existing bridge structures, construction of new bridge substructure & superstructure components, adjacent <b>embankments and roadway</b> . Mr. Bajwa provided quality assurance inspection services monitoring construction activities for conformance with contract documents, preparing daily diary, maintaining work quantity records, reviewing pay estimates, coordinating testing services and maintaining all documents.
01/16-10/17	<b>Rafe Meyer Bridges Reconstruction, LADOTD, Baker, LA:</b> Mr. Bajwa provided construction inspection for this project involving demolition and construction of two off-system bridges for LADOTD in East Baton Rouge Parish. The project included precast concrete pile driving, cast-in-place concrete bents, decks, approach slabs, safety rails and <b>asphaltic concrete roadway transition</b> . He was responsible for quality assurance inspection services monitoring construction activities for conformance with contract documents, preparing daily diary, maintaining work quantity records, reviewing pay estimates, coordinating testing services and maintaining all documents.
09/15-02/16	<b>SSO Program, City of Baton Rouge/East Baton Rouge Parish DPW, Baton Rouge, LA:</b> Mr. Bajwa provided construction inspection for projects under the \$900 million Sanitary Sewer Overflow Program. The scope of work for these projects consisted of construction and/or rehabilitation of gravity sewers, force mains, wastewater pump stations, wastewater treatment plant facilities and <b>roadway restorations</b> . Mr. Bajwa's responsibilities included inspection of <b>asphalt overlays and road repair</b> and subsurface drainage associated with the projects.
12/13-10/14	<b>P2P- Baronne, Burgundy and South Peters Streets:</b> Mr. Bajwa served as Senior Construction Inspector for this project. Project scope included asphaltic concrete pavement, PCC pavement, patching, <b>ADA compliant ramps, and pavement markings</b> .
08/12-12/13	<b>French Quarter Street Overlay, LADOTD, New Orleans, LA:</b> Mr. Bajwa served as Senior Construction Inspector for this project and provided inspection of <b>asphaltic concrete pavement, PCC pavement</b> , utility structure adjustments, <b>ADA compliant ramps, and pavement markings</b> . His duties included monitoring ongoing work being performed by the contractor for compliance with approved specifications, plans, standards and relevant regulations. He measured and calculated quantities of work done and recorded when the work was complete in Daily Reports. Mr. Bajwa also performed field acceptance testing and sampling of materials to implement the Sampling Plan of LADOTD for Quality Assurance for all items of work included in this project.

Prime consultant name: *ECM Consultants, Inc.*



**16. Staff Experience:**

Résumés shall be provided for all prime and sub-consultant personnel listed in Sections 14 and/or 15 of the proposal. Résumés of personnel not identified in Section 14 or Section 15 of the proposal should not be included and will not be evaluated. Résumés should be limited to 2 pages per person. Any certificates required by the advertisement are to be placed in Section 20.

Firm employed by <b>ECM Consultants, Inc.</b>				
Name	<b>Tia Youngblood</b>		Years of relevant experience with this employer	<b>1</b>
Title	<b>DOTD Certified Inspector</b>		Years of relevant experience with other employer(s)	<b>2</b>
Degree(s) / Years / Specialization		Bachelor's Degree Industrial Engineering Technology from Northwestern State University		
Active registration number / state / expiration date		NA		
Year registered		Discipline	NA	
Contract role(s) / brief description of responsibilities		<b>Ms. Youngblood will serve as a DOTD Certified Construction Inspector for this contract.</b> She has the following certifications: ; DOTD Embankment and Base Course, Asphalt Paving, PCC Paving, Structural Concrete, Authorized concrete Field Tester, Nuclear Device Operator, DOTD Certified IRI Inspector and ATSSA Traffic Control Flagger/Technician/Supervisor		
Experience dates (mm/yy–mm/yy)	Experience and qualifications relevant to the proposed contract; <i>i.e.</i> , “designed drainage”, “designed girders”, “designed intersection”, etc. Experience dates should cover the time specified in the applicable MPR(s).			
06/20-Present	<b>I-20 Interchange IMP &amp; BAFB Access Road- Design-Build, LADOTD, Bossier Parish, LA.</b> Ms. Youngblood is serving as a DOTD Certified Inspector for <b>this \$77 million</b> as a part of ECM's CQCM services for this project to construct a new I-220 extension South of I-20 that will provide access to Barksdale Air Force Base, adding access ramps and enhancing capacity at the I-20/220 interchange. This work includes pile driving, drilled shafts, installing prestressed concrete girders, steel girders, <b>on grade roadway</b> including earthwork, subbase and base, drainage, utilities relocation, PCC pavement, Asphaltic Concrete pavement. Ms. Youngblood is assisting inspection in multiple areas: Embankment, <b>PCC and Asphaltic Concrete pavement</b> .			
07/18-09/18	<b>I-49 Pavement Marking Replacement IV:</b> Ms. Youngblood monitored the removal and replacement of all <b>pavement markings; also, the reflectivity tests on striping</b> . She also was involved in checking traffic control devices installation conforming to MUTCD. This was a moving operation on an multi lane Interstate.			
04/19-08/19	<b>LA 1226 &amp; LA 1227: Project included Lime treated subbase, Cement treat Base, Drainage system replacement, and asphalt wearing/surface course.</b> Ms. Youngblood assisted in supervising all construction areas: the replacement of all drainage systems, layout and testing of all subbase and base course, and laying of asphalt concrete. Training for her DOTD IRI, Embankment and Base Course, Asphalt Paving, and Nuclear Device; Certifications.			
10/19-03/20	<b>LA 153: JCT LA 9 to Five Forks Road:</b> Ms. Youngblood inspected all aspects of this DOTD project. Project scope included Lime treated subbase, Cement treat Base, subsurface Drainage system replacement, asphalt overlay, and asphalt wearing/surface course striping and pavement marking.			

**16. Staff Experience:**

Résumés shall be provided for all prime and sub-consultant personnel listed in Sections 14 and/or 15 of the proposal. Résumés of personnel not identified in Section 14 or Section 15 of the proposal should not be included and will not be evaluated. Résumés should be limited to 2 pages per person. Any certificates required by the advertisement are to be placed in Section 20.

Firm employed by ECM Consultants, Inc.			
Name	<b>Mark Sanchez</b>		Years of relevant experience with this employer
Title	<b>DOTD Certified Inspector</b>		Years of relevant experience with other employer(s)
Degree(s) / Years / Specialization			
Active registration number / state / expiration date			
Year registered		Discipline	
Contract role(s) / brief description of responsibilities		<b>Mr. Sanchez will serve as a DOTD Certified Inspector for this contract.</b> He has the following certifications: LADOTD Asphalt Paving Technician; LADOTD Asphalt Plant Inspector/Technician; Work Zone Traffic Control Technician/Supervisor and Flagger	
Experience dates (mm/yy–mm/yy)	Experience and qualifications relevant to the proposed contract; <i>i.e.</i> , “designed drainage”, “designed girders”, “designed intersection”, etc. Experience dates should cover the time specified in the applicable MPR(s).		
05/20- 07/20	<b>I-220/I-20 Interchange Improvement &amp; BAFB Access, Bossier City, LA:</b> Mr. Sanchez provided inspection services for this project. This project included of concrete piles, drilled shafts, concrete and asphalt paving. Mr. Sanchez inspected pile driving operations and <b>asphalt paving operations</b> .		
06/18 -05/20	<b>N. Flannery/Firewood/Cloverland Bridges, East Baton Rouge Parish, LA:</b> Mr. Sanchez is provided Inspection services for the replacement of three bridges in East Baton Rouge Parish. He was responsible for inspecting construction work for compliance with plans and specifications, prepare daily reports, keeping track of quantiles of pay items, personnel and equipment used by the contractor etc.		
07/19 – 04/20	<b>Southern University Erosion / Road Improvement, East Baton Rouge Parish:</b> Mr. Sanchez served as DOTD certified inspector for this project. This project consisted of removing a temporary bridge and replacing it with reinforced concrete box culverts. It also included <b>roadway work</b> including embankment, base course, <b>asphalt paving</b> and drainage structures. Mr. Sanchez provided inspection on base course operations, asphalt paving operation and installation of box culverts.		
01/19 – 07/19	<b>La 431 @ La 934 Intersection Improvement, Ascension Parish, LA.</b> Mr. Sanchez was lead inspector on this project. This project consisted of drainage structures, embankment, replacing traffic signals, base course and <b>asphalt paving</b> . Mr. Sanchez provided inspection for excavation operations, drainage structure installation, replacement of traffic signal, <b>asphalt paving and striping</b> of roadway.		

Prime consultant name: *ECM Consultants, Inc.*

05/18- 07/19	<b>I-110 Interchange Modifications at Terrace Ave., (CE&amp;I), Baton Rouge, LA:</b> Mr. Sanchez provided inspection services for <b>this \$8.80 million I-110 Terrace Ave Interchange</b> Project that will provide connectivity from I-110 southbound to the existing I-10 eastbound at the Washington Street exit. The project consists of an exit ramp that will be constructed on the left side of I-110 southbound allowing traffic to exit onto Terrace Ave. Nineteen drill shafts will be utilized. The production shafts consist of 6-24" shafts, 2-36" shafts, 2-48" shafts and 9-96" shafts ranging in length from 55' to 102'. Additionally, this project will also include a widening of the I-110 southbound roadway span, installation of signage and the installation of poles with new camera equipment to monitor traffic
02/18-05/18	<b>Roadway restoration in connection with SSO Program, City of Baton Rouge/East Baton Rouge Parish-DPW, Baton Rouge, LA:</b> Mr. Sanchez served as Inspector for projects for <b>roadway restorations</b> after installation of gravity sewer lines and force mains under the SSO Program. He monitored placement of base course and <b>asphaltic concrete paving for roadway restorations</b> and prepared daily inspection reports.
01/11-12/17	<b>Engineering Technician, Asphalt Plant:</b> Mr. Sanchez sampled and ran DSR tests on blended liquid asphalt and aided in the designing of Job Mixes. He ran gradations, sampled hot mixes and ran tests to determine the specific gravity of the mix for bricks and to determine voids on compacted mix. He worked on roadway cores, trimming them and placing them in an oven to dry prior to testing. When tests indicated mixes were out of specifications, he determined what changes needed to be made to get the mix into specification. He ensured all relevant paperwork was completed.
12/15-11/17	<b>Area Field Quality Control Manager &amp; Asphalt Plant Quality Control Technician,</b> While working with Coastal Bridge Company, Mr. Sanchez's responsibilities included supervising Field QC personnel to ensure they were performing as directed/needed on the project and to ensure that density tests were run and documented. Additionally, Mr. Sanchez acted as a Field QC Technician on various projects as needed.
08/15-04/17	<b>LA. 1, LA 6–LA 75: Road Rehabilitation for Iberville Parish .</b> Mr. Sanchez was the QC technician for Coastal Contractors for this project, that included the reconstruction of 9.5 miles of roadway, along with the construction of a at grade Railroad tie-in at the Union Pacific railroad crossing located near Evergreen Road. This work included check grade, coordination with Railroad flagman, coordination with DOTD staff, meeting ride tolerances, and all pavement specifications to produce a quality tie in at the rail crossing at this location. Mr. Sanchez was responsible for the overall quality for this project, which exceeded all ride tolerance specifications.
07/80- 01/11	<b>LADOTD Certified Asphalt Plant Inspector:</b> While working for LADOTD, Mr. Sanchez's responsibilities included working at various asphalt plants to ensure the contractors adhered to all LADOTD specifications. He ran all tests on hot mixes alongside contractors' technicians in order to obtain accurate test results. His responsibilities also included completing all paperwork and delivering samples to the DOTD lab.

Prime consultant name: *ECM Consultants, Inc.*

**16. Staff Experience:**

Résumés shall be provided for all prime and sub-consultant personnel listed in Sections 14 and/or 15 of the proposal. Résumés of personnel not identified in Section 14 or Section 15 of the proposal should not be included and will not be evaluated. Résumés should be limited to 2 pages per person. Any certificates required by the advertisement are to be placed in Section 20.

Firm Employed by: <b>ECM Consultants, Inc.</b>				
Name	<b>Matthew Sigler</b>		Years of experience with this firm/employer	<b>8</b>
Title	<b>Construction Inspector</b>		Years of experience with other firm(s)/employer(s)	<b>16</b>
Degree(s) / Years / Specialization		High School Diploma		
Active registration number / state / expiration date		NA		
Year registered		Discipline	NA	
Contract role(s) / brief description of responsibilities		<b>Mr. Sigler will serve as a Construction Inspector for this contract.</b> He has the following certifications: ACI Certification; AHERA Certified for Nuclear Troxler Gauge; and ASSTA Work Zone Traffic Control Technician/Supervisor and Flagger.		
Experience dates (mm/yy–mm/yy)	Experience and qualifications relevant to the proposed contract, <i>i.e.</i> , “designed drainage”, “designed girders”, “designed intersection”, etc. Experience dates should cover the time specified in the applicable MPR(s)			
03/2013- On going	<p><b>SSO Program, City of Baton Rouge/East Baton Rouge Parish-DPW; Baton Rouge, LA :</b> Since 2013 Mr. Sigler is providing construction inspection services for many projects under this \$900 million SSO program. His responsibilities include monitoring construction activities to ascertain that works are performed in conformance with the project plans and specifications, conforming to construction safety requirements of OSHA Standards. He is also responsible for tracking quantities of pay items as well as recording equipment at the site, both working and idle, number and categories of contractor’s personnel working at the site. He was involved in inspection of installation of new gravity lines as well as rehabilitation of gravity lines, and installation of forcemains, and upgrades of pump stations. He also inspected <b>PCC and Asphaltic concrete roadway restoration</b> for several road restoration projects scattered all over City/Parish of EBR. He prepared daily reports, interpreted field and material testing results, monitored and documented construction progress through daily and weekly progress reports that included progress photos and quantities of work items in place on daily basis. The following are examples of a few complete roadway restoration projects that included roadway removal, backfill, embankment, aggregate base and asphalt and concrete surfacing:</p> <ul style="list-style-type: none"> <li>• Airline Hwy Pipeline Group A</li> <li>• Sherwood Forest – Goodwood Blvd.</li> <li>• Lovett Rd. – Greenwell Springs Road</li> <li>• Hooper Road</li> <li>• Florida Blvd.</li> </ul>			

**16. Staff Experience:**

Résumés shall be provided for all prime and sub-consultant personnel listed in Sections 14 and/or 15 of the proposal. Résumés of personnel not identified in Section 14 or Section 15 of the proposal should not be included and will not be evaluated. Résumés should be limited to 2 pages per person. Any certificates required by the advertisement are to be placed in Section 20.

Firm employed by <b>ECM Consultants, Inc.</b>			
Name	<b>Anatole Hammer</b>		Years of experience with this firm/employer
Title	<b>Construction Inspector</b>		Years of experience with other firm(s)/employer(s)
Degree(s) / Years / Specialization		High School Diploma	
Active registration number / state / expiration date		NA	
Year registered		Discipline	NA
Contract role(s) / brief description of responsibilities		<b>Mr. Hammer will serve as Construction Inspector under this contract.</b> He has the following certifications: ATSSA Traffic Control Flagger, Traffic Control Technician, Traffic Control Supervisor and OSHA 10. He is a certified PEC and will be available for inspection of traffic , pedestrian signals, roadway lighting and ITS power systems.	
Experience dates (mm/yy–mm/yy)	Experience and qualifications relevant to the proposed contract, <i>i.e.</i> , “designed drainage”, “designed girders”, “designed intersection”, etc. Experience dates should cover the time specified in the applicable MPR(s).		
03/19-05/20	<b>LADOTD SP H.012420.6 (CE&amp;I) I-110 Interchange Modifications @ Terrace Ave., Baton Rouge, LA:</b> Mr. Hammer served as Construction Inspector under supervision of the DOTD certified inspectors for this <b>\$8.80 million</b> I-110 Terrace Ave Interchange Project. that will provide connectivity from I-110 southbound to the existing I-10 eastbound at the Washington Street exit. The project consists of an exit ramp that will be constructed on the left side of I-110 southbound allowing traffic to exit onto Terrace Ave. Nineteen drill shafts will be utilized. The production shafts consist of 6-24” shafts, 2-36” shafts, 2-48” shafts and 9-96” shafts ranging in length from 55’ to 102’. Additionally, this project will also include a widening of the I-110 southbound roadway span, installation of new signage and the installation of poles with new camera equipment to monitor traffic.		
03/14- On going	<b>SSO Program, City of Baton Rouge/East Baton Rouge Parish-DPW; Baton Rouge, LA.</b> Mr. Hammer is providing <b>construction inspection</b> services for many projects under this \$900 million SSO program undertaken by City to mitigate EPA consent decree. His responsibilities include monitoring construction activities to ascertain that works are performed in conformance with the project plans and specifications, conforming to construction safety requirements of OSHA Standards. He is also responsible for tracking quantities of pay items as well as. recording equipment at the site, both working and idle, number and categories of contractor’s personnel working at the site. He was involved in inspection of installation of new Gravity lines as well as rehabilitation of gravity lines, and installation of Forcemains, and upgrades of Pump Stations and wastewater treatment plant facilities. Mr. Hammer’s responsibilities included inspection of electrical system,, control system and SCADA system to pump stations and WWTP.		

**16. Staff Experience:**

Résumés shall be provided for all prime and sub-consultant personnel listed in Sections 14 and/or 15 of the proposal. Résumés of personnel not identified in Section 14 or Section 15 of the proposal should not be included and will not be evaluated. Résumés should be limited to 2 pages per person. Any certificates required by the advertisement are to be placed in Section 20.

Firm employed by <b>ECM Consultants, Inc.</b>			
Name	<b>Emilio Rodriguez</b>	Years of relevant experience with this employer	<b>13</b>
Title	<b>Senior Construction Inspector</b>	Years of relevant experience with other employer(s)	<b>20</b>
Degree(s) / Years / Specialization		<b>Technical Architecture (Construction) / 1989; Certified NACE Coating Inspector Level 2; ATSSA Work Zone Traffic Control Flagging, Supervisor; NHI Bridge Inspection; Movable Bridge Inspection; DOT/FAA Drone Remote Pilot; Aerial Boom Lifts; Scissor Lifts; OSHA-10</b>	
Active registration number / state / expiration date		N/A	
Year registered	N/A	Discipline	N/A
Contract role(s) / brief description of responsibilities		<b>Mr. Rodriguez will serve as a Construction Inspector for this contract.</b> He will perform inspections under the supervision of DOTD certified inspector.	
Experience dates (mm/yy–mm/yy)	Experience and qualifications relevant to the proposed contract, <i>i.e.</i> , “designed drainage”, “designed girders”, “designed intersection”, etc. Experience dates should cover the time specified in the applicable MPR(s).		
01/07-05/08	<b>S.P. No. 742-36-0030: Lapalco Boulevard Improvements (US 90 to Segnette), Jefferson Parish, LA:</b> Mr. Rodriguez provided inspection for this <b>\$10.8 million roadway improvement project</b> . Scope of work included improvements to Lapalco Blvd between US 90 and Segnette Blvd. Phase I of the project involved cold planning and overlay of the existing two-lane roadway and Phase II involved construction of a new 2-lane roadway, cast-in-place reinforced culvert box (RCB) culvert, widening of an existing concrete girder span bridges, and a new concrete girder span bridge. His responsibilities included maintaining all construction field records; making daily entries in the project diary; monitoring construction activities to ascertain that the work is performed in accordance with plans and		
05/18 – 07/19	<b>I-10: Highland to LA 73 Design-Build Project   LADOTD   East Baton Rouge/Ascension Parish, LA:</b> Mr. Rodriguez served as one of the <b>Construction Inspector</b> for this <b>\$72 million</b> design-build project to widen I-10 from four to six lanes in both east and westbound directions, bridge modifications including replacing I-10 bridge over Highland Road, widening and rehabilitating I-10 bridge over Bayou Manchac, and rehabilitating LA 928 over I-10, and replacing I-10 over LA 73. Project includes two bridge construction including pile driving, installing prestressed concrete girders, bridge deck and rehabilitation of two bridges over I-10, elevated roadway, <b>on-grade roadway</b> including earthwork, subbase and base, drainage, utilities relocation, <b>PCC pavement</b> , concrete barrier railing, roadway lighting and <b>striping</b> .		



**16. Staff Experience:**

Résumés shall be provided for all prime and sub-consultant personnel listed in Sections 14 and/or 15 of the proposal. Résumés of personnel not identified in Section 14 or Section 15 of the proposal should not be included and will not be evaluated. Résumés should be limited to 2 pages per person. Any certificates required by the advertisement are to be placed in Section 20.

Firm employed by <b>GOTECH, INC.</b>			
Name	<b>Robert Price, PLS</b>		Years of relevant experience with this employer
Title	Survey Coordinator		<b>2</b>
Degree(s) / Years / Specialization		Years of relevant experience with other employer(s)	
		<b>20</b>	
Active registration number / state / expiration date		<b>MS   2009   Engineering &amp; Technology Management; BS   1997   Survey &amp; Mapping; BS   1993   Industrial Technology/Building Coordination</b>	
4889   LA   03/31/2024			
Year registered	<b>1992</b>	Discipline	<b>Professional Land Surveyor</b>
Contract role(s) / brief description of responsibilities		Mr. Price is a Licensed Professional Land Surveyor with more than <b>20 years of experience</b> in land surveying and mapping; project management; and personnel management. He has provided surveying and utility location <b>designation support for pipeline</b> , road improvement, LNG facilities, oil and gas well locations, and private development projects. <b>Mr. Price will serve as Surveyor for this project.</b>	
Experience dates (mm/yy–mm/yy)	Experience and qualifications relevant to the proposed contract, <i>i.e.</i> , “designed drainage”, “designed girders”, “designed intersection”, etc. Experience dates should cover the time specified in the applicable MPR(s).		
04/15-present	<b>4400004485; H.009320: LA DOTD – Acadian Rd Roundabout, Route LA 20 (Canal Blvd) &amp; Local Routes (Back Street, Jackson Street, Thompson Place), Thibodaux, LA:</b> Mr. Price was the <b>Professional Land Surveyor</b> providing professional supervision and project management oversight for the right-of-way mapping services to support parcel acquisition required for design of a new road roundabout in Thibodaux, Louisiana. Project included field property surveys performed to DOTD survey standards and parcel title work reviews of affected properties. Final right-of-way map and parcel description deliverables, along with MicroStation parcel mapping files, were reviewed and submitted in accordance with established DOTD Location and Survey delivery requirements.		
10/17-Present	<b>Parish of Ascension DPW – Move Ascension – Henry Road Safety Widening (LA 73 Tillotson Road/Akins Road) Ascension Parish, LA:</b> Mr. Price is the project manager providing the <b>topographic surveying and mapping services</b> to support the design and right-of-way acquisition for the Move Ascension - Henry Road widening project. Project surveys were in support of new design to widen approximately 8-miles of roadway in Ascension Parish. GOTECH is a Sub-Consultant to GSA, Inc.		

04/18-06/18	<b>Peltier Park Sidewalks – Local Road Safety Program / Safe Routes to School – LA DOTD (4400005891; H.012479):</b> Mr. Price was the <b>Survey Project Manager</b> managing the <b>topographic survey</b> to support design for various sidewalk, driveway and handicapped curbed ramp improvements along the perimeter of Peltier Park in Thibodeaux, Louisiana. Project field activities included a 2,400-linear foot existing conditions and utility survey utilizing Louisiana DOTD electronic data collection standards. The final deliverables for the project consisted of detailed plan/profile sheets drawn for the project alignment.
05/17-07/17	<b>I-55 at Hwy 22 Interchange Lighting, Tangipahoa Parish, LA - LA DOTD (4400005660; H.012874.5):</b> As Survey Project Manager, Mr. Price professionally managed the <b>topographic and utility location survey</b> services in support of design plans and specifications for the I-55 at LA Hwy 22 Interchange Lighting in Tangipahoa Parish. Survey crews conducted a complete topographic, elevation and utility survey within the entire limits of the I-55 Interchange with LA Highway 22. The topographic survey included data collected on the highway crossing exit/entrance ramps and <b>elevated overpasses</b> in addition to the location of both above ground and subsurface utilities required to facilitate design of lighting structures. All final deliverables were certified and submitted in strict accordance with DOTD Location and Survey standards.
10/17-03/18	<b>I-10 at Morrison Rd Interstate Lighting, Orleans Parish, LA – LADOTD Retainer Contract for Electrical Services (4400002746; H.012602.5):</b> Mr. Price provided project oversight as a Professional <b>Land Surveyor</b> with supervision and project management of <b>topographic surveys</b> to support various interstate lighting design projects. The projects included static GPS control surveys and topographic field surveys performed to DOTD survey standards within the full limits of the highway interchange. The survey field information gathered included roadway surface features, drainage structures, designated subsurface utility locations, and structure data on elevated portions of the <b>interstate bridge overpass</b> . Final deliverables, and MicroStation mapping files, were certified and submitted in accordance with established DOTD Location and survey delivery requirements.
08/03-10/07	<b>Louisiana Department of Transportation and Development, U.S Hwy 165, Georgetown to Tullos, Grant and LaSalle Parishes, Louisiana:</b> <b>Survey Coordinator</b> responsible for deed research and property monument recovery in connection with the property survey along a six (6) mile section of the existing U.S. Hwy 165 roadway from Georgetown to Tullos. Survey consisted of locating and retracing the boundary lines of approximately 100 property owners. Several restorations of Public Land Survey corners were undertaken as required in the determination of boundary lines

**16. Staff Experience:**

Résumés shall be provided for all prime and sub-consultant personnel listed in Sections 14 and/or 15 of the proposal. Résumés of personnel not identified in Section 14 or Section 15 of the proposal should not be included and will not be evaluated. Résumés should be limited to 2 pages per person. Any certificates required by the advertisement are to be placed in Section 20.

Firm employed by <b>GOTECH, INC.</b>			
Name	<b>John Biggs</b>		Years of relevant experience with this employer
Title	Survey Technician		Years of relevant experience with other employer(s)
Degree(s) / Years / Specialization		<b>N/A</b>	
Active registration number / state / expiration date		<b>N/A</b>	
Year registered	<b>N/A</b>	Discipline	<b>N/A</b>
Contract role(s) / brief description of responsibilities		<p>Mr. Biggs is presently a Survey Technician with over 20 years of survey experience. Mr. Biggs has a working knowledge of total station operation, EDM equipment, Fathometer/Hydro equipment, data collection and GPS equipment. He has been involved in nearly every aspect of field surveying to include:</p> <ul style="list-style-type: none"> <li>- First order baseline traversing - Property boundary surveys - Cadastral layout</li> <li>- Cross section surveys - Topographic surveys - Construction layout</li> <li>- Automated hydrographic surveys - Photogrammetric surveys - Infrastructure surveys</li> <li>- Levee centerline profile surveys</li> </ul> <ul style="list-style-type: none"> <li>▪ Certified Traffic Control Supervisor – ATSSA Expires 2/7/2023</li> <li>▪ Certified Traffic Control Technician – ATSSA Expires 2/5/2023</li> </ul>	
Experience dates (mm/yy–mm/yy)	Experience and qualifications relevant to the proposed contract, <i>i.e.</i> , “designed drainage”, “designed girders”, “designed intersection”, etc. Experience dates should cover the time specified in the applicable MPR(s).		
02/19-present	<p><b>Pointe-Marie: A New Village, Baton Rouge, LA</b></p> <p>Mr. Biggs is currently the Lead Survey Technician for the on-going design and construction of Pointe-Marie. This project entails a planned community development of a mixed-use village encompassing over 120 acres. His duties include the layout of roadways, drainage, grading, sanitary sewer system, utility layout and coordination and overseeing construction activities. Phase I is complete and he is working on Phase II.</p> <p>Mr. Biggs also has been responsible for the boundary survey field work on the development. This work includes geometric calculations, property corner setting, elevation surveys and lot layouts. Working to improve drainage across overhead utilities and underground pipelines in the north end of the property to include Entergy Transmission and Distribution, Shell Pipeline, Baton Rouge Sewer Force Main and Entergy Gulf States.</p>		

11/19-05/21	<p><b>New Orleans Street Rehabilitation: RR101, RR102 – New Orleans Department of Public Works, Orleans Parish, LA</b></p> <p>Mr. Biggs was Survey Technician providing topographic surveying services for roadway rehabilitation design. The project included static GPS control surveys, elevation level loop runs, and conventional topographic field surveys. Topographic field information gathered included roadway/pavement surface features, drainage structures, both surface and subsurface utilities, and survey data on all features within the apparent right-of-way. All field data was collected in standard DOTD electronic feature code format.</p>
11/19-06/21	<p><b>New Orleans Streets Rehab: RR119 RR120 – New Orleans Department of Public Works, Orleans Parish, LA</b></p> <p>For the roadway improvement projects in New Orleans, Mr. Biggs has been the Lead Survey Technician for GOTECH. He has conducted topographic surveys that were used as the basis for new roadway improvement designs. Gutter line surveys were used for drainage calculation and his pavement surveys were used as the basis for new roadway geometric designs (vertical curves and horizontal geometry). All survey data was compiled in detailed plan/profile sheets resulting in a complete construction document package.</p>

**16. Staff Experience:**

Résumés shall be provided for all prime and sub-consultant personnel listed in Sections 14 and/or 15 of the proposal. Résumés of personnel not identified in Section 14 or Section 15 of the proposal should not be included and will not be evaluated. Résumés should be limited to 2 pages per person. Any certificates required by the advertisement are to be placed in Section 20.

Firm employed by: <b>Arcadis</b>			
Name	<b>Anthony Moore, PE</b>		Years of relevant experience with this employer
Title	<b>Senior ITS Design Engineer</b>		<b>4</b>
Degree(s) / Years / Specialization		Years of relevant experience with other employer(s)	
		<b>26</b>	
Active registration number / state / expiration date		<b>BS / 1994 / Civil Engineering, University of Missouri</b>	
Year registered	<b>2013</b>	Discipline	<b>PE.0037887 / LA / Exp. 09/30/2023</b>
Contract role(s) / brief description of responsibilities		<b>Civil Engineering</b>	
		<b>Mr. Moore will serve as ITS Project Engineer.</b> Mr. Moore is a Transportation Engineer specializing in traffic engineering, design, signal timing development and deployment, construction, Intelligent Transportation System (ITS) design, construction, and construction engineering, and inspection ( <b>CE&amp;I</b> ). He has more than 30 years of experience in the fields of traffic and safety analysis, signal design, and ITS design. He has five years of construction engineering and inspection (CE&I) experience with LADOTD ITS construction projects serving as a project engineer. His certifications include: ATSSA TCS, TCT, Flagger, <b>IMSA Traffic Signal Technician Level II and Traffic Engineering Analysis Process &amp; Report (TEPR), Module 3. He meets MPR No. 5.</b>	
Experience dates (mm/yy–mm/yy)	Experience and qualifications relevant to the proposed contract, <i>i.e.</i> , “designed drainage”, “designed girders”, “designed intersection”, etc. Experience dates should cover the time specified in the applicable MPR(s).		
02/19 – 08/21	<b>US 190 ITS Deployment, LADOTD, West Baton Rouge, Pointe Coupee and Landry Parishes, LA / Project No. H.011505. Project Engineer.</b> Provide construction management services to LADOTD on ITS expansion project that includes the installation of approximately 48 miles of fiber optic communications cable, the interconnection of four traffic signals onto the LADOTD communications network, and the installation of two communications HUB buildings. As Project Engineer, responsibilities include overseeing all aspects of construction and inspection including providing engineering support and quality control oversight to the contractor during construction, directing field inspectors, and maintaining project documentation required by LADOTD, including RFIs and shop drawings.		
10/19 – 08/21	<b>Alexandria ITS Deployment Phase 3, LADOTD, Rapides Parish, LA / Project No.H.011505. Project Engineer.</b> Provide construction management services to LADOTD on ITS expansion project in the Alexandria metropolitan area. The ITS expansion project includes the installation of fiber optic communications cable, Dynamic Message Signs and Closed-Circuit Television cameras on US 71, US 165, and LA 28. As Project Engineer, responsibilities include overseeing all aspects of construction and inspection including providing engineering support to the contractor during construction, directing field inspectors, and maintaining project documentation required by LADOTD.		

10/16 – 08/17	<b>I-10 Bonnet Carre Emergency Crossing, LADOTD, St. John and St. Charles Parishes, LA / Project No.H.011472.</b> <i>Project Engineer.</i> Provide construction management services to LADOTD on ITS repair project in St. John and St. Charles Parishes. The ITS expansion project includes the installation of fiber optic communications cable, one Dynamic Message Sign, and the repair of two emergency crossing gates on the elevated section of I-10 near the Bonnet Carre spillway. As Project Engineer, responsibilities include overseeing all aspects of construction and inspection including providing engineering support and quality control oversight to the contractor during construction, directing field inspectors, and maintaining project documentation required by LADOTD.
02/16 – 08/17	<b>Lake Charles ITS Phase 2, LADOTD; Calcasieu Parish, LA / Project No.H.010192.</b> <i>Project Engineer.</i> Provide construction management services to LADOTD on ITS expansion project in the Lake Charles metropolitan area. The ITS expansion project includes the installation of fiber optic communications cable, Dynamic Message Signs and Closed-Circuit Television cameras on I-10. As project engineer, his responsibilities include overseeing all aspects of construction and inspection including providing engineering support and quality control oversight to the contractor during construction, directing field inspectors, and maintaining project documentation required by LADOTD.
12/12 – 06/16	<b>New Orleans Core ITS, LADOTD, Jefferson and Orleans Parish, LA / Project No. H.009427.</b> <i>Project Engineer.</i> Provide construction management services to LADOTD on ITS expansion project in the New Orleans metropolitan area. The ITS expansion project includes the installation of fiber optic communications cable, Dynamic Message Signs and Closed-Circuit Television cameras on I-10, I-610, and US 90B. As project engineer, his responsibilities include overseeing all aspects of construction and inspection including providing engineering support and quality control oversight to the contractor during construction, directing field inspectors, and maintaining project documentation required by LADOTD.
3/2013–8/2015	<b>Weigh In Motion, LADOTD, Jefferson and Orleans Parish, LA / S.P.N. H.009427 F.A.P No. H.009427.</b> <i>Project Engineer.</i> Provide construction management services to LADOTD on statewide weigh in motion upgrade project. The weigh in motion project includes the installation of fiber optic communications cable, Dynamic Message Signs, Closed Circuit Television cameras, and weigh in motion scales on I-10, I-12, and I-20. As Project Engineer, responsibilities include overseeing all aspects of construction and inspection including providing engineering support to the contractor during construction, directing field inspectors, and maintaining project documentation required by LADOTD.
6/2014–11/2015	<b>Dynamic Message Sign (DMS) Ladder Statewide, LADOTD, Statewide, LA / S.P.N. H.009427 F.A.P No. H.009427.</b> <i>Project Engineer.</i> Provide construction management services to LADOTD on DMS Ladder project to install new DMSs and ladder/walkway systems on existing DMS poles. As Project Engineer, responsibilities include overseeing all aspects of construction and inspection including providing engineering support to the contractor during construction, directing field inspectors, and maintaining project documentation required by LADOTD.



**16. Staff Experience:**

Résumés shall be provided for all prime and sub-consultant personnel listed in Sections 14 and/or 15 of the proposal. Résumés of personnel not identified in Section 14 or Section 15 of the proposal should not be included and will not be evaluated. Résumés should be limited to 2 pages per person. Any certificates required by the advertisement are to be placed in Section 20.

Firm employed by. <b>Arcadis</b>			
Name	<b>Anthony Jackson</b>		Years of relevant experience with this employer
Title	<b>Senior Technician</b>		Years of relevant experience with other employer(s)
Degree(s) / Years / Specialization		<b>Pre-Civil Engineering Coursework / 2016-Ongoing / Baton Rouge Community College</b>	
Active registration number / state / expiration date		N/A	
Year registered	N/A	Discipline	ATTSA TCT, TCS, Flagger; Manufacturer certifications in COHU, Daktronics, Econolite (Autoscope), Trafficware, and Fall Protection (Authorized Person)
Contract role(s) / brief description of responsibilities		<b>ITS Technician.</b> Mr. Jackson has 22 years of experience in constructing, integrating, and maintaining traffic signal and ITS systems in the transportation industry. He has experience with complex intelligent transportation system (ITS), and Traffic Signalizations. He has a thorough knowledge of LADOTD standards and specification. He has certified technical trainings on ITS assets and systems such as COHU, Axis, Daktronics, ISS RTMS Traffic Detector, Trafficware TS2, and Econolite Autoscope and others. He also has certifications as an IMSA Level III Traffic Signal Technician, and Traffic Signal Inspector for Advance Technologies.	
Experience dates (mm/yy–mm/yy)	Experience and qualifications relevant to the proposed contract; i.e., “designed drainage”, “designed girders”, “designed intersection”, etc. Experience dates should cover the time specified in the applicable MPR(s).		
02/19 – 08/21	<b>US 190 ITS Deployment, LADOTD, West Baton Rouge, Pointe Coupee, and Landry Parishes, LA / S.P.N. H.011511 F.A.P No. H.011511.</b> Project Technician. Provide construction management services to LADOTD on ITS expansion project that includes the installation of approximately 48 miles of fiber optic communications cable, the interconnection of four traffic signals onto the LADOTD communications network, and the installation of two communications HUB buildings. As Project Technician, his responsibilities include overseeing all aspects of construction and inspection including providing engineering support to the contractor during construction, directing field inspectors, and maintaining project documentation required by LADOTD.		
10/19 – 08/21	<b>Alexandria ITS Deployment Phase 3, LADOTD, Rapides Parish, LA / S.P.N. H.011505 F.A.P No. H.011505.</b> Project Technician. Provide construction management services to LADOTD on ITS expansion project in the Alexandria metropolitan area. The ITS expansion project includes the installation of fiber optic communications cable, Dynamic Message Signs and Closed-Circuit Television cameras on US 71, US 165, and LA 28. As Project Technician, his responsibilities include overseeing all aspects of construction and inspection including providing engineering support to the contractor during construction, directing field inspectors, and maintaining project documentation required by LADOTD.		

Prime consultant name: **ECM Consultants, Inc**

05/13 – Ongoing	<b>ITS Maintenance Retainer Contract</b> – Program Management and Maintenance Management System, LADOTD, Statewide, LA. Sr. Technician. Premier duties were to integrate, troubleshoot, and perform preventative maintenance, on CCTV Cameras, DMS, VD, and Ramp Meters. Performs QA/QC checks after any work is performed on the routine and responsive maintenance. The site visits for quality control on maintenance activities are to ensure thoroughness of work against maintenance procedure. It also allows the inspection of the TCP installation, and usability for current roadway geometrical conditions.
06/15 – 12/15	<b>District 04 Controller Upgrade Traffic Signalization and Related Work, Bienville, Bossier, Caddo, Claiborne, Desoto, Red River, Webster, Jefferson, Orleans, St. Bernard, St. Charles Parishes, Baton Rouge, LA.</b> Project Manager / Sr. Technician. Participated in planning and bidding to obtain contracts for projects. Acting Traffic Control Supervisor on the project and coordinated work schedule with LADOTD. Served as Lead Technician on project and approved partial estimates and change orders. On site, was responsible for programming ATC controllers, and installing GPS in the controller cabinets. Maintain proper traffic control by coordinating the shutdowns of major and minor signalized intersection with state and local police departments.
02/09 – 06/12	<b>Interstate – 10 widening Design-Build Project, East Baton Rouge, LA (450-10-0108).</b> Foreman. Responsible for removing and temporally relocating the existing CCTV sites on the project. Tasked with building new CCTV sites to replace the sites that where relocated, along with, building two additional sites. This construction consisted of drilled shaft, and controller cabinet foundations, erecting of poles, and cabinets. Building new power service and integrating the cabinets with new power, lighting, UPS, communication devises, where also a part of the construction. Coordinated the installation of fiber optic conduit and cable with the subcontractor and preformed the duties of the Traffic Control Supervisor for his company. Also responsible for the testing, troubleshooting, and maintenance of the CCTV systems for one year.

**16. Staff Experience:**

Résumés shall be provided for all prime and sub-consultant personnel listed in Sections 14 and/or 15 of the proposal. Résumés of personnel not identified in Section 14 or Section 15 of the proposal should not be included and will not be evaluated. Résumés should be limited to 2 pages per person. Any certificates required by the advertisement are to be placed in Section 20.

Firm employed by. <b>Arcadis</b>			
Name	<b>Jeffrey Jones</b>		Years of relevant experience with this employer
Title	<b>Project Manager/ Senior ITS Technician</b>		Years of relevant experience with other employer(s)
Degree(s) / Years / Specialization		<b>2005 / Electrical Engineering Coursework / University of New Orleans</b> <b>2005 / Electrical Engineering Coursework / Delgado Community College</b>	
Active registration number / state / expiration date		N/A	
Year registered	N/A	Discipline	<b>ATTSA TCT, TCS, TCDS, Flagger</b> ; Manufacturer certifications in COHU, Daktronics, Pelco, Axis, Econolite (Autoscope), Fall Protection (Authorized Person), Pelco, <b>IMSA I and IMSA II</b> / Louisiana Contractor License (Statewide Electrical, Telecommunications and Electrical Signs, Scoreboards, Displays, Billboards Construction)
Contract role(s) / brief description of responsibilities		<b>ITS Technician.</b> Mr. Jones has 20 years of experience designing, integrating and maintaining information systems in the transportation industry. He has experience with complex intelligent transportation system (ITS) networks that include wireless MESH, fiber optics, and copper. He has a thorough knowledge of WIFI, Cell Networks and Dedicated Short Range Communication (DSRC) systems and standards. He has certified technical trainings on ITS assets and systems such as COHU, Axis, Daktronics, ISS RTMS Traffic Detector, Trafficware/Naztec TS1 and TS2 Traffic Controller, Econolite Autoscope and others. He is IMSA II certified and is a licensed electrical contractor.	
Experience dates (mm/yy–mm/yy)	Experience and qualifications relevant to the proposed contract; <i>i.e.</i> , “designed drainage”, “designed girders”, “designed intersection”, etc. Experience dates should cover the time specified in the applicable MPR(s).		
02/19 – 08/21	<b>US 190 Intelligent Transportation Systems (ITS) Deployment, LADOTD, West Baton Rouge, Pointe Coupee, and Landry Parishes, LA / S.P.N. H.011511 F.A.P No. H.011511. Project Manager.</b> Provide construction management services to LADOTD on ITS expansion project that includes the installation of approximately 48 miles of fiber optic communications cable, the interconnection of four traffic signals onto the LADOTD communications network, and the installation of two communications HUB buildings. As Project Manager, his responsibilities include overseeing all aspects of construction and inspection including providing engineering support to the contractor during construction, directing field inspectors, and maintaining project documentation required by LADOTD.		
10/19 – 08/21	<b>Alexandria ITS Deployment Phase 3, LADOTD, Rapides Parish, LA / S.P.N. H.011505 F.A.P No. H.011505. Project Manager.</b> Provide construction management services to LADOTD on ITS expansion project in the Alexandria metropolitan area. The ITS expansion project includes the installation of fiber optic communications cable, Dynamic Message Signs and Closed-Circuit Television cameras on US 71, US 165, and LA 28. As Project Manager, his responsibilities included overseeing all aspects of construction and inspection including providing engineering support.		

08/16 – Ongoing	<b>ITS Maintenance Retainer Contract Program Management (PM) and Maintenance Management System (MMS), LADOTD, Statewide. – Contract No. 4400007102.</b> <i>Field Manager / Project Manager</i> responsible for program and project management, maintenance and related services for the LADOTD ITS maintenance program. Responsible for managing the routine maintenance of CCTV camera, dynamic message sign (DMS), vehicle detector (VD) and ramp meter sites, and responsive/emergency maintenance of CCTV camera and DMS sites located throughout the state of Louisiana. Developed Traffic Control Plans (TCP) and worked with the LADOTD project manager to determine safety class and critical level assignments for all ITS sites. Worked on the development of performance measures reports, ITS Maintenance Plan, Program Management Plan (PMP) and Health and Safety Plan (HASP) for the project. Performed site inspections, validation and quality control checks for maintenance activities performed under the contract.
08/16 – Ongoing	<b>ITS Maintenance Retainer Routine Maintenance Task Orders – CCTV Camera, DMS, VD, and Ramp Meter, LADOTD; Statewide, LA – Contract No. 4400007102 / H.011537.6 (A), H.011537.6 -2 (A), H.011537.6-3 (A).</b> <i>Field Manager / Project Manager</i> responsible for providing routine maintenance of statewide ITS sites including, CCTV cameras, DMS, VD, and ramp meters. Routine maintenance activities typically include inspecting site equipment, changing air filters, vacuuming dust out of a cabinet, cleaning CCTV domes, cleaning DMS face plates, and cleaning cooling fans, as well as record keeping. Responsibilities also include development of detailed checklist by device type; integration of checklist with MMS software; standardized reporting; development of routine maintenance scheduler; and coordination with statewide traffic management center (TMC), regional TMCs, and DOTD districts before, during, and after all routine maintenance activities.
08/16 – Ongoing	<b>ITS Maintenance Retainer Responsive Maintenance Task Orders – CCTV Camera and DMS, LADOTD; Statewide, LA Project No. 4400007102 / H.011537.6 (B), H.011537.6 -2 (B), H.011537.6-3 (B).</b> <i>Field Manager / Project Manager</i> responsible for providing responsive maintenance of statewide ITS sites including, CCTV camera and DMS. Responsive, or emergency, maintenance occurs in response to malfunctioning or faulty components that prevent the normal operations of ITS devices. Also responsible for tracking a responsive maintenance ticket to ensure work is done within the defined response time based on a site location.
08/13 – 08/16	<b>ITS Maintenance Retainer Responsive Maintenance Task Order – CCTV Camera, LADOTD, Statewide, LA – Project No. 4400002500 / H.007026.6 (F).</b> <i>Field Manager / Project Manager</i> responsible for providing responsive maintenance of statewide ITS sites including, CCTV camera and DMS. Responsible for responsive and emergency maintenance of ITS sites in Louisiana. Responsive maintenance involves the repair or replacement of any reported failed or malfunctioned equipment. Emergency maintenance is responsive maintenance that requires immediate repair, such as sites requiring traveler information, or incidents and events.
08/13 – 08/16	<b>ITS Maintenance Retainer Responsive Maintenance Task Order for Dynamic Message Sign (DMS), LADOTD, Statewide, LA – Project No. 4400002500 / H.007026.6 (G).</b> <i>Field Manager / Project Manager</i> responsible for responsive and emergency maintenance of all 79 DMS sites in Louisiana. Responsive maintenance is the repair or replacement of any reported failed or malfunctioned equipment. Emergency maintenance is responsive maintenance requiring immediate repair, such as sites requiring traveler information, or incidents and events. Sites were classified by risk to safety, with Class A, B, or C as well as level of criticality, with High, Medium or Low. Each site requires different safety precautions based on classifications. Arcadis project team assessed each site and applied the appropriate LADOTD traffic control details.

**16. Staff Experience:**

Résumés shall be provided for all prime and sub-consultant personnel listed in Sections 14 and/or 15 of the proposal. Résumés of personnel not identified in Section 14 or Section 15 of the proposal should not be included and will not be evaluated. Résumés should be limited to 2 pages per person. Any certificates required by the advertisement are to be placed in Section 20.

Firm employed by: <b>APS Engineering and Testing, LLC</b>			
Name	<b>Sergio Aviles, P.E.</b>		Years of relevant experience with this employer
Title	<b>President</b>		Years of relevant experience with other employer(s)
Degree(s) / Years / Specialization		<b>B.S. / 2001 / Civil Engineering / Geotechnical</b> ; NHI certifications Courses: Design & Implementation of Erosion & Sediment Control, Driven Pile Foundation Design and Inspection, Design of Pile Dynamic Analysis (PDA), WEAP, & CAPWAP. ATSSA Work Zone Traffic Control Supervisor, Technician, and Flagger Certifications	
Active registration number / state / expiration date		<b>0033571 / LA / 03-31-2024</b>	
Year registered	<b>2007</b>	Discipline	<b>Civil Engineering</b>
Contract role(s) / brief description of responsibilities		Mr. Aviles will serve as Professional Civil Engineer responsible for <b>QA/QC of Field Testing and Acceptance of Construction Materials.</b>	
Experience dates (mm/yy–mm/yy)	Experience and qualifications relevant to the proposed contract, <i>i.e.</i> , “designed drainage”, “designed girders”, “designed intersection”, etc. Experience dates should cover the time specified in the applicable MPR(s).		
05/18 – 12/20	<b>Project No.H.009250: I-10: Highland to LA 73:</b> The purpose was to conduct testing on the subsurface, base and concrete placement at the site to enable an evaluation of an acceptable standards for the proposed roadway structures. Mr. Aviles served as the QA/QC Field Testing manager for this project.		
01/19 – ongoing	<b>Project No.2012-FEMA-1B-1: Westend Group:</b> The purpose was to conducted testing on the subsurface, base and concrete placement at the site to enable an evaluation of an acceptable standards for the proposed roadway structures. Mr. Aviles is serving as QA/QC Field Testing manager for this project.		
04/19 – ongoing	<b>Project No. H.011795: Westwood Drive (WB Expressway to Lapalco):</b> The purpose was to conduct testing on the subsurface, base and concrete placement at the site to enable an evaluation of an acceptable standards for the proposed roadway structures. Mr. Aviles is serving QA/QC Field Testing manager for this project.		
05/19 – ongoing	<b>Phase II Project No. H.01798: Airline Park Blvd. (Camphor-West Napoleon):</b> The purpose was to conduct testing on the subsurface, base and concrete placement at the site to enable an evaluation of an acceptable standards for the proposed roadway structures. Mr. Aviles is serving as QA/QC Field Testing manager for this project.		
04/18 – 11/18	<b>Phase I Project No. H0.11798: Airline Park Blvd.:</b> The purpose was to conduct testing on the subsurface, base and concrete placement at the site to enable an evaluation of an acceptable standards for the proposed roadway structures. Mr. Aviles served as QA/QC Field Testing manager for this project.		



**16. Staff Experience:**

Résumés shall be provided for all prime and sub-consultant personnel listed in Sections 14 and/or 15 of the proposal. Résumés of personnel not identified in Section 14 or Section 15 of the proposal should not be included and will not be evaluated. Résumés should be limited to 2 pages per person. Any certificates required by the advertisement are to be placed in Section 20.

Firm employed by: <b>APS Engineering and Testing, LLC</b>			
Name	<b>Donna Easterling</b>		Years of experience with this firm/employer
Title	<b>Laboratory Manager</b>		Years of experience with other firm(s)/employer(s)
Degree(s) / Years / Specialization		<b>BA/2019/Environmental Sciences</b>	
Active registration number / state / expiration date		N/A	
Year registered	N/A	Discipline	
Contract role(s) / brief description of responsibilities		<b>Laboratory Manager-Supervising Lab Testing</b>	
Experience dates (mm/yy–mm/yy)	Experience and qualifications relevant to the proposed contract, <i>i.e.</i> , “designed drainage”, “designed girders”, “designed intersection”, etc. Experience dates should cover the time specified in the applicable MPR(s).		
09/19-Present	<b>Project No. H.004100: I-10 Widening LA 415 to Essen LN-</b> A P S was tasked thru our DOTD geotechnical retainer to drill and sample a total of 52 deep borings starting at the Washington Exit and ending at the LSU lakes. Along with this drilling and sampling APS will also test for strength and engineering characteristics of the soils with. A total of eight (8) over the waterborings and 44 land borings with approximate 1000 Triaxial Compression, Unconsolidated Drained Or Undrained (UU) and Atterberg Limits. Donna's duties were <b>supervising lab testing</b> .		
08/16-10/19	<b>Project No. H.012422: I-110 Interchange Modification at Terrace Ave-</b> A P S was tasked thru our DOTD geotechnical retainer to drill and sample a total of six (6) deep borings for the design of the Terrace Ave exit. APS tested for strength and engineering characteristics of the soils with approximate 100 Triaxial Compression, Unconsolidated Drained Or Undrained (UU) and Atterberg Limits by A P S Laboratory. Donna's duties were supervising lab testing.		
11/17-2/18	<b>Project No. H.013193: US 61 Thompson Creek Bridge Replacement-</b> A P S was tasked thru our DOTD geotechnical retainer to drill and sample a total of eight (8) deep borings for the replacement bridge at US 61 over Thompson Creek. APS tested for strength and engineering characteristics of the soils. Donna's duties were supervising lab testing.		
11/17-2/18	<b>Project No. H.002273, H.000710, and H.001352 Comite River Diversion Bridge at LA 67, LA 19 and LA 19 Railroad Bridge LA 67 and LA 19:</b> A P S was tasked thru our DOTD geotechnical retainer to drill and sample a total of 12 deep borings for the new and replacement bridges at Highway 19, 67, and 964. APS tested for strength and engineering characteristics of the soils. Donna's duties were supervising lab testing.		
03/19-05/19	<b>Project No. H.001344: US 190 over Bogue Falaya River-</b> A P S was selected with the winning team for the Geotechnical Investigation and Design of the proposed new bridge. A total of 19 deep borings were drilled and tested for the foundation recommendation. Donna's duties were supervising lab testing.		
02/17-10/17	<b>Project No. H.002861: Earhart Expressway/Causeway Boulevard:</b> APS was tasked with developing the LRFD factors for both existing structures and the new elevated sections to connect to Causeway Blvd. Per the task order APS drill and tested 85 borings to 120 feet near the proposed and existing structures. APS engineering staff provides designer with pile tip elevations for five elevated ramps to connect Earhart to Causeway Blvd. Provided boring logs, information on site conditions, site preparation recommendations, and load-length curves. Donna's duties were supervising lab testing.		



### 17. Firm Experience:

Identify the team's project experience most relevant to the scope in the advertisement. The projects should be limited to a total of 20, with no more than 5 projects being represented by the prime consultant and with no more than 3 projects represented by each sub-consultant on the team. If more than 5 projects are identified for the prime consultant, all projects identified after the first 5 will not be evaluated. If more than 3 projects are identified for a single sub-consultant, all projects identified after the first 3 from that sub-consultant will not be evaluated. Include no more than one page per project. Projects identified shall only include work performed by firms on the team. The projects identified do not necessarily need to have been DOTD projects.

Firm name	ECM Consultants, Inc.		Past Performance Evaluation Category(ies)*		CE&I/OV	
Project name	Safe Routes – Intersection Upgrade N Canal & 7th St			Firm responsibility (prime or sub?)		Prime
Project number	H.006546		Owner’s name	LADOTD		
Project location	Lafourche Parish			Owner’s Project Manager	Laura Riggs, P.E.	
Owner’s address, phone, email	1201 Capitol Access Road Baton Rouge, LA 70802, 225-379-1143, <a href="mailto:laura.riggs@la.gov">laura.riggs@la.gov</a>					
Services commenced by this firm (mm/yy)		04/19	Total consultant contract cost (\$1,000’s)			\$90
Services completed by this firm (mm/yy)		06/20	Cost of consultant services provided by this firm (\$1,000’s)			\$90

Describe the project including the firm's role and members involved. (Highlight staff to be used in this proposal.)

ECM provided Construction Engineering and Inspection (**CE&I**) services for Intersection Upgrade Canal & 7<sup>th</sup> St.; a \$800K construction project which is part of LA DOTD's Safe Routes to Public Places Program (SRTPPP) located in Lafourche Parish, LA. SRTPPP is part of the overall Highway Safety Improvement Program (HSIP) and falls under the umbrella of the Louisiana Strategic Highway Safety Plan (SHSP). ECM's Construction Engineering and Inspection (CE&I) duties included monitoring work performed by contractor, for compliance with contract documents, preparing daily written reports on the progress of the construction using LADOTD's **SiteManager** system, tracking and verifying quantities for pay items, and monthly construction estimates. These duties also included performing source evaluation and approval of materials suppliers, providing field testing per LADOTD Sampling Manual, and maintaining project documentation in order to complete LADOTD "2059" and final closeout. Project Engineering duties included preparing and approving change orders, verifying field quantities and approving contractor payments, and completing as-built plans for the project. Work on this project included **roadway widening for the installation of new asphalt turn lanes, traffic signal foundations and mast arms, and sidewalks and handicapped curb ramps**. The project also included installation of **new drainage pipes and structures to accommodate the new turn lanes and milling and overlay of the existing four lane roadway**.



Personnel worked on this project and used in this proposal:

**Zachary Collier, P.E.**  
**Matthew Sigler**

### 17. Firm Experience:

Identify the team's project experience **most relevant** to the scope in the advertisement. **The projects should be limited to a total of 20, with no more than 5 projects being represented by the prime consultant and with no more than 3 projects represented by each sub-consultant on the team. If more than 5 projects are identified for the prime consultant, all projects identified after the first 5 will not be evaluated. If more than 3 projects are identified for a single sub-consultant, all projects identified after the first 3 from that sub-consultant will not be evaluated.** Include no more than one page per project. Projects identified shall only include work performed by firms on the team. The projects identified do not necessarily need to have been DOTD projects.

Firm name	<b>ECM Consultants, Inc.</b>		Past Performance Evaluation Category(ies)*		<b>CE&amp;I/OV</b>	
Project name	<b>Safe Routes – Audubon Ave. and Ardoyne Dr. Mini-Roundabout</b>			Firm responsibility (prime or sub?)		<b>Prime</b>
Project number	<b>H.012479</b>		Owner’s name	LADOTD		
Project location	<b>Lafourche Parish</b>			Owner’s Project Manager	<b>Laura Riggs, P.E.</b>	
Owner’s address, phone, email	<b>1201 Capitol Access Road Baton Rouge, LA 70802, 225-379-1143, laura.riggs@la.gov</b>					
Services commenced by this firm (mm/yy)		<b>02/19</b>	Total consultant contract cost (\$1,000’s)			<b>\$69</b>
Services completed by this firm (mm/yy)		<b>09/19</b>	Cost of consultant services provided by this firm (\$1,000’s)			<b>\$69</b>

Describe the project including the firm's role and members involved. (Highlight staff to be used in this proposal.)

ECM provided Construction Engineering and Inspection (**CE&I**) services for the Audubon Ave. and Ardoyne Dr. **Mini-Roundabout project**; a \$280K construction project which is part of LA DOTD's Safe Routes to Public Places Program (SRTPPP) located in Lafourche Parish, LA. SRTPPP is part of the overall Highway Safety Improvement Program (HSIP) and falls under the umbrella of the Louisiana Strategic Highway Safety Plan (SHSP). ECM's Construction Engineering and inspection (CE&I) duties included monitoring of construction activities to ascertain that all work are done in strict compliance with contract plans and specifications and per DOTD standards. ECM inspectors prepared daily written reports on work performed, the progress of the construction using LADOTD **SiteManager** system, and tracking and verifying installed material quantities. These duties also included performing source evaluation and approval of materials suppliers, providing field testing and sampling, and maintaining project documentation in order to complete LADOTD "2059" and final closeout. Project Engineering duties included reviewing submittals and RFI's, preparing and approving change orders, verifying field quantities in order to prepare and approve contractor payments, and completing as-built plans for the project. Work on this project included installation of a **new roundabout** on the Nicholls State University campus including **sidewalks and handicapped ramps to connect the nearby apartments and park to the campus with safe pedestrian facilities.**



**Personnel worked on this project and used in this proposal:**

**Zachary Collier, P.E.**  
**Bob Tate**



### 17. Firm Experience:

Identify the team's project experience most relevant to the scope in the advertisement. The projects should be limited to a total of 20, with no more than 5 projects being represented by the prime consultant and with no more than 3 projects represented by each sub-consultant on the team. If more than 5 projects are identified for the prime consultant, all projects identified after the first 5 will not be evaluated. If more than 3 projects are identified for a single sub-consultant, all projects identified after the first 3 from that sub-consultant will not be evaluated. Include no more than one page per project. Projects identified shall only include work performed by firms on the team. The projects identified do not necessarily need to have been DOTD projects

Firm name	ECM Consultants, Inc.		Past Performance Evaluation Category(ies)*		CE&I/OV	
Project name	Safe Routes – Peltier Park Sidewalks				Firm responsibility (prime or sub?)	Prime
Project number	H.013084		Owner’s name	LADOTD		
Project location	Lafourche Parish			Owner’s Project Manager	Laura Riggs, P.E.	
Owner’s address, phone, email	1201 Capitol Access Road Baton Rouge, LA 70802, 225-379-1143, laura.riggs@la.gov					
Services commenced by this firm (mm/yy)			07/19	Total consultant contract cost (\$1,000’s)		\$67
Services completed by this firm (mm/yy)			01/20	Cost of consultant services provided by this firm (\$1,000’s)		\$67

Describe the project including the firm's role and members involved. (Highlight staff to be used in this proposal.)

ECM provided Construction Engineering and Inspection (**CE&I**) services for the Peltier Park Sidewalk project; a \$152K construction project which is part of LA DOTD's Safe Routes to Public Places Program (SRTPPP) located in Lafourche Parish, LA. SRTPPP is part of the overall Highway Safety Improvement Program (HSIP) and falls under the umbrella of the Louisiana Strategic Highway Safety Plan (SHSP). ECM's Construction Engineering and inspection (CE&I) duties included monitoring construction activities to ascertain conformance with contract plan, specifications and DOTD standards, preparing daily written reports on the work performed, progress of the construction, tracking and verifying quantities for pay items, any unusual activities, monthly construction estimates, including processing and verification, using LADOTD **SiteManager** system. Work on this project included installation **sidewalks, roadway crossings, and handicapped curb ramps to provide safe pedestrian facilities** in Peltier Park and connection to nearby ED White Catholic School Nicolls State University.



Personnel worked on this project and used in this proposal:

**Zachary Collier, P.E.**  
**Matthew Sigler**





## 17. Firm Experience:

Identify the team's project experience **most relevant** to the scope in the advertisement. **The projects should be limited to a total of 20, with no more than 5 projects being represented by the prime consultant and with no more than 3 projects represented by each sub-consultant on the team. If more than 5 projects are identified for the prime consultant, all projects identified after the first 5 will not be evaluated. If more than 3 projects are identified for a single sub-consultant, all projects identified after the first 3 from that sub-consultant will not be evaluated.** Include no more than one page per project. Projects identified shall only include work performed by firms on the team. The projects identified do not necessarily need to have been DOTD projects

Firm name	ECM Consultants, Inc.		Past Performance Evaluation Category(ies)*		CE&I/OV	
Project name	Pedestrian Crosswalk Enhancements (New Orleans Phase 2)			Firm responsibility (prime or sub?)		Prime
Project number	H.012682	Owner's name	LADOTD/City of New Orleans			
Project location	City of New Orleans, LA		Owner's Project Manager		Justin Guilbeau, P.E.	
Owner's address, phone, email	14101 Old Gentilly Road, New Orleans, LA 70129, 504-253-6102, <a href="mailto:justin.guilbeau@la.gov">justin.guilbeau@la.gov</a> (District 02)					
Services commenced by this firm (mm/yy)		05/22	Total consultant contract cost (\$1,000's)			\$425
Services completed by this firm (mm/yy)		On going	Cost of consultant services provided by this firm (\$1,000's)			TBD

Describe the project including the firm's role and members involved. (Highlight staff to be used in this proposal.)

ECM provided construction engineering and inspection (**CE&I**) services for this **\$2.6M** project involving **pavement striping, pedestrian and traffic signalization, roadway signage, and handicapped ramps on State and City roads** throughout the City of New Orleans. The proposed improvements will take place at over 50 intersections within the Central Business District of New Orleans.

ECM's responsibilities for CE&I services in general includes but not limited to:

- Scheduling and conducting the pre-construction meeting
- Maintaining all construction field records, making daily entries in the project diary
- Coordinating with the Chief Traffic Engineer with the City of New Orleans, and LADOTD Project Coordinator
- Inspecting the contractor's construction operations (daily) to ensure that all work is performed in accordance with the contract plans and specifications
- Keeping clear and concise records of the contractual operations
- Keeping record of work quantities on daily basis
- Monitoring safety compliance
- Preparing monthly pay estimates, and making monthly progress reports
- Preparing all documentation and entering in the SiteManager
- Monitoring and documenting all construction claims
- Managing RFIs and Change Requests from Construction Contractor
- Reporting deficiencies to the Construction Contractor for correction and simultaneously notifying City and LADOTD
- Attending substantial completion inspection and preparing "Punch List"
- Preparing "As-Built" plans, final estimate packages including Form 2059 and submitting to LADOTD

**Personnel worked on this project and used in this proposal:**

**Michael D'Angelo, P.E.,  
Anatole Hammer**



### 17. Firm Experience:

Identify the team's project experience most relevant to the scope in the advertisement. The projects should be limited to a total of 20, with no more than 5 projects being represented by the prime consultant and with no more than 3 projects represented by each sub-consultant on the team. If more than 5 projects are identified for the prime consultant, all projects identified after the first 5 will not be evaluated. If more than 3 projects are identified for a single sub-consultant, all projects identified after the first 3 from that sub-consultant will not be evaluated. Include no more than one page per project. Projects identified shall only include work performed by firms on the team. The projects identified do not necessarily need to have been DOTD projects

Firm name	<b>ECM Consultants, Inc.</b>		Past Performance Evaluation Category(ies)*		<b>CE&amp;I/OV</b>	
Project name	<b>Safe Routes – Raceland and Bayou Blue Sidewalks</b>				Firm responsibility (prime or sub?)	<b>Prime</b>
Project number	<b>H.010109</b>		Owner’s name	<b>LADOTD</b>		
Project location	<b>Lafourche Parish</b>			Owner’s Project Manager	<b>Laura Riggs, P.E.</b>	
Owner’s address, phone, email	<b>1201 Capitol Access Road Baton Rouge, LA 70802, 225-379-1143, laura.riggs@la.gov</b>					
Services commenced by this firm (mm/yy)		<b>08/19</b>	Total consultant contract cost (\$1,000’s)			<b>\$146</b>
Services completed by this firm (mm/yy)		<b>07/20</b>	Cost of consultant services provided by this firm (\$1,000’s)			<b>\$146</b>

Describe the project including the firm's role and members involved. (Highlight staff to be used in this proposal.)

ECM provided Construction Engineering and Inspection (**CE&I**) services for Raceland and Bayou Blue Sidewalks; a \$1M construction project which is part of LA DOTD's Safe Routes to Public Places Program (SRTPPP) located in Lafourche Parish, LA. SRTPPP is part of the overall Highway Safety Improvement Program (HSIP) and falls under the umbrella of the Louisiana Strategic Highway Safety Plan (SHSP). ECM's Construction Engineering and inspection (**CE&I**) duties included monitoring construction activities for conformance with contract plans, specifications and DOTD standards, preparing daily reports stating details of work done, the progress of the construction, tracking and verifying quantities for pay items, and monthly construction estimates, including processing and verification using **SiteManager**. Work on this project included installation of **new sidewalks, driveways, and handicapped ramps** along LA 308 and LA 316 to connect the surrounding neighborhoods with Bayou Blue Middle, Bayou Blue Elementary, and Raceland Middle Schools. The project also included **installation of new drainage pipes and structures, conversion of existing drainage ditches to underground drainage, and re-seeding of the affected areas along LA 316.**



Personnel worked on this project and used in this proposal

**Zachary Collier, P.E.**  
**Bob Tate**



### 17. Firm Experience:

Identify the team's project experience **most relevant** to the scope in the advertisement. The projects should be limited to a total of 20, with no more than 5 projects being represented by the prime consultant and with no more than 3 projects represented by each sub-consultant on the team. If more than 5 projects are identified for the prime consultant, all projects identified after the first 5 will not be evaluated. If more than 3 projects are identified for a single sub-consultant, all projects identified after the first 3 from that sub-consultant will not be evaluated. Include no more than one page per project. Projects identified shall only include work performed by firms on the team. The projects identified do not necessarily need to have been DOTD projects

Firm name	<b>Arcadis</b>		Past Performance Evaluation Discipline(s)*	<b>CE&amp;I/OV and ITS</b>
Project name	<b>CE&amp;I for Alexandria ITS Deployment Phase 3</b>			Firm responsibility (prime or sub?) <b>Prime</b>
Project number	<b>H.011505</b>	Owner's name	Louisiana Department of Transportation and Development	
Project location	Rapides Parish, LA		Owner's Project Manager	<b>Alaa Shams</b>
Owner's address, phone, email	ITS Annex Bldg., Room 210-S, 1212 East Highway Drive, Baton Rouge, LA 70802 / 225 379 1497, alaa.shams@la.gov			
Services commenced by this firm (mm/yy)	10/19	Total consultant contract cost (\$1,000's)		\$398
Services completed by this firm (mm/yy)	Ongoing	Cost of consultant services provided by this firm (\$1,000's)		\$375

Describe the project including the firm's role and members involved. (Highlight staff to be used in this proposal.)

Arcadis provided CEI services for the Alexandria ITS Deployment Phase 3 project in Rapides parish. This project consisted of the installation of eleven Closed Circuit Television (CCTV) cameras, six poles and eight CCTV lowering devices, two Dynamic Message Signs (DMS) and two poles, 15,000 feet of fiber optic cable and conduit, and the connection of sixteen signalized intersection, one HUB building, one existing CCTV camera, and the LADOTD District office onto the LADOTD fiber optic communications network. The project had a construction cost of \$1.9 million.

Our qualified and certified inspectors provided CEI oversight including the drilled shaft foundations for the new CCTV and DMS poles, erection of the CCTV and DMS poles, installation of the CCTV and DMS cabinets and associated hardware, conduit and fiber optic cable installation that crossed numerous existing utilities, and the fiber optic cable splicing process at multiple locations to tie all the new and existing components onto the DOTD communication network.

Anthony, (Tony) Jackson, Senior Technician/Senior Inspector, and Cody Lemoine, Senior Technician/Senior Inspector performed the daily inspections for the Alexandria ITS Deployment Phase 3 project. Tony has more than 20 years of experience on traffic signal and ITS projects in both construction and inspection. He maintains certifications on traffic signal construction and inspection, as well as other national safety certifications. Cody Lemoine has more than 7 years of experience on ITS projects, including construction, maintenance, and inspection. Cody has several national certifications including fiber optic cable splicing and testing, high tower inspection, and several others. Anthony, (Tony) Moore, P.E., Arcadis Senior Transportation Engineer, served as the Project Engineer. Tony has worked on multiple construction projects in the past several years including multiple ITS project for LADOTD. Tony directed the monthly progress meetings, oversaw and assisted in field inspections, coordinated work performed with the contractor and managed all project records on behalf of LADOTD, monitored and reviewed all Site Manager entries, and prepared monthly pay estimates in Site Manager.



**Personnel worked on this project and used in this proposal**  
**Tony Jackson, Cody Lemoine and Tony Moore**



### 17. Firm Experience:

Identify the team's project experience **most relevant** to the scope in the advertisement. **The projects should be limited to a total of 20, with no more than 5 projects being represented by the prime consultant and with no more than 3 projects represented by each sub-consultant on the team. If more than 5 projects are identified for the prime consultant, all projects identified after the first 5 will not be evaluated. If more than 3 projects are identified for a single sub-consultant, all projects identified after the first 3 from that sub-consultant will not be evaluated.** Include no more than one page per project. Projects identified shall only include work performed by firms on the team. The projects identified do not necessarily need to have been DOTD projects

Firm name	<b>Arcadis</b>		Past Performance Evaluation Discipline(s)*	<b>CE&amp;I/OV and ITS</b>
Project name	<b>CE&amp;I for LADOTD US 190 ITS Deployment</b>			Firm responsibility (prime or sub?) <b>Prime</b>
Project number	<b>H.011511</b>	Owner's name	Louisiana Department of Transportation and Development	
Project location	W. Baton Rouge, Pointe Coupee, and St. Landry		Owner's Project Manager	<b>Alaa Shams</b>
Owner's address, phone, email	ITS Annex Bldg., Room 210-S, 1212 East Highway Drive, Baton Rouge, LA 70802 / 225 379 1497, alaa.shams@la.gov			
Services commenced by this firm (mm/yy)	02/19	Total consultant contract cost (\$1,000's)		\$603
Services completed by this firm (mm/yy)	Ongoing	Cost of consultant services provided by this firm (\$1,000's)		\$603

Describe the project including the firm's role and members involved. (Highlight staff to be used in this proposal.)

Arcadis provided CEI services for the US 190 ITS Deployment project in West Baton Rouge, Pointe Coupee, and St. Landry parishes. This project consisted of the installation of approximately 225,000 feet of fiber optic cable and conduit, the installation of two communication HUB buildings, and the interconnection of four signalized intersections onto the state communications network. The project had a construction cost of \$2.3 million.

Our qualified and certified inspectors provided CEI oversight including the conduit and fiber optic cable installation that crossed numerous canals and existing utilities, the fiber optic cable splicing process at multiple locations to tie all the fiber optic cable together onto the DOTD communication network, the installation of HUB building concrete foundations, driveways, gas powered generator installations at HUB sites, driveways and fencing at the HUB sites, and the installation of fiber optic cable into four traffic signal cabinets.

Anthony, (Tony) Jackson, Senior Technician/Senior Inspector, performed the daily inspections for the US 190 ITS Deployment project. Tony has more than 20 years of experience on traffic signal and ITS projects. He maintains certifications on traffic signal construction and inspection, as well as other national safety certifications. Anthony, (Tony) Moore, P.E., Arcadis Senior Transportation Engineer, served as the project engineer. Tony has worked on multiple construction projects in the past several years including multiple ITS project for LADOTD. Tony directed the monthly progress meetings, oversaw and assisted in field inspections, coordinated work performed with the contractor and managed all project records on behalf of LADOTD, monitored and reviewed all Site Manager entries, and prepared monthly pay estimates in Site Manager.



**Personnel worked on this project and used in this proposal**  
**Tony Jackson and Tony Moore**

**17. Firm Experience:**

Identify the team's project experience most relevant to the scope in the advertisement. The projects should be limited to a total of 20, with no more than 5 projects being represented by the prime consultant and with no more than 3 projects represented by each sub-consultant on the team. If more than 5 projects are identified for the prime consultant, all projects identified after the first 5 will not be evaluated. If more than 3 projects are identified for a single sub-consultant, all projects identified after the first 3 from that sub-consultant will not be evaluated. Include no more than one page per project. Projects identified shall only include work performed by firms on the team. The projects identified do not necessarily need to have been DOTD projects

Firm name	<b>GOTECH, Inc.</b>	Past Performance Evaluation Category(ies)*	<b>Survey</b>
Project name	<b>LA Hwy 431 at LA Hwy 934 Intersection Improvements</b>	Firm responsibility (prime or sub?)	<b>Sub</b>
Project number	<b>H..007855.5</b>	Owner's name	<b>LADOTD</b>
Project location	<b>Ascension Parish, LA</b>	Owner's Project Manager	<b>Mark Chenevert</b>
Owner's address, phone, email	1201 Capitol Access Road, Room 405-E, Baton Rouge, LA 70802-4438, 225-379-1591, <a href="mailto:mark.chenevert@la.gov">mark.chenevert@la.gov</a>		
Services commenced by this firm (mm/yy)	<b>02/14</b>	Total consultant contract cost (\$1,000's)	<b>\$105</b>
Services completed by this firm (mm/yy)	<b>11/16</b>	Cost of consultant services provided by this firm (\$1,000's)	<b>\$105</b>

Describe the project including the firm's role and members involved. (Highlight staff to be used in this proposal.)

Working as a Subconsultant to Meyer Engineers, Ltd., GOTECH provided topographic surveying and mapping services for the Hwy 431 / 934 Intersection Improvements project. The work was located in Ascension Parish on what are currently two-lane highways with narrow shoulders and adjacent open ditch drainage. GOTECH field crews obtained field data in a format that was used to in MicroStation CADD drawings with Inroads software. GOTECH also mapped the data in an AutoCAD version for the designers to use. The topographic map showed existing features as pavement, ditches, culverts, lighting, signs, utility poles, traffic controls, driveways, and other utilities. GOTECH also developed an existing drainage map for the project. The watershed covered approximately 25 acres of contributing drainage area.

**Personnel worked on this project and used in this proposal**

**Rhaoul Guillaume, Sr. P.E.**

**Bruce Dyson, P.E., P.L.S.**

**Rob Price, P.L.S.**

**Raymond Belmer**

**17. Firm Experience:**

Identify the team's project experience most relevant to the scope in the advertisement. The projects should be limited to a total of 20, with no more than 5 projects being represented by the prime consultant and with no more than 3 projects represented by each sub-consultant on the team. If more than 5 projects are identified for the prime consultant, all projects identified after the first 5 will not be evaluated. If more than 3 projects are identified for a single sub-consultant, all projects identified after the first 3 from that sub-consultant will not be evaluated. Include no more than one page per project. Projects identified shall only include work performed by firms on the team. The projects identified do not necessarily need to have been DOTD projects

Firm name	<b>GOTECH, Inc.</b>		Past Performance Evaluation Category(ies)*	<b>Survey</b>
Project name	<b>I-10 (LA 30 to LA22)</b>		Firm responsibility (prime or sub?)	<b>Sub</b>
Project number	<b>H.007855.5</b>	Owner's name	<b>LADOTD</b>	
Project location	<b>Ascension Parish, LA</b>		Owner's Project Manager	<b>Mark Chenevert</b>
Owner's address, phone, email	1201 Capitol Access Road, Room 405-E, Baton Rouge, LA 70802-4438, 225-379-1591, <a href="mailto:mark.chenevert@la.gov">mark.chenevert@la.gov</a>			
Services commenced by this firm (mm/yy)	<b>10/12</b>	Total consultant contract cost (\$1,000's)		<b>\$209</b>
Services completed by this firm (mm/yy)	<b>12/13</b>	Cost of consultant services provided by this firm (\$1,000's)		<b>\$209</b>

Describe the project including the firm's role and members involved. (Highlight staff to be used in this proposal.)

GOTECH conducted the topographic, elevation and utility survey for the 5-mile-long I-10 corridor between LA Hwy 73 and LA Hwy 22 in Ascension Parish. The project involved the widening of I-10 from a 4-lane freeway section to a 6-lane freeway section. GOTECH survey personnel tied into control points provided by the Louisiana DOTD and used the horizontal and vertical data as the basis for the survey. GOTECH surveyed the right-of-way limits so that the existing centerline could be established. Cross sections were surveyed at 100-foot intervals from 65' inside the inner shoulder to 50' beyond the other shoulder on both the eastbound and west bound travel lanes. GOTECH also surveyed utility line markings and test holes for items such as water lines, gas lines, electrical lines, pipelines and fiber optic lines. Information was also obtained in the field for bridges such as project stationing for bent centerlines, joint openings, elevations of slab corners, elevations of bent tops, piling size and location, column size and bridge geometry. Additionally, all topographic features in the project area were surveyed. GOTECH was the Subconsultant to Sigma Consulting Group, Inc.

**Personnel worked on this project and used in this proposal**

**Rhaoul Guillaume, Sr. P.E.**

**Bruce Dyson, P.E., P.L.S.**

**Rob Price, P.L.S.**

**Raymond Belmer**

### 17. Firm Experience:

Identify the team's project experience most relevant to the scope in the advertisement. The projects should be limited to a total of 20, with no more than 5 projects being represented by the prime consultant and with no more than 3 projects represented by each sub-consultant on the team. If more than 5 projects are identified for the prime consultant, all projects identified after the first 5 will not be evaluated. If more than 3 projects are identified for a single sub-consultant, all projects identified after the first 3 from that sub-consultant will not be evaluated. Include no more than one page per project. Projects identified shall only include work performed by firms on the team. The projects identified do not necessarily need to have been DOTD projects

Firm name	<b>GOTECH, Inc.</b>		Past Performance Evaluation Category(ies)*	<b>Survey</b>
Project name	<b>Acadian Rd Roundabout, Route LA 20 (Canal Blvd) &amp; Local Routes (Back Street, Jackson Street, Thompson Place)</b>		Firm responsibility (prime or sub?)	<b>Sub</b>
Project number	<b>4400004485; H..009320</b>	Owner's name	<b>LADOTD</b>	
Project location	<b>Thibodaux, LA</b>		Owner's Project Manager	<b>Mark Chenevert</b>
Owner's address, phone, email	1201 Capitol Access Road, Room 405-E, Baton Rouge, LA 70802-4438, 225-379-1591, <a href="mailto:mark.chenevert@la.gov">mark.chenevert@la.gov</a>			
Services commenced by this firm (mm/yy)	<b>04/15</b>	Total consultant contract cost (\$1,000's)	<b>\$204</b>	
Services completed by this firm (mm/yy)	<b>09/19</b>	Cost of consultant services provided by this firm (\$1,000's)	<b>\$195</b>	

Describe the project including the firm's role and members involved. (Highlight staff to be used in this proposal.)

GOTECH, Inc. provided a complete topographic survey required for the design of a roundabout at the existing intersection located in Thibodaux, LA. The survey was completed in accordance with LADOTD Standards and included all utilities with depths, all drainage structures, and DTM for the survey area. The project survey control and horizontal alignment was based on the Louisiana State Plane Coordinate System, (NAD-83-92) as determined by G.P.S. observation. The project also included right-of-way surveys and the preparation of right-of-way maps.

#### Personnel worked on this project and used in this proposal

**Rhaoul Guillaume, Sr. P.E.**

**Rob Price, P.L.S.**

**Raymond Belmer**

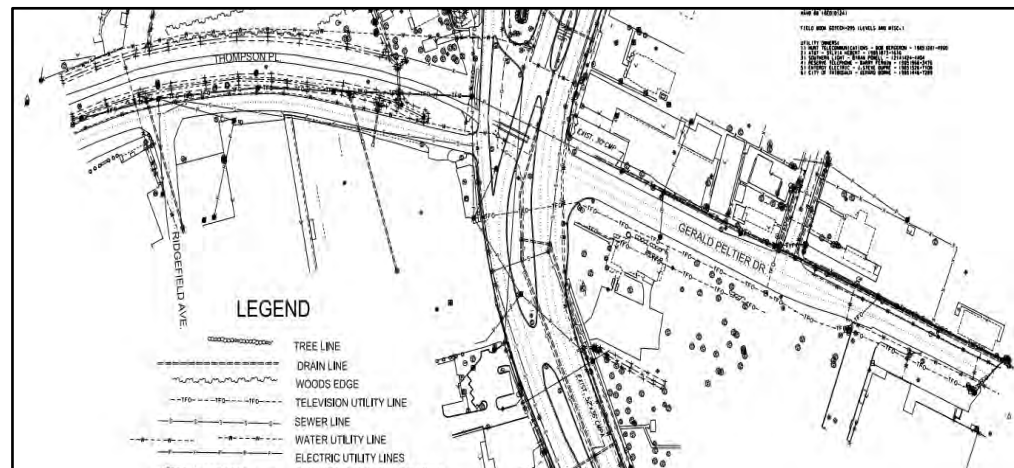



**17. Firm Experience:**

Identify the team's project experience **most relevant** to the scope in the advertisement. **The projects should be limited to a total of 20, with no more than 5 projects being represented by the prime consultant and with no more than 3 projects represented by each sub-consultant on the team. If more than 5 projects are identified for the prime consultant, all projects identified after the first 5 will not be evaluated. If more than 3 projects are identified for a single sub-consultant, all projects identified after the first 3 from that sub-consultant will not be evaluated.** Include no more than one page per project. Projects identified shall only include work performed by firms on the team. The projects identified do not necessarily need to have been DOTD projects

Firm name	<b>A P S Engineering and Testing, LLC</b>		Past Performance Evaluation Discipline(s)*	<b>Other (Testing)</b>
Project name	<b>Westwood Drive (WB Expressway to Lapalco)</b>		Firm responsibility (prime or sub?)	<b>SUB</b>
Project number	<b>H.011670</b>	Owner's name	<b>DOTD</b>	
Project location	<b>Orleans Parish</b>		Owner's Project Manager	<b>Fritz C. Lua</b>
Owner's address, phone, email	Design Engineering, Inc. 330 W. Esplanade Ave. Suite 205, Metairie, LA, 504.836.2155, <a href="mailto:flua@dei-engr.com">flua@dei-engr.com</a>			
Services commenced by this firm (mm/yy)	<b>04/19</b>	Total consultant contract cost (\$1,000's)		<b>N/A</b>
Services completed by this firm (mm/yy)	<b>09/20</b>	Cost of consultant services provided by this firm (\$1,000's)		<b>\$80</b>

Describe the project including the firm's role and members involved. (Highlight staff to be used in this proposal.)

ApS provided the QA for material testing services representing DOTD. As the QA testing lab, APS conducted all laboratory and field tests for approval of soil, compaction tests, and concrete testing. This included over hundreds of sieve analysis, gradation, proctors, concrete cylinders breaks, field compaction, and concrete pour monitor. APS also entered test results into SiteManager.

**Personnel worked on this project and used in this proposal:**

**Sergio Aviles, P.E.**  
**Sai Eddanapudi, M.E., P.E.**  
**David Wilson**



### 17. Firm Experience:

Identify the team's project experience most relevant to the scope in the advertisement. The projects should be limited to a total of 20, with no more than 5 projects being represented by the prime consultant and with no more than 3 projects represented by each sub-consultant on the team. If more than 5 projects are identified for the prime consultant, all projects identified after the first 5 will not be evaluated. If more than 3 projects are identified for a single sub-consultant, all projects identified after the first 3 from that sub-consultant will not be evaluated. Include no more than one page per project. Projects identified shall only include work performed by firms on the team. The projects identified do not necessarily need to have been DOTD projects

Firm name	A P S Engineering and Testing, LLC		Past Performance Evaluation Discipline(s)*		Other/Materials and field testing
Project name	I-10: Highland to LA 73			Firm responsibility (prime or sub?)	Sub
Project number	H.009250	Owner's name	Louisiana Dept of Transportation and Development		
Project location	East Baton Rouge and Ascension Parishes, LA		Owner's Project Manager	Peggy Paine, P.E.	
Owner's address, phone, email		1201 Capitol Access Rd., Baton Rouge, La. 70802-4438225-379-1001; Peggy.Paine@la.gov			
Services commenced by this firm (mm/yy)		04/18	Total consultant contract cost (\$1,000's)		N/A
Services completed by this firm (mm/yy)		01/20	Cost of consultant services provided by this firm (\$1,000's)		\$400k

Describe the project including the firm's role and members involved. (Highlight staff to be used in this proposal.)

APS provided QA testing services as subconsultant to ECM for this project involving widening of I-10 and rehabilitation of several bridges. APS served as the Construction Quality Acceptance Laboratory Manager (CQALM) for this project. Work included elevated and on-grade roadway including earthwork, subbase and base and PCC pavement. APS provided lab testing of soil samples, made concrete cylinders at site and performed slump tests, performed field compaction testing for subbase and base courses, performed lab tests for concrete cylinder breaks etc.

The Construction Quality Acceptance Laboratory Manager (CQALM) duties and responsibilities included:

- QA testing and reporting of laboratory and field test results.
- Document and notify the CQAM immediately of any non-conformance test results
- Responsible for adherence to proper CQA laboratory testing and sampling procedures.
- Coordinate testing needed with the CQAM and/or CQAI Field Supervisor.
- Responsible for the distribution of laboratory test results to all within one working day of results being recorded

#### Personnel worked on this project and used in this proposal:

**Sergio Aviles, P.E. , Sai Eddanapudi, P.E., Donna Easterly**





## **18. Approach and Methodology:**

Provide a description of how the work will be performed and provide the proposed project schedule. Include any additional information or description of unique resources that are planned to be used to produce the deliverables. Include any proprietary technologies, methods or approaches that will be used on this project to improve quality or efficiency. If the proposal is for an IDIQ contract, the consultant should review the scope of services in Attachment A to the advertisement to obtain a general understanding of what a typical task order would entail. Based upon that understanding, the consultant should provide a sample schedule that identifies the major milestones, deliverables, tasks, etc., to demonstrate sufficient understanding of a typical task order. The duration of the task order is not required. This section shall be limited to four pages. If more than four pages are included, all pages after the fourth page will not be evaluated.

### **1. Project Understanding**

We understand that this IDIQ contract is for CE&I services for Safety Projects, Statewide with majority of work in District 02, 61 & 62 under which separate task orders will be issued, each of which will specify scope of services, contract time and compensation. Under these task orders, we will perform, but not limited to, the items listed in the RFQ. Some of the major items will include maintenance of field records; daily entries into project diary to include contractor personnel and equipment being utilized, work being performed, the acceptability of traffic control, contract time charged; keeping record of quantities of contract items placed; inspection of contractor's daily operations for compliance with contract plans, specifications and approved materials; keeping clear and concise records of contractual operations; preparing daily/weekly/monthly quantity summaries/breakdowns; daily progress reports and entering all data and documents in SiteManager daily. We also understand that from now on all CE&I projects will require use of Headlights software. ECM engineers and inspectors have been using Headlights software for over two years for several major DOTD construction projects. ECM engineers and inspectors are also trained by Headlight developer and are proficient in using the same.

ECM Team, the best-in-class, includes 1) Arcadis, 2) GoTech and 3) APS Engineering and Testing, in providing CE&I services for various safety projects including roadways restorations and new constructions. ECM Team members understand the nature of the various potential projects that will be scattered all over the State mostly in districts 02, 61 and 62 and importance of communication and coordination between DOTD and the stakeholders to keep them abreast of project status.

ECM has and is currently providing CE&I services for safety projects in the various districts under existing IDIQ contracts. ECM Team personnel are fully aware of the policies, procedure and DOTD's demand for delivering quality projects on time and on budget. Accurate and timely flow of information between the project team, the contractor and DOTD will aid the contractor in completion of the project successfully. The ECM Team utilizes all the current DOTD software as is described below and is prepared to work the contractor's working hours which may include night work for off peak traffic times and hauling and delivery of material. This experienced team can categorize issues, respond to those issues in the field which can be handled and understands when the issues that should be elevated. The experienced ECM staff can react quickly to those construction challenges encountered during construction which will allow quick responses to the contractor and mitigate schedule delays. The ECM team is positioned to provide exceptional CE&I services for safety projects to the DOTD as has been demonstrated by previous projects for the DOTD on other safety and roadway projects.

### **2. Our Approach for Performance**

The ECM Team will perform all the tasks listed in the RFQ as well as additional tasks when assigned by DOTD for successful completion of this project, meeting, and exceeding industry best practices and to the satisfaction of DOTD.

The ECM Team's construction administration and construction engineering and inspection (CE&I) services approach places highly qualified and knowledgeable personnel on the project site with support from office engineering/technical staff. The key management tool used to successfully accomplish the work will be a plan comprised of elements such as the Project Management and Execution Plan, Cost and Schedule Controls, Effective Communication, Coordination, Cooperation (C3) between all parties, Reporting Processes, QA/QC and Safety. The fundamental objective of our CE&I services is to serve as "Eyes and Ears" of DOTD and effectively manage the quality, cost, schedule, and safety to assure that all the projects are completed on time and within budget meeting the expectations of DOTD.

#### **2.1 Construction Engineering and Inspection (CE&I)**

The ECM team offers staff which has extensive broad experience with DOTD construction engineering and inspection procedures on roads, bridges, and safety enhancement construction projects, as shown in our project description and the resumes of our staff. Because our staff is already trained and experienced on Site Manager, ProjectWise,

LAPAVE and Headlight applications now being used by DOTD, the team has an **enhanced ability** to provide updates on the progression of the projects. By using Headlight, timely updates can be given to DOTD since Daily Work Reports (**DWR**) will include pictures of ongoing work progress, and as **Site Manager Materials** becomes part of Headlight, this will further streamline the process. The Team's highly experienced Project Engineers, Assistant Project Engineers and certified Inspectors will be on site and will observe, monitor, record and report all construction activities regarding conformance, quality, workmanship, and safety compliance and will communicate with DOTD Project Engineer/Coordinator daily to ensure that the project is constructed in strict compliance with contract documents and meeting DOTD standards and requirements. They will monitor progress by tracking contract time and review of the base **CPM schedule** and schedule updates and all recovery schedules for slippage of milestones. Our on-site project team members will review monthly estimates, comparing with quantities of work recorded in the DWRs. Any discrepancies will be brought to the attention of contractor for resolution. While construction layout will be performed by the contractor, ECM's Louisiana licensed surveyor and **GoTech's survey team** will spot check layouts and elevations **for verification**. Our Project Engineer will coordinate with DOTD Project Engineer, the contractor, the District Laboratory, and the District Utility Coordinator to set up a pre-construction meeting prior to starting the project.

As outlined in the Attachment A- Scope of Services of the RFQ, a traditional CE&I project, in general, will include the major items as graphically presented below:

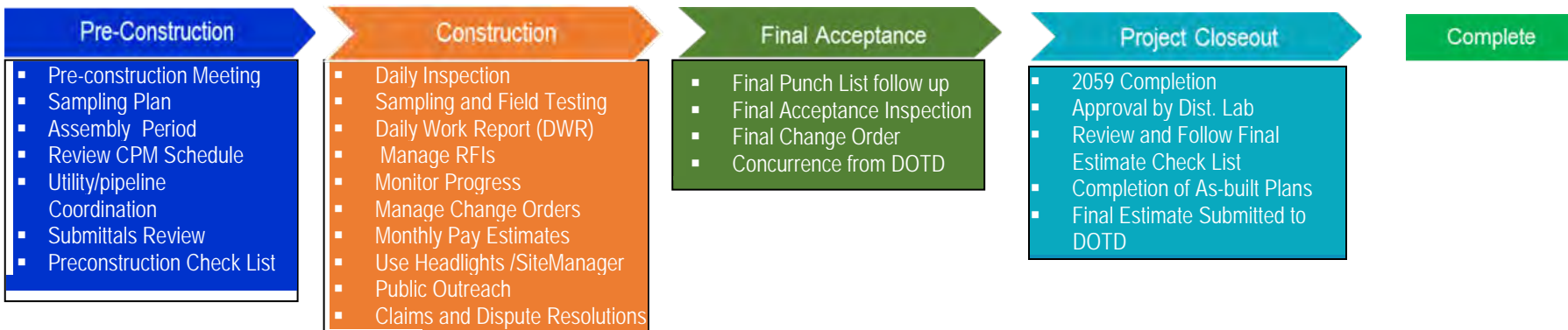

Below is a brief overview of how some of the major tasks will be performed

#### 2.1.1 Pre-construction Meeting

ECM's **Project Engineer** will schedule and invite the DOTD Project Manager and the Project Coordinator, the District Lab Engineer, a Representative of FHWA, the Contractor, Utility Company Representatives, City/Parish Representatives, ECM's Project Manager, Assistant Project Engineer, Lead Inspector (s), and assigned LADOTD certified Inspectors. ECM's Project Engineer will be responsible to take notes, prepare and distribute Minutes of Meeting (MoM) to all.

#### 2.1.2. Sampling and Field Testing

The Project Engineer will prepare a Sampling Plan in accordance with the Materials Sampling Manual for the project **unless** a sampling plan is prepared by DOTD District Lab and provided at Pre-Construction meeting. Field sampling will be performed by ECM team and will be promptly entered into **SiteManager**. The ECM Team Project Engineer will enter and ensure that all Material Test results are documented in **LAPAVE**, **SiteManager Materials**, **Headlight** and/or other DOTD software systems. APS Engineering and Testing, LLC. will perform field testing and perform Material Testing for acceptance of materials when not performed by the District Lab.

#### 2.1.3 Daily Work Reports

The ECM Team Inspector (s) will complete DWR's daily according to DOTD Policies and Procedures. Our staff is aware of the importance of noting all important items such as charged days, controlling work items, contractor's equipment on site, personnel, and work activities. Special attention will be given to **documenting deficiencies, non-conforming and non-standard works, safety issues**, any unusual incidents and communication with the contractor, DOTD and other project team personnel at the site. The team's inspectors will document and enforce requirements of the Storm Water Pollution Prevention Plan (**SWPPP**) and any other requirements of permits from CPRA, DEQ, USACE and Coast Guard as applicable. Our certified inspectors will enter completed quantity of pay items and work progress daily. The team will also ensure that the contractor is **completing required traffic control logs on a daily basis**.

#### 2.1.4 Monitor Progress

Adherence to schedule is critical to the project success. The majority of the projects in various districts specially in school zones may draw some public attention and scrutiny. Our experienced Project Engineer in consultation with CPM Scheduler will monitor progress compared to the contractor's baseline schedule as well as schedule updates. He will communicate with DOTD Coordinator/ Project Engineer to request contractor to provide recovery schedule every time a milestone is slipped. Accurate CPM scheduling will be critical to be able to keep up with time charges, weather delays, potential extra work, liquidated damages, and communication of project timelines with DOTD personnel.

#### 2.1.5 Reporting deficiencies

The ECM team's Project Engineer will address deficiencies, deviations, non- standard and non-conforming work that is performed by the contractor and not rectified after notification by ECM staff. ECM staff will document the non-conforming work, notify the contractor and simultaneously notify DOTD Project Coordinator and ECM's Project Engineer will **issue NCRs** if matters not resolved after notification.

#### 2.1.6 Monthly Pay Estimates

The ECM Team's Project Engineer will review all monthly pay estimates in **SiteManager** according to the Policies and Procedures of DOTD. Prior to approval of payment for work completed, Project Engineer will make sure that all documentation necessary for DOTD such as all Material Sources have been received and checked to ensure that they are from approved sources and all documentation associated with passing material test results are submitted. The ECM Team's Project Engineer will verify quantities of completed pay items with DWRs.

#### 2.1.7 Change Orders

The ECM Team's Project Engineer will **prepare Change Orders** when necessary, according to DOTD Policy and Procedures. Before preparing any change order, the Project Engineer will discuss with the DOTD Coordinator regarding justification and costs associated with any potential change order. The Project Engineer will complete change order forms explaining the need for the change order and will include required attachments. Approvals from those needed based on the category of the Change order will be obtained.

#### 2.1.8 Public Outreach

We are fully aware of the importance of communication and timely dissemination of information to facility users including vehicular and marine and all stakeholders, the Coast Guard, the DOTD, and the FHWA. All will be fully informed of project status, progress, construction issues and any unusual incidents. The ECM team's staff is familiar with the procedures for project updates or press releases that will require approval from the DOTD Area Engineer and others as needed and will be obtained prior to release of any information. ECM is familiar with the **MyDOTD system** and is experienced in entering traffic and closure notices on the MyDOTD.

#### 2.1.9 Project Closeout

The ECM team's staff under the leadership of the Project Engineer will prepare and coordinate with the District Lab both the 2059 information and the Final pay estimates as the project is being completed and submitted to DOTD Final Audit Section. Information will be gathered and organized as the project progress so that the closeout process will proceed smoothly. Processing of information and coordination of project closeout will begin shortly after completion of the construction to gain final acceptance. We have developed an in-house process where we set up our system of files by work item prior to the project commencement. As the work is completed, we capture copies of all required correspondence, CD's, CC's, Shop drawings, Summary of Test Results, and any other documents necessary to complete **the 2059, "As-built" plans and the Final Estimate**.

#### 2.1.10 Unique Resources and Capabilities

ECM is fully licensed, and FAA cleared to operate **two DJI Mavic Pro Zoom aerial drones** which can be used to capture crystal clear images and video feed from any desired height up to 200 ft that will be used for taking high resolution **construction progress aerial photographs** and send to the DOTD Project Coordinator. This information will assist in resolution of field issues in a timely manner. The ECM team will be provided with **iPad with Headlight** and other software with synchronizing capability with SiteManager, SiteManager Material and LAPAVE. All our field staff will have wireless internet connections for accessing DOTD data base. The team's authorized personnel will access/upload plans/documents to the **DOTD ProjectWise** as we are doing this for other major DOTD projects.

#### 2.1.11 Project Plan and Priorities:

The ECM Team **gives high importance** to the following items as major factors for success of the construction projects:

**Dispute Resolution:** It is prudent to take **proactive approach** for disputes and/or claims management. It is important to resolve issues as soon as possible at the lowest level and while all the parties are on the job. Meaning that it is lot easier to resolve issues with person(s) who are knowledgeable of the issues and present them and assist the DOTD Project

Coordinator to resolve any potential claims timely. This will require documentation including construction records, progress photographs logged in chronological order with activity descriptions, and maintenance of records of all communication between various parties including emails and letters. Our role will be to take proactive approach to resolve potential change orders/ claims before they occur.

**Staffing Plan:** Based on our past experience, we estimate the staffing requirements for a typical safety and related road projects will be: One Project Engineer; Certified Lead Inspector, Certified inspector (on as needed basis) for: Embankment and Base Course Inspectors; PCC Paving Inspectors, Asphalt Paving Inspector, Structural Concrete Inspector. We will use only required certified inspector(s) depending on type of construction. The ECM will submit a work hour proposal within 30 days following the notification of selection as required. We will download project plans, the construction contract and project schedule etc. from ProjectWise if available, review them and then prepare a staffing plan for each Task Order detailing category and number of personnel and their potential duration to form the basis of our labor estimates and fee proposal to DOTD. Since this is a 5-year Retainer Contract, our assigned project manager will serve for the entire duration of the contract for continuity. Also, for continuity, we will have one of our Project Engineer works closely with the PM so that he/she can manage the projects in the absence of the PM. Additionally, all our management personnel will be actively involved in every project, keep themselves abreast of the project status and will be able to provide support, when necessary. Our organization chart provides an overview of our staffing plan.

**DOTD Liaison:** Our experience working on DOTD construction projects has taught us that communication with all parties is the most important part of making a project successful. We know that the DOTD Project Coordinator has dealt with similar projects and understands that there will be issues during construction. As a result of their past involvement in similar types of projects, DOTD may have developed solution for some of the issues in conjunction with design consultant which may potentially reduce time for approval process.

**Quality Control/Quality Assurance Plan:** We will prepare and submit a detailed QA/QC Plan for CE&I services conforming to DOTD requirements, after contract award. The plan will include a systematic and consistent review of all contracted services and help assure standardization and quality of construction inspection services. The QA/QC Plan will be flexible, to respond to changes in required services and ensure a smooth flow of information and document control, while maintaining the highest possible level of accuracy, value, quality, and competency. Our QA process will include periodic audits to verify all quality control procedures are in place and adhered to. Our Project Engineer will be responsible for implementing the process, monitoring performance of field personnel, and monitoring progress, schedule, and cost.

### 3. Project Schedule

The below is a Basic Schedule as an example of a typical Safety Project with roadway restoration Task Order. Duration: Assembly: 30 days, Construction 120 days, Final acceptance 30 days, Close out 30 days. Start date: Jan 1, 2023, End Date: July 31, 2023

	Task Name	Start	Finish	2023						
				Jan	Feb	Mar	Apr	May	Jun	Jul
1	Pre-Construction/Assembly	Sun 1/1/23	Mon 1/30/23							
2	Construction	Wed 2/1/23	Tue 5/30/23							
3	Sidewalk, ADA Ramps, Driveways, Drainage, etc.	Wed 2/1/23	Fri 3/31/23							
4	Roadway Restoration, Signals, Crosswalks, Signage, etc.	Sat 4/1/23	Tue 5/30/23							
5	Final Acceptance	Thu 6/1/23	Fri 6/30/23							
6	Project Closeout	Sat 7/1/23	Mon 7/31/23							

**Why ECM Team?** 1. We have extensive experience in providing construction contract administration and CE&I services to DOTD. 2. We have qualified and experienced staff in all required disciplines to meet any challenges. 3. Excellent past performance record with DOTD. 4. Ample capacity to provide required numbers of engineers and certified inspectors and state of the art equipment and software. 4. Capability to provide quality service with experience in similar projects. 5. "Can do team" poised to accept challenges that may be encountered during construction; and 6. Most importantly, Integrity, Reliability, Dedication and Enthusiasm to deliver high-quality CE&I services to the DOTD. We thank you for the opportunity to submit our qualifications and hope to receive your favorable

**19. Workload:**

For all contracts where a firm on the team is a prime consultant or sub-consultant and where a) the consultant selection was made by DOTD, and b) a contract was executed by the consultant and the contracting entity by the date the advertisement for this proposal was posted, list all work meeting the following criteria:

- 1) one of the team's firms is responsible for the performance of the work;
- 2) authorization to perform the work has been provided, as provided in the contract between the consultant and the contracting entity;
- 3) the work has not yet been performed and invoiced; and
- 4) the work is not currently suspended for an indefinite period of time.

For indefinite delivery/indefinite quantity (IDIQ) contracts, list open Task Orders individually.

List only the portion of the fees attributable to firms on the team.

Firm	Work type(s)*	State project number	Project name and location	Remaining unpaid balance**
ECM	CE&I/OV	H.011767.6-1	Retainer Contract for Construction Engineering Management & Staff Augmentation Services for District 61, West Feliciana, East Feliciana, Pointe Coupee, West Baton Rouge, East Baton Rouge, Iberville, Ascension, St. James & Assumption Parishes ( <i>Bayou Crab Road Bridge Assumption Parish</i> )	\$29,533
ECM	CE&I/OV	H.013579.6	Retainer Contract for Construction Engineering Management & Staff Augmentation Services for District 61, West Feliciana, East Feliciana, Pointe Coupee, West Baton Rouge, East Baton Rouge, Iberville, Ascension, St. James & Assumption Parishes ( <i>DOTD I-10 Pecue Lane I-10 Interchange Phase II</i> )	\$48,753
ECM	CE&I/OV	H.013114.6	Retainer Contract for Construction Engineering Management & Staff Augmentation Services for District 61, West Feliciana, East Feliciana, Pointe Coupee, West Baton Rouge, East Baton Rouge, Iberville, Ascension, St. James & Assumption Parishes ( <i>Southern University Erosion Road Improvements</i> )	\$205,870
ECM	CE&I/OV	H.013606.6	Retainer Contract for Construction Engineering Management & Staff Augmentation Services for District 61, West Feliciana, East Feliciana, Pointe Coupee, West Baton Rouge, East Baton Rouge, Iberville, Ascension, St. James & Assumption Parishes ( <i>Low-Cost Safety Improvements Ph. 2</i> )	\$76,668
ECM	CE&I/OV	H.014747.6	Retainer Contract for Construction Engineering Management & Staff Augmentation Services for District 61, West Feliciana, East	\$311,809

Prime consultant name: *ECM Consultants, Inc.*



			Feliciano, Pointe Coupee, West Baton Rouge, East Baton Rouge, Iberville, Ascension, St. James & Assumption Parishes ( <i>Southern University Ravine Protection</i> )	
ECM	Other/CQCM	H.003370	I-220/I-20 Interchange Imp & Barksdale Airforce Base (BAFB) Access Road. Design-Build Project. Bossier Parish, LA	\$619,901
ECM	Other/CQCM	H.0044791	Belle Chasse Bridge & Tunnel Replacement Public-Private Partnership Project	\$3,850,988
ECM	CE&I/OV	H. 009175.6	IDIQ CE&I for Safety Projects Statewide with Majority of Work in District 03, 07, and 08 ( <i>St. Bernard Signing and Striping Local Road Safety Program</i> )	\$42,193
ECM	CE&I/OV	H.011949.6	IDIQ CE&I for Safety Projects Statewide with Majority of Work in District 03, 07, and 08 ( <i>RWD Signing Plaquemines Parish Local Road Safety Program</i> )	\$154,549
ECM	CE&I/OV	H.012682.6	IDIQ CE&I for Safety Projects Statewide with Majority of Work in District 03, 07, and 08 ( <i>Pedestrian Crosswalk Enh [NO PH2]</i> )	\$419,469
ECM	CE&I/OV	H.006528.6	IDIQ CE&I for Safety Projects Statewide with Majority of Work in District 03, 07, and 08 ( <i>Fenton Elementary Sidewalks</i> )	\$54,667
ECM	CE&I/OV	H.007233.6	IDIQ CE&I Inspection Services Statewide with Majority of Work in District 03 ( <i>Lafayette MPO Non-State Pavement Marking Lafayette Parish</i> )	\$120,847
ECM	CE&I/OV	H.0123936	IDIQ CE&I Inspection Services Statewide with Majority of Work in District 03 ( <i>LA 98 Roundabout at Mills St. Route LA 98</i> )	\$451,604
ECM	CE&I/OV	H.018767.6	IDIQ CE&I Inspection Services Statewide with Majority of Work in District 03 ( <i>Jude &amp; Placid Road Bridges, Vermillion Parish</i> )	\$395,428
ECM	CE&I/OV	4400020842 Task Order 1	IDIQ Contract for Engineering & Inspection of State Regulated Dams with Majority of work in District 03, 07, 61, & 61 Statewide	\$62,094
ECM	CE&I/OV	H.008145.6	LA1 Leeville to Golden Meadow	\$10,491,579
Arcadis	Environmental	H.002397.2	LA 16 (Pete's Hwy) Interstate 12 Interchange Route	\$20,109
Arcadis	Environmental	H.011328.2	I-49 South (Ricohoc to Berwick)	\$828,788
Arcadis	Traffic	H.011328.2	I-49 South (Ricohoc to Berwick)	\$176,056
Arcadis	Road	H.011328.2	I-49 South (Ricohoc to Berwick)	\$353,273
Arcadis	ITS	H.013868.5	ITS Program Management and Operations (2021)	\$171,274

Prime consultant name: *ECM Consultants, Inc.*



Arcadis	ITS	H.013868.6 (A)	ITS Routine Maintenance Engineering and Inspection (ME&I) (2021)	\$75,276
Arcadis	ITS	H.013868.6 (B)	ITS Responsive/Emergency Maintenance Engineering and Inspection (ME&I) (2021)	\$49,298
Arcadis	ITS	H.013868.5	ITS Program Management and Operations (2022)	\$668,651
Arcadis	ITS	H.013868.6 (A)	ITS Routine Maintenance Engineering and Inspection (ME&I) (2022)	\$674,471
Arcadis	ITS	H.013868.6 (B)	ITS Responsive/Emergency Maintenance Engineering and Inspection (ME&I) (2022)	\$154,105
Arcadis	ITS		PO No. 2000588785 Scott Tower Cable and Grounding Repair, PO No. 2000609725 I-10 @ Louisiana Ave CCTV & Elec Repair, PO No. 2000610683 I-110 @ US61 Mini-Split AC Install, PO No. 2000620009 LA 3040 @ Hollywood Rd Elec Serv. Install, PO No. 2000617303 I-10 @ Picardy CCTV Upgrade, PO No. 2000617304 US 61 @ Greenwell Springs Bluetoad Install, PO No. 2000634022 I-60 @ Canal CCTV Upgrade, PO No. 2000634027 I-20 @ I-220 CCTV Repair For The Site in Shreveport, LA, PO No. 2000635990 LaPlace Microwave Tower CCTV Install, PO No. 2000635996 I-10 @ Claiborne DMS Electrical Service Vandalism Repair, PO No. 2000644636 I-10 @ LA 22 DMS CCTV Install	\$52,200
Arcadis	CE&I/OV	H.011220.6-1	I-10 CBD2 Carrollton-Lafitte Ave and Supplement No. 1	\$120,499
Arcadis	CE&I/OV	H.012876.6	US 90Z (I-10 Magnolia Street) Supplement No. 1	\$36,153
Arcadis	CE&I/OV	H.013710.6	I-10. US 61 to Laplace ITS Deployment	\$542,651
Arcadis	Environmental	H.009932	US 80 Widening. Vancil Road to Well Road Environmental Assessment	\$5,343
Arcadis	Traffic	H.003370	I-220/I-20 Interchange IMP & BAFP Access Design Build	\$15,000
Arcadis	Traffic	H.004100.5	I-10. LA 415 to Essen Lane on I-10 and I-12	\$774,686
Arcadis	Bridge	H.004100.5	I-10. LA 415 to Essen Lane on I-10 and I-12	\$1,424,422
Arcadis	ITS	H.004100.5	I-10. LA 415 to Essen Lane on I-10 and I-12	\$299,878
Arcadis	Traffic	H.005121	LA 1/LA 415 Connector	\$108,947
Arcadis	Traffic	H.972419.1	SHSP Update and Regional SHSP Marketing/Advertising Support	\$31,557
Arcadis	Road	H.012901.6, H.010634.6	US 90Z (Bodenger Blvd. – Stumpf Blvd.)	\$339,654
Arcadis	Traffic	H.012018.6	Adaptive Traffic Signal Design and Implementation	\$12,608

Prime consultant name: *ECM Consultants, Inc.*

Arcadis	Traffic	H.014305.1	US 61. Cardinal Drive to Bert Street	\$24,979
Arcadis	Traffic	H.013322.1	LA 3040 Feasibility Study	\$80,000
Arcadis	Environmental	H.012891	LA 300 at Bayou LaLoutre	\$12,825
Arcadis	Environmental	H.014215	LA 20 at 40 Arpent Canal and Drainage Canals	\$50,048
Arcadis	Environmental	H.014213	LA 700 at Indian Bayou and Bayou Grand Marais	\$40,179
Arcadis	Environmental	H.014279	LA 35. Drain Canal Near Lawtell	\$32,759
Arcadis	Environmental	H.014278	LA 85. Patout and Drain Canal Bridges	\$39,894
Arcadis	Environmental	H.014276	LA 975. Creek Bridges	\$20,579
Arcadis	Environmental	H.014216	LA 682 at Norris Canal and Unnamed Tributaries	\$48,600
Arcadis	Environmental	H.014241	LA 10 at Mill Creek	\$32,741
Arcadis	Environmental	H.014251	LA 422. Bridge Over Unnamed Stream	\$31,538
Arcadis	Environmental	H.012565	LA 963 at Redwood Creek and Little Redwood Creek	\$14,378
Arcadis	Environmental	H.014257	LA 68 at Karrs Creek	\$33,121
Arcadis	Environmental	H.014253	LA 421 at Thom Creek	\$13,880
Arcadis	Environmental	H.014256	LA 952 at McKowen Creek and Beaver Creek	\$38,383
Arcadis	Environmental	H.014254	LA 955 at Knighton Bayou, Trib. Olive Branch, White Branch, and Chapman Branch	\$55,056
Arcadis	Environmental	H.012061	LA 1 at Lateral W15#7A and Bayou Moreau	\$13,934
Arcadis	Environmental	H.014252	LA 1054 at Tyner Creek	\$11,799
A P S	GEOTECH	H.013127	Retainer Contract for Geotechnical Services	\$53,996.00
A P S	GEOTECH	H.013144	Retainer Contract for Geotechnical Services	\$45,457.00
GOTECH, Inc. (Subconsultant to Volkert, Inc.)	CE&I/OV	Contract No. 4400004631. Task Order No. H.003107.6 *Task Order No. 1 *Task Order No. 2	Retainer Contract for Construction Engineering Management and Staff Augmentation Services for District 62 (St. Helena, Livingston, St. John, Tangipahoa, Washington & St. Tammany Parishes)	\$0 \$171,520
GOTECH, Inc. (Subconsultant to Huval)	Survey	Project No. H.004791	Belle Chasse Bridge & Tunnel Replacement (Plaquemines Parish)	\$40,150
GOTECH, Inc. (Subconsultant to GEC, Inc.)	CE&I/OV	Contract No. 4400017006. Task Order No. H.011670	I-10 / Loyola Interchange Improvements (Jefferson Parish)	\$578,549

Prime consultant name: *ECM Consultants, Inc.*

GOTECH, Inc. (Subconsultant to Hardesty & Hanover, LLC)	CE&I/OV	Contract No. 4400017430. Task Order No. H.001498.6	LA 24 & 316: Company Canal Bridge CE&I (Terrebonne Parish)	\$304,467
GOTECH, Inc. (Subconsultant to WSP)	Planning	Contract No. 4400017327	IDIQ Innovative Procurement & Alternative Delivery Support Services, Statewide	\$74,052
GOTECH, Inc. (Subconsultant to GEC, Inc.)	CE&I/OV	Contract No. 4400019950 Task Order No. H.003003 Task Order No. H.002151	IDIQ Contracts for Construction Engineering & Inspection Services, Statewide w/Majority of Work in District 03 (Acadia, Lafayette, Evangeline, Iberia, St. Landry, St. Martin, St. Mary & Vermilion Parishes)	\$0 \$68,000
GOTECH, Inc. (Subconsultant to GEC, Inc.)	Survey	Contract No. 4400011354 Task Order H.014552.5 Task Order H.014553.5 Task Order H.014556.5 Task Order H.014557.5	IDIQ Electrical LA 31: I-49 Interchange Lighting District 03 (Lafayette)	\$0 \$0 \$27,538 \$48,690
GOTECH, Inc. (Subconsultant to R.C. Lambert Consultants, LLC)	CE&I/OV	Contract No. 4400019550 SPN: H.001234	LA 1: Port Allen Canal Bridge Replacement Phase 1 (HBI) (CE&I) Route LA 1 (West Baton Rouge Parish)	\$787,337
GOTECH, Inc. (Subconsultant to GEC, Inc.)	CE&I/OV	Contract No. 4400023074 Task Order No. H.010725	IDIQ Contract for Construction, Engineering & Inspection & Staff Augmentation - Pecan Island Rd - District 61 (Hammond)	\$82,736

(Add rows as needed)

**DO NOT SUM**

Prime consultant name: *ECM Consultants, Inc.*

\* The past performance evaluation disciplines to be used are: Road, Bridge, Traffic, CE&I/OV, Geotech, Survey, Environmental, Data Collection, Planning, Right-of-Way, CPM, ITS, Appraiser and Other. If a firm has more than one past performance evaluation discipline for any single project, the firm can use multiple rows to express the remaining unpaid balance per evaluation discipline.

\*\* Round to the nearest dollar. **Do not** round to the nearest thousands. If there are no active contracts with a remaining unpaid balance, place N/A in the Remaining Unpaid Balance column. LEAVING THE “REMAINING UNPAID BALANCE” COLUMN BLANK IS NOT ACCEPTABLE.

Prime consultant name: *ECM Consultants, Inc.*

## 20. Certifications/Licenses:

If the advertisement requires submission of licenses and/or certificates, include them here. Otherwise, leave this section blank.

Louisiana Professional Engineering and Land Surveying Board

**The Louisiana Professional Engineering and Land Surveying Board has the following information on file:**

Name: Public Address:  
ECM Consultants, Inc. Mr. Ujjal DasGupta 1301 Clearview Parkway, Suite 200  
Metairie, Louisiana 70001

### License/Certificate Information w/ Supervision

License	Status	First Issuance Date	Expiration Date	Supervisor(s)
EF.0002003	Active	10/24/1995	03/31/2024	Mr. Ujjal DasGupta # PE.0019849 - Active. Mr. Kazem Hadjialikhani # PE.0025073 - Active

Print

Close

9643 Brookline Avenue | Suite 121 | Baton Rouge, LA 70809-1433  
225-925-6291 | Fax 225-925-6292



## Certifications:

### Kazem Alikhani, P.E.



**Certifications:**  
**Chad Vosburg, P.E.**





**Certifications:**  
**Kim Garlington P.E.**



**Certifications:**  
**Blake Guidry P.E.**





**Certifications:**  
**Zachary Collier, P.E.**

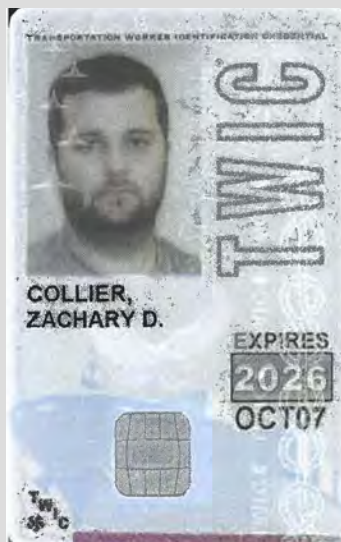



## Certifications: Jules Saunee

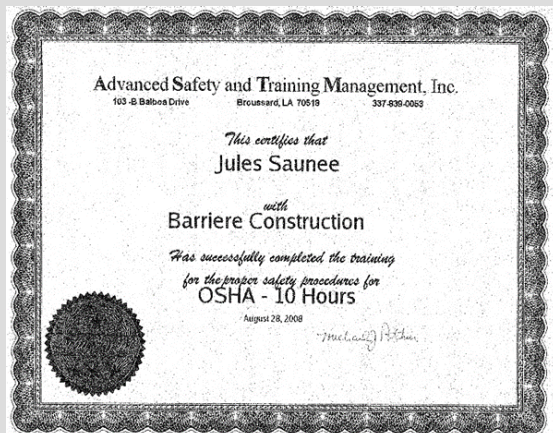
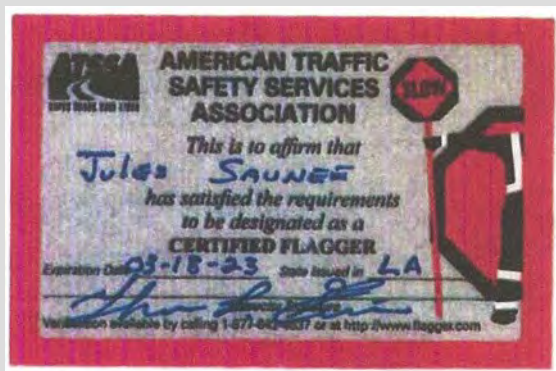

## Certifications: M. David Waller

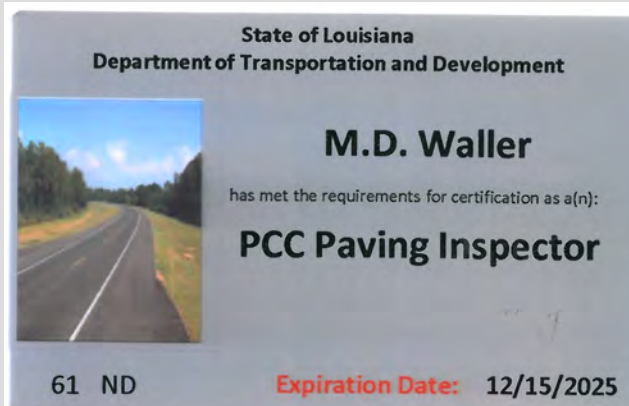
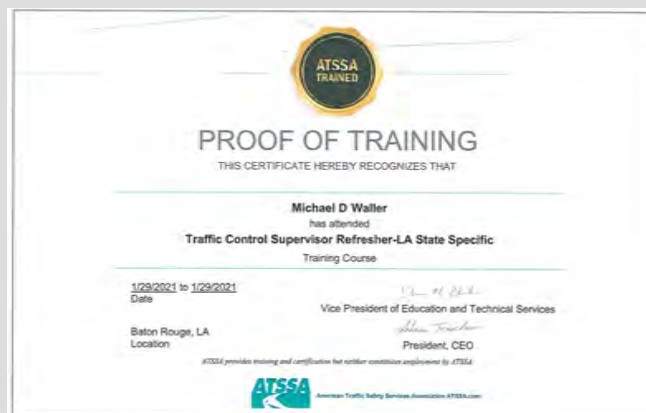



## Certifications: Kim Martinez

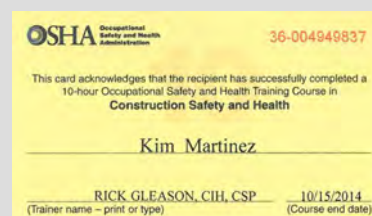

## Certifications: Glenn Eggert

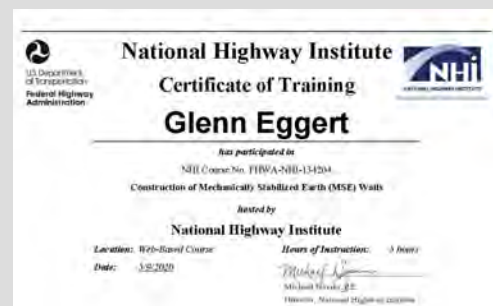
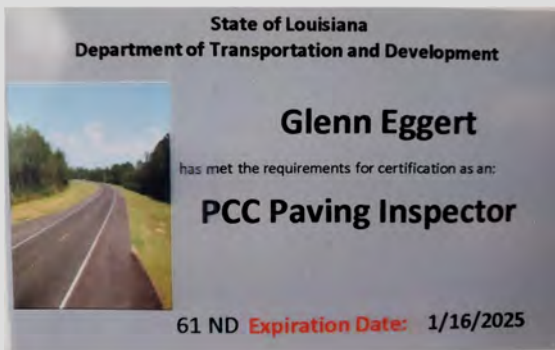



## Certifications: Mansoor Bajwa, E.I.





## Certifications: Tia Youngblood



## Certifications: Mark Sanchez





Certifications:  
Matthew Sigler

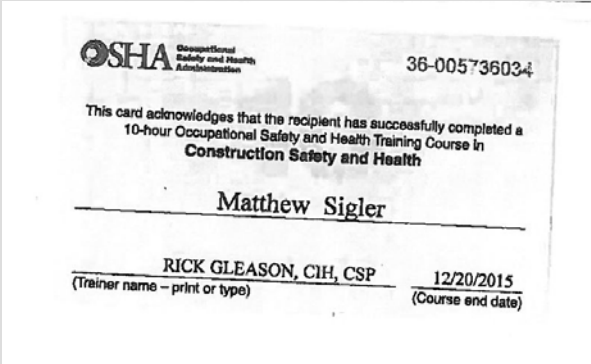
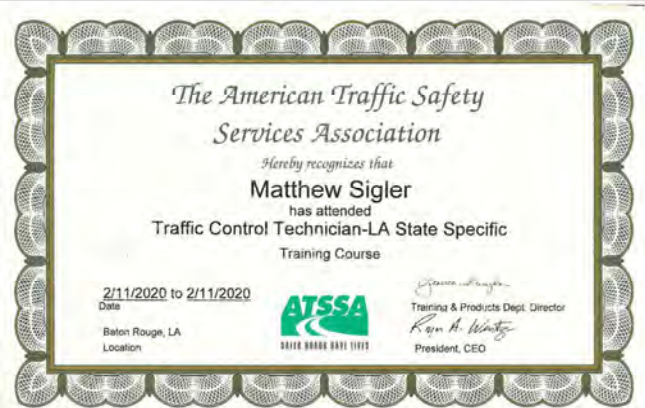

**Certifications:**  
**Anatole Hammer**

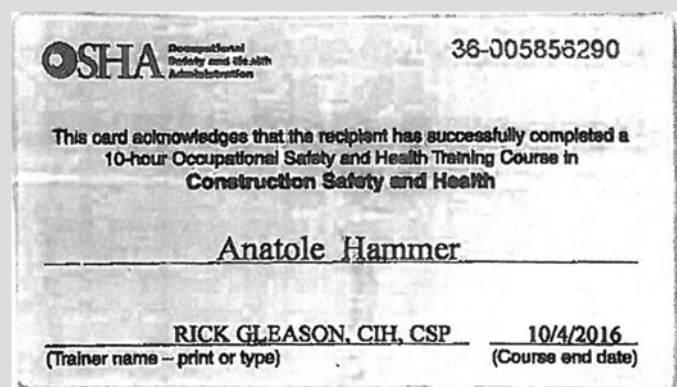
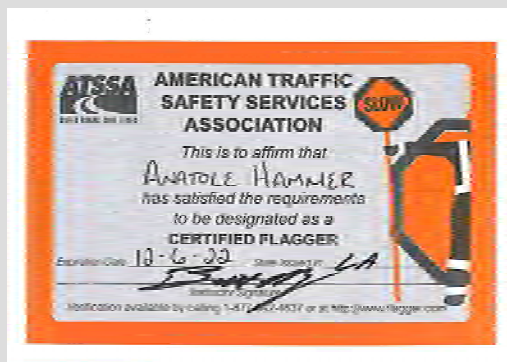



## Certifications: Emilio Rodriguez

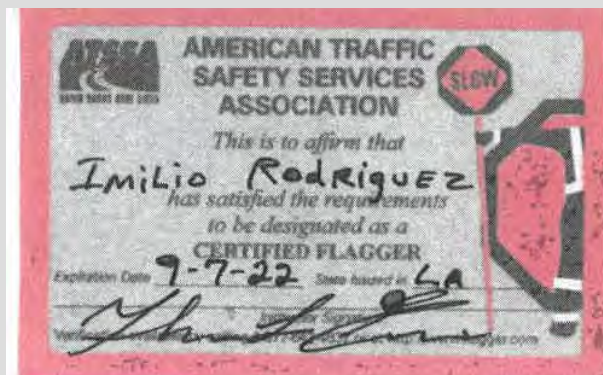



*The American Traffic Safety  
Services Association*

*Hereby recognizes that*

**John Biggs**

has attended

**Traffic Control Supervisor-LA State Specific  
Training Course**

2/6/2019 to 2/7/2019

Date

Baton Rouge, LA



*Jessica S. Hingler*

Training & Products Dept. Director

*Ryan A. Wentz*

President, CEO

*The American Traffic Safety  
Services Association*

*Hereby recognizes that*

**John Biggs**

has attended

**Traffic Control Technician-LA State Specific  
Training Course**

2/5/2019 to 2/5/2019

Date

Baton Rouge, LA

Location



*Jessica S. Hingler*

Training & Products Dept. Director

*Ryan A. Wentz*

President, CEO





June 3, 2019

Dear Moore:

The Certification Board of the American Traffic Safety Services Association (ATSSA) has approved your application for certification as a Traffic Control Supervisor. Enclosed in this packet please find your wallet card, certificate, and an ATSSA TCS patch to be worn on your left shoulder.

This certification shall remain in effect until 2/2/2022. If during this time your employment status, name or address changes, please let us know so we may keep your record current.

You are to be commended for maintaining your knowledge of traffic control issues and fulfilling the requirements for certification. It is not an easy achievement and your accomplishment indicates a dedication to improving the traffic control services you perform. Please call us at 877-642-4637 if we can assist you with any future training needs.

Sincerely,

Training and Business  
Development Department

**Laminating the front of your card with Dual Laminate:**

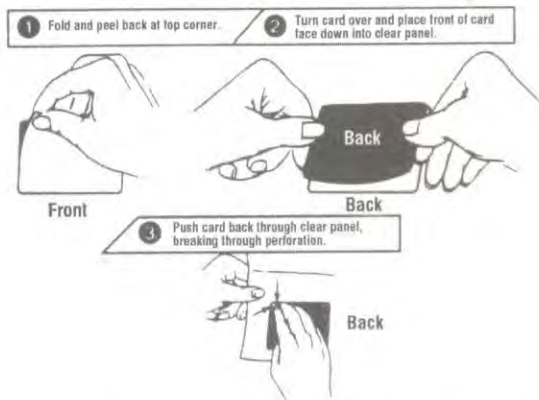

A M E R I C A N   T R A F F I C   S A F E T Y   S E R V I C E S   A S S O C I A T I O N

15 RIVERSIDE PARKWAY ■ SUITE 100 ■ FREDERICKSBURG, VA 22406-1022

TEL (540) 368-1701 ■ FAX (540) 368-1717 ■ TOLL FREE (800) 272-8772 ■ INTERNET [www.atssa.com](http://www.atssa.com)

TRAINING (877) 642-4637



**Tony J. Moore**

is hereby certified as a

**Traffic Signal Technician Level I**

by completing all requirements and examination for certification  
on 9/18/2019

Valid thru 9/18/2022

Certification #AA\_127114

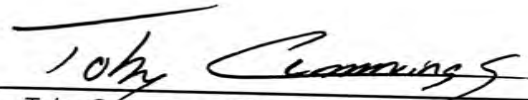
  
Toby Cummings, CAE - Executive Director





**Tony J. Moore**

is hereby certified as a

**Traffic Signal Field Technician Level II**

by completing all requirements and examination for certification  
on 9/18/2019

Valid thru 9/18/2022

Certification #BE\_127114

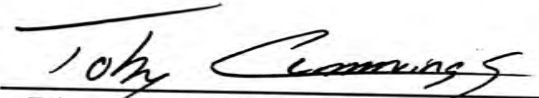
  
Toby Cummings, CAE - Executive Director

# *Certificate of Completion*

presented to

*Tony Moore*

for completing the

## **Traffic Engineering Analysis Process & Report Module 3**

*Date:* January 30, 2020

*Location:* Baton Rouge, Louisiana

*Professional Development*

*Hours (PDHs) Awarded:* 3.5

  
\_\_\_\_\_  
*Authorized Instructor*

  
\_\_\_\_\_  
*Authorized Instructor*

  
\_\_\_\_\_  
*Authorized instructor*





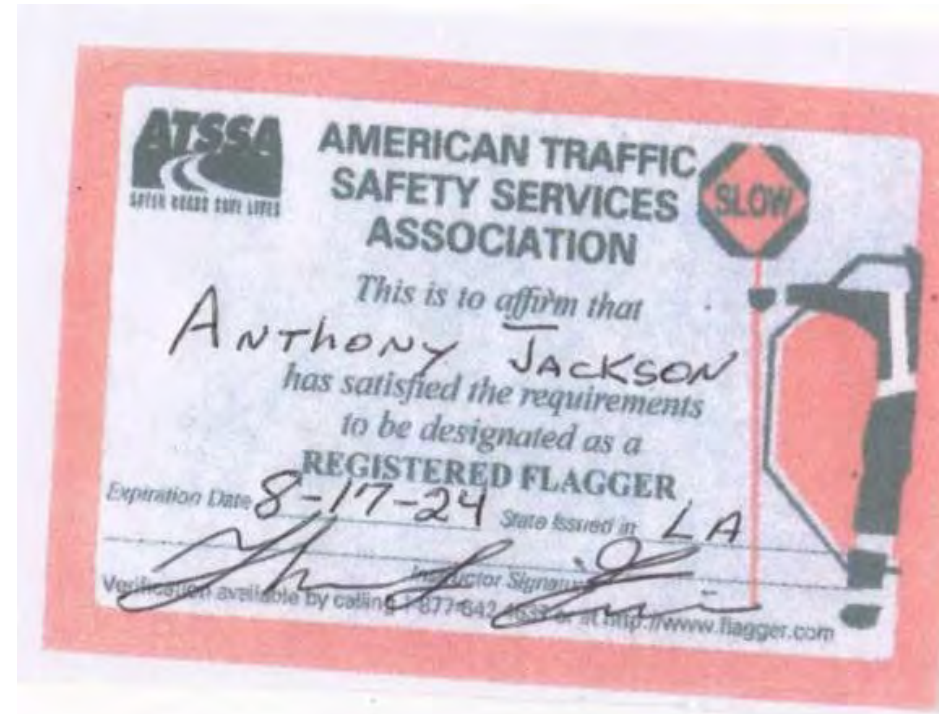















# Training Certificate

P R E S E N T E D T O

*Jeff Jones*

for successful completion of a webinar presentation on  
Traffic Controller (Naztec TS1 & TS2) and Streetwise Training Course  
September 5, 2013



*Michael Trueblood*

Michael Trueblood, PE, PTOE  
Facilitator



LAPELS Continuing Professional  
Development Provider - CPD.0000281





**Certifications:**  
**Sergio Aviles P.E.**

	
<b>LOUISIANA PROFESSIONAL ENGINEERING &amp; LAND SURVEYING BOARD (LAPELS)</b>	
9643 Brookline Avenue, Suite 121 Baton Rouge, LA 70809 Phone (225) 925-6291 <a href="http://www.lapels.com">www.lapels.com</a>	
<b>Mr. Sergio L. Aviles</b>	
License/Certificate Type - Number	Expiration Date
<b>PE.0033571</b>	<b>03/31/2022</b>
<b>Status: Active</b>	

<p>Please be advised that your license must be in "Active" status in order for you to (a) provide or offer to provide engineering or land surveying services in Louisiana or (b) use the words "engineer", "engineering", "land surveyor", "land surveying" or any modification or derivative thereof in your name or in connection with your business or activities in Louisiana. Licensees whose licenses are in "Retired", "Inactive", or "Expired" status are prohibited from engaging in the activities described above in items (a) and (b).</p> <p>L.A.R. S. 37:689 requires firms practicing or offering to practice engineering or land surveying in the state of Louisiana to be licensed by the Board prior to offering such services.</p>
---



**LOUISIANA ASSOCIATED GENERAL CONTRACTORS, INC.**  
666 North Street - Baton Rouge, LA 70802  
Phone: 225/344-0432 \* Fax: 225/344-0458  
[www.lagc.org](http://www.lagc.org)

January 7, 2019

To Whom It May Concern,

This is to verify that the below listed employee of APS Engineering & Testing has completed LADOTD required ATSSA traffic control training. We are currently awaiting the results of his exam.

LA Specific Traffic Control Supervisor Refresher - December 7, 2018 - Sergio Aviles

If there are any questions regarding this issue, please contact Mr. Barry Lacy, P.E. of LADOTD at Headquarters in Baton Rouge, LA (225-379-1584) or Michael Demouy at the above captioned address.

Best Regards,

Michael Demouy - LAGC Manager



# LOUISIANA UNIFIED CERTIFICATION PROGRAM

## Disadvantaged Business Enterprise Program (DBE)

## Small Business Element (SBE)

This is to certify that under Title 49, Part 26 of the Code of Federal Regulations  
& under the State of Louisiana United Certification Program (LAUCP)

### **APS Engineering & Testing, LLC.**

Is a Certified Disadvantaged Business Enterprise (DBE) & Small Business Element (SBE) in the following specialties:

**NC221310, NC221320, NC541330, NC541370, NC541380, NC541620, NC541690**

*NOTE: There may be other approved NAICS Codes. The online DBE Directory includes a complete list of approved codes.*

### **Certificate Eligibility: October 2021 to October 2022**

*This certificate is valid through the above date provided. This firm meets the on-going programmatic standard and fulfills the annual update requirement to remain in good standing as a DBE. This certification is subject to annual verification and suspension or revocation based upon reasonable cause to believe that the firm is ineligible.*

***Rhonda Wallace***

**Rhonda Wallace, DBE/SBE Programs Manager**  
*Louisiana Department of Transportation & Development*





Office of the Secretary  
PO Box 94245 | Baton Rouge, LA 70804-9245  
PH: 225-379-1200 | FX: 225-379-1851

John Bel Edwards, Governor  
Shawn D. Wilson, Ph.D., Secretary

August 12, 2021

**GOTECH, Inc.**

Attn: Rhaoul A. Guillaume, Sr. P.E.  
8383 Bluebonnet Blvd.  
Baton Rouge, LA 70810

Dear Rhaoul A. Guillaume, Sr.:

We have received your firm's Disadvantaged Business Enterprise (DBE) and Small Business Element (SBE) annual affidavit. Based on the information which you provided we have concluded that your firm continues to meet the eligibility requirements of our program and remains certified for only the following specific work categories that fall under the listed NAICS codes:

**NC541330-Engineering Services**

C09-Civil Engineering

**NC541340-Drafting Services**

C03-Drafting

**NC541370-Surveying and Mapping (except Geophysical) Services**

C06-Land Surveying

**NC541618-Other Management Consulting Services**

C74-Construction Management

C21-Construction Inspections

C11-Planning

*Please note that per the federal regulations, suppliers only receive 60% goal credit towards the materials they provide. Also note that A Louisiana Contractor's License is required by any contractor performing work in excess of \$50,000 with the exception of electrical, mechanical and plumbing which are required to have a license if work is in excess of \$10,000. You may contact the State Licensing Board for Contractors at (225) 765-2301 for more information. Your firm's certification will be recognized by all participants of the Louisiana Unified Certification Program. This includes all entities receiving federal transportation funding within the boundaries of our state.*

You will be required to submit an annual affidavit with all supporting documents (**Business taxes with all attachments, such as 1098, 1099, K-1's and/or W-2's**) stating your firm continues to meet the eligibility requirements of the program. An email informing you to submit the necessary documentation will be forwarded to you approximately six (6) weeks prior to your anniversary date of **June 30, 2022**. However, should you not receive notification from this office for your annual affidavit, it is your responsibility to contact us. Additionally, you must notify our office immediately regarding any changes which affect the social and economic disadvantage, size, ownership or control of your firm.

The Department has contracted with SJB Group, LLC to provide DBE Supportive Services to all our certified DBE's at no cost to you. This consultant can offer your firm assistance and guidance on areas such as marketing, estimating, bidding, financial preparations, etc. Please feel free to contact Jackie des Bordes or Kenyatta Sparks with the SJB Group, LLC at (225) 769-3400 for any assistance needed to grow your organization.

GOTECH, Inc.  
August 12, 2021  
Page 2

We reserve the right to withdraw this certification, if at any time, it is determined that **DBE and SBE** certifications was knowingly obtained by the submission of false, misleading or incorrect data. We further reserve the right to request additional information and/or conduct an on-site visit at any time during your certification period.

If further assistance is needed, contact the DBE Certification Unit at (225) 379-1382.

Respectfully,

A handwritten signature in blue ink, appearing to read "Paula Merrick Roddy", with a large, stylized initial "P" and "R".

Paula Merrick Roddy  
Compliance Programs Director





# LOUISIANA UNIFIED CERTIFICATION PROGRAM

## Disadvantaged Business Enterprise Program (DBE)

## Small Business Element (SBE)

This is to certify that under Title 49, Part 26 of the Code of Federal Regulations  
& under the State of Louisiana United Certification Program (LAUCP)

## GOTECH, INC

Is a Certified Disadvantaged Business Enterprise (DBE) & Small Business Element (SBE) in the following specialties:

**NC541330 NC541340 NC541370 NC541618**

NOTE: There may be other approved NAICS Codes. The online DBE Directory includes a complete list of approved codes.

### **Certificate Eligibility: June 2021 to June 2022**

*This certificate is valid through the above date provided. This firm meets the on-going programmatic standard and fulfills the annual update requirement to remain in good standing as a DBE. This certification is subject to annual verification and suspension or revocation based upon reasonable cause to believe that the firm is ineligible.*

**Paula Roddy, Compliance Programs Director**

*Louisiana Department of Transportation & Development*

**21. QA/QC Plan and/or Work Plan:**

If the advertisement requires submission of a QA/QC plan or Work plan, include them here. Otherwise, leave this section blank.

**Not applicable.**



**22. Sub-consultant information:**

If one or more sub-consultants will be used, provide the name, address, point of contact and phone number for each. Otherwise, leave this section blank

<b>Firm Name (as registered with Louisiana's Secretary of State)</b>	<b>Address</b>	<b>Point of Contact and email address</b>	<b>Phone Number</b>
<b>APS Engineering and Testing, LLC</b>	1645 Nicholson Drive, Baton Rouge, LA 70802	Sergio Aviles <a href="mailto:sergio@aps-testing.com">sergio@aps-testing.com</a>	225-456-5714
<b>Arcadis US, Inc.</b>	10352 Plaza Americana Drive, Baton Rouge, LA 70816	Akhil Chauhan, PE <a href="mailto:Akhil.chauhan@arcadis.com">Akhil.chauhan@arcadis.com</a>	225-368-6563
<b>GOTECH, Inc.</b>	8383 Bluebonnet Boulevard Baton Rouge, LA 70810	Rhaoul A. Guillaume, Sr., P.E., F.ASCE	225-766-5358

(Add rows as needed)

**23. Location:**

If location is an evaluation criterion for this advertisement and the prime consultant intends to establish a local presence, describe the plan for doing so. Otherwise, leave this section blank.

***ECM Consultants, Inc.***

---

8048 One Calais Avenue, Suite F, Baton Rouge, LA 70809